

\*NOTE: THIS SIGN SHALL BE TAKEN DOWN WHEN WORKERS ARE NOT PRESENT.

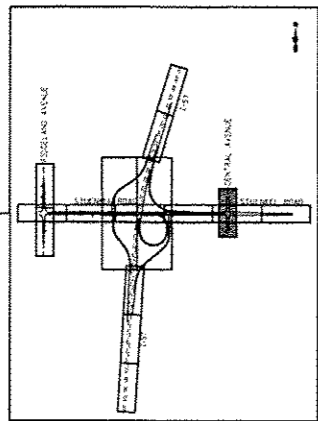
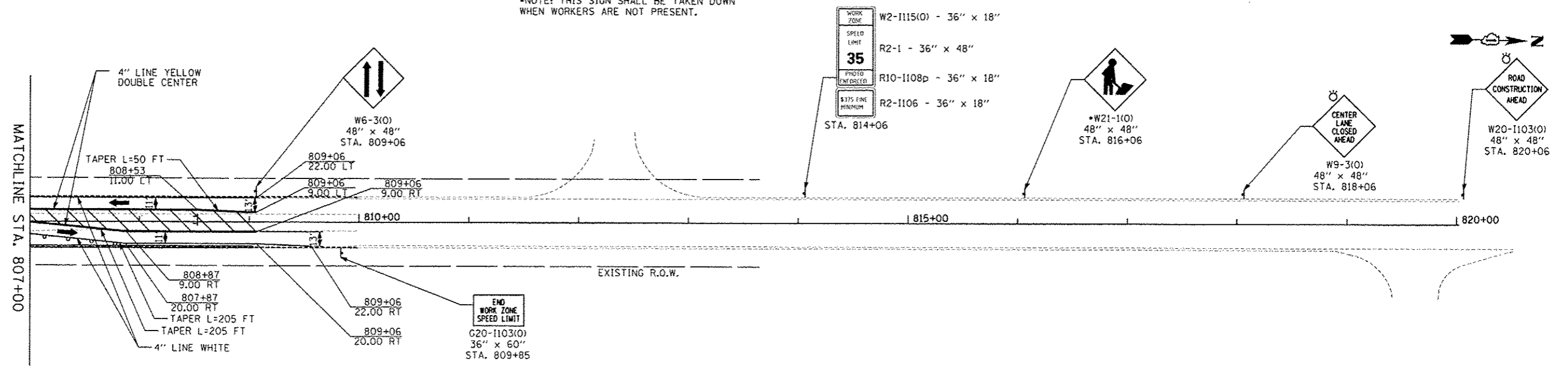

- LEGEND:**
- TRAFFIC MOVEMENT
  - WORK ZONE
  - BARRICADE, TYPE III
  - VERTICAL BARRICADE WITH BI-DIRECTIONAL STEADY-BURNING LIGHT, 50' C-C IN TANGENTS, 20' IN TAPERS
  - VERTICAL PANEL (POST MOUNTED)
  - TEMPORARY AGGREGATE
  - MOT WORK ZONE SIGN
  - TEMPORARY PAVEMENT

**NOTE:**  
SEE STUENKEL ROAD MAINTENANCE OF TRAFFIC - DETOUR PLAN FOR ADVANCED SIGNING.

<b>TYLIN INTERNATIONAL</b> <small>USER NAME: JTP DESIGNED: JTP DRAWN: JTP CHECKED: JPM DATE: 05/10/2013</small>	<small>DESIGNED: JTP REVISOR: 12/04/2013</small>	<b>STATE OF ILLINOIS</b> <b>DEPARTMENT OF TRANSPORTATION</b>	<b>STUENKEL ROAD AT I-57 RIDGELAND AVENUE TO CENTRAL AVENUE</b> <b>MAINTENANCE OF TRAFFIC STAGE 2B - CENTRAL AVENUE</b>		<small>F.A. RTE. 57</small>	<small>SECTION 99-1HB-R1</small>	<small>COUNTY WILL</small>	<small>TOTAL SHEETS 679</small>	<small>SHEET NO. 170</small>
	<small>DATE: 05/10/2013</small>		<small>SCALE: 1" = 50'</small>	<small>SHEET 4 OF 4 SHEETS</small>	<small>STA. 780+00 TO STA. 817+00</small>	<small>ILLINOIS FED. AID PROJECT CONTRACT NO. 60L69</small>			

P:\6028120-57-5\work\INRoad\31\stuenkel\31\stuenkel\31\31\06\2B-4.dwg

12/15/2013 10:30:46 AM