

LEGEND:

- TRAFFIC MOVEMENT
- WORK ZONE
- BARRICADE, TYPE III
- VERTICAL BARRICADE WITH BI-DIRECTIONAL STEADY-BURNING LIGHT, 50' C-C IN TANGENTS, 20' IN TAPERS
- VERTICAL PANEL (POST MOUNTED)
- TEMPORARY AGGREGATE
- MOT WORK ZONE SIGN
- TEMPORARY PAVEMENT

NOTES:

1. SEE STUENKEL ROAD MAINTENANCE OF TRAFFIC - DETOUR PLAN FOR ADVANCED SIGNING.
2. THE EXISTING R.O.W. IS NOT DEPICTED WITHIN THE INTERSECTION FOR CLARITY.

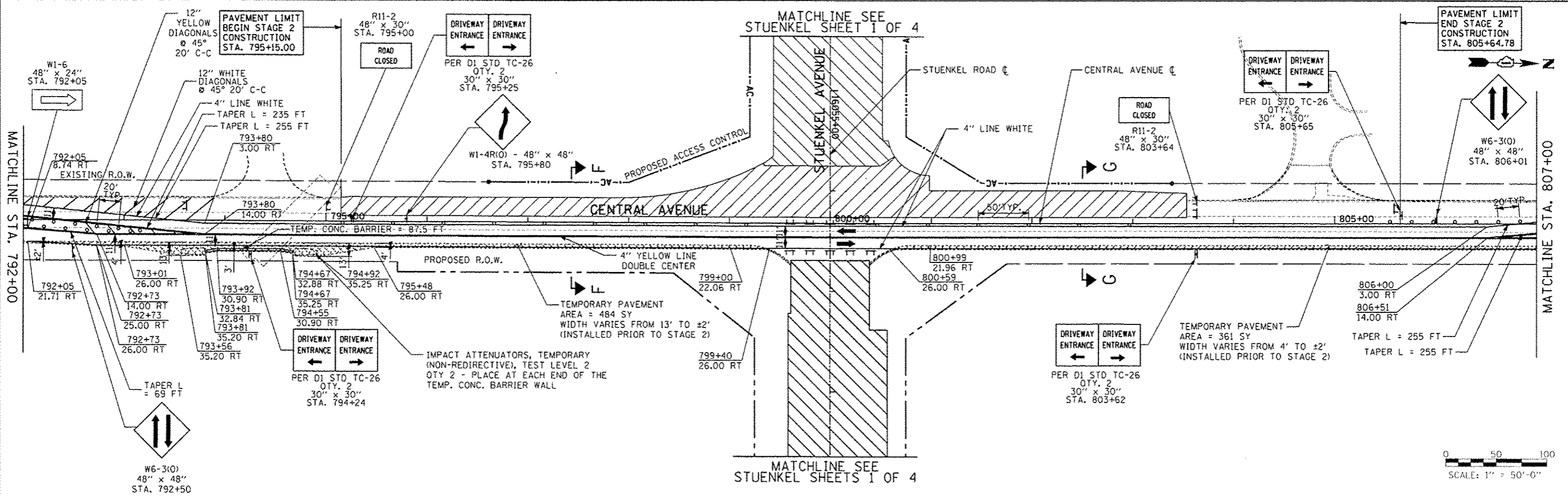
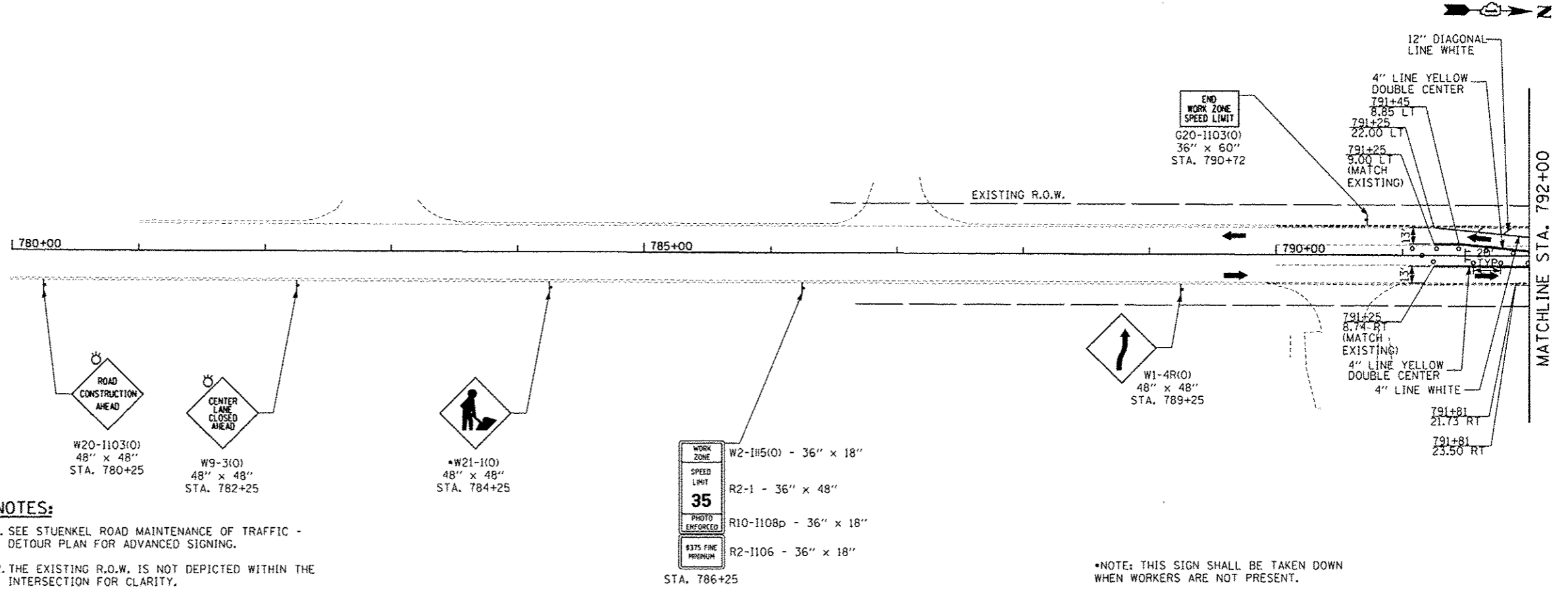

TYLIN INTERNATIONAL

USER NAME	DESIGNED	JTP	REVISED	10/18/2013
PLLOT SCALE	DRAWN	JTP	REVISED	12/04/2013
PLLOT DATE	CHECKED	JPM	REVISED	
	DATE	05/10/2013	REVISED	

**STATE OF ILLINOIS
DEPARTMENT OF TRANSPORTATION**

**STUENKEL ROAD AT I-57 RIDGELAND AVENUE TO CENTRAL AVENUE
MAINTENANCE OF TRAFFIC STAGE 2 - CENTRAL AVENUE**

F.A. RTE.	SECTION	COUNTY	TOTAL SHEETS	SHEET NO.
57	99-1H8-R1	WILL	679	111
CONTRACT NO. 60L69			ILLINOIS FED. AID PROJECT	

P:\60261201\57_8_Stuenkel\Road\AC_30\Interchange\11_3_Stuenkel\MOT_LOCAL_2_3.dwg

10:00:38 AM 10/25/2013