

**NOTES:**

1. SEE RIDGELAND AVENUE MAINTENANCE OF TRAFFIC - DETOUR PLAN FOR ADVANCED SIGNING.
2. EXISTING R.O.W. NOT SHOWN FOR CLARITY WITHIN PROJECT LIMITS.

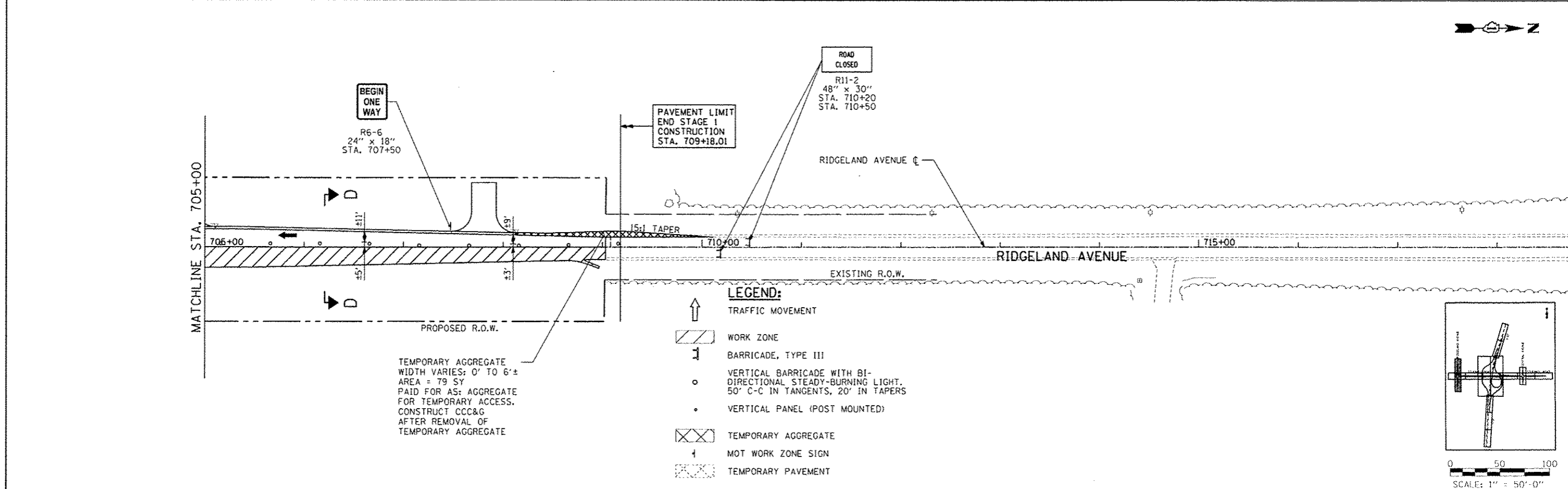

**LEGEND:**

- TRAFFIC MOVEMENT
- WORK ZONE
- BARRICADE, TYPE III
- VERTICAL BARRICADE WITH BI-DIRECTIONAL STEADY-BURNING LIGHT, 50' C-C IN TANGENTS, 20' IN TAPERS
- VERTICAL PANEL (POST MOUNTED)
- TEMPORARY AGGREGATE
- MOT WORK ZONE SIGN
- TEMPORARY PAVEMENT

TEMPORARY AGGREGATE  
WIDTH VARIES: 0' TO 6'±  
AREA = 79 SY  
PAID FOR AS: AGGREGATE  
FOR TEMPORARY ACCESS.  
CONSTRUCT CCC&G  
AFTER REMOVAL OF  
TEMPORARY AGGREGATE

TYLIN INTERNATIONAL	USER NAME	DESIGNED - JTP	REVISED - 10/18/2013	STATE OF ILLINOIS DEPARTMENT OF TRANSPORTATION	STUENKEL ROAD AT I-57 RIDGELAND AVENUE TO CENTRAL AVENUE MAINTENANCE OF TRAFFIC PLAN STAGE 1A - RIDGELAND AVENUE	F.A. RTE.	SECTION	COUNTY	TOTAL SHEETS	SHEET NO.
	PLT. SCALE	DRAWN - JTP	REVISED - 12/04/2013			57	99-IHB-R1	WILL	679	108
	PLT. DATE	CHECKED - JPM	REVISED			CONTRACT NO. 60L69				
		DATE - 05/10/2013	REVISED			ILLINOIS FED. AID PROJECT				

P:\6261201\_57\_9\_5work\B\Road\NC\_3\Interchange\NC\_3\_Stuenkel MD1.DWG 10/18/13

10/30/13 AM