

A-A
STAGE 1 - I-57
STA. 1442+50 TO STA. 1469+15

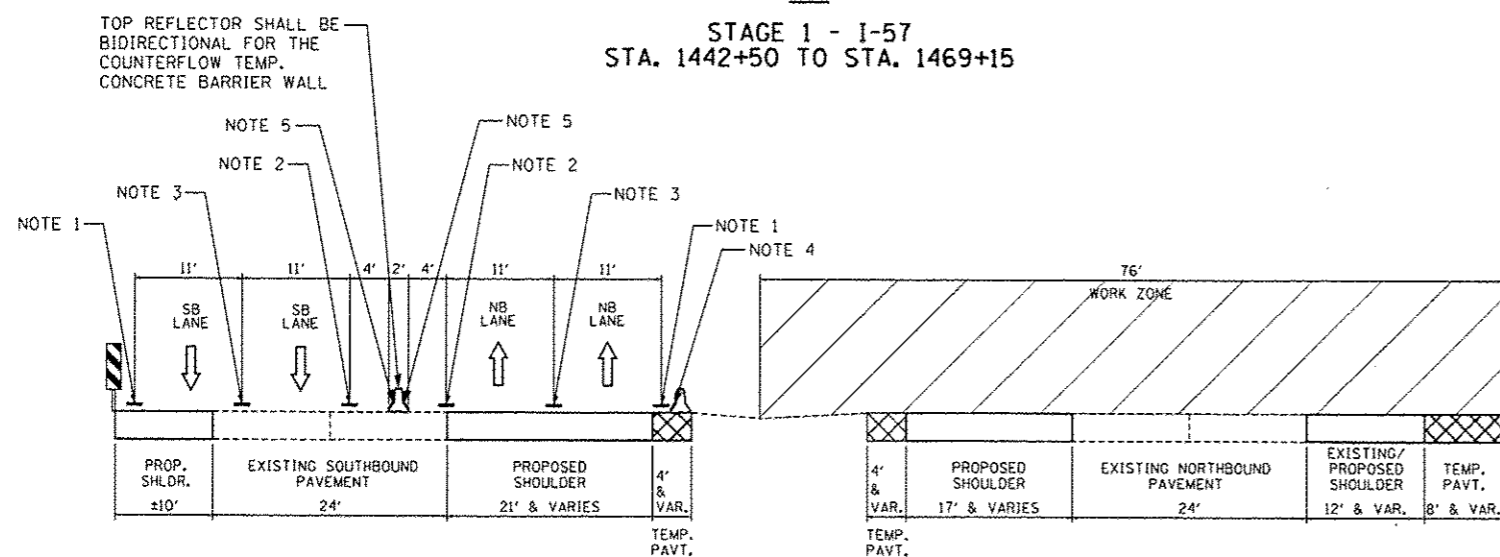

B-B
STAGE 2 - I-57
STA. 1442+50 TO STA. 1458+23
STA. 1459+57 TO STA. 1469+66

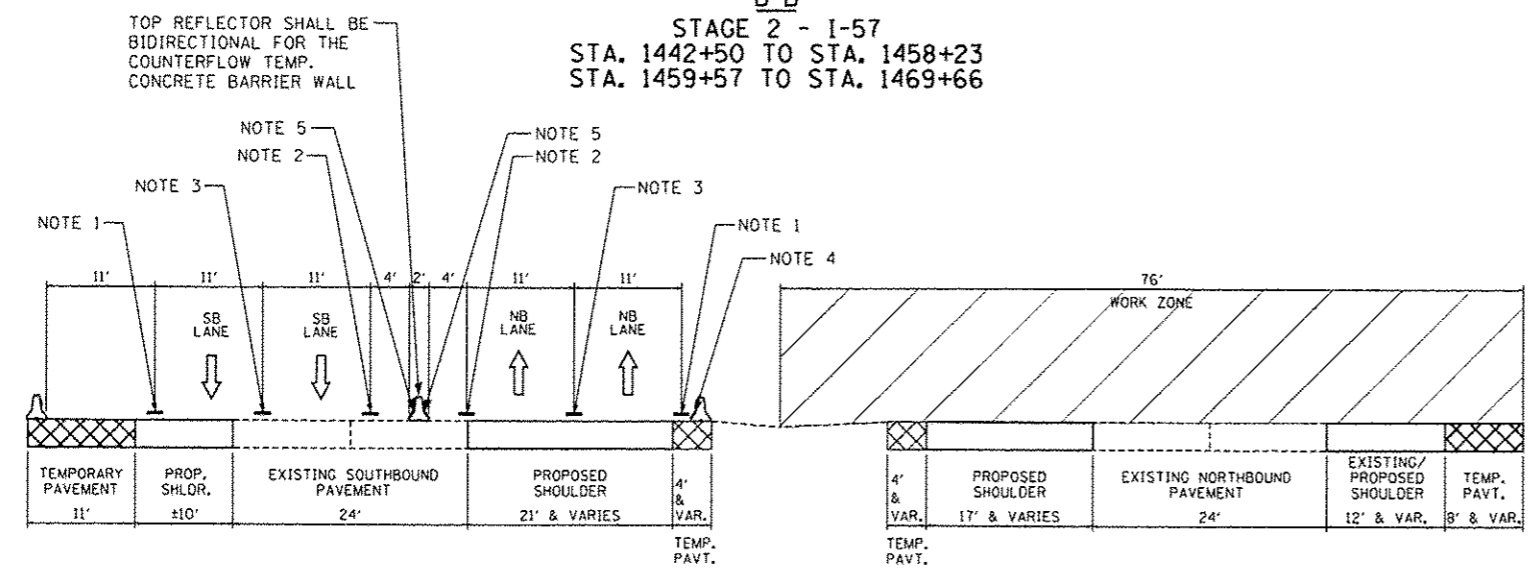

C-C
STAGE 2 - I-57
STA. 1458+23 TO STA. 1459+57

- NOTE 1 - PAVEMENT MARKING TAPE, TYPE III 4" LINE (WHITE)
- NOTE 2 - PAVEMENT MARKING TAPE, TYPE III 4" LINE (YELLOW)
- NOTE 3 - PAVEMENT MARKING TAPE, TYPE III 5" SKIP DASH 10' - 30' (WHITE)
- NOTE 4 - TEMPORARY PAVEMENT MARKING, LINE 6" (WHITE)
- NOTE 5 - TEMPORARY PAVEMENT MARKING, LINE 6" (YELLOW)

LEGEND:

- TRAFFIC MOVEMENT
- DRUM WITH MONO-DIRECTIONAL STEADY BURNING LIGHT
- VERTICAL PANEL (POST MOUNTED)
- VERTICAL BARRICADE WITH BI-DIRECTIONAL STEADY BURNING LIGHT ON TLW SECTIONS AND MONO-DIRECTIONAL STEADY BURNING LIGHT ON ONE WAY AND MULTI-LANE SEGMENTS. 100 FOOT C-C IN TANGENT SECTIONS, 50 FOOT C-C IN TAPERS/RAMPS.
- PAVEMENT MARKING TAPE, TYPE III (SEE PLANS FOR LINE COLOR)
- PAVEMENT REMOVAL / WORK ZONE AREA
- TEMPORARY PAVEMENT / TEMPORARY AGGREGATE
- TEMPORARY CONCRETE BARRIER (WITH REFLECTORS ON TOP AND SIDE FACING TRAFFIC)

TYLIN INTERNATIONAL

USER NAME	DESIGNED - JDF	REVISED - 10/18/2013
PLLOT SCALE	DRAWN - JDF	REVISED - 12/04/2013
PLLOT DATE	CHECKED - JPM	REVISED
	DATE - 05/10/2013	REVISED

STATE OF ILLINOIS
DEPARTMENT OF TRANSPORTATION

STUENKEL ROAD AT I-57 RIDGELAND AVENUE TO CENTRAL AVENUE
MOT TYPICAL SECTIONS - I-57 STAGES 1 & 2

SCALE: N.T.S. SHEET 5 OF 5 SHEETS STA. TO STA.

F.A.I. RTE. 57	SECTION 99-1HB-RI	COUNTY WILL	TOTAL SHEETS 679	SHEET NO. 104
			CONTRACT NO. 60L69	
ILLINOIS FED. AID PROJECT				