

DATE	
BY	
APPROVED	
CHECKED	
NO. OF SHEETS	
NO. OF PAGES	
DATE FILED	

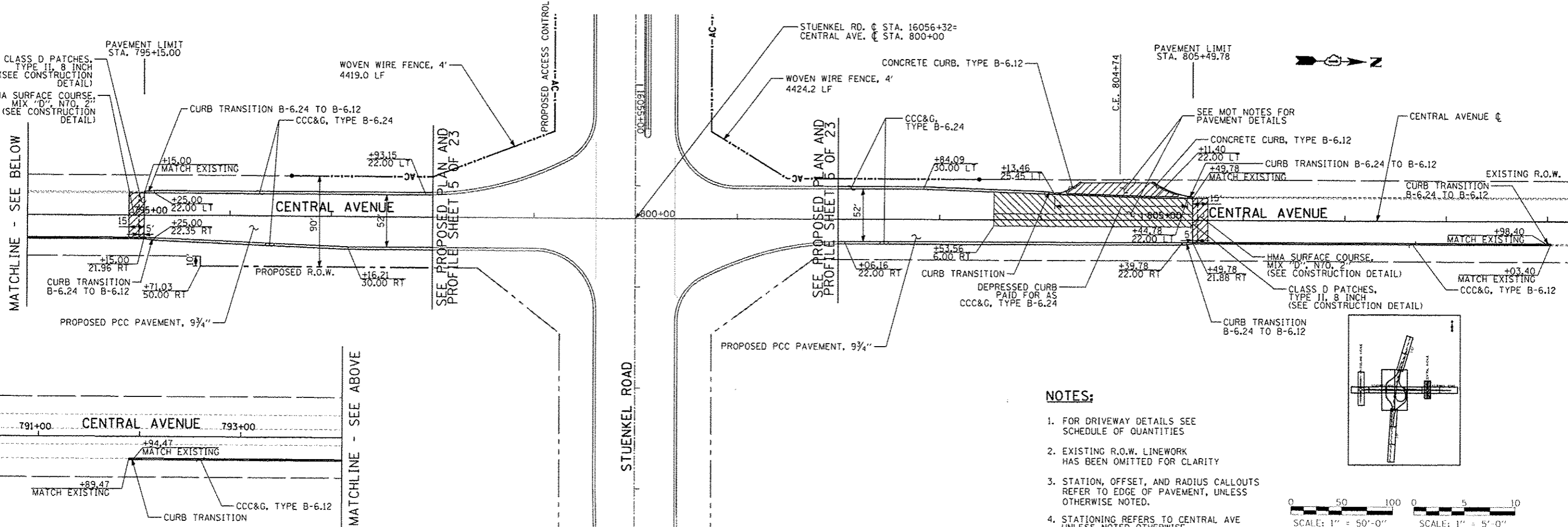

**NOTES:**

1. FOR DRIVEWAY DETAILS SEE SCHEDULE OF QUANTITIES
2. EXISTING R.O.W. LINEWORK HAS BEEN OMITTED FOR CLARITY
3. STATION, OFFSET, AND RADIUS CALLOUTS REFER TO EDGE OF PAVEMENT, UNLESS OTHERWISE NOTED.
4. STATIONING REFERS TO CENTRAL AVE UNLESS NOTED OTHERWISE.

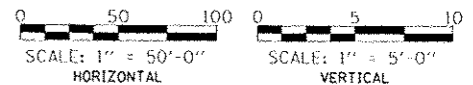
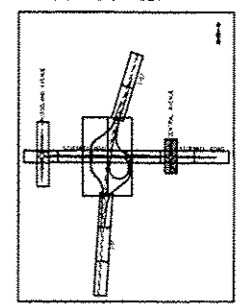

DATE	
BY	
APPROVED	
CHECKED	
NO. OF SHEETS	
NO. OF PAGES	
DATE FILED	

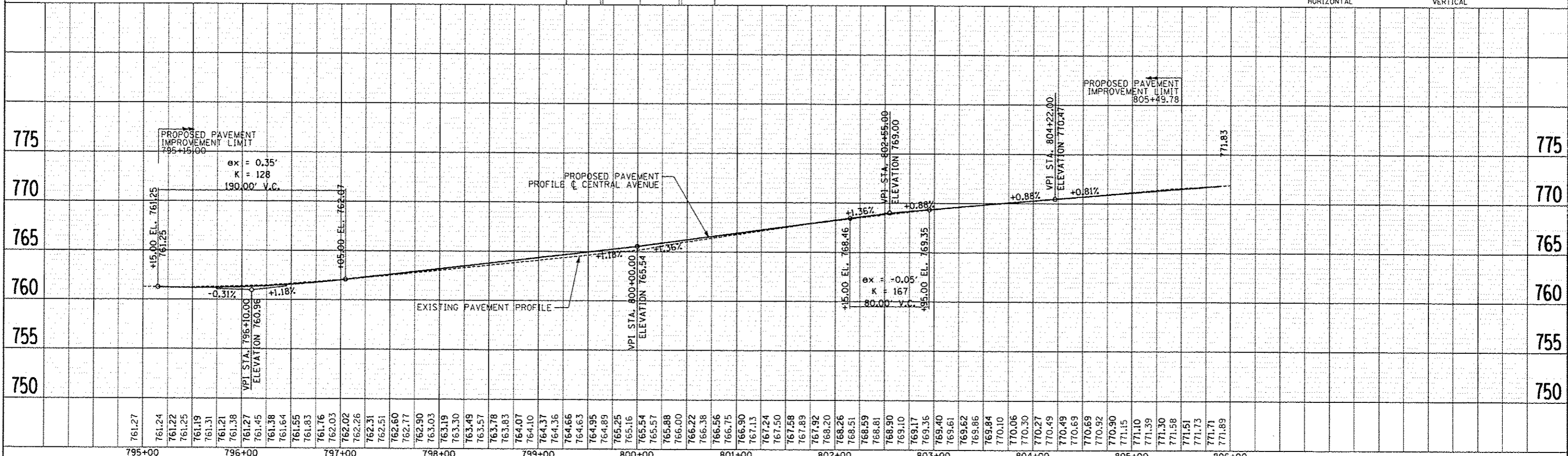

<b>TYLIN INTERNATIONAL</b>	USER NAME: _____	DESIGNED - JTP	REVISED - _____	<b>STATE OF ILLINOIS</b> <b>DEPARTMENT OF TRANSPORTATION</b>	<b>STUENKEL ROAD AT I-57 RIDGELAND AVENUE TO CENTRAL AVENUE</b> <b>CENTRAL AVENUE PROPOSED PLAN AND PROFILE</b>	F.A.I. R.T.E. 57	SECTION 99-IHB-R1	COUNTY WILL	TOTAL SHEETS 679	SHEET NO. 81
	PRINT SCALE: _____	DRAWN - JTP	REVISED - _____			CONTRACT NO. 60L69				
	PRINT DATE: _____	CHECKED - JPM	REVISED - _____			ILLINOIS FED. AID PROJECT				
		DATE 05/10/2013	REVISED - _____							