

- NOTES:**
1. FOR DRIVEWAY DETAILS SEE SCHEDULE OF QUANTITIES
 2. EXISTING R.O.W. LINEWORK HAS BEEN OMITTED FOR CLARITY
 3. STATION, OFFSET, AND RADIUS CALLOUTS REFER TO EDGE OF PAVEMENT, UNLESS OTHERWISE NOTED.
 4. STATIONING REFERS TO RIDGELAND AVE UNLESS NOTED OTHERWISE.

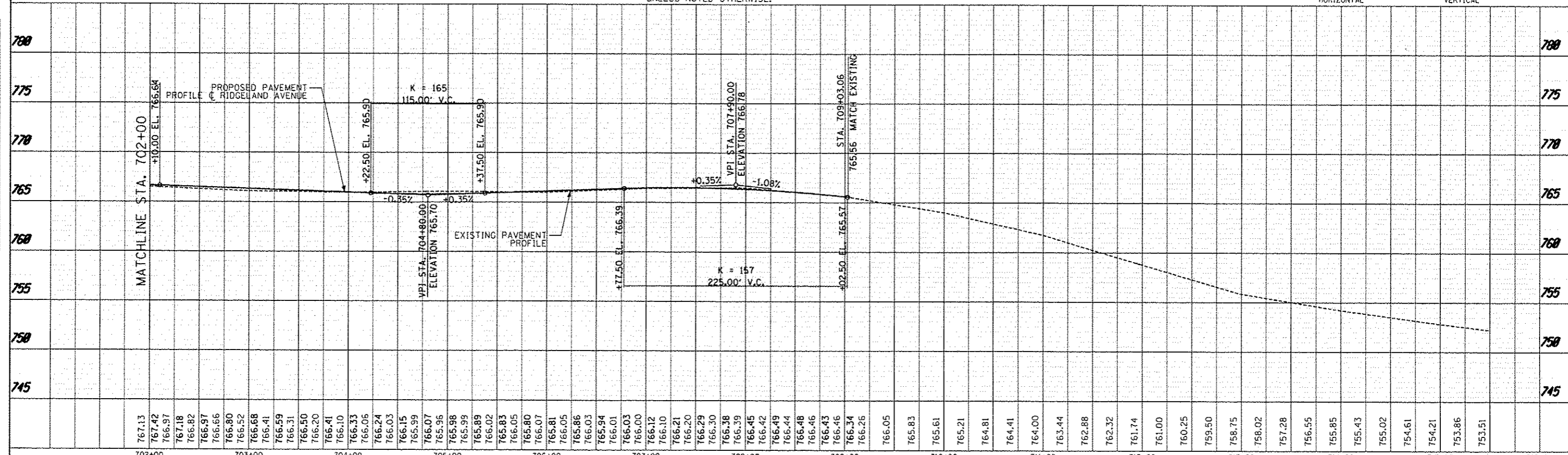
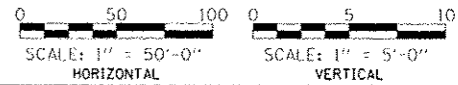
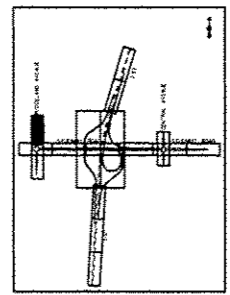

PLAN	DATE
REVISED	
NOTE BOOK	
NO.	

PROFILE	DATE
REVISED	
NOTE BOOK	
NO.	

TYLIN INTERNATIONAL	DESIGNED - JTP	REVISED - 06/21/2013	STATE OF ILLINOIS DEPARTMENT OF TRANSPORTATION	STUENKEL ROAD AT I-57 RIDGELAND AVENUE TO CENTRAL AVENUE RIDGELAND AVENUE PROPOSED PLAN AND PROFILE	F.A.I. 57	SECTION 99-IHB-R1	COUNTY WILL	TOTAL SHEETS 80
	DRAWN - JTP	REVISED - 10/18/2013			CONTRACT NO. 60L69			
	CHECKED - JPM	REVISED -			ILLINOIS FED. AID PROJECT			
	DATE 05/10/2013	REVISED -						
SCALE: 1" = 50'			SHEET 8 OF 23 SHEETS		STA. 703+00 TO STA. 709+03			