

- LEGEND:**
- PAVEMENT REMOVAL
 - DRIVEWAY PAVEMENT REMOVAL
 - PAVED SHOULDER REMOVAL
 - AGGREGATE REMOVAL (PAID FOR AS EARTH EXCAVATION)
 - TRAFFIC SIGN REMOVAL
 - CCC&G REMOVAL
 - FIELD ENTRANCE REMOVAL (PAID FOR AS EARTH EXCAVATION)
 - MAILBOX REMOVAL & TEMPORARILY RELOCATED
 - CABLE BARRIER REMOVAL
 - DRAINAGE STRUCTURE REMOVAL
 - TREE REMOVAL
 - TREE REMOVAL (ACRE)
 - TREE REMOVAL (UNITS SPECIFIED)
 - GUARDRAIL REMOVAL
 - FENCE REMOVAL
 - STORM SEWER REMOVAL
 - PAVEMENT CRACKING & SEATING

NOTE: REMOVAL OF EXISTING SURFACE INCLUDED IN PATCH

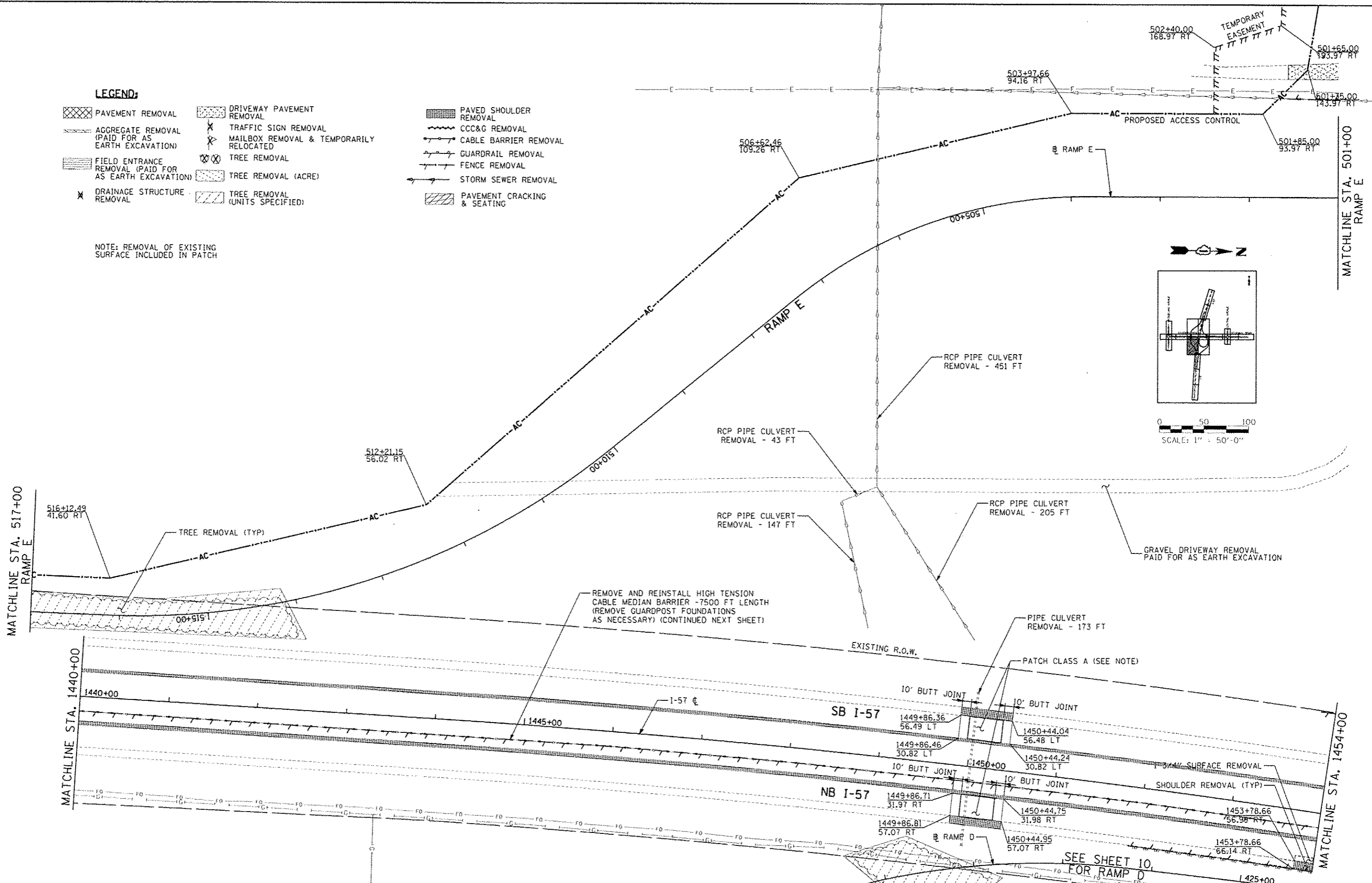

TYLIN INTERNATIONAL	USER NAME	DESIGNED	JTP	REVISED	10/18/2013
	PILOT SCALE	DRAWN	JTP	REVISED	
	PILOT DATE	CHECKED	JPM	REVISED	
		DATE	05/10/2013	REVISED	

**STATE OF ILLINOIS
DEPARTMENT OF TRANSPORTATION**

**STUENKEL ROAD AT I-57 RIDGELAND AVENUE TO CENTRAL AVENUE
RAMP E REMOVAL PLAN**

SCALE: 1" = 50' SHEET 9 OF 14 SHEETS STA. 517+00 TO STA. 501+00

F.A.I. RTE.	SECTION	COUNTY	TOTAL SHEETS	SHEET NO.
57	99-1HB-RJ	WILL	679	67
			CONTRACT NO. 60L69	
ILLINOIS FED. AID PROJECT				

P:\60261201-57_R_StuenkelRoad\AC_30\mto\change\AC_30\Stuenkel_RAMP_E.dgn

3:07:41 PM 12/27/2013