

STUENKEL RD DATA

P.O.T. STA. = 15927+62.74 N = 1,744,712.5234 E = 1,131,814.9301
P.O.T. STA. = 15949+23.72 N = 1,744,756.0716 E = 1,133,975.4738
P.O.T. STA. = 15993+45.85 N = 1,744,832.1982 E = 1,136,396.9498
P.O.T. STA. = 16003+46.49 N = 1,744,852.1819 E = 1,139,397.3874
P.O.T. STA. = 16021+50.00 N = 1,744,886.2104 E = 1,141,200.5730
P.O.T. STA. = 16039+00.00 N = 1,744,919.2294 E = 1,142,950.2615
P.O.T. STA. = 16056+32.31 N = 1,744,951.9146 E = 1,144,682.2614
P.O.T. STA. = 16099+21.56 N = 1,745,029.4382 E = 1,148,970.8158

I-57 DATA

PROP. CURVE EXCL57-1
EXIST. CURVE MA111-1
PI STA. = 1458+10.02
N = 1,745,198.5034
E = 1,142,062.1467
Δ = 14° 07' 38" (RT)
D = 0° 29' 59"
R = 11,467.92'
T = 1,421.02'
L = 2,827.62'
e = ----
T.R. = ----
S.E. RUN = ----
P.C. STA. = 1443+89.00
N = 1,743,778.5775
E = 1,142,006.4196
P.T. STA. = 1472+16.63
N = 1,746,561.8830
E = 1,142,462.7602

RIDGELAND AVE DATA

P.O.T. STA. = 680+02.45 N = 1,742,854.9219 E = 1,139,431.4980
P.O.T. STA. = 700+00.00 N = 1,744,852.1819 E = 1,139,397.3874
P.O.T. STA. = 720+16.29 N = 1,746,868.1542 E = 1,139,361.8510

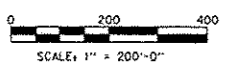
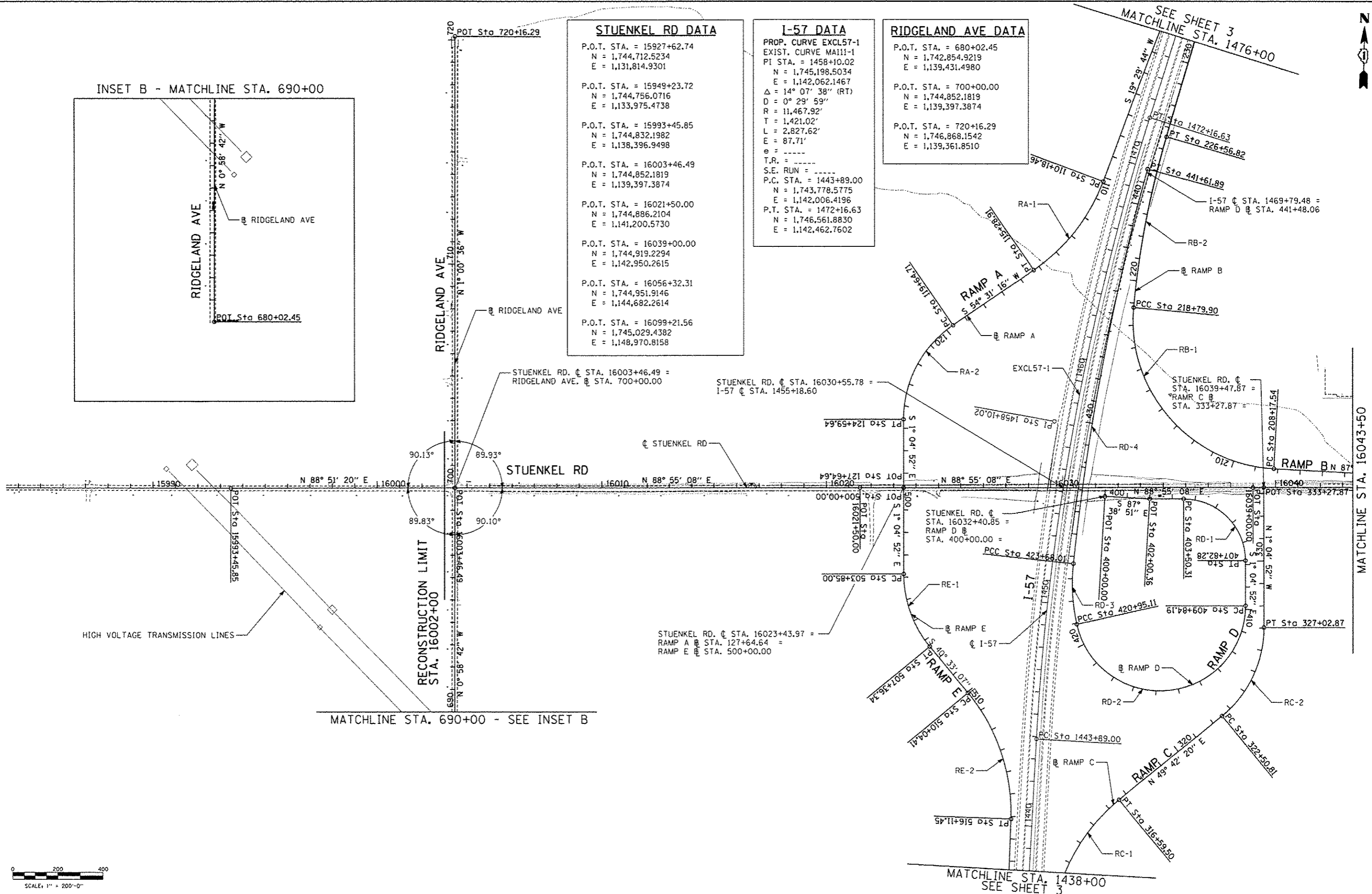

TYLIN INTERNATIONAL USER NAME: _____ PLOT SCALE: _____ PLOT DATE: _____	DESIGNED: BES DRAWN: BES CHECKED: JPM DATE: 05/10/2013	REVISED: _____ REVISED: _____ REVISED: _____ REVISED: _____	STATE OF ILLINOIS DEPARTMENT OF TRANSPORTATION	STUENKEL ROAD AT I-57 RIDGELAND AVENUE TO CENTRAL AVENUE ALIGNMENT PLAN		F.A.J. RTE.: 57 SECTION: 99-1HB-R1 COUNTY: WILL TOTAL SHEETS: 679 SHEET NO.: 28 CONTRACT NO.: 60L69
	SCALE: 1" = 200' SHEET 1 OF 3 SHEETS STA. TO STA.			ILLINOIS FED. AID PROJECT		
	MATCHLINE STA. 1438+00 SEE SHEET 3					