

ASBESTOS SURVEY REPORT

PTB 196-032

Asbestos Survey for Building Demolition (I-80)

607 Water Street, Joliet, Illinois

Region One/District One

Prepared for:



**Illinois Department of Transportation
District 1**

Submitted to:

WSP USA

30 N. LaSalle Street

Chicago, IL, 60602

Prepared by:



GSG CONSULTANTS, INC.

735 Remington Road, Schaumburg IL 60173
Tel: 630.994.2600, www.gsg-consultants.com

January 2, 2026



January 2, 2026

David Skaleski, P.E.
Project Manager
WSP USA
30 N. LaSalle Street, Suite 4200
Chicago, Illinois 60602

Asbestos Survey Report
PTB 198-003
FAI-80 (I-80) over Des Plaines River Bridge
Job N. D-91-204-19
607 Water Street, Joliet, IL
Parcel No. 1P10140

Dear Mr. Skaleski:

GSG Consultants, Inc. (GSG) has conducted an Asbestos Survey for the above referenced property in accordance with our contractual agreement. The report provides a description of the site, survey methodology, analytical results, abatement cost estimates, and recommendations.

Should you have any questions or require additional information, please call us at 630-994-2600.

Prepared by:	<u></u>	<u>January 2, 2026</u>
	Erin Pahomi	Date
	Asbestos Building Inspector	
	Inspector License No: 100-20674	

Reviewed By:	<u></u>	<u>January 2, 2026</u>
	Kyle Boyd, CIH, CHMM	Date
	Director of Industrial Hygiene	

QA Manager:	<u></u>	<u>January 2, 2026</u>
	Ala E Sassila, Ph.D., PE	Date

TABLE OF CONTENTS

1.0	INTRODUCTION	4
2.0	SURVEY METHODOLOGY	5
2.1	VISUAL INSPECTION	5
2.2	SAMPLING PROCEDURES	5
2.3	QUANTIFICATION.....	6
3.0	ANALYTICAL RESULTS.....	7
3.1	TESTING PROCEDURES	7
3.2	FINDINGS.....	7
4.0	RECOMMENDATIONS.....	8
5.0	LIMITATIONS	10
6.0	CERTIFICATION	11

TABLES

Table 1	Materials Sampled for ACM.....	2
----------------	---------------------------------------	----------

EXHIBITS

Figure 1	Asbestos Bulk Sampling Locations
Figure 2	Asbestos-Containing Material Locations

APPENDICES

Appendix A	Analytical Testing Results
Appendix B	Reference Photographs
Appendix C	Inspector Licenses and Training Certificates
Appendix D	Laboratory Accreditations

ACRONYMS AND ABBREVIATIONS

ACM	Asbestos-Containing Material
ACBM	Asbestos-Containing Building Material
CFR	Code of Federal Regulations
COC	Chain of Custody
GSG	GSG Consultants, Inc.
IDOT	Illinois Department of Transportation
IDPH	Illinois Department of Public Health
NESHAP	National Emissions Standards for Hazardous Air Pollutant
NVLAP	National Voluntary Laboratory Accreditation Program
OSHA	Occupational Safety and Health Administration
PLM	Polarized Light Microscopy
RACM	Regulated Asbestos-Containing Material
TSI	Thermal System Insulation
USEPA	United States Environmental Protection Agency



SURVEY SUMMARY

SITE INFORMATION			
FAP Route:	FAI-80 (I-80)	Address:	607 Water Street
County:	Will	City, State, Zip	Joliet, IL 60433
Section:	N/A	Property Type:	Single-Family Residential
IDOT Job No.	D-91-204-19	Construction Date:	1941
Parcel No.	1P10140	Building Size:	600 SF

ASBESTOS CONTAINING MATERIALS	
Survey Date:	December 16, 2025
Weather Conditions:	14°F, Sunny
By Whom: Firm: Inspector: IDPH License No.	GSG Consultants, Inc Erin Pahomi 100-20674
Results:	Number of Material Types Sampled <u>13</u> Number of Samples Collected: <u>39</u> Number of Materials Tested Positive: <u>3</u> Was Friable ACM Found? <u>Yes</u> Were Roofing Materials Sampled? <u>Yes</u> Are There Unique State or Local Requirements? <u>No</u>
Laboratory Used:	Name: Stat Analysis Corporation (Sterling Labs) Address: 2242 W. Harrison Street, Chicago, Illinois NVLAP: 101202-0
Building Access Limitations:	None

ASBESTOS-CONTAINING MATERIAL (ACM) SURVEY RESULTS:

Parcel No. 1P10140
Residential Property
607 Water Street, Joliet, Illinois

Table 1 provides a list of the homogeneous building material types that were sampled as part of the asbestos survey and the laboratory testing results.

HA No.	Material Description	Location	Type ⁽¹⁾	Condition	Friable	% Asbestos*	# of Samples	Estimated Quantity ⁽²⁾
1	Drywall System (Drywall, Tape, & Compound)	Throughout	Misc.	Good	No	Asbestos Not Detected	3	N/A
2	Plaster	Bedroom, Living Room, Kitchen	Surf.	Good	No	Asbestos Not Detected	3	N/A
3	Stone Pattern Linoleum	Kitchen	Misc.	Good	No	Asbestos Not Detected	3	N/A
4	Red Flooring	Basement Stairs	Misc.	Good	No	Chrysotile 15-20%	3	50 SF
5	Chimney Brick	Basement	Misc.	Good	No	Asbestos Not Detected	3	N/A
6	Duct Seal	Basement	Misc.	Good	No	Asbestos Not Detected	3	N/A
7	Pipe Wrap	Basement	TSI.	Good	Yes	Chrysotile 60-65%	3	5 LF
8	Duct Wrap Tape	Basement	Misc.	Good	No	Chrysotile 60-65%	3	5 LF
9	Window Glazing	Basement	Misc.	Good	No	Asbestos Not Detected	3	N/A
10	Attic Insulation	Attic	Misc.	Good	No	Asbestos Not Detected	3	N/A
11	Roofing Material (3 Layers)	Roof	Misc.	Good	No	Asbestos Not Detected	3	N/A
12	Brick Mortar	Exterior	Misc.	Good	No	Asbestos Not Detected	3	N/A
13	Exterior Window Caulking	Exterior	Misc.	Good	No	Asbestos Not Detected	3	N/A
Total Estimated Quantity of ACM								50 SF/ 10 LF

(1) TSI= Thermal System Insulation, Surf. = Surfacing Material, and Misc. = Miscellaneous.

(2) Quantities are estimates only, all quantities must be field verified.

1.0 INTRODUCTION

GSG Consultants Inc. (GSG) conducted an Asbestos Survey at Parcel No. 1P10140 located at 607 Water Street in Joliet, Illinois. The site is improved with a one-story, single-family house that is approximately 600 square feet in size and includes an attic and a basement. The interior walls and ceilings are plaster and drywall, and the floors are wood, floor tile, and linoleum. The building exterior is of masonry construction with an asphaltic shingled roof.

GSG conducted the asbestos survey to satisfy requirements of the United States Environmental Protection Agency (USEPA) regulations under 40 CFR Part 61, Subpart M of the National Emission Standards for Hazardous Air Pollutants (NESHAP) and applicable state and local regulations. This was accomplished by conducting a visual inspection of the structures to be impacted by the planned demolition and collecting samples of suspect Asbestos-Containing Material (ACM) based on these observations.

The results, findings, conclusions, and recommendations expressed in this report are based on conditions observed during GSG's survey of the project area. The information contained in this report represents conditions at the time of the survey and may not accurately represent conditions at a later date. The conclusions in this report are based on conditions observed in accessible areas of the project area. The possibility exists that suspect hazardous building materials or conditions may exist within wall cavities, voids, or other areas hidden from view which were not observed and cannot be ruled out. Any additional potential hazardous building materials encountered that will be disturbed during the demolition activities and that differ from the materials assessed during this survey, were hidden from view, or were located in an area not accessible will require further sampling and analysis prior to disturbance. The estimated quantities provided herein should be considered approximate and are accurate to the extent allowable under the terms and conditions of our contract. This report has been prepared with generally accepted industry practices and procedures. No other warranty, either expressed or implied, is made.

The investigation did not include access or inspection of confined spaces, underground piping, conduits, and building footings, if any. Materials associated with electrical components and energized equipment were not safely accessible and were not sampled.

2.0 SURVEY METHODOLOGY

The asbestos survey was conducted in compliance with the United States Environmental Protection Agency (USEPA) National Emissions Standards for Hazardous Air Pollutants (NESHAPs), applicable state of Illinois and local asbestos regulations. NESHAP regulations defined Regulated Asbestos-Containing Material (RACM) as a friable asbestos material, a Category I non-friable ACM that has become friable, a Category I non-friable ACM that will be or has been subjected to sanding, grinding, cutting or abrading, or Category II non-friable ACM that has a high probability of becoming or has become crumbled, pulverized, or reduced to powder by the forces acting on it during demolition or renovation. The materials were then classified with regard to whether they are friable or non-friable and classified as Class I or Class II non-friable materials, using the following definitions.

- **Friable:** NESHAP defines a friable ACM as any material containing more than one percent (1%) asbestos, which, when dry, may be crumbled, pulverized, or reduced to powder by hand pressure, and includes previously non-friable material where previously non-friable material becomes damaged to the extent that it may be crumbled, pulverized, or reduced to powder by hand pressure.
- **Category I Non-friable ACM:** NESHAP defines a Category I non-friable ACM as packing, gaskets, resilient floor covering (except vinyl sheet flooring products that are considered friable), and asphalt roofing products that contain more than one (1) percent asbestos as determined using the method specified in **Appendix A**, Subpart F, 40 CFR Part 763, Section 1, Polarized Light Microscopy (PLM).
- **Category II Non-friable ACM:** means any material, excluding Category I non-friable ACM, containing more than 1 percent asbestos as determined using the methods specified in **Appendix A**, Subpart F, 40 CFR Part 763, Section 1, PLM that, when dry, cannot be crumbled, pulverized, or reduced to powder by hand pressure.

The survey consisted of three major activities: visual inspection, sampling, and quantification of building materials. A brief description of each of the above elements is provided in the following sections.

2.1 Visual Inspection

The inspector conducted an initial building walkthrough to determine the presence and condition of suspect ACM that were accessible and/or exposed. The survey consisted of accessing accessible areas of the buildings to identify and quantify suspect ACM. The inspector identified Homogeneous Areas (HA) comprised of building materials that appear similar throughout in terms of color and texture and assumed date of installation. Materials that were similar in general appearance were grouped into homogeneous sampling areas. Following the EPA inspection protocol, each identified suspect homogeneous material was placed in one of the following EPA classifications:

1. Surfacing Materials (spray or trowel applied to building members)
2. Thermal System Insulation (materials generally applied to various mechanical systems)
3. Miscellaneous Materials (any materials which do not fit either of the above categories)

2.2 Sampling procedures

The asbestos inspector collected a representative number of samples from each HA. Building materials identified

2.0 Survey Methodology**607 Water Street, Joliet, IL**

as concrete (not including cement panels or pipe and soft concrete), glass (including fiberglass), wood, masonry, metal, and plastic are not considered suspect ACM and were not sampled. The survey included destructive, intrusive, and/or exploratory testing unless specifically prohibited by IDOT. Destructive sampling is performed to identify materials that are concealed or obstructed. Concealed or obstructed areas include but are not limited to wall cavities, pipe chases, spaces above fixed ceilings, materials located under carpeting or subfloors, and ceramic tile grout/adhesive. Bulk samples of suspect ACM were collected in general accordance with NESHAP sampling protocols, based on the results of the visual observation. Representative samples of suspect materials were collected of each HA.

A total of thirty-nine (39) bulk samples of suspect ACM, three (3) samples for each of the thirteen (13) homogeneous areas, were collected from various homogeneous areas of the building. Bulk samples were collected from the following materials/homogeneous area(s):

- Drywall System (Drywall, Tape, & Compound)
- Plaster
- Stone Pattern Linoleum
- Red Flooring
- Chimney Brick
- Duct Seal
- Pipe Wrap
- Duct Wrap Tape
- Window Glazing
- Attic Insulation
- Roofing Material (3 Layers)
- Brick Mortar
- Exterior Window Caulking

Exhibit 1, Suspect ACM Sample Locations, shows the approximate locations of the suspect ACM collected during the field survey. Samples were placed in new sealable containers and labeled with unique sample numbers using an indelible marker. All non-disposable sampling equipment was wet-wiped and cleaned before and after each use. Bulk material samples were collected in 4-milliliter plastic bags and tightly sealed for transport to the laboratory. Bulk samples were submitted under a strict chain-of-custody (COC) protocol to Stat Analysis Corporation (Sterling Labs) in Chicago, Illinois.

2.3 Quantification

The inspector estimated the quantities of accessible and/or exposed materials that were suspected of containing asbestos using a measuring wheel and/or visual estimation. Actual quantities may differ between visually estimated values and physical measurements. The asbestos abatement contractor is responsible for verifying reported quantities of ACM.

3.0 ANALYTICAL RESULTS

3.1 Testing Procedures

Stat Analysis Corporation (Sterling Labs) analyzed the bulk samples using PLM method with dispersion staining techniques per USEPA methodology “Method for the Determination of Asbestos in Bulk Building Materials, EPA/600/R-93/116, July 1993”. This is a standard method of analysis in optical mineralogy and the currently accepted method for the determination of asbestos in bulk samples. A suspect material is immersed in a solution of known refractive index and subjected to illumination by polarized light. The characteristic color displays which enable mineral identification. It should be noted that some ACM may not be accurately identified and/or quantified by PLM. The percentage of asbestos applicable was determined by microscopic visual estimation. Stat Analysis Corporation (Sterling Labs) analyzed each layer of each sample individually, which means if multiple layers are detected in the same sample (i.e., roof field), each layer was analyzed, and a separate result was provided for each layer. If any of the sample results from a homogeneous group had a positive result, that homogeneous group was considered to be ACM. Stat Analysis Corporation (Sterling Labs) is accredited under the National Voluntary Laboratory Accreditation Program (NVLAP Accreditation Number 101202-0). Refer to **Appendix D** for laboratory accreditations.

3.2 Findings

GSG identified a total of thirteen (13) HAs from which thirty-nine (39) samples were collected and analyzed. Results are summarized in **Table 1** and include a description of each material, location, material type, test results, and estimated quantity. Materials indicated to have a “negative” result were confirmed by PLM analysis to be non-asbestos-containing. The laboratory results are provided in **Appendix A** and reference photographs are included in **Appendix B**. The USEPA defines ACM as a material containing greater than 1% asbestos. Materials containing less than 1% asbestos are not regulated by the USEPA or the State of Illinois, but their disturbance is regulated by OSHA.

The following **HAs were confirmed** to be ACM:

- Red Flooring
- Pipe Wrap
- Duct Wrap Tape

The laboratory reported that asbestos was Not Detected (ND) in the remaining bulk samples collected by GSG. **Exhibit 2, ACM Locations**, shows the approximate locations of ACM present in the building.

4.0 RECOMMENDATIONS

GSG understands that the residential property will be demolished as part of the I-80 improvement project. ACM identified at the site must be removed and managed in accordance with all federal, state, and local regulations governing asbestos. ACM abatement and management are subject to the US EPA, the Occupational and Health Administration (OSHA), Illinois Department of Public Health (IDPH), the Illinois Environmental Protection Agency (Illinois EPA), and other applicable federal, state, and local government regulations. The following regulations governing asbestos removal and disposal:

1. U.S. Environmental Protection Agency Regional National Emissions Standards for Hazardous Air Pollutants (NESHAP) (40 CFR Part 61 Subpart A and M).
2. U.S. Department of Transportation "Hazardous Substances Final Rule" 49 CFR 171 and 172, November 21, 1986, February 17, 1987.
3. U.S. Department of Labor Occupational Safety and Health Administration (OSHA) Asbestos Regulations (Code of Federal Regulations Title 29, Part 1910, Section 1910.1001 and Part 1926, Section 1926.1101).
4. State of Illinois, Commercial and Public Building Asbestos Abatement Act. Illinois Department of Public Health, Rules for Asbestos Abatement for Public and Private Schools and Commercial and Public Buildings in Illinois (77 IL Admin. Code 855).

All friable asbestos-containing building materials (ACBMs) identified shall be removed from any building(s) or other structures before demolition. Non-friable ACM may be left in place, unless during demolition, the ACM may become friable. If other suspect materials not referenced in this survey report, within or on the outside of the buildings, are identified, not listed in **Table 1**, such materials shall be assumed ACM until the materials are inspected by a licensed asbestos inspector, sampled, and submitted for laboratory analysis.

GSG recommends the preparation of an asbestos abatement project design before any demolition. An asbestos abatement design plan and specifications should include information regarding the location of containments and barriers, type of sealant, and air sampling requirements and clearance during the asbestos abatement activities. The asbestos design plan and specifications shall be prepared and signed by an IDPH licensed asbestos project designer following Illinois regulations. Before starting any abatement activities, an asbestos abatement notification is required for all asbestos projects and must be applied for at least ten (10) working days before the start of the project. A building demolition notification is required for all demolition projects and must be applied for at least ten (10) working days before the start of the project.

Abatement and emergency response shall be conducted only by IDPH licensed asbestos abatement contractor(s) under the supervision of a licensed asbestos project manager in accordance with all applicable federal, state, and local regulations. Workers who abate or manage asbestos must receive the proper training and licensing. OSHA prescribes required personnel monitoring including air monitoring and medical monitoring (ref 29 CFR 1926.1101). Personnel protective equipment and procedures are also required.

All asbestos waste generated from the required pre-demolition removal activities during the project must be wetted before it is double bagged in 6-millimeter plastic bags and enclosed in a plastic, leak-tight container with a lid and proper labeling. No visible emissions to the outside air during the collection, processing, packaging, or transporting of any asbestos-containing waste material. Asbestos waste is a "special waste" in Illinois. Asbestos-

containing waste can only be disposed of in Subtitle D landfills that are designated to receive asbestos waste.

5.0 LIMITATIONS

This report has been prepared for the exclusive use of the Illinois Department of Transportation (IDOT) and its Design Section Engineer consultant. GSG warrants that the investigations and methodology reflect our best efforts based upon the prevailing standard of care in the environmental field. This assessment was limited to those materials which were readily accessible and visible with limited demolition of building components. Additional suspect materials may be located behind walls and ceilings. The survey is subject to the following limitations.

- The investigation did not include sampling on any system which may present a hazard to the inspection team such as energized electrical systems or within confined spaces
- Estimated quantities of the ACM are based on observations during the field survey and additional materials may be concealed or were not accessible. Therefore, all estimated quantities shall be field verified by the abatement contractor.

6.0 CERTIFICATION

The undersigned hereby affirm that the conditions described herein are accurate to the best of our knowledge and belief and are subject to the limitations inherent in the investigative techniques used and any expressed limitations of this survey. Applicable licensing to perform the described survey activities was valid at the time of performance of services in accordance with applicable federal, state and local laws, rules, and regulations.

Inspection Performed By:

Erin Pahomi

Asbestos Inspector's Name

100-20674

IDPH License Number



Asbestos Inspector's Signature

12.16.2025

Date

EXHIBITS

Exhibit 1	Suspect ACM Sample Location Plans
Exhibit 2	Asbestos-Containing Material Location Plan

EXHIBIT 1

SL-1, SL-2, and SL-3 Suspect ACM Sample Location Plans

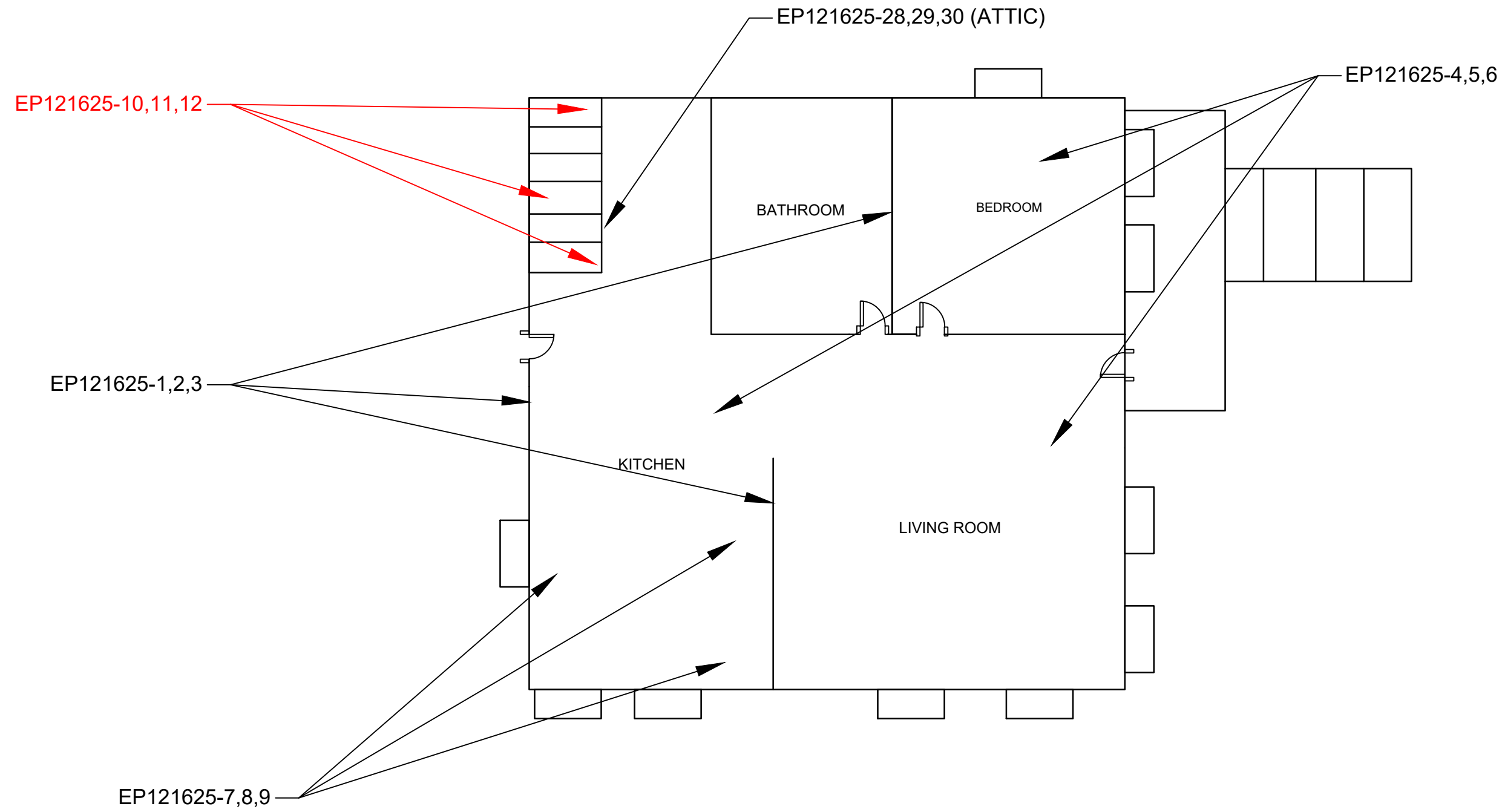

FIRST FLOOR
SCALE = N.T.S.



LEGEND

SUSPECT ACM SAMPLE LOCATIONS: EP121625-XX

BATCH NUMBER: 377080

RED SAMPLES TESTED POSITIVE FOR ASBESTOS

SUSPECT ASBESTOS-CONTAINING MATERIAL SAMPLE LOCATION PLAN

ASBESTOS SURVEY FOR BUILDING DEMOLITION (I-80)
607 WATER STREET
JOLIET, IL, 60436

GSG CONSULTANTS, INC.
732 E. BROADWAY, SUITE 200, JOLIET, IL 60436
TEL: 815.741.1111 FAX: 815.741.1112
ILLINOIS PROFESSIONAL DESIGN FIRM 18-000002

DRAWN BY:	PROJECT:
EP	21-2007
CHECKED BY:	SCALE:
KB	NTS
DATE:	SHEET #:
12/23/25	1 OF 3
SHEET NAME:	

SL-1

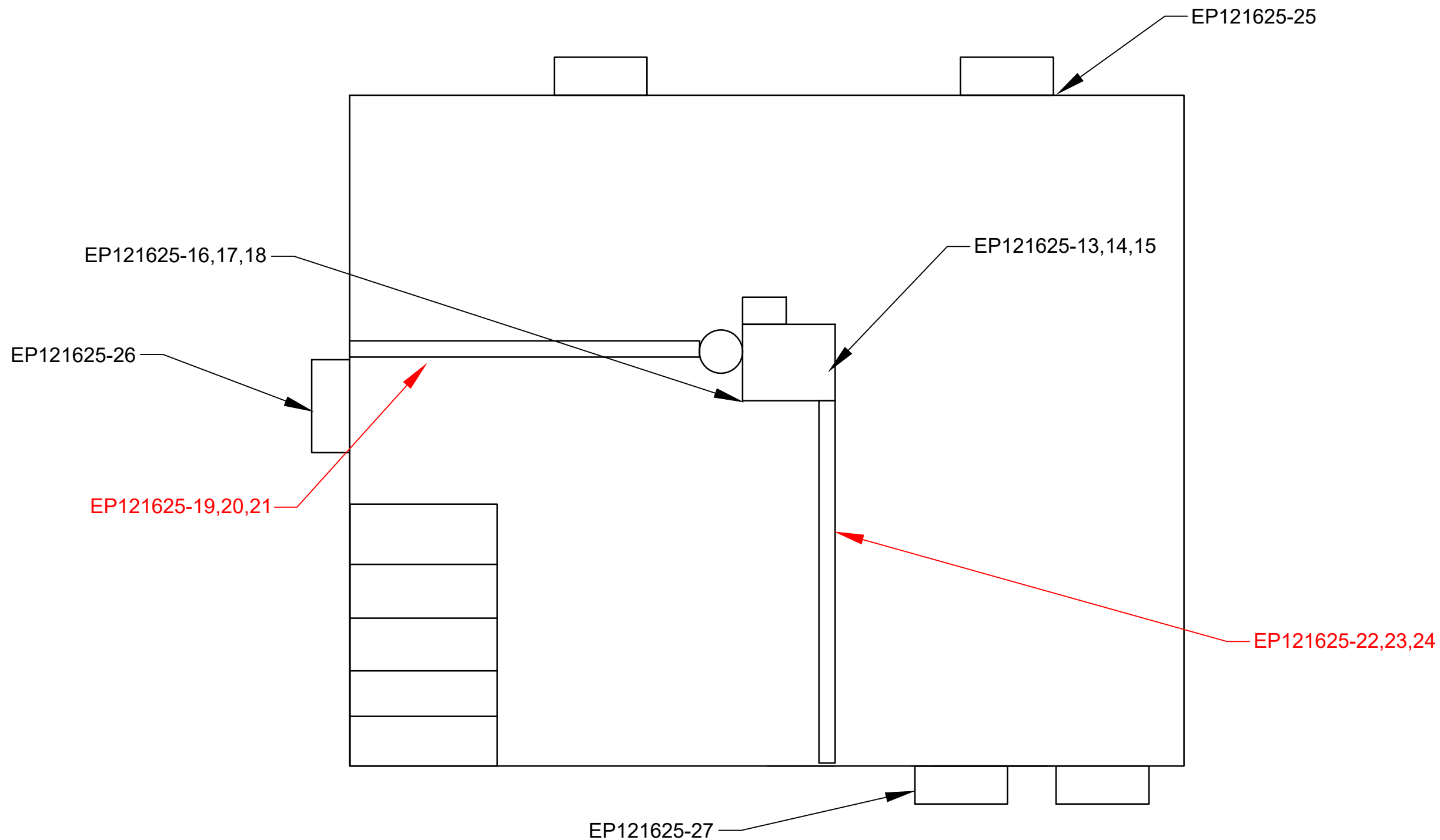

BASEMENT
SCALE = N.T.S.



LEGEND

SUSPECT ACM SAMPLE LOCATIONS: EP121625-XX

BATCH NUMBER: 377080

RED SAMPLES TESTED POSITIVE FOR ASBESTOS

SUSPECT ASBESTOS-CONTAINING MATERIAL SAMPLE LOCATION PLAN

ASBESTOS SURVEY FOR BUILDING DEMOLITION (I-80)
607 WATER STREET
JOLIET, IL 60436



DRAWN BY:	PROJECT:
EP	21-2007
CHECKED BY:	SCALE:
KB	NTS
DATE:	SHEET #:
12/22/25	2 OF 3

SHEET NAME:

SL-2

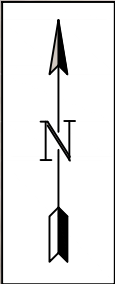

SUSPECT ASBESTOS-CONTAINING MATERIAL SAMPLE LOCATION PLAN

ASBESTOS SURVEY FOR BUILDING DEMOLITION (I-80)
607 WATER STREET
JOLIET, IL, 60436

GSG CONSULTANTS, INC.
1875 E. RIVERVIEW AVE., SUITE 100, JOLIET, IL 60436
TEL: 815/741-1000 FAX: 815/741-1002
ILLINOIS PROFESSIONAL DESIGN FIRM 18-000002

DRAWN BY:	PROJECT:
EP	21-2007
CHECKED BY:	SCALE:
KB	NTS
DATE:	SHEET #:
12/23/25	3 OF 3
SHEET NAME:	

SL-3

LEGEND

SUSPECT ACM SAMPLE LOCATIONS: EP121625-XX
BATCH NUMBER: 377080

EXHIBIT 2

ACM-1, ACM-2 ACM Location Plans



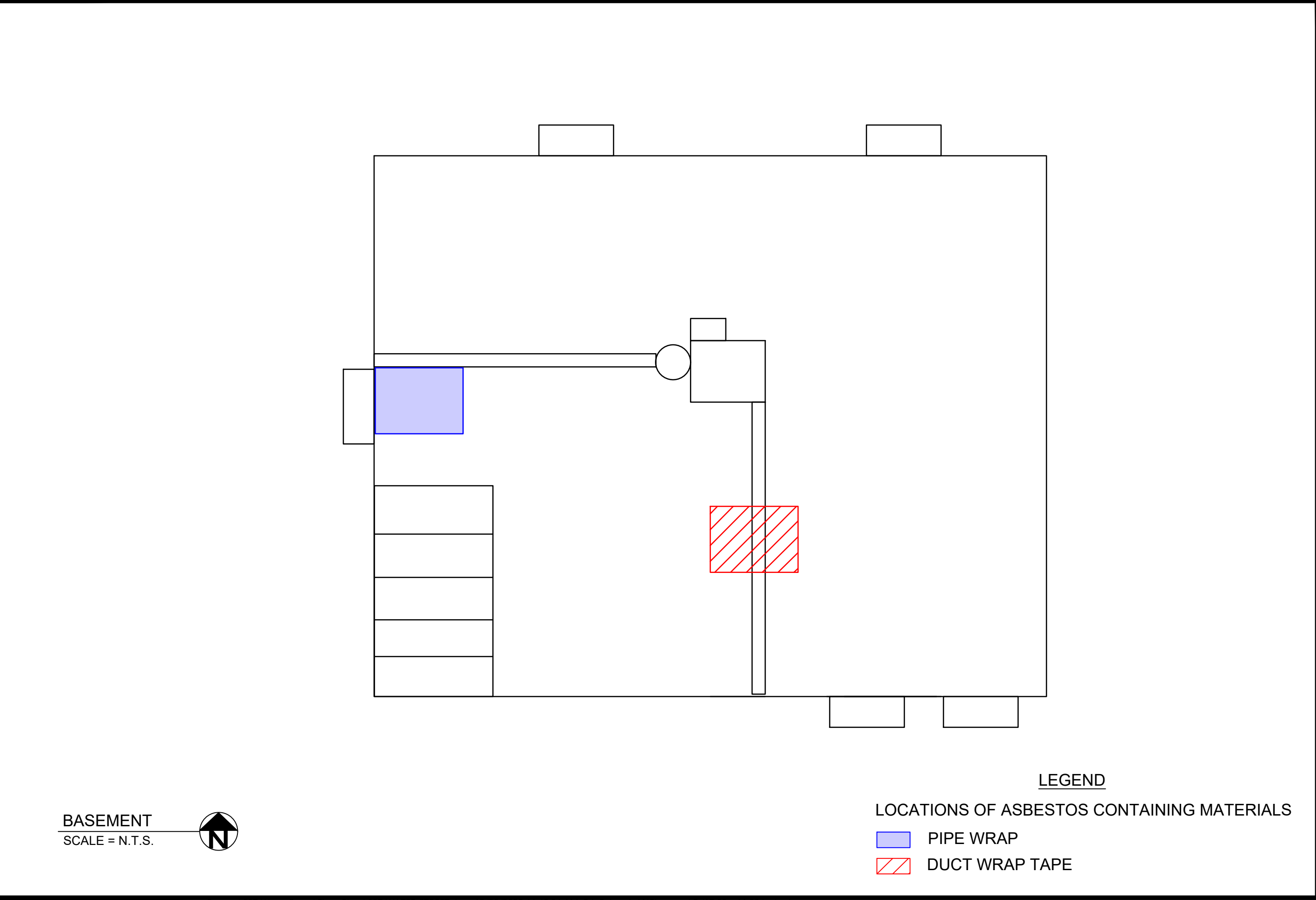

ASBESTOS-CONTAINING MATERIAL LOCATION PLAN

ASBESTOS SURVEY FOR BUILDING DEMOLITION (I-80)
607 WATER STREET
JOLIET, IL 60436

GSG CONSULTANTS, INC.
732 E. BIRMINGHAM AVE., SUITE 200, JOLIET, IL 60436
TEL: 815/741-1111 FAX: 815/741-1112
ILLINOIS PROFESSIONAL DESIGN FIRM 18-000882

DRAWN BY:	PROJECT:
EP	21-2007
CHECKED BY:	SCALE:
KB	NTS
DATE:	SHEET #:
12/22/25	2 OF 2
SHEET NAME:	
ACM-2	

APPENDIX A

Analytical Testing Results

ASBESTOS ANALYSIS BY POLARIZED LIGHT MICROSCOPY

Method: EPA/600/R-93/116

GSG Consultants, Inc.
 735 Remington Road
 Schaumburg, IL 60173
 Phone: (630) 994-2600
 Fax: (312) 733-5612

Reference:	I-80 Over Des Plaines	Date Received:	12/16/2025
Location:	607 Water Street, Joliet, IL	Date Analyzed:	12/21/2025
Batch No.:	377080	Date Reported:	12/21/2025
Customer No.:	4651	Turn Around Time:	5 Days

Laboratory Sample	Customer Sample Number	Asbestos Components (%)	Non-Asbestos Components (%)
377080001	EP121625-1	ND	Cellulose 10-15% Binder 85-90%
377080002	EP121625-2	ND	Cellulose 10-15% Binder 85-90%
377080003	EP121625-3	ND	Cellulose 10-15% Binder 85-90%
377080004	EP121625-4	ND	Cellulose 1-5% Binder 95-99%
377080005	EP121625-5	ND	Cellulose 1-5% Binder 95-99%
377080006	EP121625-6	ND	Cellulose 1-5% Binder 95-99%
377080007	EP121625-7	ND	Cellulose 1-5% Binder 95-99%
377080008	EP121625-8	ND	Cellulose 1-5% Binder 95-99%
377080009	EP121625-9	ND	Cellulose 1-5% Binder 95-99%
377080010	EP121625-10	Chrysotile 15-20%	Binder 80-85%
377080011	EP121625-11	NA	

ND = Asbestos Not Detected (Not Present) NA = Not Analyzed NS = Not Submitted

Components of inhomogeneous samples are analyzed per our Standard Operating Procedure, or per customer request.

The use of the NVLAP logo does not imply endorsement by NVLAP or any agency of the US Government.

The information contained in this report and any attachments is confidential information intended only for the use of the individual or entities named above. The results of this report relate only to the samples tested. If you have received this report in error, please notify us immediately by phone. This report shall not be reproduced, except in its entirety, unless written approval has been obtained from the laboratory. This report remains property of STAT Analysis until payment is received in full (see invoice).

Analyzed by Name :

 Daniel Mikos / Microscopy Manager

Date: 12/21/2025

ASBESTOS ANALYSIS BY POLARIZED LIGHT MICROSCOPY

Method: EPA/600/R-93/116

GSG Consultants, Inc.
 735 Remington Road
 Schaumburg, IL 60173
 Phone: (630) 994-2600
 Fax: (312) 733-5612

Reference:	I-80 Over Des Plaines	Date Received:	12/16/2025
Location:	607 Water Street, Joliet, IL	Date Analyzed:	12/21/2025
Batch No.:	377080	Date Reported:	12/21/2025
Customer No.:	4651	Turn Around Time:	5 Days

Laboratory Sample	Customer Sample Number	Asbestos Components (%)	Non-Asbestos Components (%)
377080012	EP121625-12	NA	
377080013	EP121625-13	ND	Cellulose 1-5% Binder 95-99%
377080014	EP121625-14	ND	Cellulose 1-5% Binder 95-99%
377080015	EP121625-15	ND	Cellulose 1-5% Binder 95-99%
377080016	EP121625-16	ND	Cellulose 1-5% Binder 95-99%
377080017	EP121625-17	ND	Cellulose 1-5% Binder 95-99%
377080018	EP121625-18	ND	Cellulose 1-5% Binder 95-99%
377080019	EP121625-19	Chrysotile 60-65%	Binder 35-40%
377080020	EP121625-20	NA	
377080021	EP121625-21	NA	
377080022	EP121625-22	Chrysotile 60-65%	Binder 35-40%
377080023	EP121625-23	NA	
377080024	EP121625-24	NA	

ND = Asbestos Not Detected (Not Present) NA = Not Analyzed NS = Not Submitted

Components of inhomogeneous samples are analyzed per our Standard Operating Procedure, or per customer request.

The use of the NVLAP logo does not imply endorsement by NVLAP or any agency of the US Government.

The information contained in this report and any attachments is confidential information intended only for the use of the individual or entities named above. The results of this report relate only to the samples tested. If you have received this report in error, please notify us immediately by phone. This report shall not be reproduced, except in its entirety, unless written approval has been obtained from the laboratory. This report remains property of STAT Analysis until payment is received in full (see invoice).

Analyzed by Name :



ASBESTOS ANALYSIS BY POLARIZED LIGHT MICROSCOPY

Method: EPA/600/R-93/116

GSG Consultants, Inc.
735 Remington Road
Schaumburg, IL 60173
Phone: (630) 994-2600
Fax: (312) 733-5612

Reference: I-80 Over Des Plaines Date Received: 12/16/2025
Location: 607 Water Street, Joliet, IL Date Analyzed: 12/21/2025
Batch No.: 377080 Date Reported: 12/21/2025
Customer No.: 4651 Turn Around Time: 5 Days

Laboratory Sample	Customer Sample Number	Asbestos Components (%)	Non-Asbestos Components (%)
377080025	EP121625-25	ND	Cellulose 1-5% Binder 95-99%
377080026	EP121625-26	ND	Cellulose 1-5% Binder 95-99%
377080027	EP121625-27	ND	Cellulose 1-5% Binder 95-99%
377080028	EP121625-28	ND	Cellulose 80-85% Binder 15-20%
377080029	EP121625-29	ND	Cellulose 80-85% Binder 15-20%
377080030	EP121625-30	ND	Cellulose 80-85% Binder 15-20%
377080031	EP121625-31 Layer 1	ND	Binder 85-90% Glass 10-15%
377080032	EP121625-32 Layer 1	ND	Binder 85-90% Glass 10-15%
377080033	EP121625-33 Layer 1	ND	Binder 85-90% Glass 10-15%
377080034	EP121625-31 Layer 2	ND	Binder 85-90% Glass 10-15%

ND = Asbestos Not Detected (Not Present) NA = Not Analyzed NS = Not Submitted

Components of inhomogeneous samples are analyzed per our Standard Operating Procedure, or per customer request.

The use of the NVLAP logo does not imply endorsement by NVLAP or any agency of the US Government.

The information contained in this report and any attachments is confidential information intended only for the use of the individual or entities named above. The results of this report relate only to the samples tested. If you have received this report in error, please notify us immediately by phone. This report shall not be reproduced, except in its entirety, unless written approval has been obtained from the laboratory. This report remains property of STAT Analysis until payment is received in full (see invoice).

Analyzed by Name :

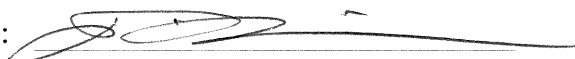

ASBESTOS ANALYSIS BY POLARIZED LIGHT MICROSCOPY

Method: EPA/600/R-93/116

GSG Consultants, Inc.
735 Remington Road
Schaumburg, IL 60173
Phone: (630) 994-2600
Fax: (312) 733-5612

Reference: I-80 Over Des Plaines Date Received: 12/16/2025
Location: 607 Water Street, Joliet, IL Date Analyzed: 12/21/2025
Batch No.: 377080 Date Reported: 12/21/2025
Customer No.: 4651 Turn Around Time: 5 Days

Laboratory Sample	Customer Sample Number	Asbestos Components (%)	Non-Asbestos Components (%)
377080035	EP121625-32 Layer 2	ND	Binder 85-90% Glass 10-15%
377080036	EP121625-33 Layer 2	ND	Binder 85-90% Glass 10-15%
377080037	EP121625-31 Layer 3	ND	Binder 85-90% Glass 10-15%
377080038	EP121625-32 Layer 3	ND	Binder 85-90% Glass 10-15%
377080039	EP121625-33 Layer 3	ND	Binder 85-90% Glass 10-15%
377080040	EP121625-34	ND	Cellulose 1-5% Binder 95-99%
377080041	EP121625-35	ND	Cellulose 1-5% Binder 95-99%
377080042	EP121625-36	ND	Cellulose 1-5% Binder 95-99%
377080043	EP121625-37	ND	Cellulose 1-5% Binder 95-99%
377080044	EP121625-38	ND	Cellulose 1-5% Binder 95-99%

ND = Asbestos Not Detected (Not Present) NA = Not Analyzed NS = Not Submitted

Components of inhomogeneous samples are analyzed per our Standard Operating Procedure, or per customer request.

The use of the NVLAP logo does not imply endorsement by NVLAP or any agency of the US Government.

The information contained in this report and any attachments is confidential information intended only for the use of the individual or entities named above. The results of this report relate only to the samples tested. If you have received this report in error, please notify us immediately by phone. This report shall not be reproduced, except in its entirety, unless written approval has been obtained from the laboratory. This report remains property of STAT Analysis until payment is received in full (see invoice).

Analyzed by Name :



ASBESTOS ANALYSIS BY POLARIZED LIGHT MICROSCOPY

Method: EPA/600/R-93/116

GSG Consultants, Inc.
735 Remington Road
Schaumburg, IL 60173
Phone: (630) 994-2600
Fax: (312) 733-5612

Reference:	I-80 Over Des Plaines	Date Received:	12/16/2025
Location:	607 Water Street, Joliet, IL	Date Analyzed:	12/21/2025
Batch No.:	377080	Date Reported:	12/21/2025
Customer No.:	4651	Turn Around Time:	5 Days

Laboratory Sample	Customer Sample Number	Asbestos Components (%)	Non-Asbestos Components (%)
377080045	EP121625-39	ND	Cellulose 1-5% Binder 95-99%

ND = Asbestos Not Detected (Not Present) NA = Not Analyzed NS = Not Submitted

Components of inhomogeneous samples are analyzed per our Standard Operating Procedure, or per customer request.

The use of the NVLAP logo does not imply endorsement by NVLAP or any agency of the US Government.

The information contained in this report and any attachments is confidential information intended only for the use of the individual or entities named above. The results of this report relate only to the samples tested. If you have received this report in error, please notify us immediately by phone. This report shall not be reproduced, except in its entirety, unless written approval has been obtained from the laboratory. This report remains property of STAT Analysis until payment is received in full (see invoice).

Analyzed by Name :

Daniel Mikos / Microscopy Manager



GSG CONSULTANTS, INC.

Engineering and Industrial Hygiene Services

735 Remington Road

Schaumburg, IL 60173

(630) 994-2600 Fax: (312) 733-5612

www.gsg-consultants.com

Page 1 of 3

377080

PLM BULK LABORATORY ANALYSIS FORM

Project Name: 180 over Desplaines		Project Manager: Kyle Boyd	
Project Number:		Building Inspector: Erin Pahomi	
Project Address: 607 Water Street		IDPH Number:	
City/State: Joliet, IL		Work Day: S M (T) W TH F S	
Client: WSP		Analyze by Method:	
Date: 12/16/25		EPA/600/R-93-116	

Field Number	HA Number	Type of material, specific sample location (i.e. Room Number, Building Construction Date)
EP121625-1	1	Drywall system - Kitchen
-2	1	- Living room
-3	1	- Bedroom Bathroom
-4	2	Plaster - Bedroom
-5	1	- Living room
-6	1	- Kitchen
-7	3	stone pattern linoleum - Kitchen
-8	1	
-9	1	
-10	4	red flooring - Basement Stair
-11	1	
-12	1	
-13	5	chimney brick - Basement
-14	1	
-15	1	

TURN AROUND TIME:	1 Day	COMMENTS: E-mail Results to: epahomi@gsg-consultants.com
	2 Days	
(5 Day) Other	3 Days	

CHAIN OF CUSTODY RECORD

Collected By (Signature)	Date: 12/16/25	Time:	Relinquished by (Signature)	Date: 12/16/25	Time: 2:40
Received by: (Signature)	Date:	Time:	Relinquished by: (signature)	Date:	Time:
Dispatched by: (Signature, if mailed)	Date:	Time:	Received for Laboratory by:	Date: 12/16/25	Time: 13:40

Definitions: BLK-Bulk Sample, PLM-Polarized Light Microscopy, TEM-Transmission Electron Microscope.



GSG CONSULTANTS, INC.

Engineering and Industrial Hygiene Services

735 Remington Road

Schaumburg, IL 60173

(630) 994-2600 Fax: (312) 733-5612

www.gsg-consultants.com

Page 2 of 3

377 080

PLM BULK LABORATORY ANALYSIS FORM

Project Name:		Project Manager:	
Project Number:		Building Inspector:	
Project Address:		IDPH Number:	
City/ State:		Work Day: S M T W TH F S	
Client:		Analyze by Method:	
Date:		EPA/600/R-93-116	

Field Number	HA Number	Type of material, specific sample location (i.e. Room Number, Building Construction Date)
EP121625-16	6	Duct seal Basement
17	1	
18	1	
19	7	pipe wrap
20	9	
21	1	
22	80	Duct wrap tape
23	1	
24	1	
25	9	Window glazing
26	1	
27	1	
28	10	Attic insulation
29	1	
30	1	

TURN AROUND TIME: <input checked="" type="radio"/> (5 Day) Other	1 Day 2 Days 3 Days	COMMENTS: E-mail Results to: twalsh@gsg-consultants.com epahomi@gsg-consultants.com STOP AT FIRST POSITIVE

CHAIN OF CUSTODY RECORD

Collected By(Signature) <i>epahomi</i>	Date: 12/16/25	Time:	Relinquished by (Signature) <i>Michael Hef</i>	Date: 12/16/25	Time: 2:41
Received by: (Signature)	Date:	Time:	Relinquished by: (signature)	Date:	Time:
Dispatched by: (Signature, if mailed)	Date:	Time:	Received for laboratory by: <i>Michael Hef</i>	Date: 12/16/25	Time: 13:40

Definitions: BLK-Bulk Sample, PLM-Polarized Light Microscopy, TEM-Transmission Electron Microscope.

377080

PLM BULK LABORATORY ANALYSIS FORM

Project Name:		Project Manager:	
Project Number:		Building Inspector:	
Project Address:		IDPH Number:	
City/ State:		Work Day: S M T W TH F S	
Client:		Analyze by Method: EPA/600/R-93-116	
Date:			
Field Number	HA Number	Type of material, specific sample location (i.e. Room Number, Building Construction Date)	
EPA 1625-31	11	Roofing material (3 layers)	
32	1	1	
33			
34	12	Brick mortar	
35	1	1	
36			
37	13	Exterior window caulking	
38	1		
-39			
TURN AROUND TIME:		COMMENTS: E-mail Results to: epahomi@gsg-consultants.com	
1 Day		STOP AT FIRST POSITIVE	
2 Days			
3 Days			
(5 Day) Other			

CHAIN OF CUSTODY RECORD

Collected By(Signature) <i>[Signature]</i>	Date: <i>12/16/25</i>	Time:	Relinquished by (Signature) <i>[Signature]</i>	Date: <i>12/16/25</i>	Time: <i>2:41</i>
Received by: (Signature)	Date:	Time:	Relinquished by: (signature)	Date:	Time:
Dispatched by: (Signature, if mailed)	Date:	Time:	Received for Laboratory by: <i>[Signature]</i>	Date: <i>12/16/25</i>	Time: <i>13:40</i>

Definitions: BLK-Bulk Sample, PLM-Polarized Light Microscopy, TEM-Transmission Electron Microscope.

APPENDIX B

Reference Photographs



Material Description:
Drywall System (Drywall,
Tape, & Compound)

Photo Location:
Living Room

**ILLINOIS DEPARTMENT OF
TRANSPORTATION
I-80 OVER DES PLAINES RIVER BRIDGE
IMPROVEMENTS**



GSG Consultants, Inc.
735 Remington Road
Schaumburg, Illinois 60173

Date: 12/16/25



Material Description:
Stone Pattern Linoleum

Photo Location:
Kitchen

**ILLINOIS DEPARTMENT OF
TRANSPORTATION
I-80 OVER DES PLAINES RIVER BRIDGE
IMPROVEMENTS**



GSG Consultants, Inc.
735 Remington Road
Schaumburg, Illinois 60173

Date: 12/16/25



Material Description:
Red Flooring - **Tested
Positive for Asbestos**

Photo Location:
Basement Stairs

**ILLINOIS DEPARTMENT OF
TRANSPORTATION
I-80 OVER DES PLAINES RIVER BRIDGE
IMPROVEMENTS**



GSG Consultants, Inc.
735 Remington Road
Schaumburg, Illinois 60173

Date: 12/16/25



Material Description:
Plaster

Photo Location:
Bedroom

**ILLINOIS DEPARTMENT OF
TRANSPORTATION
I-80 OVER DES PLAINES RIVER BRIDGE
IMPROVEMENTS**



GSG Consultants, Inc.
735 Remington Road
Schaumburg, Illinois 60173

Date: 12/16/25



Material Description:
Duct Seal & Chimney Brick

Photo Location:
Basement

**ILLINOIS DEPARTMENT OF
TRANSPORTATION
I-80 OVER DES PLAINES RIVER BRIDGE
IMPROVEMENTS**



GSG Consultants, Inc.
735 Remington Road
Schaumburg, Illinois 60173

Date: 12/16/25



Material Description:
Pipe Wrap - **Tested
Positive For Asbestos**





Photo Location:
Basement

**ILLINOIS DEPARTMENT OF
TRANSPORTATION
I-80 OVER DES PLAINES RIVER BRIDGE
IMPROVEMENTS**



GSG Consultants, Inc.
735 Remington Road
Schaumburg, Illinois 60173

Date: 12/16/25

	Material Description: Duct Wrap Tape - Tested Positive For Asbestos	
	Photo Location: Basement	
ILLINOIS DEPARTMENT OF TRANSPORTATION I-80 OVER DES PLAINES RIVER BRIDGE IMPROVEMENTS	 GSG Consultants, Inc. 735 Remington Road Schaumburg, Illinois 60173	Date: 12/16/25
	Material Description: Window Glazing	
	Photo Location: Basement	
ILLINOIS DEPARTMENT OF TRANSPORTATION I-80 OVER DES PLAINES RIVER BRIDGE IMPROVEMENTS	 GSG Consultants, Inc. 735 Remington Road Schaumburg, Illinois 60173	Date: 12/16/25



Material Description:
Brick Mortar

Photo Location:
Exterior

**ILLINOIS DEPARTMENT OF
TRANSPORTATION
I-80 OVER DES PLAINES RIVER
BRIDGE IMPROVEMENTS**



GSG Consultants, Inc.
735 Remington Road
Schaumburg, Illinois 60173

Date: 12/16/25



Material Description:
Exterior Window Caulking



Photo Location:
Exterior

**ILLINOIS DEPARTMENT OF
TRANSPORTATION
I-80 OVER DES PLAINES RIVER
BRIDGE IMPROVEMENTS**



GSG Consultants, Inc.
735 Remington Road
Schaumburg, Illinois 60173

Date: 12/16/25

		Material Description: Attic Insulation
		Photo Location: Attic
ILLINOIS DEPARTMENT OF TRANSPORTATION I-80 OVER DES PLAINES RIVER BRIDGE IMPROVEMENTS	 GSG Consultants, Inc. 735 Remington Road Schaumburg, Illinois 60173	Date: 12/16/25

APPENDIX C

Inspector Licenses and Training Certifications

ERIN PAHOMI
1016 N PLUM GROVE APT 316
SCHAUMBURG, IL 60173

5/28/2025

ASBESTOS PROFESSIONAL LICENSE ID NUMBER: 20674

Enclosed is your Asbestos Professional License. Please note the expiration date on the card and in the image depicted below.

COPY OF THE ASBESTOS PROFESSIONAL LICENSE

Front of License

Back of License



ASBESTOS
PROFESSIONAL
LICENSE

ENDORSEMENTS

TC EXPIRES

INSPECTOR

1/18/2026

ID NUMBER

ISSUED

EXPIRES

100 - 20674

5/28/2025

05/15/2026

ERIN PAHOMI

1016 N PLUM GROVE APT 316
SCHAUMBURG, IL 60173

Environmental Health



Alteration of this license shall result in legal action
This license issued under authority of the State of Illinois
Department of Public Health
This license is valid only when accompanied by a valid
training course certificate.

If you have any questions or need further assistance, contact the Asbestos Program at (217)782-3517 or 1-800-85-5897.

Web address is: dph.illinois.gov/topics-services/environmental-health-protection/asbestos
Email Address: dph.asbestos@illinois.gov

PROTECTING HEALTH, IMPROVING LIVES

Nationally Accredited by PHAB



OCCUPATIONAL TRAINING & SUPPLY, INC.

2025

7233 S. Adams Street | Willowbrook, IL 60527 (630) 655-3900 | www.otssafety.com

Asbestos Building Inspector Refresher

Occupational Training & Supply, Inc. certifies that

Erin Pahomi

has successfully completed the Asbestos Building Inspector Refresher course and has passed the competency exam with a minimum score of 70%. The course is accredited by the Illinois Department of Public Health and Indiana Department of Environmental Management for purposes of accreditation in accordance with EPA 40 CFR 763, Asbestos Hazard Emergency Response Act (AHERA) and TSCA Title II.

Course Date: 1/18/2025

Exam Date: 1/18/2025

Expiration Date: 1/18/2026

Certificate Number: BIR2501180283

Course Credit Hours: BIR 4 Hours

Kristina Miczek, Training Manager

APPENDIX D

Laboratory Accreditations

United States Department of Commerce
National Institute of Standards and Technology



Certificate of Accreditation to ISO/IEC 17025:2017

NVLAP LAB CODE: 101202-0

STAT Analysis Corporation
Chicago, IL

*is accredited by the National Voluntary Laboratory Accreditation Program for specific services,
listed on the Scope of Accreditation, for:*

Asbestos Fiber Analysis

*This laboratory is accredited in accordance with the recognized International Standard ISO/IEC 17025:2017.
This accreditation demonstrates technical competence for a defined scope and the operation of a laboratory quality
management system (refer to joint ISO-ILAC-IAF Communique on ISO/IEC 17025).*

2025-07-01 through 2026-06-30
Effective Dates



For the National Voluntary Laboratory Accreditation Program

SCOPE OF ACCREDITATION TO ISO/IEC 17025:2017

STAT Analysis Corporation

Sterling Labs
2242 W. Harrison Suite 200
Chicago, IL 60612
Joseph Gusek
Phone: 312-733-0551
Email: jgusek@thesterlinglab.com
www.thesterlinglab.com

ASBESTOS FIBER ANALYSIS

NVLAP LAB CODE 101202-0

Bulk Asbestos Analysis

<u>Code</u>	<u>Description</u>
18/A01	EPA -- 40 CFR Appendix E to Subpart E of Part 763, Interim Method of the Determination of Asbestos in Bulk Insulation Samples
18/A03	EPA 600/R-93/116: Method for the Determination of Asbestos in Bulk Building Materials

Airborne Asbestos Analysis

<u>Code</u>	<u>Description</u>
18/A02	U.S. EPA's "Interim Transmission Electron Microscopy Analytical Methods-Mandatory and Nonmandatory-and Mandatory Section to Determine Completion of Response Actions" as found in 40 CFR, Part 763, Subpart E, Appendix A.



For the National Voluntary Laboratory Accreditation Program