

**TYPICAL ENTRANCE/EXIT RAMP COMBINATION PAVEMENT MARKINGS**

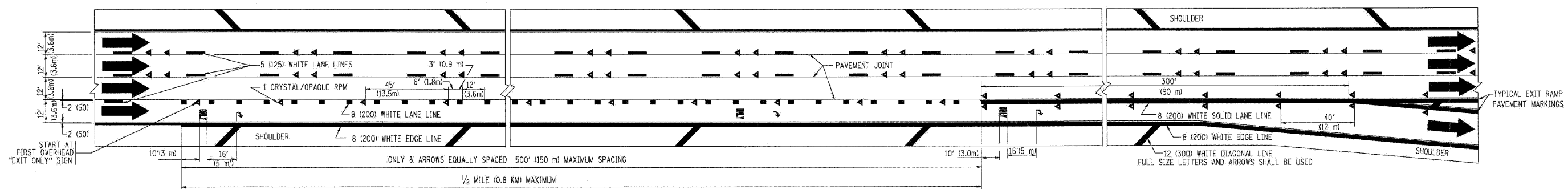

**TYPICAL EXIT ONLY LANE PAVEMENT MARKINGS**

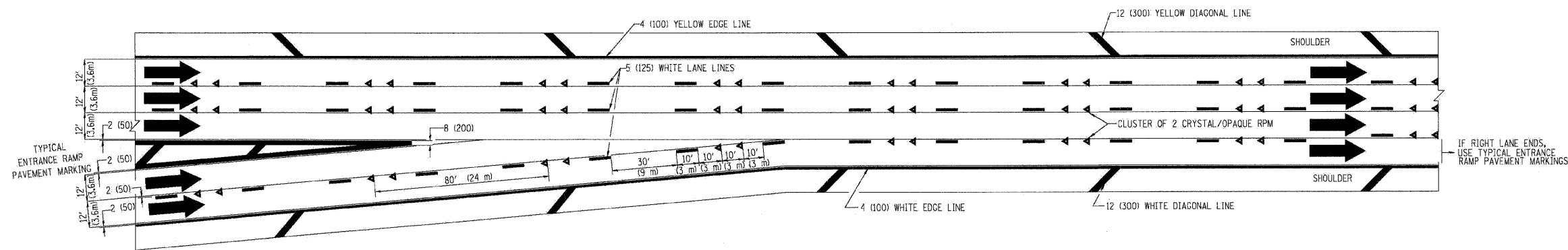

**TYPICAL TWO LANE ENTRANCE RAMP PAVEMENT MARKINGS**

FILE NAME = ...prpln-ABC-C2-D1-TC-12B.dgn	DESIGNED - AJP	REVISED -	<b>benesch</b>	<b>STATE OF ILLINOIS DEPARTMENT OF TRANSPORTATION</b>	<b>MULTI-LANE FREEWAY PAVEMENT MARKING</b>		F.A.I. RTE. 290	SECTION (3131, ETC., 3435)RS-6	COUNTY COOK	TOTAL SHEETS 215	SHEET NO. 211	
USER NAME = tblank	DRAWN - TMB	REVISED -			SCALE: N.T.S.	SHEET NO. 12 OF 16 SHEETS	STA.	TO STA.	FED. ROAD DIST. NO. [ILLINOIS] FED. AID PROJECT		CONTRACT NO. 60K10	
PLOT DATE = 1/25/2010	CHECKED - JMM	REVISED -										
	DATE - 1/25/10	REVISED -										