

DES PLAINES RIVER

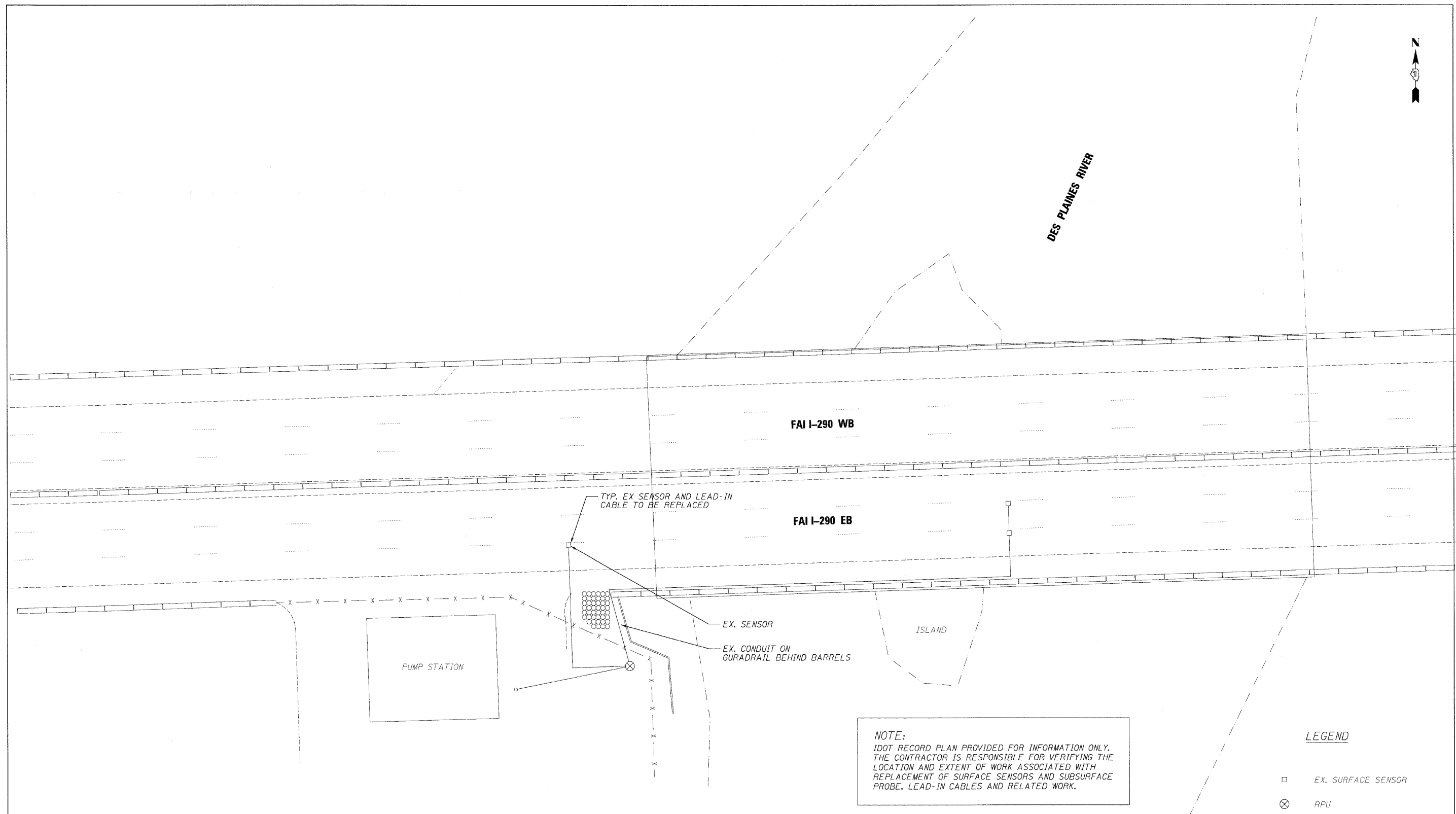

ROADWAY WEATHER INFORMATION SYSTEM (RWIS)
 I-290 OVER DES PLAINES RIVER
 SCALE: 1 INCH = 20 FEET FOREST PARK, IL

| | | |
|----------------------------------|----------------|-----------|
| FILE NAME = | DESIGNED - GHT | REVISED - |
| ...Signals\prpIn_ABC.C2_HIDS.dgn | DRAWN - TMB | REVISED - |
| USER NAME = tblank | CHECKED - MPM | REVISED - |
| PLOT DATE = 1/25/2010 | DATE - 1/25/10 | REVISED - |

benesch

STATE OF ILLINOIS
 DEPARTMENT OF TRANSPORTATION

| ROADWAY WEATHER INFORMATION SYSTEM SENSOR | | | |
|---|-------------------------|------|---------|
| SCALE: N.T.S. | SHEET NO. 1 OF 9 SHEETS | STA. | TO STA. |

| F.A.I. RTE. | SECTION | COUNTY | TOTAL SHEETS | SHEET NO. |
|---|-----------------------|--------|--------------------|-----------|
| 290 | 13131, ETC., 3435RS-6 | COOK | 215 | 174 |
| FED. ROAD DIST. NO. ILLINOIS FED. AID PROJECT | | | CONTRACT NO. 60K10 | |