

DATE	
BY	
FINAL SURVEY	
PLOTTED	
NOTE BOOK	
AREAS CHECKED	
NO.	

DATE	
BY	
ORIGINAL SURVEY	
PLOTTED	
NOTE BOOK	
AREAS CHECKED	
NO.	

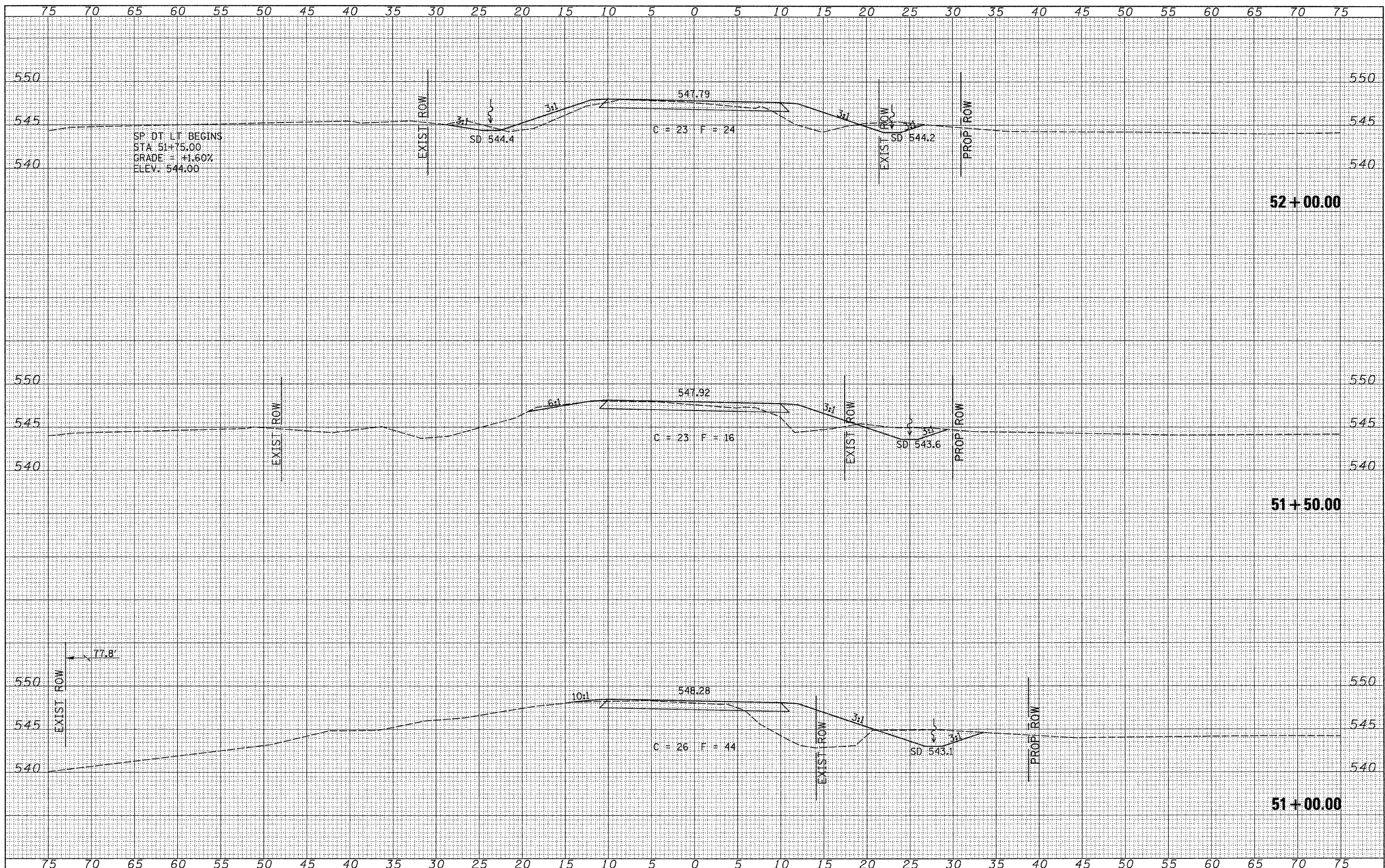

SP. DT. LT. BEGINS
 STA. 51+75.00
 GRADE = +1.60%
 ELEV. 544.00

52+00.00

51+50.00

51+00.00

FILE NAME = V:\Bridges\2800 - Pike\2800\shsta.dgn	USER NAME = cthomas	DESIGNED -	REVISED -	PIKE COUNTY TOWNSHIP ROAD 359 OVER HONEY CREEK	CROSS SECTIONS			RTE.	SECTION	COUNTY	TOTAL SHEETS	SHEET NO.
		DRAWN -	REVISED -		TR 359	09-1113-00-BR	PIKE	28	27			
		CHECKED -	REVISED -		CONTRACT NO. 93546							
		DATE -	REVISED -		SCALE: 1"=5'-0"	SHEET NO. 11 OF 12 SHEETS	STA. 51+00.00 TO STA. 52+00.00	FED. ROAD DIST. NO. 7	ILLINOIS	FED. AID PROJECT BR05-0149041		