

Nov-03-2010 11:13:55 AM

Notes:
See sheet 13 of 23 for Sections C-C & D-D and View E-E.
a₄(E) and a₅(E) bar spacings measured along ϕ Rdwy.

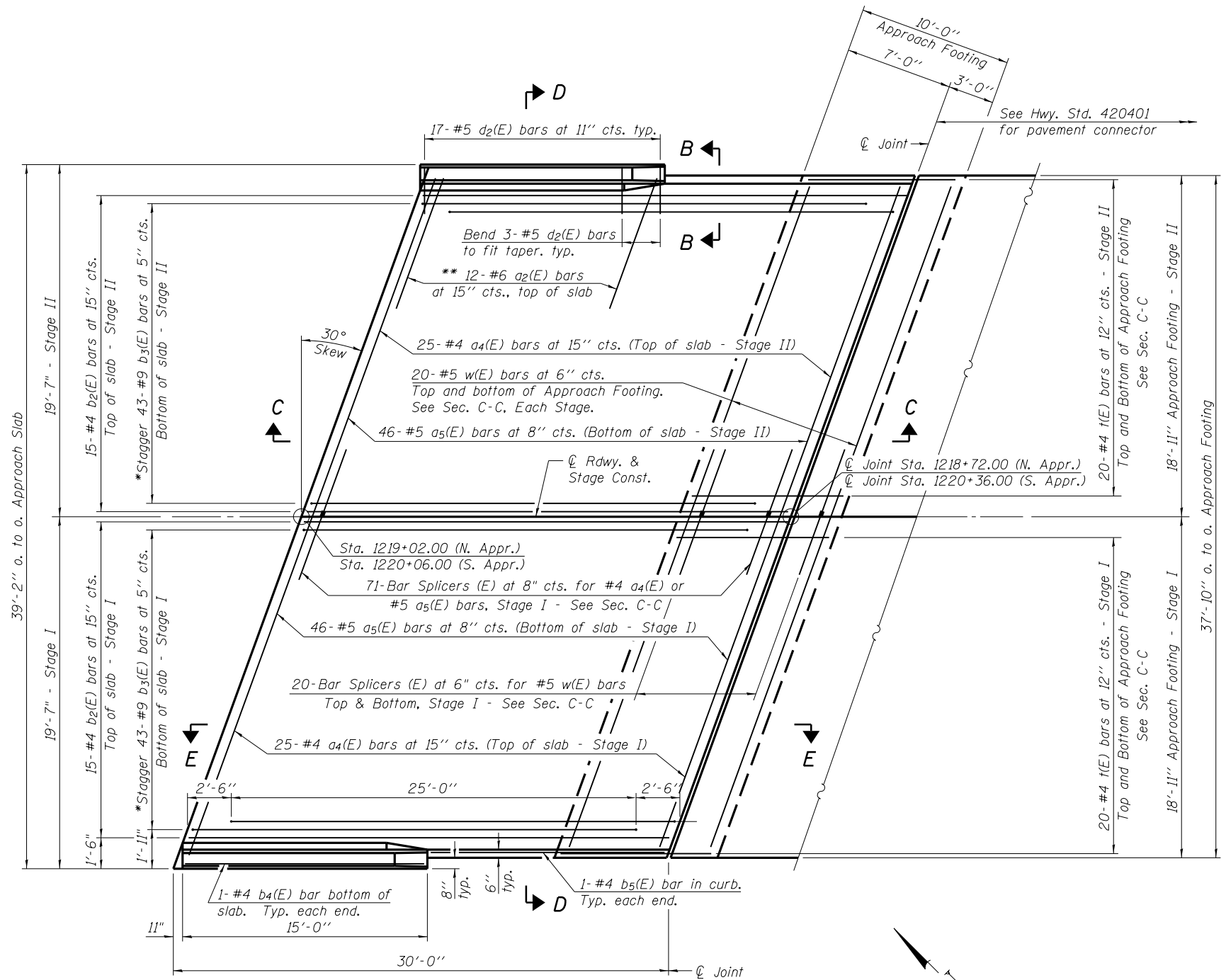

PLAN

* Tilt #9 b₃(E) bars as required to maintain clearance.
** Space between a₄(E) bars, typ. each parapet.

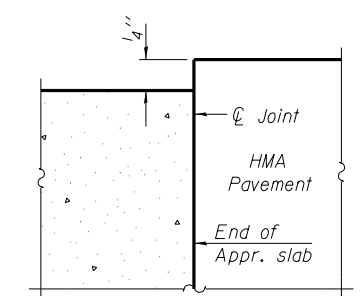

FLEXIBLE PAVEMENT

DETAIL A

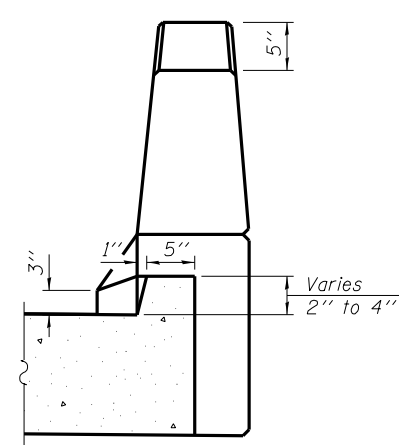

VIEW B-B

FILE \$

FILE NAME =	USER NAME =	DESIGNED RJP	REVISED -	STATE OF ILLINOIS DEPARTMENT OF TRANSPORTATION	BRIDGE APPROACH SLAB DETAILS (SHEET 1 of 2) STRUCTURE NO. 034-0528	F.A.P. RTE.	SECTION	COUNTY	TOTAL SHEETS	SHEET NO.	
		CHECKED ADL	REVISED -			685	(117,118)RS-4,119RS-1; 118B-1	HANCOCK	101	54	
		PLOT SCALE =	DRAWN RJP			REVISED -	CONTRACT NO. 72B05				
		PLOT DATE =	CHECKED ADL			REVISED -	ILLINOIS FED. AID PROJECT				

Klingner & Associates P.C.