

EAST EDGE OF SHOULDER

Location	Station	Offset	Theoretical Grade Elevations
N. End North Appr. Slab	1218+82.39	-18.00	666.81
A1	1218+92.39	-18.00	666.84
A2	1219+02.39	-18.00	666.88
S. End North Appr. Slab	1219+12.39	-18.00	666.90

EAST EDGE OF PAVEMENT

Location	Station	Offset	Theoretical Grade Elevations
N. End North Appr. Slab	1218+78.93	-12.00	666.92
A1	1218+88.93	-12.00	666.96
A2	1218+98.93	-12.00	666.99
S. End North Appr. Slab	1219+08.93	-12.00	667.02

☉ ROADWAY & PROFILE GRADE

Location	Station	Offset	Theoretical Grade Elevations
N. End North Appr. Slab	1218+72.00	0.00	667.07
A1	1218+82.00	0.00	667.12
A2	1218+92.00	0.00	667.15
S. End North Appr. Slab	1219+02.00	0.00	667.19

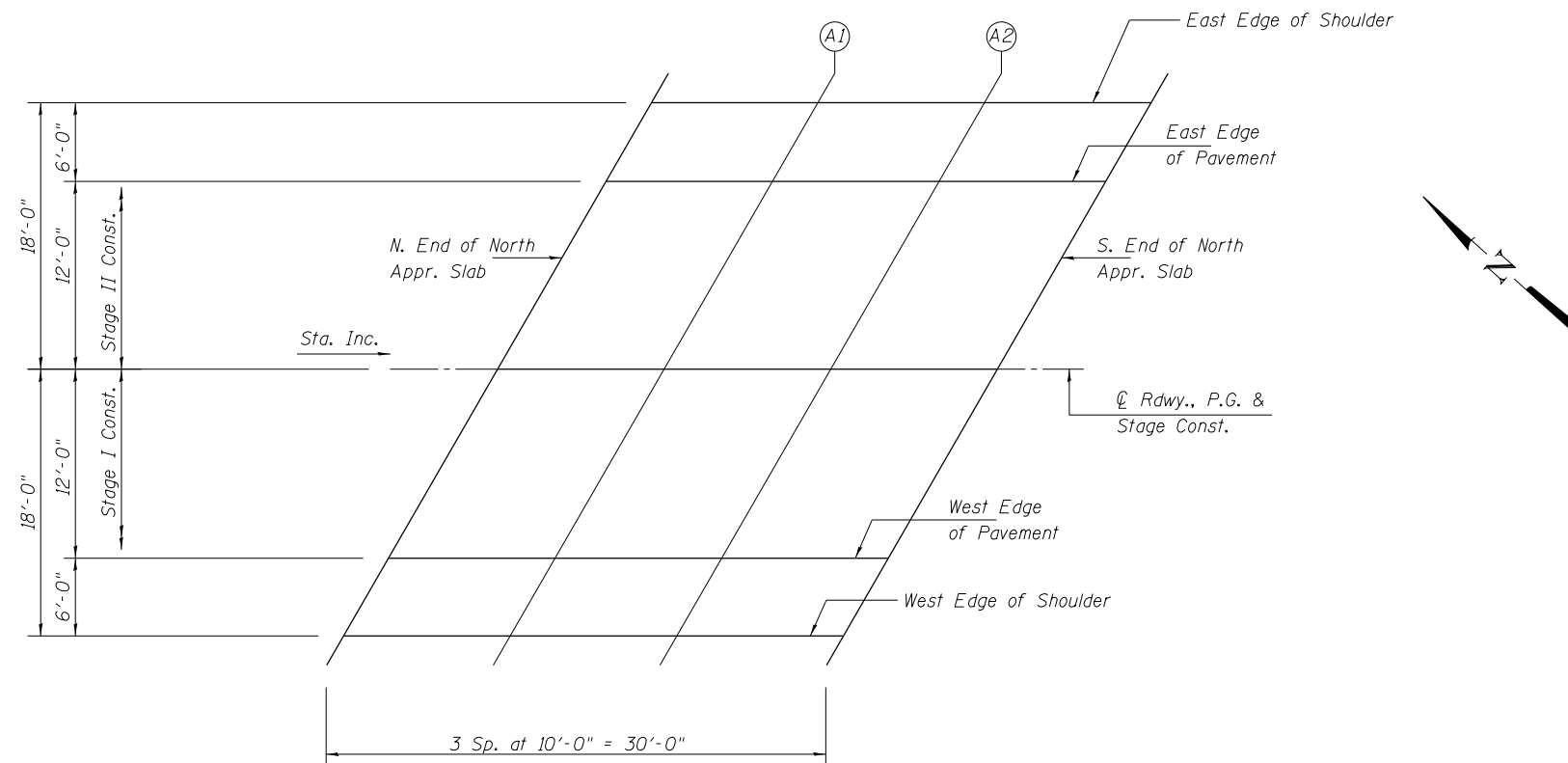

PLAN

WEST EDGE OF PAVEMENT

Location	Station	Offset	Theoretical Grade Elevations
N. End North Appr. Slab	1218+65.07	12.00	666.85
A1	1218+75.07	12.00	666.90
A2	1218+85.07	12.00	666.94
S. End North Appr. Slab	1218+95.07	12.00	666.98

WEST EDGE OF SHOULDER

Location	Station	Offset	Theoretical Grade Elevations
N. End North Appr. Slab	1218+61.61	18.00	666.71
A1	1218+71.61	18.00	666.76
A2	1218+81.61	18.00	666.80
S. End North Appr. Slab	1218+91.61	18.00	666.84