

F.A.P. RTE.	SECTION	COUNTY	TOTAL SHEETS	SHEET NO.
704	(J)N & TS-1	McLEAN	497	133
STA. 2+200.000		TO STA. 2+450.000		
FED. ROAD DIST. NO.		ILLINOIS FED. AID PROJECT		CONTRACT NO. 70514

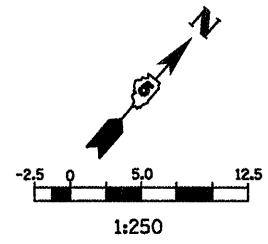

LEGEND

- ↑ SIGN
- DRUM, BARRICADE OR VERTICAL BARRICADE WITH STEADY BURNING LIGHT
- ⇨ DIRECTION OF TRAFFIC
- ⇨ DIRECTION INDICATOR BARRICADE WITH STEADY BURN MONODIRECTIONAL LIGHT

GENERAL STAGING NOTES

PLACE TYPE III BARRICADES IN ACCORDANCE WITH STANDARD 701901.

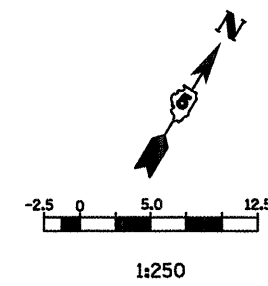
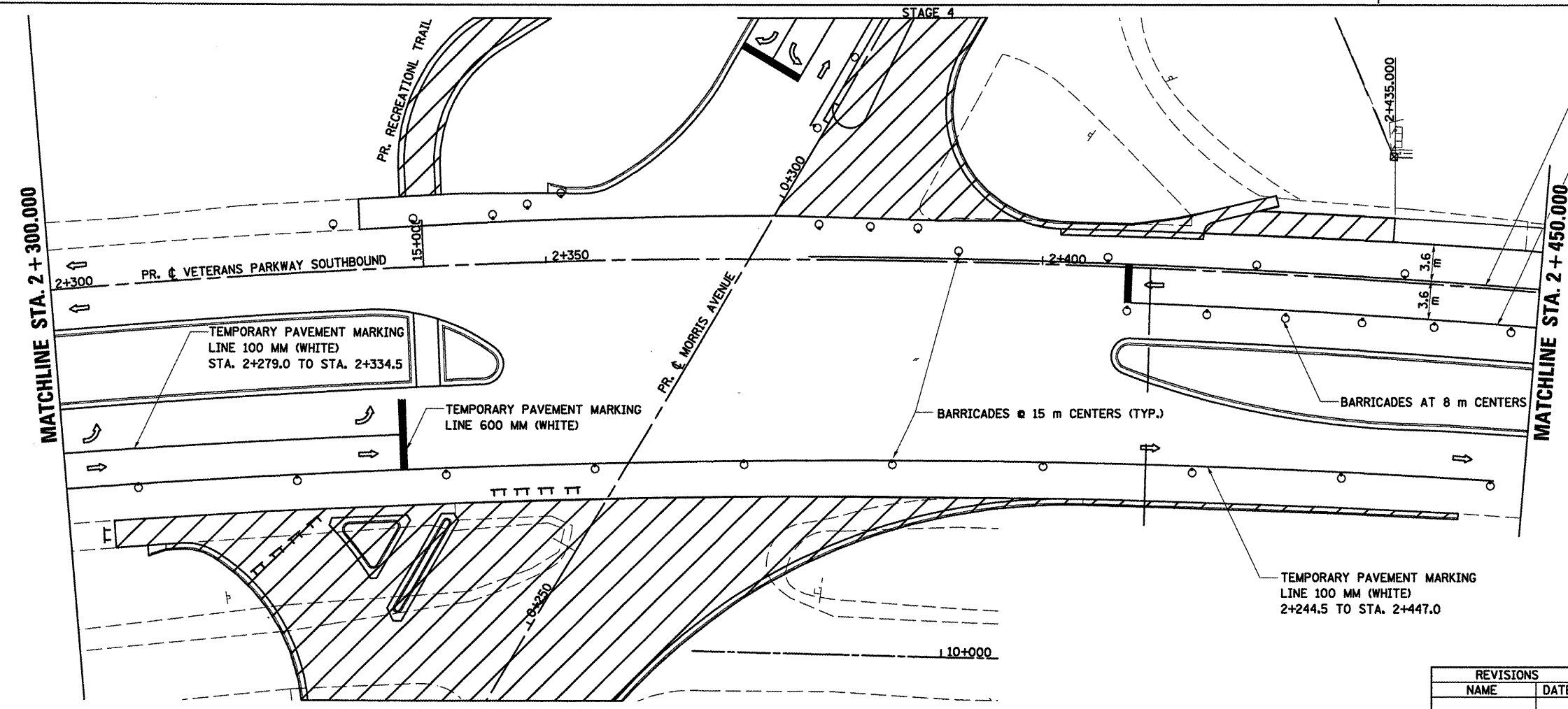
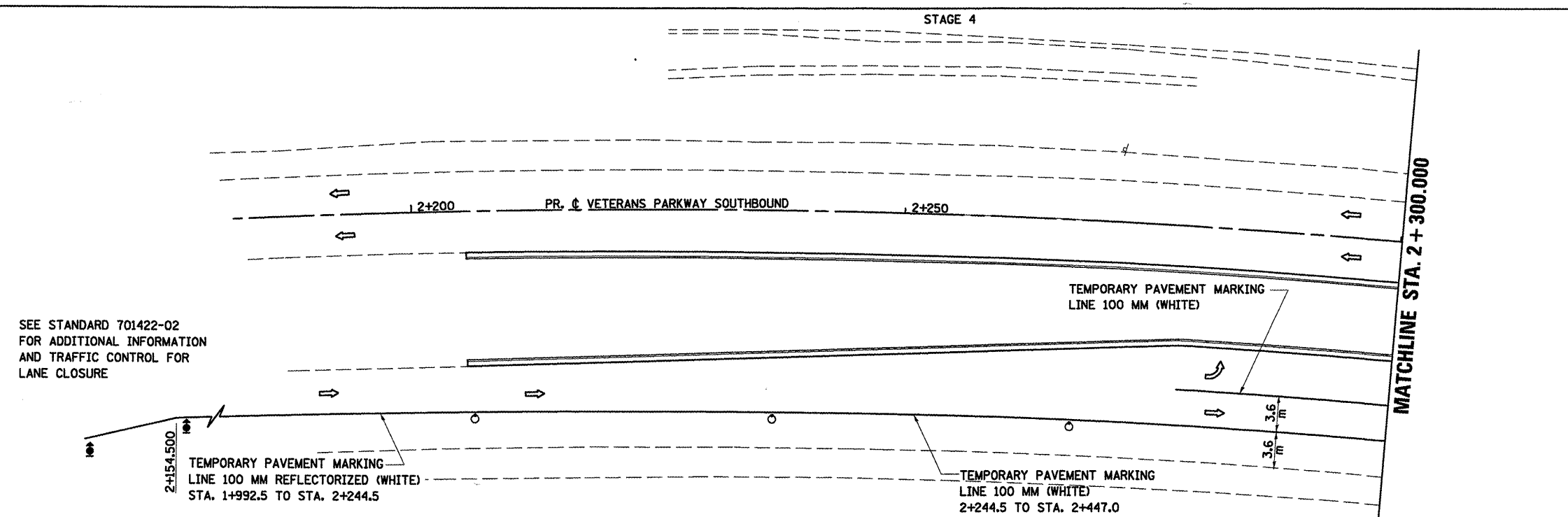

LEGEND

- ↑ SIGN
- DRUM, BARRICADE OR VERTICAL BARRICADE WITH STEADY BURNING LIGHT
- ▨ WORK AREA
- ⇨ DIRECTION OF TRAFFIC

REVISIONS	
NAME	DATE

ILLINOIS DEPARTMENT OF TRANSPORTATION

STAGING PLANS
STAGE 4 VETERANS PARKWAY

DRAWN BY SAM
CHECKED BY PMH
DATE 05/27/09

STAGING PLANS, STAGE 4 VETERANS PARKWAY

PLOT DATE = 6/12/09
 FILE NAME = C:\work\mark\staging\stage4\stage4.dgn
 PLOT SCALE = 1:2500 m / in.
 USER NAME = cregis