

NO OVERSIZE -  
OVERWEIGHT LOADS  
XX MILES AHEAD

[illegible]

ALL DIMENSIONS ARE IN INCHES UNLESS OTHERWISE NOTED.

REVISÉD - 3-11-09

**ROAD CLOSED TO OVERSIZED LOADS 40.4**

## GENERAL NOTES

WOOD POSTS, CABLE, AND SIGN SUPPORTS SHALL BE IN ACCORDANCE WITH SECTION 634 & 636 OF THE STANDARD SPECIFICATIONS FOR ROAD AND BRIDGE CONSTRUCTION. THE PANELS SHALL BE ANCHORED TO THE (3/8) CABLE IN SUCH A MANNER SO THEY CANNOT SLIDE ALONG THE CABLE.

THE REFLECTIVE SHEETING USED FOR THE PANELS SHALL MEET THE REQUIREMENTS OF SECTION 1091 OF THE STANDARD SPECIFICATIONS FOR ROAD & BRIDGE CONSTRUCTION AND SHALL BE ON BOTH SIDES.

ALL PANELS SHALL HAVE ALTERNATING REFLECTORIZED WHITE & RED STRIPES SLOPING DOWNWARD AT 45° TOWARD THE SIDE ON WHICH TRAFFIC WILL PASS AND ON BOTH SIDES OF PANEL. THE DRILLING OF 75 (3) HOLES SHALL BE INCLUDED TO THE MEDIAN CLOSURE.

THIS WORK SHALL BE PAID FOR AT THE  
CONTRACT UNIT PRICE EACH FOR  
MEDIAN CLOSURE.

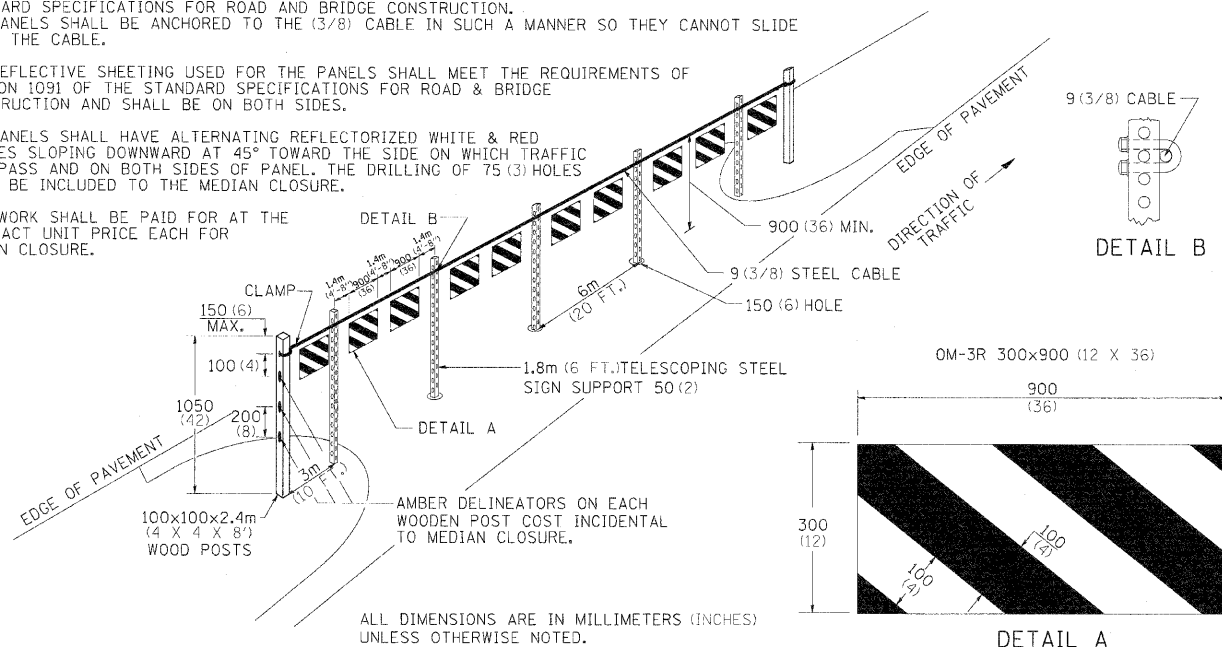

REVISÉ - 5-27-09

**TYPICAL MEDIAN CROSSOVER CLOSURE 98.4**

3.5'-4.0'

1.5'-2.0'

RED OR ORANGE FIBERGLASS POST

PERMANENT SURVEY MARKER, TYPE II

SECTION AA

5"

12"

2.5"

GENERAL NOTES

A WITNESS MARKER SHALL BE INSTALLED WITHIN 1' OF ALL PERMANENT SURVEY MARKERS TYPE II EXCEPT IN AREAS WHERE THE MARKER IS IN THE SIDEWALK. THIS WORK WILL BE INCLUDED TO THE CONTRACT UNIT PRICE PER EACH FOR PERMANENT

WITNESS POST	
PLEASE DO NOT DISTURB NEARBY	
SURVEY	MARKER

GENERAL NOTES

A WITNESS MARKER SHALL BE INSTALLED WITHIN 1' OF ALL PERMANENT SURVEY MARKERS TYPE II EXCEPT IN AREAS WHERE THE MARKER IS IN THE SIDEWALK. THIS WORK WILL BE INCLUDED TO THE CONTRACT UNIT PRICE PER EACH FOR PERMANENT SURVEY MARKERS, TYPE II.

## PERMANENT SURVEY MARKERS, TYPE II

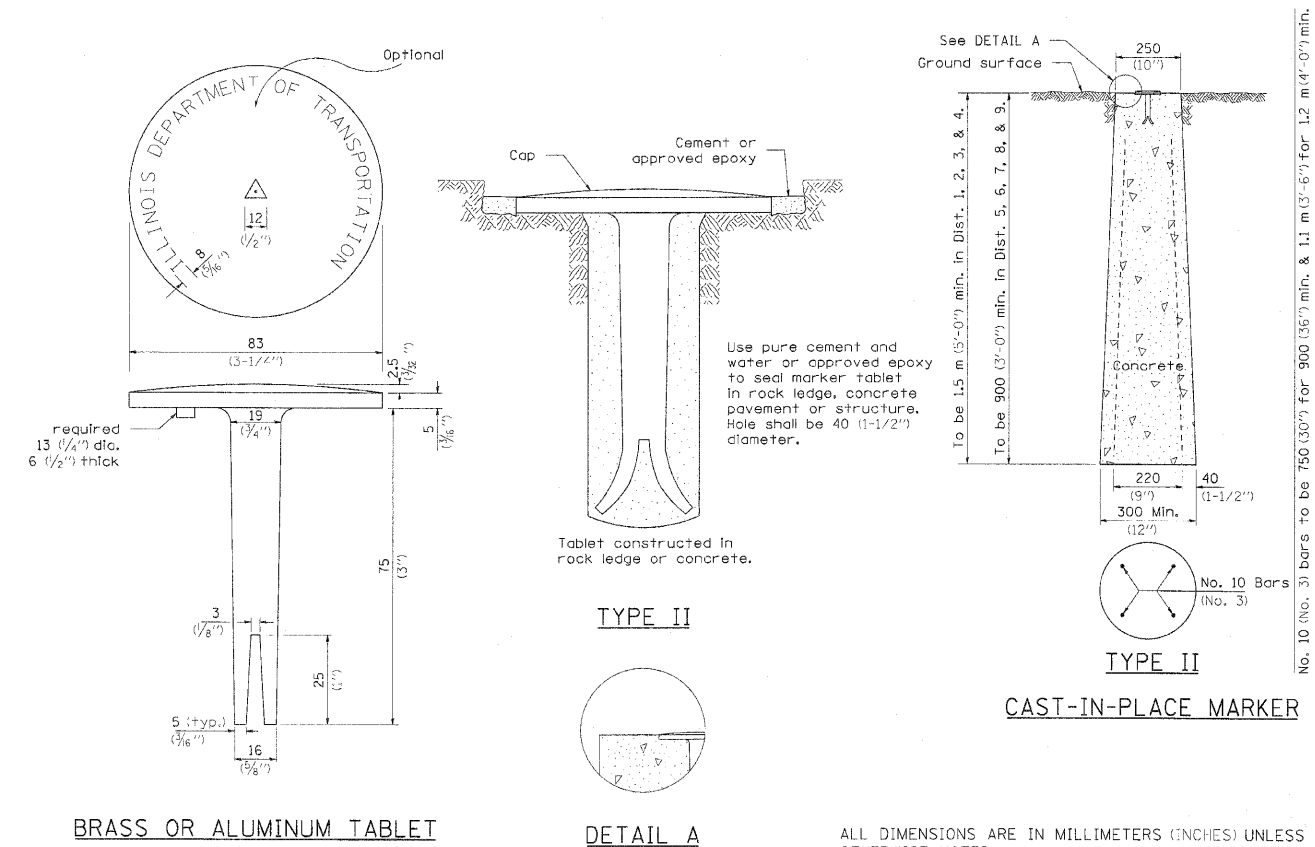

ALL DIMENSIONS ARE IN MILLIMETERS (INCHES) UNLESS OTHERWISE NOTED.

## BRASS OR ALUMINUM TABLET

REVISÉ - 10-21-08

**WITNESS MARKER & PERMANENT SURVEY MARKERS, TYPE II 66.2**

FILE NAME =	USER NAME = Pop02836	DESIGNED -	REVISED -	<div>STATE OF ILLINOIS DEPARTMENT OF TRANSPORTATION</div>	<div>REGION 2 /DISTRICT 2 STANDARD</div>					F.A.I. RTE.	SECTION	COUNTY	TOTAL SHEETS	SHEET NO.
D264815-cht-D2-Details07.dgn		DRAWN -	REVISED -			280	81-1B+1-HB+1-HB+2-VB+VB-1R	ROCK ISLAND	503	463				
MODEL NAME =		CHECKED -	REVISED -			CONTRACT NO. 64815								
D2 Detail 07		DATE - 07/23/10	REVISED -			SCALE:	SHEET NO. OF SHEETS	STA. TO STA.	FED. ROAD DIST. NO. 7	ILLINOIS FED. AID PROJECT 7				