

STATE OF ILLINOIS  
DEPARTMENT OF TRANSPORTATION  
DIVISION OF HIGHWAYS

# PROPOSED HIGHWAY PLANS

FAI ROUTE 280 (I-280)  
SECTION 81-1(B-1, HB, HB-1, HB-2, VB, VB-1)R  
PROJECT ACNHI-ARRA-280-6(050)003  
ROCK ISLAND COUNTY

C-92-159-10

FOR INDEX OF SHEETS, SEE SHEET NO. 2  
FOR LIST OF STANDARDS, SEE SHEET NO. 3

## UTILITY NOTE

THE LOCATIONS OF THOSE BURIED AND ABOVEGROUND UTILITIES SHOWN ARE APPROXIMATE, ARE SHOWN FOR CONTRACTOR INFORMATIONAL USE ONLY, AND ARE NOT TO BE REFERENCED FOR CONSTRUCTION PURPOSES. THE IMPLIED PRESENCE OR ABSENCE OF UTILITIES IS NOT TO BE CONSTRUED BY THE OWNER, ENGINEER, CONTRACTOR, OR SUBCONTRACTORS TO BE AN ACCURATE AND COMPLETE REPRESENTATION OF UTILITIES THAT MAY OR MAY NOT EXIST ON THE CONSTRUCTION SITE. BURIED AND ABOVEGROUND UTILITY LOCATION, IDENTIFICATION, AND MARKING ARE THE SOLE RESPONSIBILITY OF THE CONTRACTOR. REROUTING, DISCONNECTION, PROTECTION, ETC. OF ANY UTILITIES MUST BE COORDINATED BETWEEN THE CONTRACTOR, UTILITY COMPANY, AND OWNER. SITE SAFETY, INCLUDING THE AVOIDANCE OF HAZARDS ASSOCIATED WITH BURIED AND ABOVEGROUND UTILITIES, REMAIN THE SOLE RESPONSIBILITY OF THE CONTRACTOR.

## DESIGN DESIGNATION

ROADWAY	DESIGN DESIGNATION
I-280	I-3340(28) INTERSTATE 29.0 (FD-20)

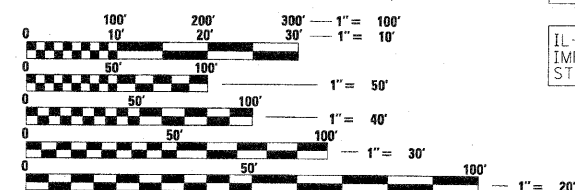

FULL SIZE PLANS HAVE BEEN PREPARED USING STANDARD ENGINEERING SCALES. REDUCED SIZED PLANS WILL NOT CONFORM TO STANDARD SCALES. IN MAKING MEASUREMENTS ON REDUCED PLANS, THE ABOVE SCALES MAY BE USED.

J.U.L.I.E.  
JOINT UTILITY LOCATION INFORMATION FOR EXCAVATION  
1-800-892-0123  
OR 811

PROJECT ENGINEER - REBECCA MARRUFFO  
PROJECT MANAGER - EDWARD CONDERMAN (815) 284-5947

CONTRACT NO. 64815

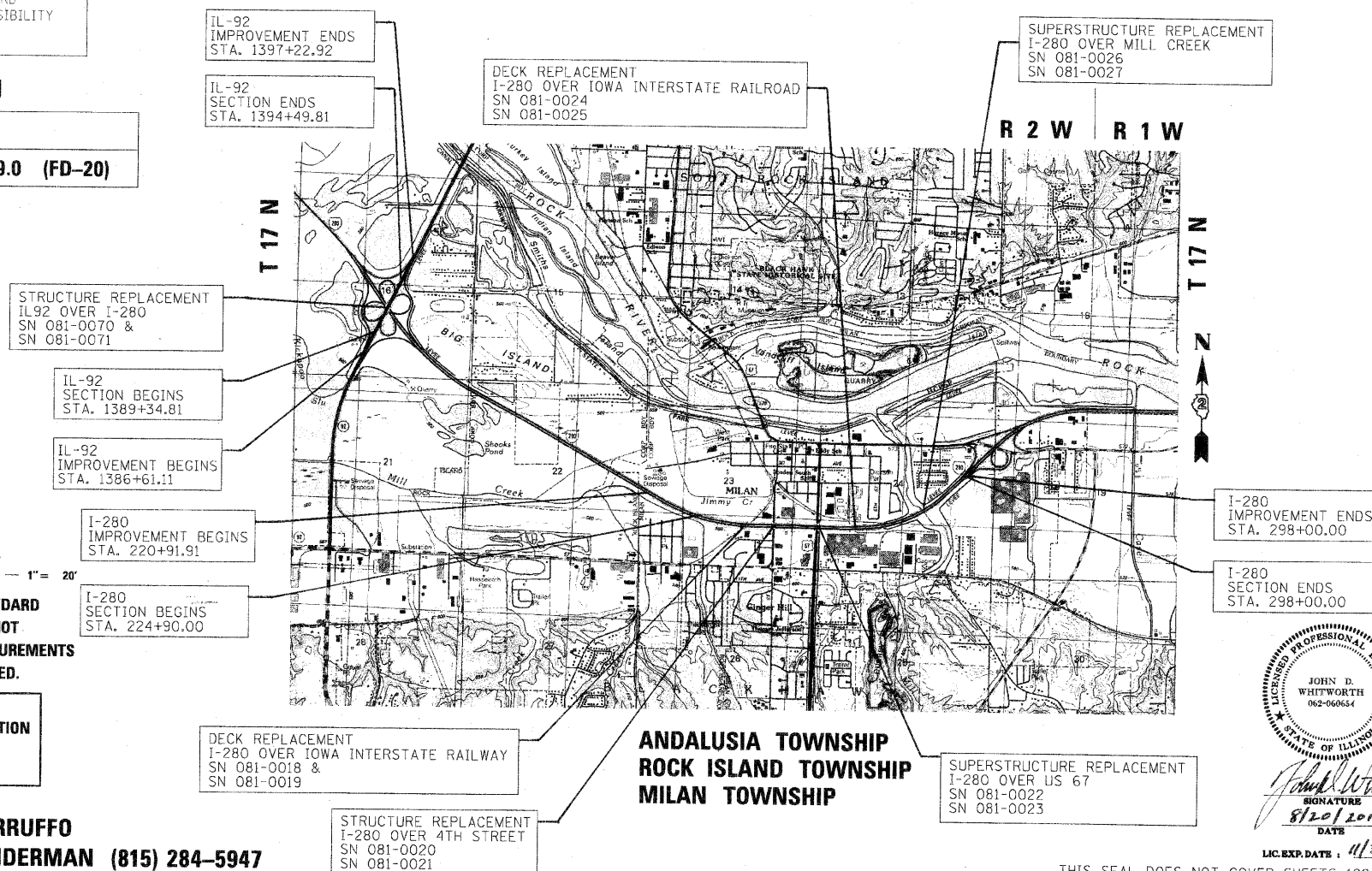

ANDALUSIA TOWNSHIP  
ROCK ISLAND TOWNSHIP  
MILAN TOWNSHIP

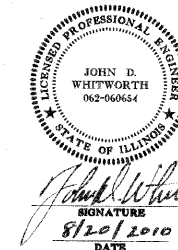

THIS SEAL DOES NOT COVER SHEETS 122 TO 133  
(BRIDGE PATCHING AND OVER-LAY) AND  
SHEETS 50 TO 52 (CONTRACTOR ACCESS)

GROSS LENGTH OF PROPOSED F.A.I. 280 (INTERSTATE 280) = NET LENGTH = 7310 LF = 1.384 MILES  
GROSS LENGTH OF PROPOSED F.A.P 380 (ILLINOIS 92) = NET LENGTH = 515 LF = 0.098 MILES

F.A.I. RTE.	SECTION	COUNTY	TOTAL SHEETS	SHEET NO.
280	*	ROCK ISLAND	503	1
		ILLINOIS	CONTRACT NO. 64815	

\*81-1 (B-1, HB, HB-1, HB-2, VB, VB-1)R  
D-92-045-02 \*503+35  
528



LOCATION OF SECTION INDICATED THUS: -

REVISÉ 10/19/10

STATE OF ILLINOIS  
DEPARTMENT OF TRANSPORTATION  
DIVISION OF HIGHWAYS

SUBMITTED Sept 8 2010  
George F. Ryan  
DEPUTY DIRECTOR OF HIGHWAYS, REGION ENGINEER  
October 1 2010  
Scott E. Stitt, P.E.  
ENGINEER OF DESIGN AND ENVIRONMENT  
October 1 2010  
Christina M. Reed  
DIRECTOR OF HIGHWAYS, CHIEF ENGINEER

PRINTED BY THE AUTHORITY  
OF THE STATE OF ILLINOIS