

NOTES:

1. ALL SIGN POSTS SHALL BE NEW AND SHALL BE MADE OF WOOD PER SECTION 703 OF THE STANDARD SPECIFICATIONS.
2. PAVEMENT MARKINGS SHALL BE THERMOPLASTIC ON ALL SURFACES.

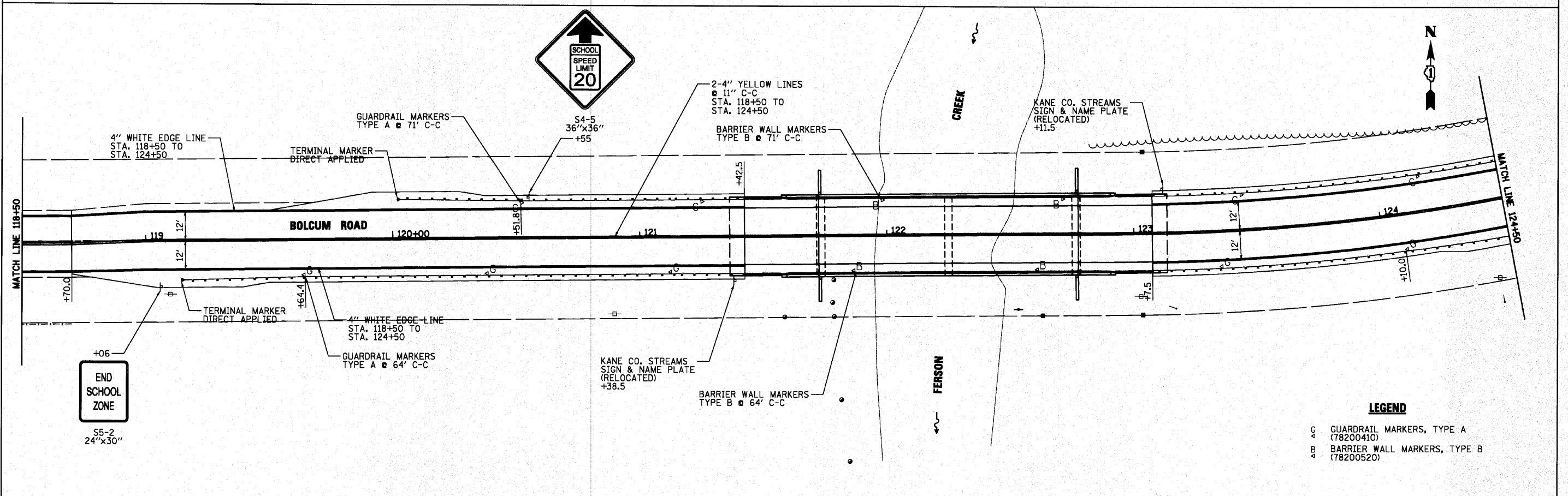
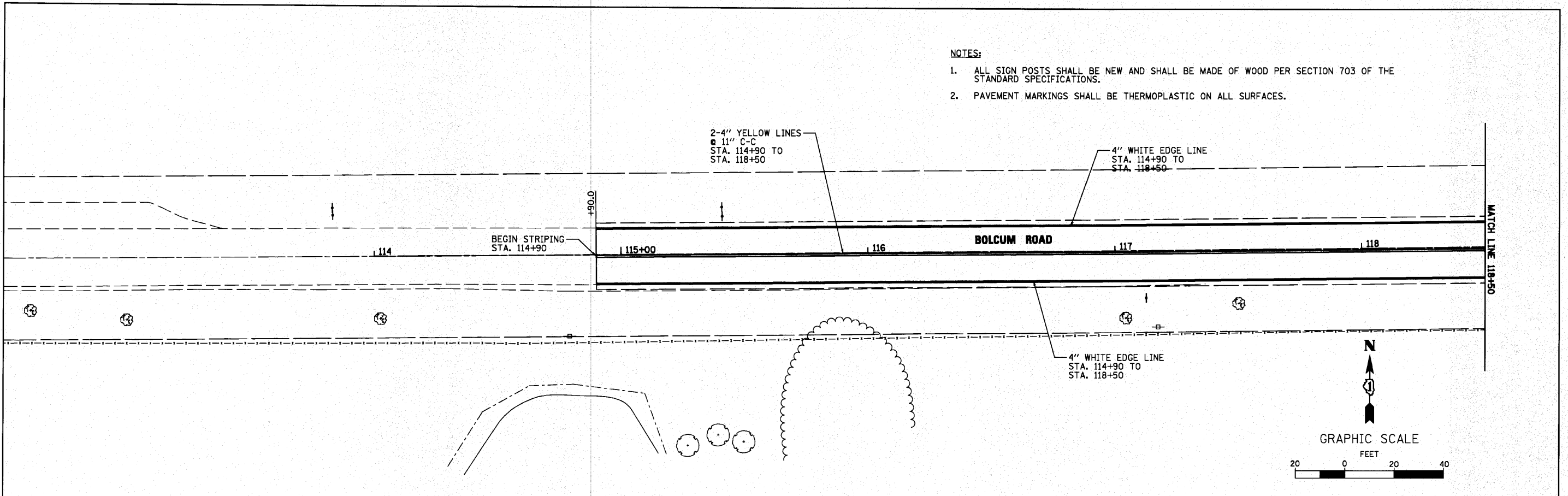

FILE NAME = P:\CIBBEL WEST Projects\2009\10\08\02 Bolcum PH11\G11\09\10\Sign\PK 01.dgn

END SCHOOL ZONE
S5-2
24"x30"

- LEGEND**
- A GUARDRAIL MARKERS, TYPE A (78200410)
 - B BARRIER WALL MARKERS, TYPE B (78200520)

| | | | | | | | | | | | | | |
|---|------------------------|-----------------|-----------|---|--|---------------------------|-------------|---------|--------|----------------|-----------|-------|---|
| WILLS BURKE KELSEY ASSOCIATES LTD. 119 West Main Street, Suite 201 St. Charles, Illinois 60174 | USER NAME = #USER# | DESIGNED - | REVISED - | STATE OF ILLINOIS DEPARTMENT OF TRANSPORTATION | PAVEMENT MARKING & SIGNING PLAN | | F.A.U. RTE. | SECTION | COUNTY | TOTAL SHEETS | SHEET NO. | | |
| | PLOT SCALE = | DRAWN - | REVISED - | | SCALE: | SHEET NO. 20 OF 73 SHEETS | STA. | TO STA. | 2332 | 03-14185-02-BR | KANE | 73 20 | |
| | PLOT DATE = 10/21/2010 | CHECKED - | REVISED - | | | | | | | | | | CONTRACT NO. 63521 |
| | | DATE = 10/22/10 | REVISED - | | | | | | | | | | FED. ROAD DIST. NO. 1 ILLINOIS FED. AID PROJECT |