

NOTES:

1. ALL REMOVED SIGN PANELS SHALL REMAIN THE PROPERTY OF THE ST. CHARLES TOWNSHIP. ONCE PANELS HAVE BEEN REMOVED THE CONTRACTOR WILL RETURN THEM TO A LOCATION SPECIFIED BY THE TOWNSHIP.
2. ALL GUARDRAIL, POSTS AND TERMINAL SECTIONS SHALL BE REMOVED AND SALVAGED. ALL MATERIALS SHALL BE RETURNED TO A LOCATION SPECIFIED BY ST. CHARLES TOWNSHIP. ANY MATERIAL DAMAGED BY THE CONTRACTOR SHALL BE REPLACED AT CONTRACTORS' EXPENSE.
3. CLEANING AND GRUBBING PER SEC. 200, SHALL NOT BE MEASURED SEPERATELY FOR PAYMENT, BUT SHALL BE INCLUDED IN COST OF EXCAVATION.

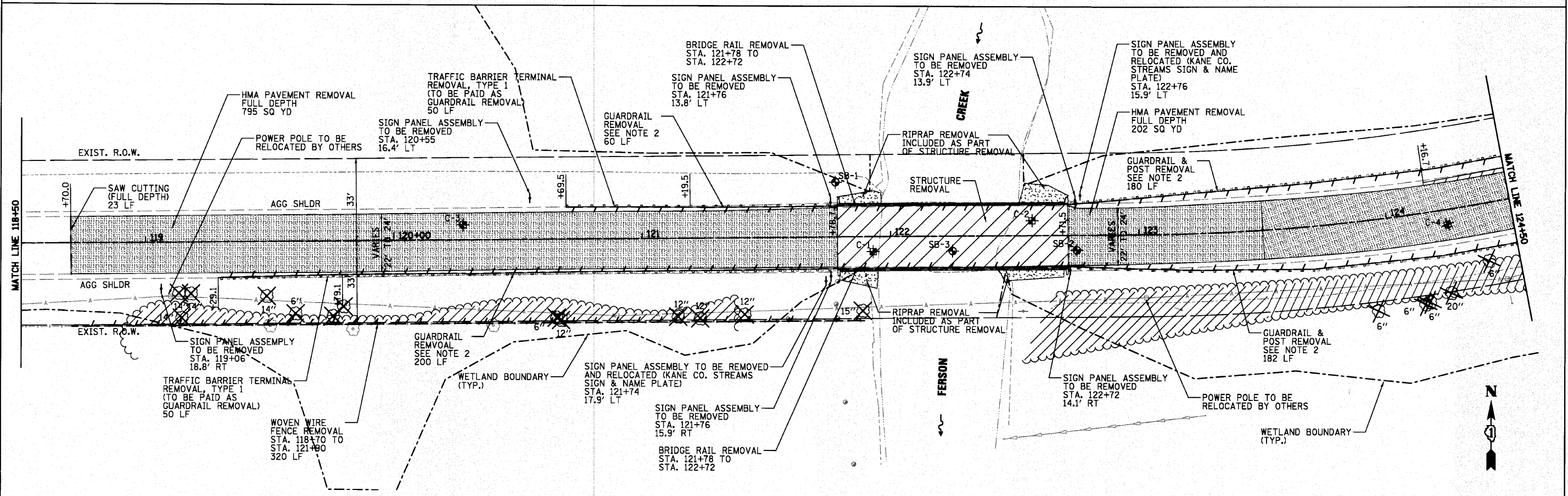
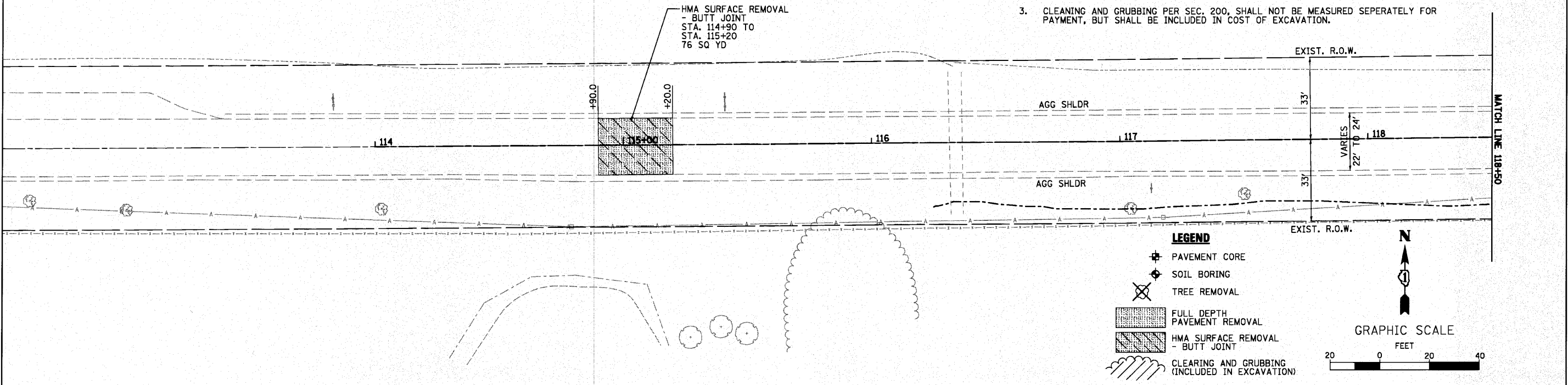

FILE NAME = P:\CIBBEL WEST Projects\2009\91-0002_Bottom_Plan\119-124\SSR\SSR\DEM_Bldg.dwg

WILLS BURKE KELSEY ASSOCIATES LTD.
 116 West Main Street, Suite 201
 St. Charles, Illinois 60174

USER NAME = #USER#	DESIGNED -	REVISED -
PLOT SCALE =	DRAWN -	REVISED -
PLOT DATE = 10/21/2010	CHECKED -	REVISED -
	DATE = 10/22/10	REVISED -

**STATE OF ILLINOIS
 DEPARTMENT OF TRANSPORTATION**

EXISTING CONDITIONS & REMOVAL PLAN	
SCALE:	SHEET NO. 14 OF 73 SHEETS STA. 118+70 TO STA. 127+12

F.A.U. RTE. 2332	SECTION 03-14185-02-BR	COUNTY KANE	TOTAL SHEETS 73	SHEET NO. 14
CONTRACT NO. 63521				
FED. ROAD DIST. NO. 1 ILLINOIS FED. AID PROJECT				