

NOTE:
THE TRAFFIC SIGNAL CONTROL EQUIPMENT FOR THIS PROJECT SHALL BE "ECONOLITE" TO MATCH THE EXISTING ADJACENT SYSTEM.

RESTORATION OF WORK AREA
RESTORATION OF THE TRAFFIC SIGNAL WORK AREA SHALL BE INCIDENTAL TO THE RELATED PAY ITEM SUCH AS FOUNDATION, CONDUIT, HANDHOLE, TRENCH AND BACKFILL, ETC., AND NO EXTRA COMPENSATION SHALL BE ALLOWED. ALL ROADWAYS SURFACES SUCH AS SHOULDERS, MEDIANS, SIDEWALKS, PAVEMENT, ETC. SHALL BE REPLACED IN KIND. ALL DAMAGE TO MOWED LAWNS SHALL BE REPLACED WITH AN APPROVED SOD AND ALL DAMAGE TO UNMOWED FIELDS SHALL BE SEEDED IN ACCORDANCE WITH STANDARD SPECIFICATIONS 252 AND 250 RESPECTIVELY.

NOTE:
STOP BARS ARE NOT TO BE PLACED PRIOR TO THE PROPOSED TRAFFIC SIGNALS BEING OPERATIONAL. THEY MUST BE IN PLACE, HOWEVER, AT THE TIME OF TURN-ON.

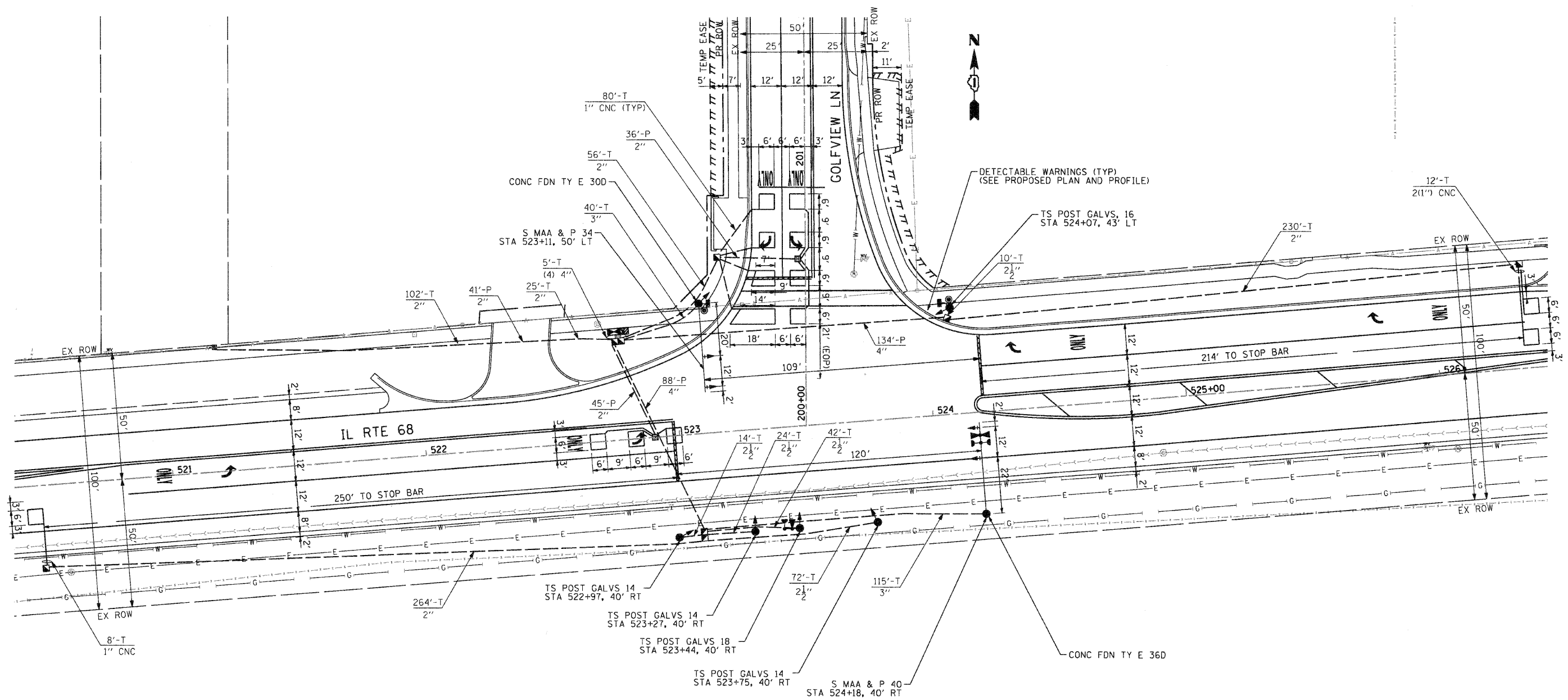

SEC GROUP, INC.
 COMPANY NAME
 PROJECT CONTACT
 VILLAGE OF CARPENTERSVILLE
 CLIENT
 11/17/2010 6:02:13 PM
 DATE PLOTTED
 080326-sb-pn.dgn
 FILE NAME
 pdflht
 PLOT DRIVER
 sfondard@trans.nj
 PEN TABLE

SEC Group, Inc.
 1000 Professional Design Firm 156-000108
 400 N. First Street
 Morrisville, NC 27560-2000
 E 919.366.1779 F 919.366.1791
 www.secgroup.com

USER NAME = CHeerUke	DESIGNED - JJS	REVISED -
PLOT SCALE = 1" = 20'	DRAWN - JJS	REVISED -
PLOT DATE = 11/17/2010	CHECKED - CJP	REVISED -
	DATE - 10/25/10	REVISED -

VILLAGE OF CARPENTERSVILLE

TRAFFIC SIGNAL INSTALLATION PLAN
IL RTE 68 AT GOLFVIEW LANE

SCALE: 1" = 20' SHEET NO. 0 OF 0 SHEETS STA. NA TO STA. NA

F.A. RTE.	SECTION	COUNTY	TOTAL SHEETS	SHEET NO.
*	06-00074-00-FP	KANE	211	108
* FAU 2414, FAU 1280, FAP 343			CONTRACT NO. 63504	
FED. ROAD DIST. NO. [ILLINOIS] FED. AID PROJECT				