

- 308 MH TA 5' DIA T1 F&CL
STA = 227+45, 5' RT
RIM = 872.08
INV = 862.70 S
INV = 865.20 N
INV = 867.86 E,W
- 309 19 LIN FT STORM SEW WM
REQ 12" @ 1.3%
- 310 INLET TA TIIV F&G
STA = 227+45, 15' LT
RIM = 871.82
INV = 868.10
- 311 9 LIN FT SS CL A 1 12" @ 1.8%
- 312 INLET TA TIIV F&G
STA = 227+45, 15' RT
RIM = 872.31
INV = 868.00
- 313 81 LIN FT SS CL A 2 30" @ 0.9%
- 314 MH TA 5' DIA T1 F&CL
STA = 228+23, 20' LT
RIM = 874.07
INV = 865.90 S
INV = 869.00 NW
INV = 868.30 NE
- 314A 18 LIN FT SS CL A 1 12" @ 1.2%
- 314B INLET TA TIIV F&G
STA = 228+33, 35' LT
RIM = 873.74
INV = 869.20

- 319 81 LIN FT SS CL A 2 30" @ 0.9%
- 320 MH TA 5' DIA T1 F&CL
STA = 229+13, 10.4' LT
RIM = 878.12
INV = 869.0 SW
INV = 871.60 N
- 321 56 LIN FT SS CL A 2 30" @ 0.9%
- 322 MH TA 5' DIA T1 F&CL
STA = 229+75, 11' LT
RIM = 880.58
INV = 872.10 S
INV = 875.25 N
INV = 876.34 E,W
- 323 3 LIN FT SS CL A 1 12" @ 1.3%
- 324 INLET TA TIIV F&G
STA = 229+75, 15' RT
RIM = 880.61
INV = 876.36
- 325 24 LIN FT STORM SEW WM
REQ 12" @ 0.6%
- 326 INLET TA TIIV F&G
STA = 229+75, 15' RT
RIM = 881.10
INV = 876.50
- 327 191 LIN FT SS CL A 2 30" @ 0.7%

- 230 TOP OF WM PIPE = 866.10
BOTTOM OF SS PIPE = 868.07
CLEARANCE = 1.97'
- 230A OMITTED
- 231 TOP OF EX SAN PIPE = 864.14
BOTTOM OF SS PIPE = 865.77
CLEARANCE = 1.63'
- 231A TOP OF WM PIPE = 867.63
BOTTOM OF SS PIPE = 869.13
CLEARANCE = 1.50'
- 232 TOP OF WM PIPE = 866.60
BOTTOM OF SS PIPE = 868.10
CLEARANCE = 1.50'
- 233 OMITTED
- 234 OMITTED
- 235 TOP OF WM PIPE = 874.25
BOTTOM OF SS PIPE = 876.42
CLEARANCE = 2.17'

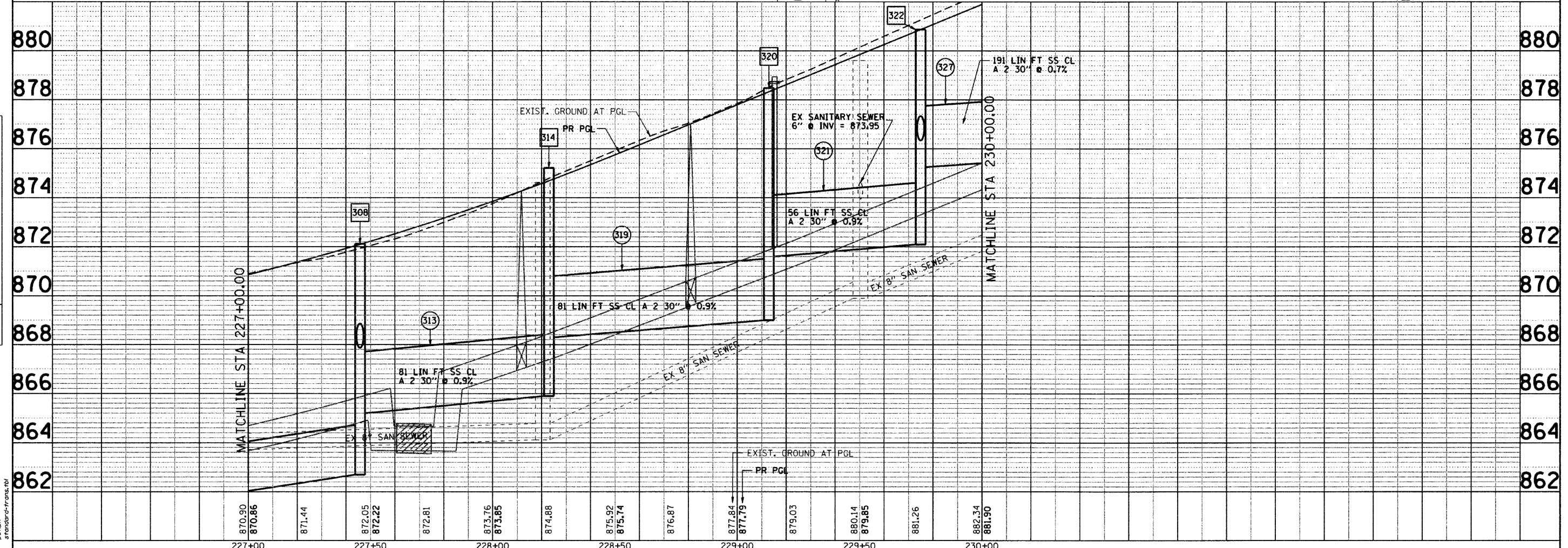
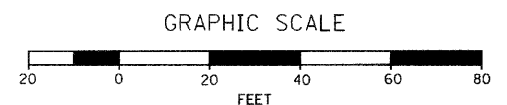
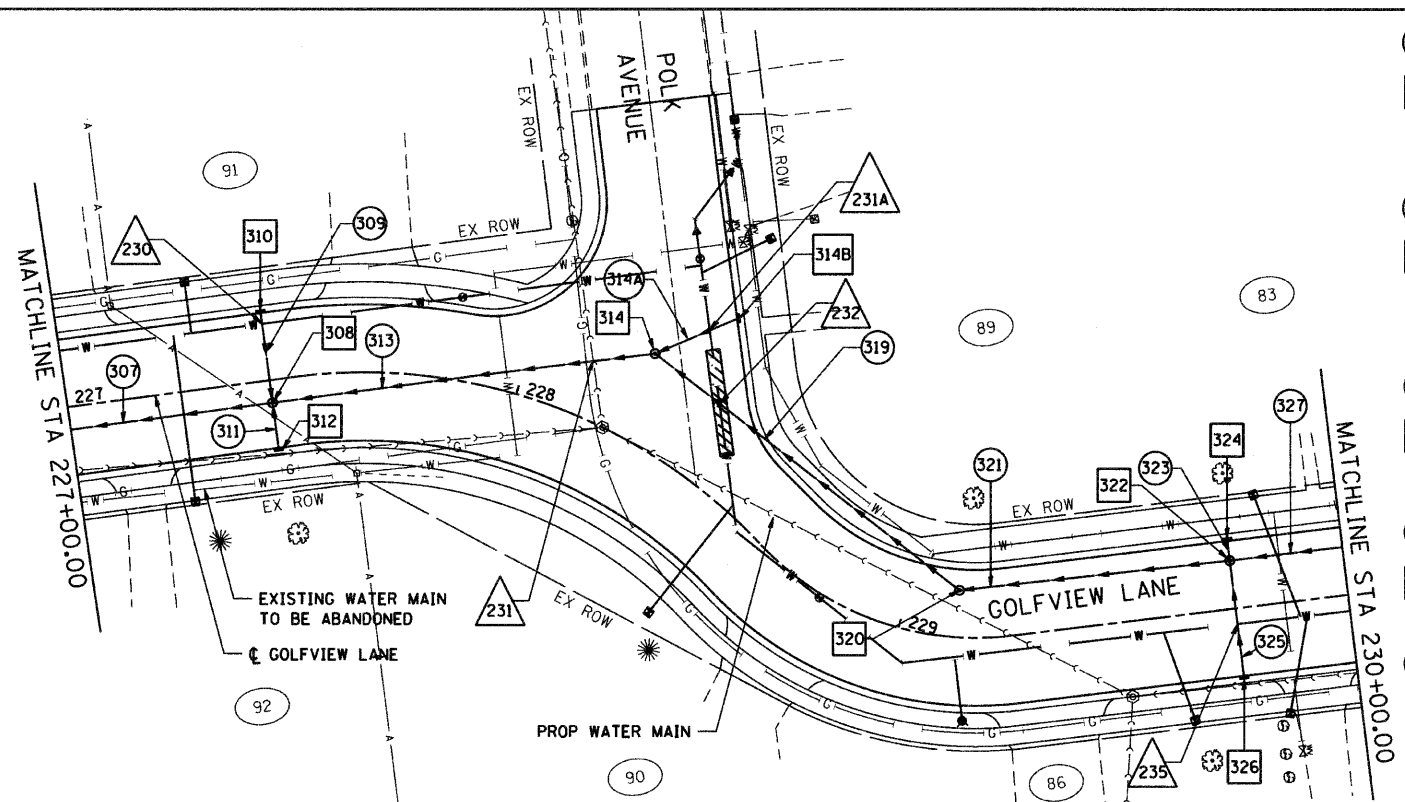

| | |
|-------------|--|
| DATE | |
| BY | |
| REVISIONS | |
| NO. | |
| DESCRIPTION | |
| DATE | |
| BY | |
| DATE | |
| BY | |

| | |
|-------------|--|
| DATE | |
| BY | |
| REVISIONS | |
| NO. | |
| DESCRIPTION | |
| DATE | |
| BY | |
| DATE | |
| BY | |

SEC GROUP, INC.
 COMPANY NAME
 PROJECT CONTACT
 CLIENT
 DATE PLOTTED
 FILE NAME
 PLOT DRIVER
 PEN TABLE

| | | | | | | | |
|---|--|--|---|---|-------------------------------------|---|--------------------|
| <p>SEC Group, Inc. 440 N. First Street Moline, IL 61401-1210 815.336.1778 • 815.336.1791 www.secgroup.com</p> | USER NAME = CHARLIE DESIGNED - A. JAIN DRAWN - S. PERNAL CHECKED - T. HAMILTON DATE - 10/25/10 | REVISED - REVISED - REVISED - REVISED - | VILLAGE OF CARPENTERSVILLE DRAINAGE AND UTILITY PLAN AND PROFILE GOLFVIEW LANE | F.A. RTE. SECTION COUNTY TOTAL SHEETS SHEET NO. | 06-00074-00-FP KANE 211 59 | *FAU 2414, FAU 1280, FAP 343 FED. ROAD DIST. NO. ILLINOIS FED. AID PROJECT | CONTRACT NO. 63504 |
| | PLOT SCALE = 1" = 20' PLOT DATE = 11/5/2010 | SCALE: 1" = 20' SHEET NO. 11 OF 21 SHEETS STA. 227+00 TO STA. 230+00 | STA. 227+00 TO STA. 230+00 | | | | |