

STATE OF ILLINOIS
DEPARTMENT OF TRANSPORTATION

ROUTE NO.	SECTION	COUNTY	POST MILES	SHEET	SHEET NO. 1
353	(12&13)WRS-4	WILL	608	440	23 SHEETS
FED. ROAD DIST. NO. 7		ILLINOIS	FED. AID PROJECT-		Contract No. 62478

Benchmark:
BM #10 Cui [] on Southwest Corner of Crashwall to
Bridge No. 099-0311 at East Side of Windy Hill Drive,
Elevation 694.59.

Existing Structures:

Structure No. 099-0344 at Station 441+40, Built as State Bond
Issue Route Number 22, Section 12, at Station 452+45 in 1922.
Superstructure- Single Span Cast-in-Place Concrete Deck Slab
with 4" Thick Bituminous Concrete Overlay.
Substructure- Cast-in-Place Concrete Closed Abutments on
Spread Footings.

Length = 16'-6" (Back to Back Abutments)
Width = 32'-0" (Out to Out Deck)

Existing structure to be removed and replaced
with structure extension.

Structure No. 099-4626, Built as F.A.P. Route 330,
Section 104 R-1 and 104 PB, at Station 427+80.13 in 1998.
10'x5' Double Box Cast-in-Place Concrete Culvert,
1,143'-5 1/4" End to End Along C. Box Culvert.

Structure No. 099-4627, Built as F.A.P. Route 330,
Section 104 R-1 & 104 PB under Private Road at Station
430+69.10 in 1998. 11'x3' Double Box Cast-in-Place
Concrete Culvert, 22'-6" Long Out to Out of Headwalls.
Existing structure to be removed and replaced
with structure extension.

Traffic is to be maintained utilizing stage construction.

INDEX OF CULVERT DRAWINGS

Sheet No.	Title
1	Partial General Plan (1 of 4)
2	Partial General Plan (2 of 4)
3	Partial General Plan (3 of 4)
4	Partial General Plan (4 of 4)
5	Existing Structure Removal
6	Existing Culvert Concrete Removal
7	10'x5' Double Box Culvert Extension (1 of 2)
8	10'x5' Double Box Culvert Extension (2 of 2)
9	End Section A
10	Junction Chamber No. 1
11	Junction Chamber No. 2
12	Junction Chamber No. 3
13	Junction Chamber No. 4
14	Soil Boring Log CS-02
15	Soil Boring Log CS-03
16	Soil Boring Log CS-04
17	Soil Boring Log CS-05
18	Soil Boring Log CS-06
19	Soil Boring Log CS-07
20	Soil Boring Logs CS-09 & CS-10
21	Soil Boring Logs CS-12 & CS-14
22	Soil Boring Log CS-16
23	Soil Boring Log CS-17

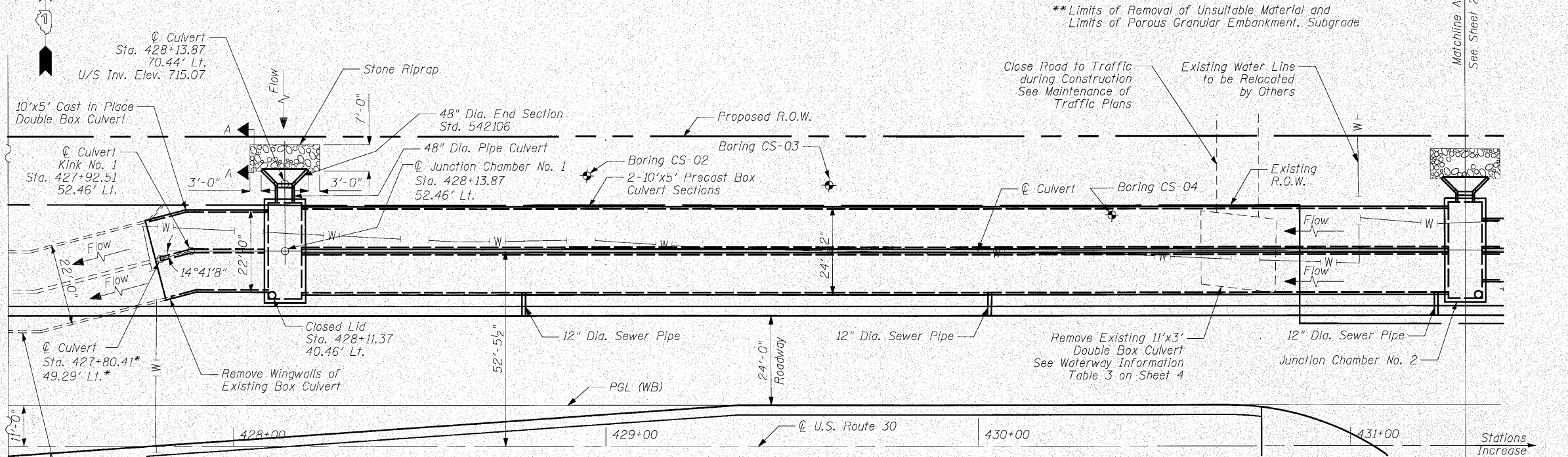
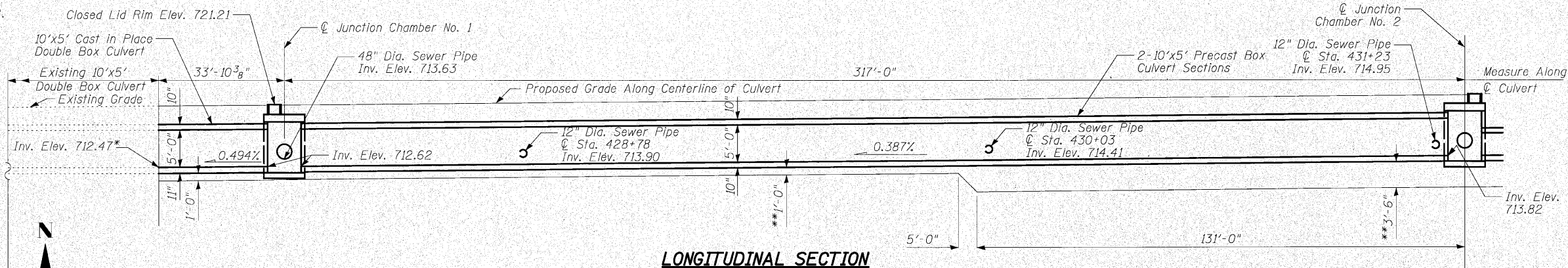

Note:
1. See Sheet 4 for Section A-A.
*Elevation, Station and Offset are based on Survey Information.

TOTAL BILL OF MATERIAL

Item	Unit	Total
Removal and Disposal of Unsuitable Material	Cu Yd	2,830
Porous Granular Embankment, Subgrade	Cu Yd	2,570
Stone Riprap, Class A4	Sq Yd	74
Filter Fabric	Sq Yd	74
Removal of Existing Structures	Each	1
Concrete Removal	Cu Yd	48.1
Reinforcement Bars	Pound	16,140
Temporary Sheet Piling	Sq Ft	2,536
Name Plates	Each	1
Box Culvert End Section, Culvert No. 1	Each	1
Expansion Bolts 3/4 Inch	Each	33
Concrete Box Culverts	Cu Yd	55.4
Precast Concrete Box Culvert 7'x4'	Foot	2,102
Precast Concrete Box Culvert 10'x5'	Foot	620
Pipe Culverts, Class A, Type 2 36"	Foot	19
Pipe Culvert, Class A, Type 2 48"	Foot	8
End Sections 36"	Each	1
End Sections 48"	Each	2
Junction Chamber No. 1	Each	1
Junction Chamber No. 2	Each	1
Junction Chamber No. 3	Each	1
Junction Chamber No. 4	Each	1

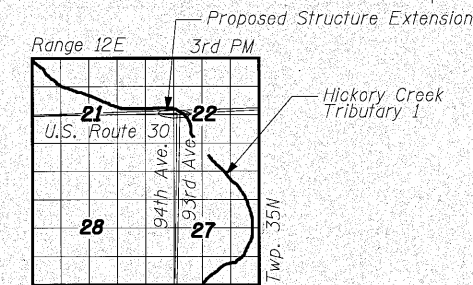
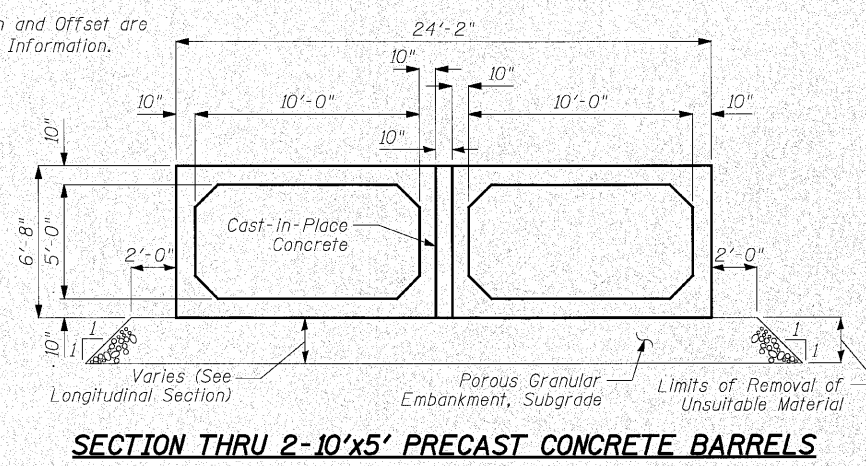

PARTIAL GENERAL PLAN (1 OF 4)
U.S. ROUTE 30 OVER
HICKORY CREEK TRIBUTARY 1
F.A.P. ROUTE 353 SEC. (12&13)WRS-4
WILL COUNTY
STATION 441+23.00
STRUCTURE NO. 099-4626

INFRASTRUCTURE ENGINEERING | INCORPORATED
33 West Monroe | Suite 1540 | Chicago, IL 60603
P 312.425.9560 | F 312.425.9564 | www.infrastructure-eng.com

DESIGNED	MT
CHECKED	RB
DRAWN	JHP
CHECKED	SPK

TYPICAL CROSS SECTION BETWEEN STATIONS 428+13.87 AND 431+30.87 (Looking East)

P:\P-03\1505\Drawings\Final Design\441+23.00\Drawings\Sheet\441+23.00\441-23.00.dgn 2:02:04 PM 7/26/2010