

F.A.P. RTE.	SECTION	COUNTY	TOTAL SHEETS	SHEET NO.
353	(12&13)WRS-4	WILL	608	338
STA. 495+00		TO STA. 525+00		
FED. ROAD DIST. NO. 1 ILLINOIS FED. AID PROJECT				

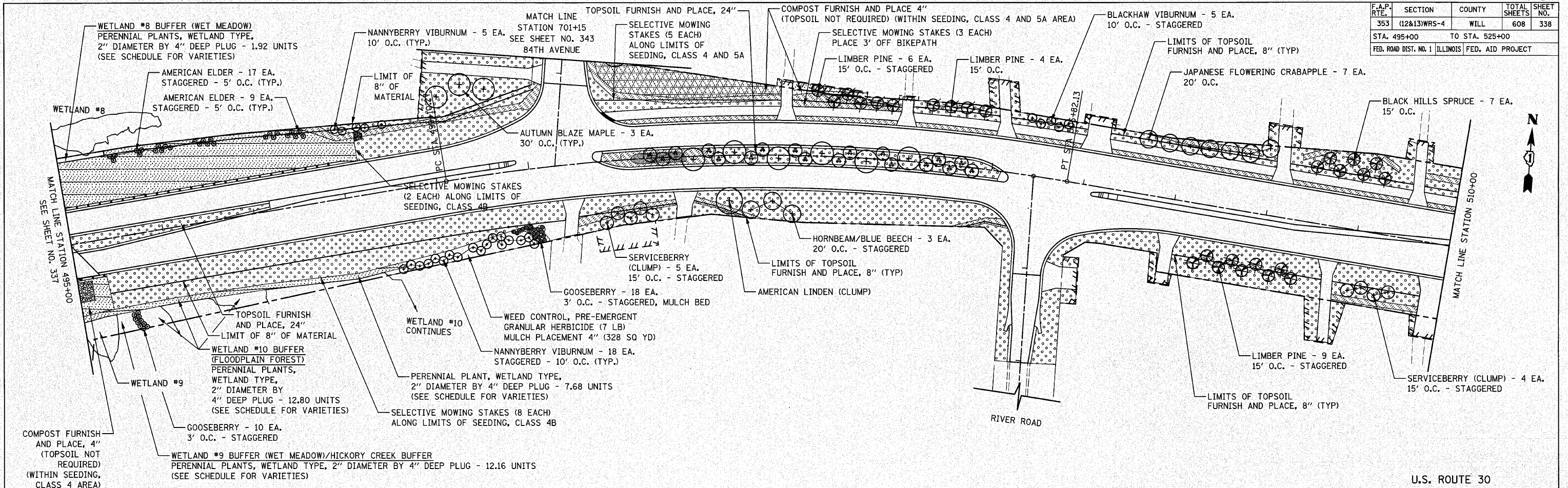

U.S. ROUTE 30

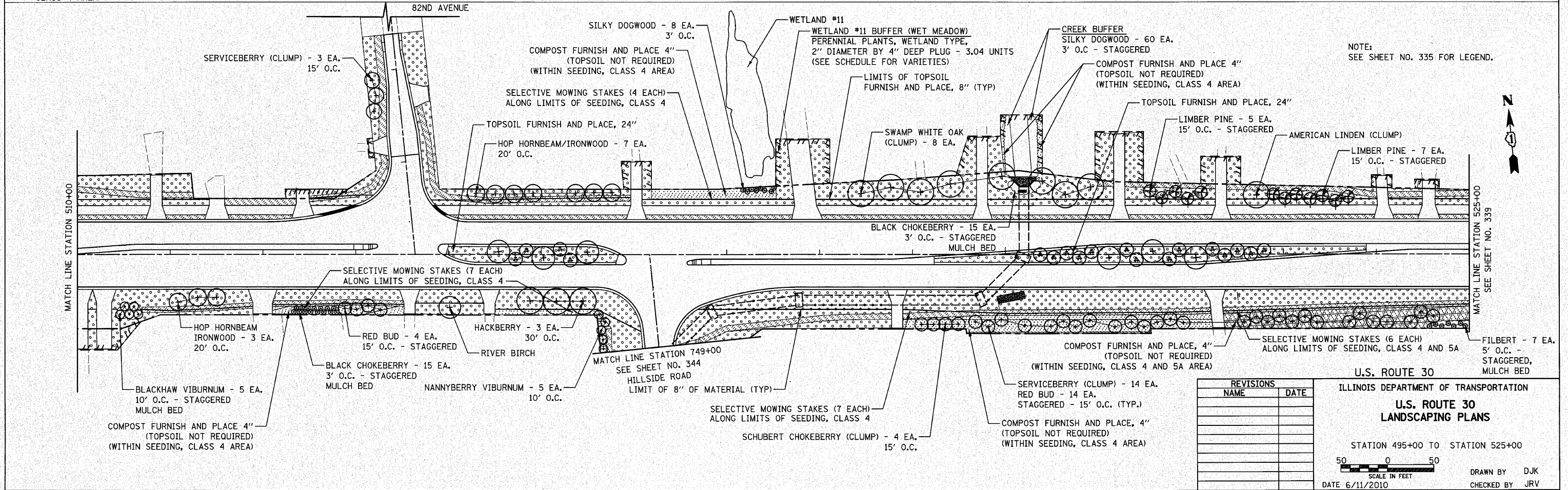

NOTE:
SEE SHEET NO. 335 FOR LEGEND.

U.S. ROUTE 30

ILLINOIS DEPARTMENT OF TRANSPORTATION
U.S. ROUTE 30
LANDSCAPING PLANS

STATION 495+00 TO STATION 525+00

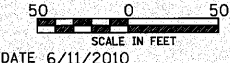

DRAWN BY DJK
CHECKED BY JRV

REVISIONS	
NAME	DATE

DATE 6/11/2010