

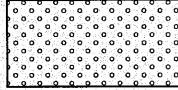

F.A.P. RTE.	SECTION	COUNTY	TOTAL SHEETS	SHEET NO.
353	(12&13)WRS-4	WILL	608	335
STA. 410+00		TO STA. 435+00		
FED. ROAD DIST. NO. 1 ILLINOIS FED. AID PROJECT				

**LEGEND**

-  SEEDING, CLASS 2A
-  SEEDING, CLASS 4
-  SEEDING, CLASS 4B (MODIFIED WETLAND MIX)
-  SEEDING, CLASS 4 AND SEEDING, CLASS 5A
-  SODDING, SALT TOLERANT
-  STONE RIPRAP (SEE DETAIL SHEETS AND CULVERT PLANS FOR GRADATION AND PLACEMENT DETAILS)

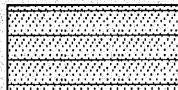
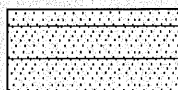
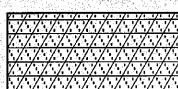

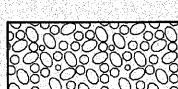
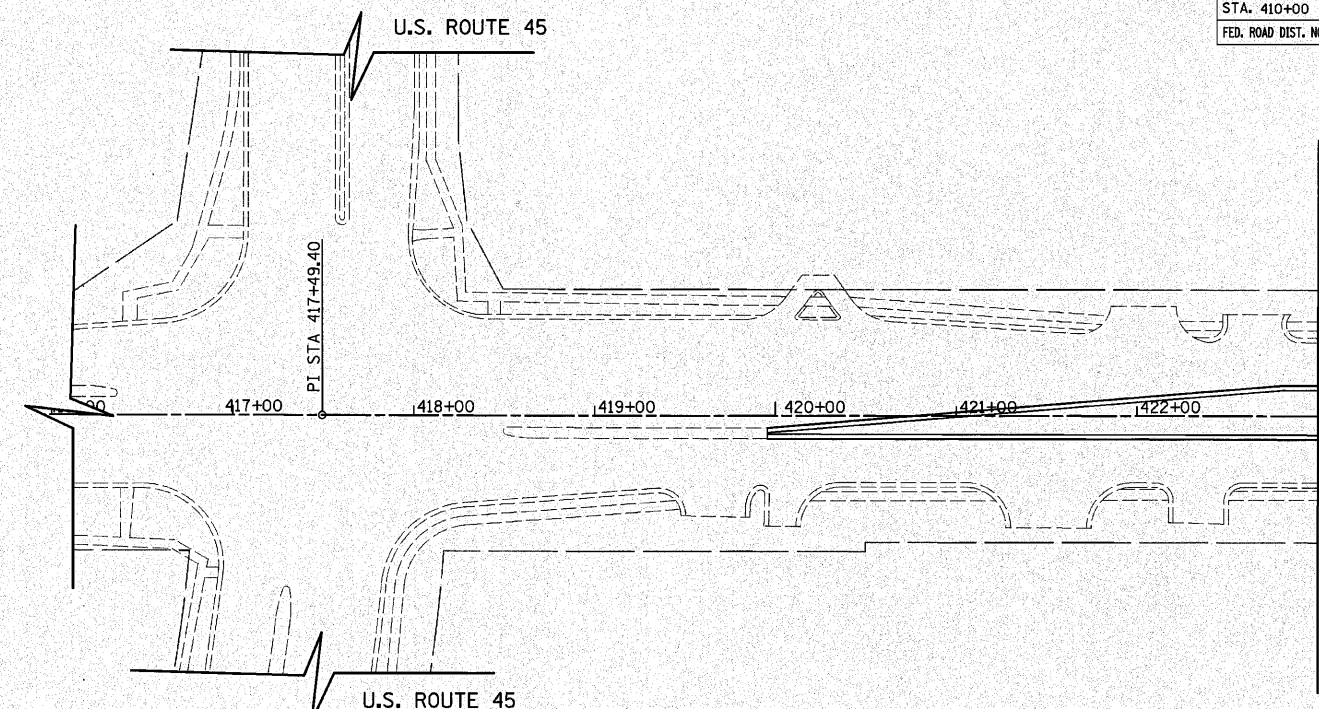
**NOTES**

- 1) 8" OF MATERIAL SHALL BE PLACED ON US ROUTE 30 AND HARLEM AVENUE FROM THE BACK OF CURB TO THE LIMIT LINE SHOWN ON THESE PLANS AND AS SHOWN ON THE CROSS SECTIONS. THIS 8" MATERIAL SHALL BE TOPSOIL FURNISH AND PLACE, 8" UNLESS SEEDING CLASS 4 IS SHOWN, IN WHICH CASE 4" OF TOPSOIL AND 4" OF COMPOST SHALL BE USED. ALL AREAS BEYOND THE LIMIT LINE, INCLUDING THE SIDESTREETS, SHALL HAVE TOPSOIL FURNISH AND PLACE, 4" UNLESS OTHERWISE NOTED.
- 2) SEE SHEET NO. 348-363 FOR MEDIAN PLANTING PLANS.
- 3) ALL ORNAMENTAL PERENNIAL BEDS AND SODDING IN THE MEDIANS WILL BE TEMPORARILY SEEDED WITH SEEDING, CLASS 2A UNTIL READY FOR FINAL PLANTING.

U.S. ROUTE 30

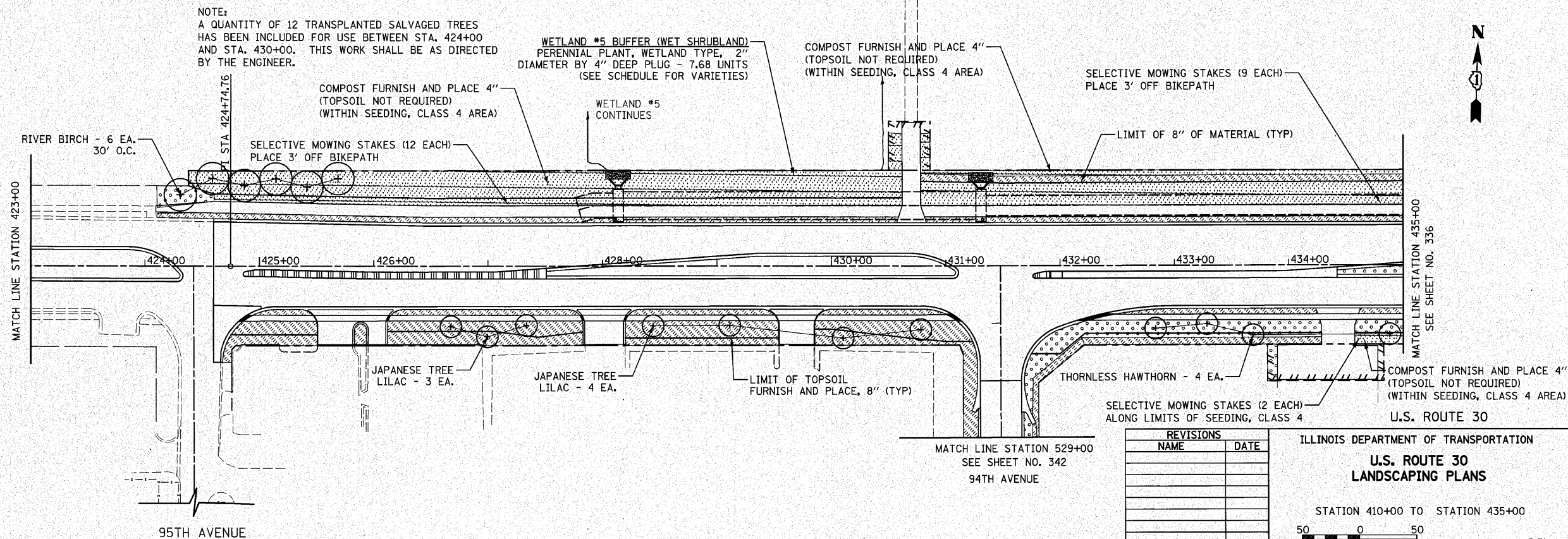

NOTE:  
A QUANTITY OF 12 TRANSPLANTED SALVAGED TREES HAS BEEN INCLUDED FOR USE BETWEEN STA. 424+00 AND STA. 430+00. THIS WORK SHALL BE AS DIRECTED BY THE ENGINEER.

REVISIONS	
NAME	DATE

ILLINOIS DEPARTMENT OF TRANSPORTATION  
**U.S. ROUTE 30  
 LANDSCAPING PLANS**

STATION 410+00 TO STATION 435+00

SCALE IN FEET  
 50 0 50

DATE 6/11/2010

DRAWN BY DJK  
 CHECKED BY JRV