

F.A.P. RTE.	SECTION	COUNTY	TOTAL SHEETS	SHEET NO.
353	(12&13)WRS-4	WILL	608	210
STA.		TO STA.		
FED. ROAD DIST. NO. 1		ILLINOIS	FED. AID PROJECT	

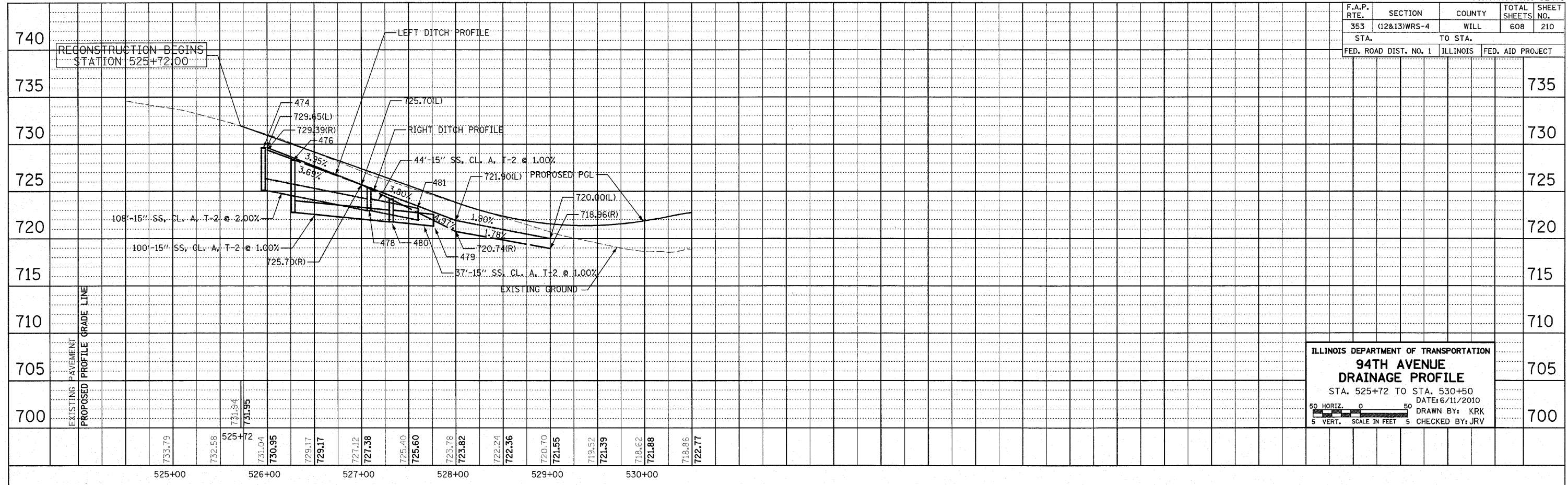

ILLINOIS DEPARTMENT OF TRANSPORTATION  
**94TH AVENUE**  
**DRAINAGE PROFILE**  
 STA. 525+72 TO STA. 530+50  
 DATE: 6/11/2010  
 DRAWN BY: KRK  
 CHECKED BY: JRV

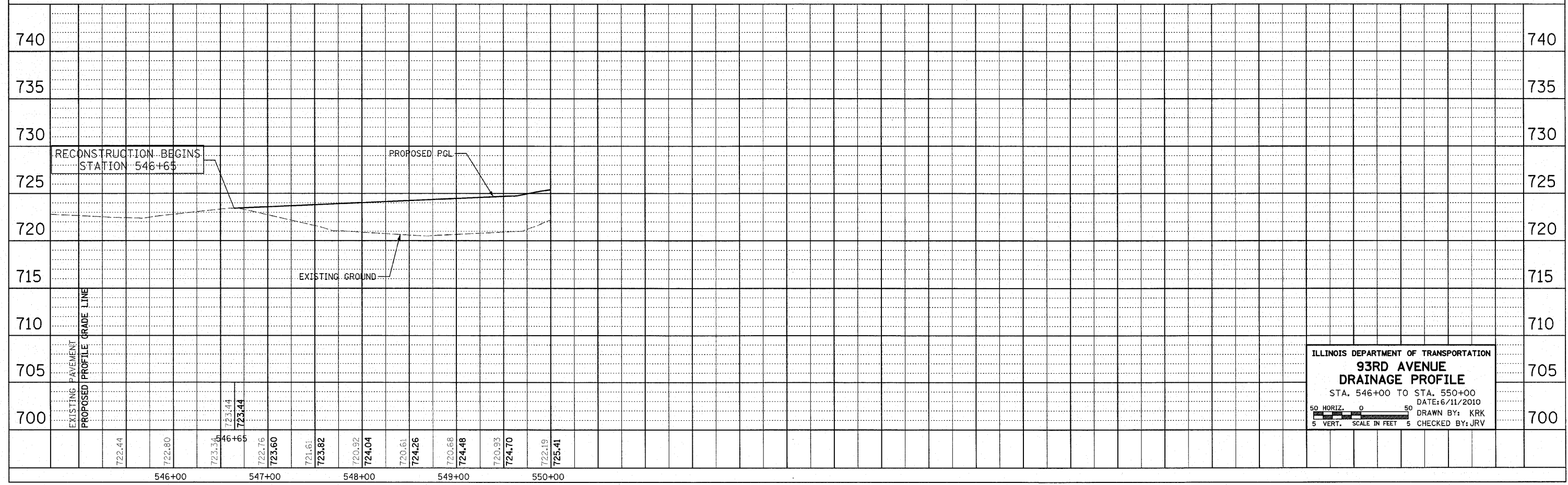

ILLINOIS DEPARTMENT OF TRANSPORTATION  
**93RD AVENUE**  
**DRAINAGE PROFILE**  
 STA. 546+00 TO STA. 550+00  
 DATE: 6/11/2010  
 DRAWN BY: KRK  
 CHECKED BY: JRV