

F.A.P. RTE.	SECTION	COUNTY	TOTAL SHEETS	SHEET NO.
353	(12&13)WRS-4	WILL	608	116
STA. 1002+00		TO STA. 1025+00		
FED. ROAD DIST. NO. 1		ILLINOIS FED. AID PROJECT		

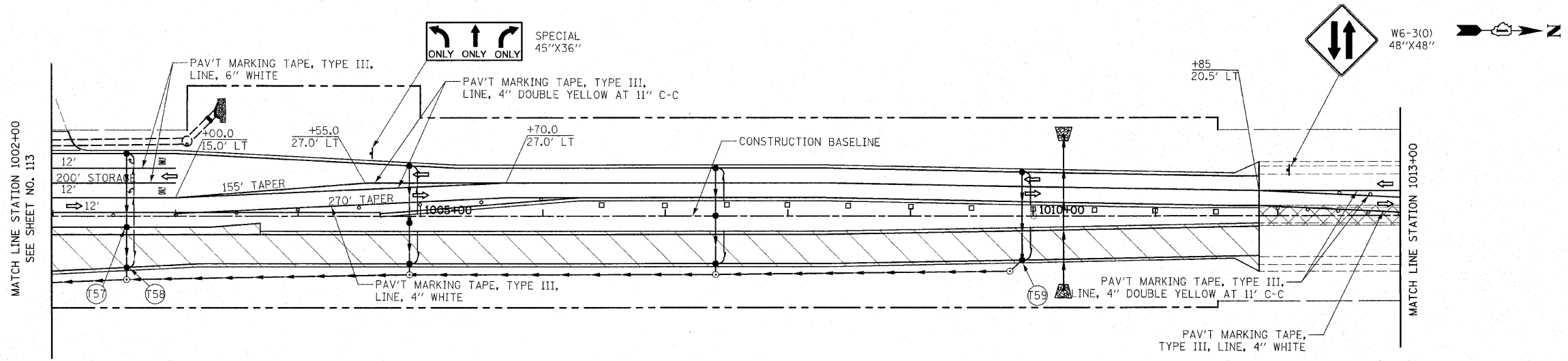

LEGEND

- TEMPORARY PAVEMENT
- CONSTRUCTION WORK ZONE
- DIRECTION OF TRAFFIC FLOW
- ARROW BOARD
- TYPE I OR II BARRICADE
- VERTICAL PANEL WITH STEADY BURNING LIGHT
- TYPE III BARRICADE WITH FLASHING LIGHTS

HARLEM AVENUE

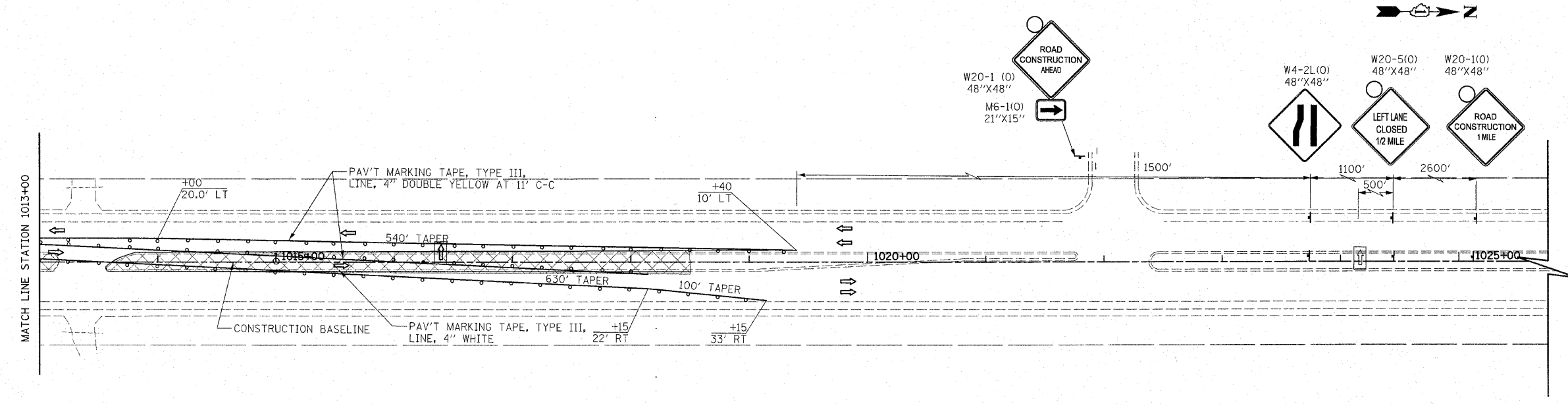

HARLEM AVENUE

REVISIONS	
NAME	DATE

ILLINOIS DEPARTMENT OF TRANSPORTATION  
HARLEM AVENUE  
MAINTENANCE OF TRAFFIC  
STAGE 2

STATION 1002+00 TO STATION 1025+00

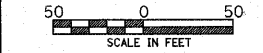

SCALE IN FEET  
DATE 6/11/2010  
DRAWN BY DJK  
CHECKED BY JRV