

CONSTRUCTION NOTES:

- 1. INSTALL UNINTERRUPTIBLE POWER SUPPLY UNIT.
- 2. INSTALL NEW SERVICE INSTALLATION, SERVICE CABLE, AND GROUND CABLE AND REMOVE EXISTING SERVICE INSTALLATION.
- 3. ALL CABINET MODIFICATIONS AND/OR LOAD SWITCH REPLACEMENTS REQUIRED FOR PROPER OPERATION OF THE LED SIGNAL INDICATIONS TO THE SATISFACTION OF THE ENGINEER SHALL BE INCIDENTAL TO THE PAY ITEM: UNINTERRUPTIBLE POWER SUPPLY.
- 4. THE CONTRACTOR SHALL REMOVE ALL EXISTING PAVEMENT MARKINGS PRIOR TO INSTALLING NEW THERMOPLASTIC PAVEMENT MARKINGS.
- 5. THE TEMPORARY RADIO INTERCONNECT SHALL BE REMOVED AFTER THE FIBER OPTIC INTERCONNECT TO LINCOLN AVENUE/SUNNYDALE BOULEVARD AND WESTVIEW CENTER IS INSTALLED AND OPERATIONAL.
- 6. THE CONTRACTOR SHALL REMOVE THE EXISTING CONTROLLER AND INSTALL A NEW CONTROLLER, SPECIAL IN THE EXISTING CABINET.

TRAFFIC SIGNAL LEGEND

COMBINATION CONCRETE CURB & GUTTER
PORTLAND CEMENT CONCRETE SIDEWALK, 5"
DETECTABLE WARNING

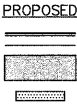

* 100% OF THE COST TO THE VILLAGE OF STREAMWOOD

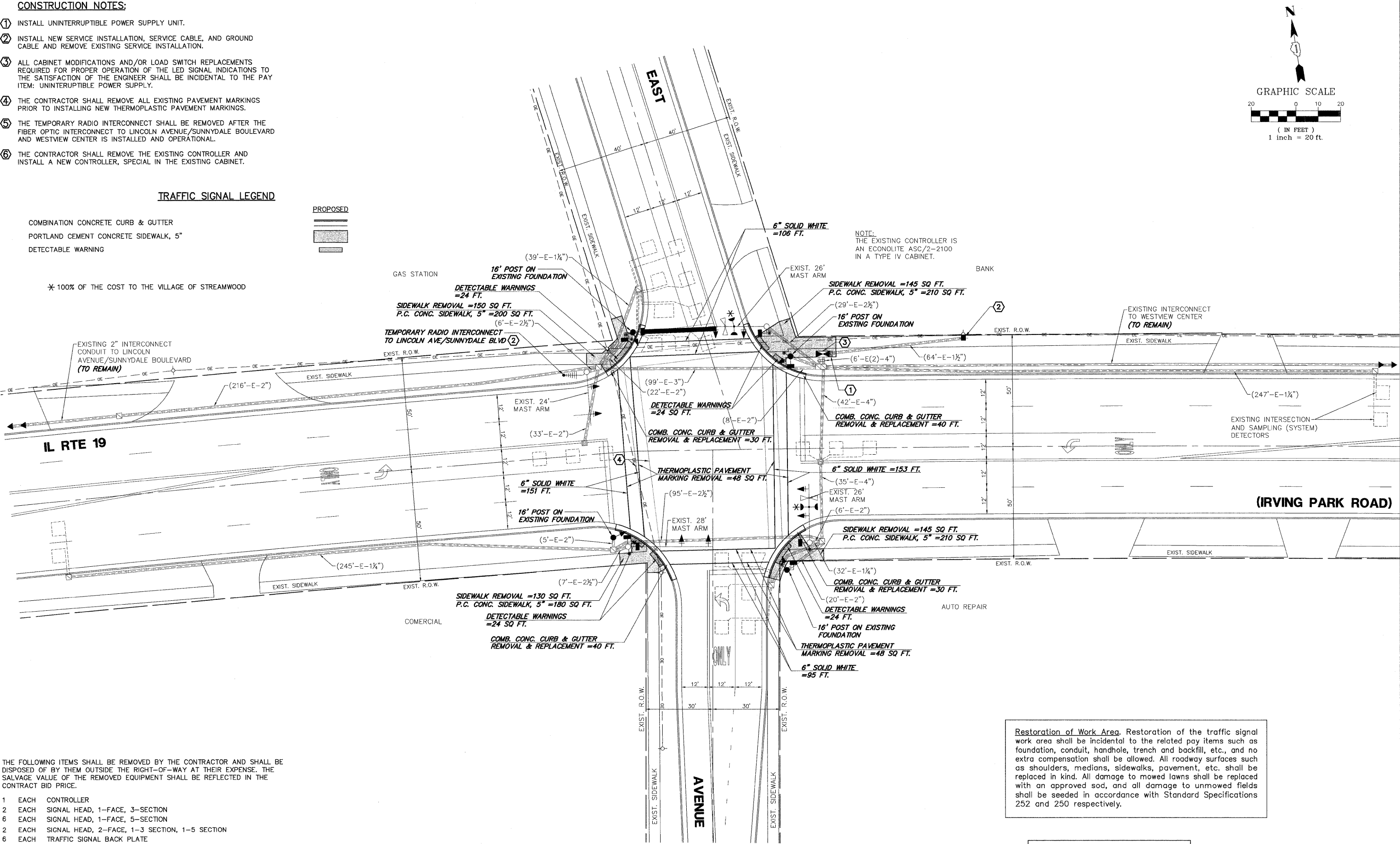

THE FOLLOWING ITEMS SHALL BE REMOVED BY THE CONTRACTOR AND SHALL BE DISPOSED OF BY THEM OUTSIDE THE RIGHT-OF-WAY AT THEIR EXPENSE. THE SALVAGE VALUE OF THE REMOVED EQUIPMENT SHALL BE REFLECTED IN THE CONTRACT BID PRICE.

- 1 EACH CONTROLLER
- 2 EACH SIGNAL HEAD, 1-FACE, 3-SECTION
- 6 EACH SIGNAL HEAD, 1-FACE, 5-SECTION
- 2 EACH SIGNAL HEAD, 2-FACE, 1-3 SECTION, 1-5 SECTION
- 6 EACH TRAFFIC SIGNAL BACK PLATE
- 4 EACH PEDESTRIAN SIGNAL HEAD, 1-FACE
- 2 EACH PEDESTRIAN SIGNAL HEAD, 2-FACE
- 7 EACH PEDESTRIAN PUSH-BUTTON
- 1 EACH SERVICE INSTALLATION

Restoration of Work Area. Restoration of the traffic signal work area shall be incidental to the related pay items such as foundation, conduit, handhole, trench and backfill, etc., and no extra compensation shall be allowed. All roadway surfaces such as shoulders, medians, sidewalks, pavement, etc. shall be replaced in kind. All damage to mowed lawns shall be replaced with an approved sod, and all damage to unmowed fields shall be seeded in accordance with Standard Specifications 252 and 250 respectively.

THE TRAFFIC SIGNAL CONTROL EQUIPMENT FOR THIS PROJECT SHALL BE "ECONOLITE" TO MATCH THE EXISTING ADJACENT SYSTEM.

FILE NAME =	USER NAME = ZACH WALLSTEN	DESIGNED - JRD	REVISED -	STATE OF ILLINOIS DEPARTMENT OF TRANSPORTATION		TRAFFIC SIGNAL MODERNIZATION PLAN IL ROUTE 19 (IRVING PARK ROAD) AT EAST AVENUE		FAP RTE.	SECTION	COUNTY	TOTAL SHEETS	SHEET NO.
4085.865-TR1.dwg		DRAWN - ZCW	REVISED -					VARIABLES	2010-005TS	COOK	32	21
	PLOT SCALE = 1" = .08'	CHECKED - KLB	REVISED -									
	PLOT DATE = 10/12/2010	DATE - 10/12/2010	REVISED -									
				SCALE 1"=20'		SHEET NO. OF SHEETS		STA. TO STA.		ILLINOIS FED. AID PROJECT		
										CONTRACT # 60K23		

GHA #4085.865