

RTE.	SECTION	COUNTY	TOTAL SHEETS	SHEET NO.
FAI 80	150-2HBR	LA SALLE	460	47
STA. 52+95		TO STA. 60+70		
FED. ROAD DIST. NO.	ILLINOIS	FED. AID PROJECT		

CONTRACT NO. 86603

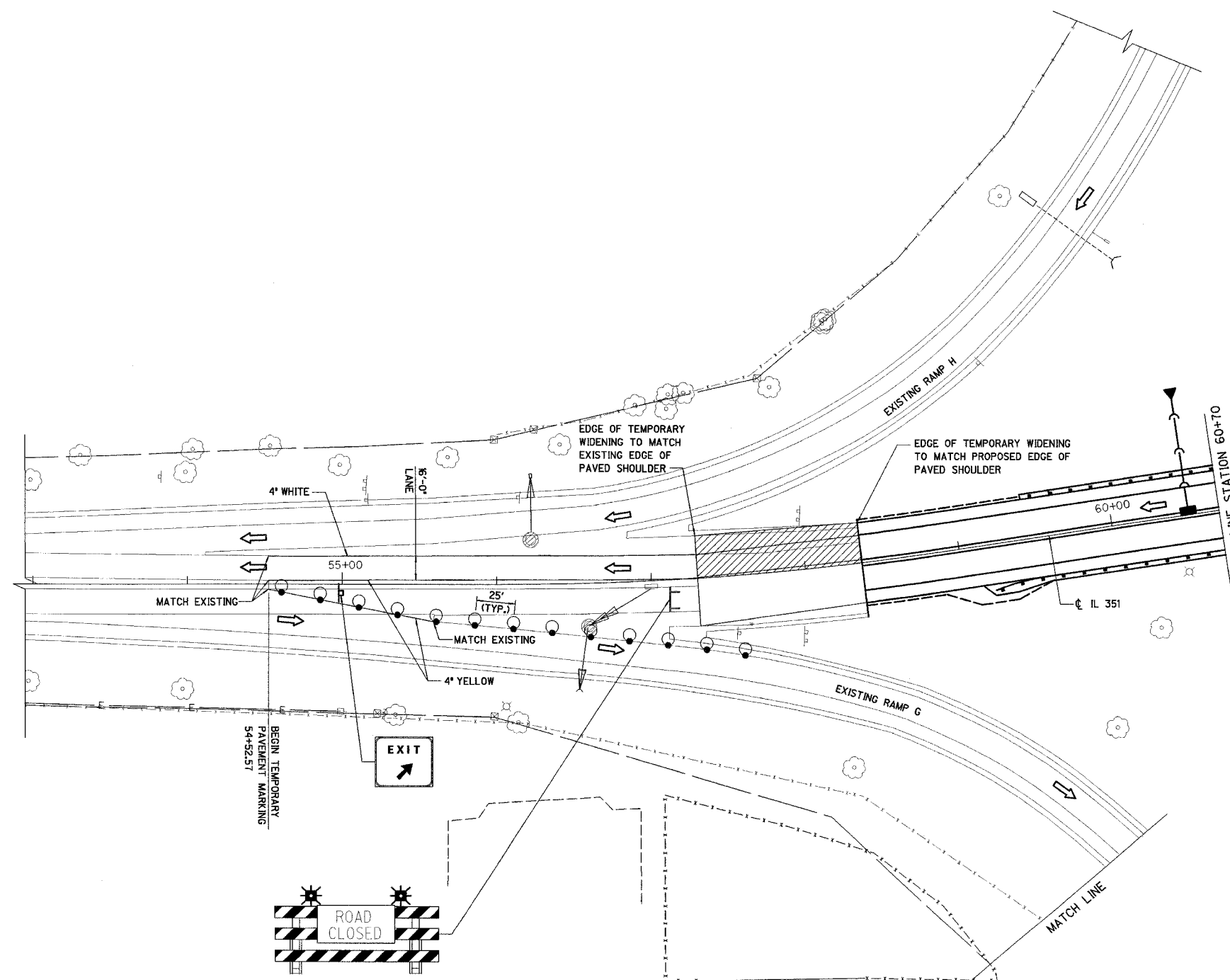

REVISIONS	DATE
NAME	

ILLINOIS DEPARTMENT OF TRANSPORTATION
STAGE IIIa CONSTRUCTION PLAN
 F.A.I. 80 AT ILLINOIS ROUTE 351
 STATION 52+95 TO STATION 60+70
 DATE: 09/04
 DRAWN BY: MES
 CHECKED BY: MTD

