

STATE OF ILLINOIS  
DEPARTMENT OF TRANSPORTATION

| F.A.U. RTE. | SECTION  | COUNTY | TOTAL SHEETS       | SHEET NO. |
|-------------|----------|--------|--------------------|-----------|
| 1419        | 0405RS-6 | COOK   | 21                 | 1         |
| ILLINOIS    |          |        | CONTRACT NO. 62A03 |           |

FOR INDEX OF SHEETS, SEE SHEET NO. 2

THE IMPROVEMENT IS LOCATED IN THE VILLAGES OF RIVER FOREST AND FOREST PARK

# PROPOSED HIGHWAY PLANS

F.A.U. ROUTE: 1419 – MADISON ST.  
THATCHER AVE. TO VAN BUREN ST.  
SECTION: 0405RS-6  
RESURFACING, ADA RAMPS  
COOK COUNTY

C-91-054-15

ACM-1419(006)

R. 12 E. R. 13 E.

**TRAFFIC DATA**

ADT (2014) = 11,700

POSTED SPEED LIMIT = 25 MPH

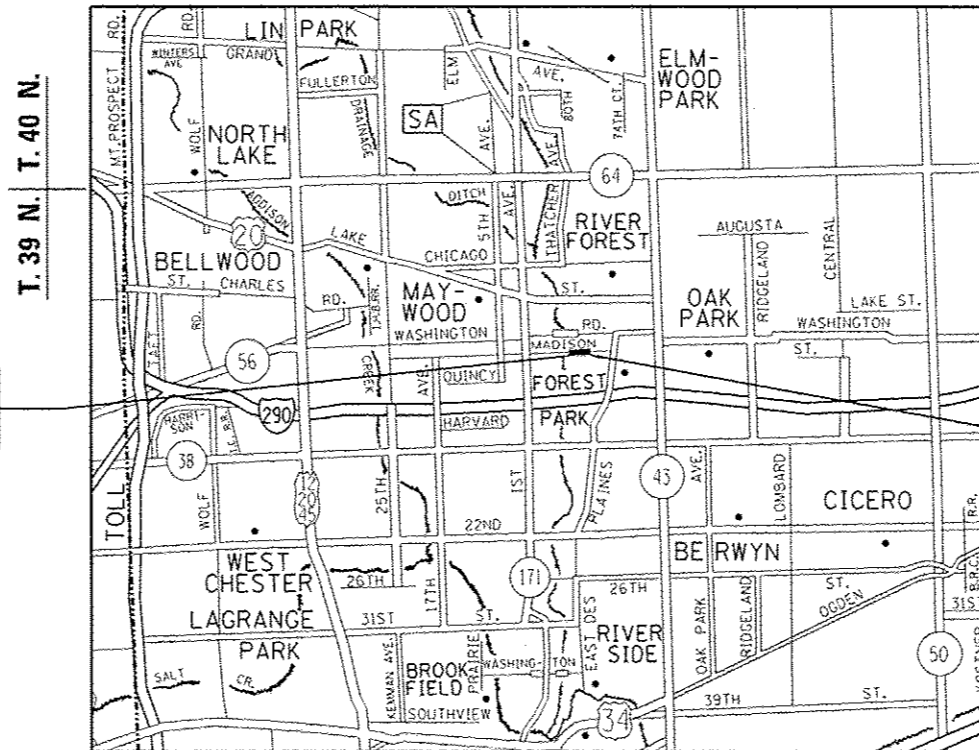
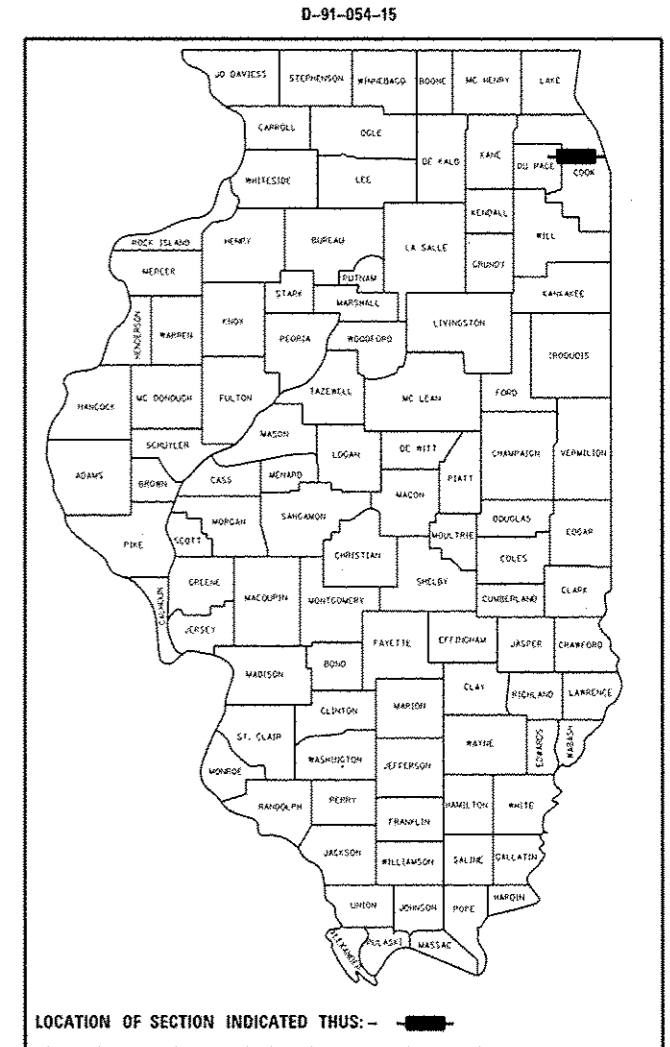

IMPROVEMENT BEGINS  
STA. 7 + 00

IMPROVEMENT ENDS  
STA. 32 + 40.4

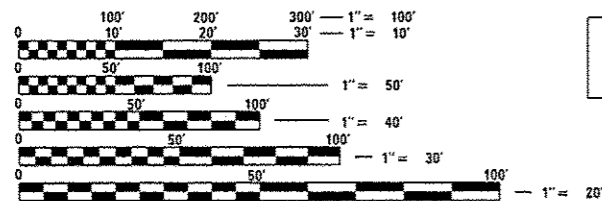

FULL SIZE PLANS HAVE BEEN PREPARED USING STANDARD ENGINEERING SCALES. REDUCED SIZED PLANS WILL NOT CONFORM TO STANDARD SCALES. IN MAKING MEASUREMENTS ON REDUCED PLANS, THE ABOVE SCALES MAY BE USED.

J.U.L.I.E.  
JOINT UTILITY LOCATION INFORMATION FOR EXCAVATION  
1-800-892-0123  
OR 811

RIVER FOREST & PROVISO TOWNSHIPS

GROSS & NET LENGTH = 1739.0 FT. = 0.329 MILE  
OF RESURFACING

PROJECT ENGINEER J. ALAIN MIDY (847) 221-3056  
PROJECT MANAGER ISSAM RAYYAN (847) 705-4178

CONTRACT NO. 62A03

STATE OF ILLINOIS  
DEPARTMENT OF TRANSPORTATION

SUBMITTED *October 25, 2016*

*John F. ...*  
REGIONAL ENGINEER

*Dec 9 2016*  
*M. Addis, P.E.*  
ENGINEER OF DESIGN AND ENVIRONMENT

*Dec 9 2016*  
*... 2*  
DIRECTOR OF PROGRAM DEVELOPMENT

PRINTED BY THE AUTHORITY  
OF THE STATE OF ILLINOIS

**INDEX OF SHEETS**

| SHEET NO. | DESCRIPTION  |
|-----------|--|
| 1.        | TITLE SHEET  |
| 2.        | INDEX OF SHEETS, STATE STANDARDS, AND GENERAL NOTES  |
| 3-4.      | SUMMARY OF QUANTITIES  |
| 5.        | TYPICAL SECTIONS   |
| 6-8.      | ROADWAY & PAVEMENT MARKING PLANS   |
| 9-11.     | ADA RAMP DETAILS   |
| 12.       | DETAILS FOR FRAMES AND LIDS ADJUSTMENT WITH MILLING (BD-8)                                 |
| 13.       | PAVEMENT PATCHING FOR HOT-MIX ASPHALT SURFACED PAVEMENT (BD-22)                            |
| 14.       | CURB OR CURB AND GUTTER REMOVAL AND REPLACEMENT (BD-24)                                    |
| 15.       | TRAFFIC CONTROL AND PROTECTION FOR SIDE ROADS, INTERSECTIONS AND DRIVEWAYS (TC-10)         |
| 16.       | TYPICAL APPLICATIONS RAISED REFLECTIVE PAVEMENT MARKERS (SNOW PLOW RESISTANT) (TC-11)      |
| 17.       | DISTRICT ONE TYPICAL PAVEMENT MARKINGS (TC-13)   |
| 18.       | SHORT TERM PAVEMENT MARKING LETTERS AND SYMBOLS (TC-16)                                    |
| 19-20.    | ARTERIAL ROAD INFORMATION SIGNING (TC-22)  |
| 21.       | TYPICAL SUPPLEMENTAL SIGNING AND PAVEMENT MARKING TREATMENT FOR RAILROAD CROSSINGS (TC-23) |

**STATE STANDARDS**

| STANDARD NO | DESCRIPTION   |
|-------------|---|
| 424001-09   | PERPENDICULAR CURB RAMPS FOR SIDEWALKS                                    |
| 424021-03   | DEPRESSED CORNER FOR SIDEWALKS  |
| 442201-03   | CLASS C AND D PATCHES   |
| 606001-06   | CONCRETE CURB TYPE B AND COMBINATION CONCRETE CURB AND GUTTER             |
| 701101-05   | OFF-ROAD OPERATIONS, MULTILANE, 15' TO 24" FROM PAVEMENT EDGE             |
| 701427-05   | LANE CLOSURE, MULTILANE, INTERMITTENT OR MOVING OPER. FOR SPEEDS < 40 MPH |
| 701602-03   | URBAN LANE CLOSURE, MULTILANE, 2W WITH BIDIRECTIONAL LEFT TURN LANE       |
| 701606-10   | URBAN LANE CLOSURE, MULTILANE, 2W WITH MOUNTABLE MEDIAN                   |
| 701701-10   | URBAN LANE CLOSURE, MULTILANE INTERSECTION                                |
| 701801-06   | SIDEWALK CORNER OR CROSSWALK CLOSURE                                      |
| 701901-06   | TRAFFIC CONTROL DEVICES   |

**GENERAL NOTES:**

BEFORE STARTING ANY EXCAVATION, THE CONTRACTOR SHALL CALL "JULIE" AT 800-892-0123 OR 811 FOR FIELD LOCATIONS OF BURIED ELECTRIC, TELEPHONE AND GAS FACILITIES (48 HOUR NOTIFICATION IS REQUIRED).

THE CONTRACTOR SHALL COORDINATE CONSTRUCTION ACTIVITIES WITH UTILITY COMPANIES AND THE VILLAGES OF RIVER FOREST AND FOREST PARK.

THE CONTRACTOR WILL NOT BE ALLOWED TO SET UP A YARD OR FIELD OFFICE ON STATE PROPERTY WITHOUT WRITTEN PERMISSION FROM THE DEPARTMENT.

ANY PAVEMENT MARKINGS AND RAISED REFLECTIVE PAVEMENT MARKERS OBLITERATED BY MILLING AND RESURFACING OPERATIONS ON SIDE STREETS AND ENTRANCES SHALL BE REPLACED AND PAID FOR IN KIND.

WHEN MILLED PAVEMENT IS OPEN TO TRAFFIC THE MAXIMUM GRADE DIFFERENTIAL BETWEEN PASSES OF THE MILLING MACHINE SHALL NOT EXCEED 1/2 INCHES (40MM) WHERE THE SPEED LIMIT IS 40 MPH (80KM/H) OR LESS AND 1 INCH (25 MM) WHERE THE SPEED LIMIT IS GREATER THAN 40 MPH (80 KM/H), WITH WRITTEN APPROVAL FROM THE ENGINEER. A MAXIMUM GRADE DIFFERENTIAL OF 3 INCHES (75 MM) MAY BE ALLOWED IF THE EDGE OF THE MILLING IS SLOPED A MINIMUM 1:3 (V:H) OR A NOTCHED LONGITUDINAL WEDGE IS USED.

BEFORE BEGINNING ANY WORK, THE CONTRACTOR SHALL RETAIN AND RECORD FOR FUTURE REFERENCE, ALL EXISTING PAVEMENT MARKING LINES AND REVISED REFLECTIVE PAVEMENT MARKERS IN ORDER THAT THESE LOCATIONS CAN BE RE-ESTABLISHED FOR STRIPING. EXACT LOCATIONS OF ALL PAVEMENT MARKINGS SHALL BE AS DIRECTED BY THE ENGINEER.

THE RESIDENT ENGINEER SHALL CONTACT CORY JUCIUS, ARTERIAL TRAFFIC FIELD ENGINEER AT CORY.JUCIUS@ILLINOIS.GOV A MINIMUM OF TWO (2) WEEKS PRIOR TO THE PLACEMENT OF PERMANENT PAVEMENT MARKINGS.

DRAINAGE ADJUSTMENT OR RECONSTRUCTION LOCATIONS WILL BE DETERMINED IN THE FIELD BY THE ENGINEER.

THE CONTRACTOR SHALL CONTACT THE DISTRICT ONE TRAFFIC CONTROL SUPERVISOR AT (847) 705-4470 A MINIMUM OF 72 HOURS IN ADVANCE OF BEGINNING WORK.

IT SHALL BE THE CONTRACTOR'S RESPONSIBILITY TO VERIFY ALL DIMENSIONS AND CONDITIONS EXISTING IN THE FIELD PRIOR TO CONSTRUCTION AND ORDERING OF MATERIALS.

THE CONTRACTOR SHALL BE REQUIRED TO PROVIDE ACCESS TO ABUTTING PROPERTY AT ALL TIMES DURING THE CONSTRUCTION OF THIS PROJECT.

EXISTING BROKEN FRAMES AND LIDS SHALL BE REMOVED AND DISPOSED OF BY THE CONTRACTOR AND SHALL BE REPLACED AS DIRECTED BY THE ENGINEER. REPLACEMENT FRAMES AND LIDS WILL BE PAID FOR ACCORDING TO ARTICLE 109.04 OF THE STANDARD SPECIFICATIONS UNLESS A SEPARATE PAY ITEM HAS BEEN PROVIDED.

DO NOT SCALE PLANS FOR CONSTRUCTION DIMENSIONS.

DOUBLE LANE MARKERS ARE TO BE USED AS SHOWN ON THE DISTRICT ONE DETAIL "TYPICAL APPLICATIONS - RAISED REFLECTIVE PAVEMENT MARKERS (SNOW-PLOW RESISTANT)" SHOWN IN THE PLANS.

ALL PAVEMENT PATCHING LOCATIONS WILL BE DETERMINED IN THE FIELD BY THE ENGINEER.

LOCATION OF COMBINATION CONCRETE CURB AND GUTTER REMOVAL AND REPLACEMENT WILL BE DETERMINED IN THE FIELD BY THE ENGINEER.

THESE PLANS HAVE BEEN PREPARED FROM NOTES RECEIVED FROM THE BUREAU OF CONSTRUCTION.

BUTT JOINTS WILL BE INSTALLED AT THE ENDS OF ALL RESURFACING (WHERE RESURFACING MEETS EXISTING PAVEMENT) ACCORDING TO THE "BUTT JOINT AND HOT-MIX ASPHALT TAPER DETAILS" SHEET INCLUDED IN THE PLANS, UNLESS OTHERWISE SPECIFIED.

OVERNIGHT LANE CLOSURES SHALL NOT BE ALLOWED FOR REHABILITATION PROJECTS INVOLVING DAYTIME MILLING AND RESURFACING OPERATIONS AND CLASS D PATCHING UNLESS OTHER CONDITIONS WARRANT EXTENDED LANE CLOSURES AS DETERMINED AND APPROVED IN WRITING BY THE ENGINEER OR AS PROVIDED FOR IN THE CONTRACT SPECIFICATIONS.

SIDEWALK RAMPS MODIFICATIONS WITHIN THE LIMITS OF THE PROJECT SHALL CONFORM TO THE APPLICABLE HIGHWAY STANDARDS INCLUDED IN THE PLANS.

REV.

|             |             |            |           |   |   |                           |          |                 |              |              |  |
|-------------|-------------|------------|-----------|---|---|---------------------------|----------|-----------------|--------------|--------------|--|
| FILE NAME : | USER NAME : | DESIGNED : | REVISED : | <b>STATE OF ILLINOIS<br/>DEPARTMENT OF TRANSPORTATION</b> | <b>INDEX OF SHEETS, STATE STANDARDS<br/>AND GENERAL NOTES</b> | F.A.U. RTE.               | SECTION  | COUNTY          | TOTAL SHEETS | SHEET NO.    |  |
| Default     | pyzanoski   | -          | -         |   |   | 1419                      | 0405RS-6 | COOK            | 21           | 2            |  |
|             |             | CHECKED :  | REVISED : |   |   | SCALE:                    |          | SHEET OF SHEETS |              | STA. TO STA. |  |
|             |             | DATE :     | -         |   |   | ILLINOIS FED. AID PROJECT |          |                 |              |              |  |

| SUMMARY OF QUANTITIES |  |       | CONSTRUCTION TYPE CODE 0005 |        |  |  |  |
|-----------------------|--|-------|-----------------------------|--------|--|--|--|
| CODE NO               | ITEM   | UNIT  | TOTAL QUANTITIES            | 0005   |  |  |  |
| 21101615              | TOPSOIL FURNISH AND PLACE, 4"                              | SO YD | 54.5                        | 54.5   |  |  |  |
| 25200110              | SODDING, SALT TOLERANT                                     | SO YD | 88.5                        | 88.5   |  |  |  |
| 40600400              | MIXTURE FOR CRACKS, JOINTS, AND FLANGEWAYS                 | TON   | 16                          | 16     |  |  |  |
| 40600827              | POLYMERIZED LEVELING BINDER (MACHINE METHOD), IL-4.75, N50 | TON   | 428                         | 428    |  |  |  |
| 40600982              | HOT-MIX ASPHALT SURFACE REMOVAL - BUTT JOINT               | SO YD | 125                         | 125    |  |  |  |
| 40601005              | HOT-MIX ASPHALT REPLACEMENT OVER PATCHES                   | TON   | 233                         | 233    |  |  |  |
| 40603340              | HOT-MIX ASPHALT SURFACE COURSE, MIX "D", N70               | TON   | 871                         | 871    |  |  |  |
| 40600290              | BITUMINOUS MATERIALS (TACK COAT)                           | POUND | 7001                        | 7001   |  |  |  |
| 42001300              | PROTECTIVE COAT  | SO YD | 154                         | 154    |  |  |  |
| 42400200              | PORTLAND CEMENT CONCRETE SIDEWALK 5 INCH                   | SO FT | 1385.5                      | 1385.5 |  |  |  |
| 42400800              | DETECTABLE WARNINGS  | SO FT | 96                          | 96     |  |  |  |
| 44000158              | HOT-MIX ASPHALT SURFACE REMOVAL, 2 1/4"                    | SO YD | 10369                       | 10369  |  |  |  |
| 44000600              | SIDEWALK REMOVAL   | SO FT | 1405.5                      | 1405.5 |  |  |  |
| 44002216              | HOT-MIX ASPHALT REMOVAL OVER PATCHES, 4"                   | SO YD | 1037                        | 1037   |  |  |  |
| 44201749              | CLASS D PATCHES, TYPE I, 9 INCH                            | SO YD | 28                          | 28     |  |  |  |
| 44201753              | CLASS D PATCHES, TYPE II, 9 INCH                           | SO YD | 118                         | 118    |  |  |  |

| SUMMARY OF QUANTITIES |   |        | CONSTRUCTION TYPE CODE 0005 |      |  |  |  |
|-----------------------|---|--------|-----------------------------|------|--|--|--|
| CODE NO               | ITEM  | UNIT   | TOTAL QUANTITIES            | 0005 |  |  |  |
| 44201757              | CLASS D PATCHES, TYPE III, 9 INCH                 | SO YD  | 20                          | 20   |  |  |  |
| 44201759              | CLASS D PATCHES, TYPE IV, 9 INCH                  | SO YD  | 871                         | 871  |  |  |  |
| 60262700              | INLETS TO BE RECONSTRUCTED                        | EACH   | 3                           | 3    |  |  |  |
| 60600605              | CONCRETE CURB, TYPE B                             | FOOT   | 20                          | 20   |  |  |  |
| 60603800              | COMBINATION CONCRETE CURB AND GUTTER, TYPE B-6.12 | FOOT   | 215                         | 215  |  |  |  |
| * 66900200            | NON-SPECIAL WASTE DISPOSAL                        | CU YD  | 22                          | 22   |  |  |  |
| * 66900450            | SPECIAL WASTE PLANS AND REPORTS                   | L SUM  | 1                           | 1    |  |  |  |
| * 66900530            | SOIL DISPOSAL ANALYSIS                            | EACH   | 1                           | 1    |  |  |  |
| 67000400              | ENGINEER'S FIELD OFFICE, TYPE A                   | CAL MO | 6                           | 6    |  |  |  |
| 67100100              | MOBILIZATION                                      | L SUM  | 1                           | 1    |  |  |  |
| 70102625              | TRAFFIC CONTROL AND PROTECTION, STANDARD 701606   | L SUM  | 1                           | 1    |  |  |  |
| 70102632              | TRAFFIC CONTROL AND PROTECTION, STANDARD 701602   | L SUM  | 1                           | 1    |  |  |  |
| 70102635              | TRAFFIC CONTROL AND PROTECTION, STANDARD 701701   | L SUM  | 1                           | 1    |  |  |  |
| 70102640              | TRAFFIC CONTROL AND PROTECTION, STANDARD 701801   | L SUM  | 1                           | 1    |  |  |  |
| 70300100              | SHORT TERM PAVEMENT MARKING                       | FOOT   | 462                         | 462  |  |  |  |
| 70300150              | SHORT TERM PAVEMENT MARKING REMOVAL               | SO FT  | 153                         | 153  |  |  |  |

|              |             |            |           |   |   |                    |                     |        |              |   |  |
|--------------|-------------|------------|-----------|---|---|--------------------|---------------------|--------|--------------|---|--|
| FILE NAME :  | USER NAME : | DESIGNED - | REVISOR - | <b>STATE OF ILLINOIS</b><br><b>DEPARTMENT OF TRANSPORTATION</b> | <b>MADISON ST. (THATCHER AVE. TO VAN BUREN ST.)</b><br><b>SUMMARY OF QUANTITIES</b> | F.A.U. RTE.        | SECTION             | COUNTY | TOTAL SHEETS | SHEET NO.                                       |  |
| OFFICE :     | PROJECT :   | CHECKED -  | REVISOR - |   |   | 1419               | 0405RS-6            | COOK   | 21           | 3   |  |
| PLOT SCALE : | PLOT DATE : | DATE -     | REVISOR - |   |   | CONTRACT NO. 62A03 |                     |        |              |   |  |
|              |             |            |           |   |   | SCALE:             | SHEET NO. OF SHEETS | STA.   | TO STA.      | FED. ROAD DIST. NO. 1 ILLINOIS FED. AID PROJECT |  |

\* SPECIALTY ITEM

| SUMMARY OF QUANTITIES             |  |       |                  | CONSTRUCTION TYPE CODE 0005 |  |  |  |  |
|-----------------------------------|--|-------|------------------|-----------------------------|--|--|--|--|
| CODE NO                           | ITEM   | UNIT  | TOTAL QUANTITIES | 0005                        |  |  |  |  |
| 70300210                          | TEMPORARY PAVEMENT MARKING LETTERS AND SYMBOLS       | SO FT | 299.8            | 299.8                       |  |  |  |  |
| 70300220                          | TEMPORARY PAVEMENT MARKING - LINE 4"                 | FOOT  | 5606             | 5606                        |  |  |  |  |
| 70300240                          | TEMPORARY PAVEMENT MARKING - LINE 6"                 | FOOT  | 408              | 408                         |  |  |  |  |
| 70300260                          | TEMPORARY PAVEMENT MARKING - LINE 12"                | FOOT  | 497              | 497                         |  |  |  |  |
| 70300280                          | TEMPORARY PAVEMENT MARKING - LINE 24"                | FOOT  | 111              | 111                         |  |  |  |  |
| * 72000100                        | SIGN PANEL - TYPE 1                                  | SO FT | 9                | 9                           |  |  |  |  |
| * 72900100                        | METAL POST - TYPE A                                  | FOOT  | 10.5             | 10.5                        |  |  |  |  |
| * 78000100                        | THERMOPLASTIC PAVEMENT MARKING - LETTERS AND SYMBOLS | SO FT | 299.8            | 299.8                       |  |  |  |  |
| * 78000200                        | THERMOPLASTIC PAVEMENT MARKING - LINE 4"             | FOOT  | 5606             | 5606                        |  |  |  |  |
| * 78000400                        | THERMOPLASTIC PAVEMENT MARKING - LINE 6"             | FOOT  | 408              | 408                         |  |  |  |  |
| * 78000600                        | THERMOPLASTIC PAVEMENT MARKING - LINE 12"            | FOOT  | 497              | 497                         |  |  |  |  |
| * 78000650                        | THERMOPLASTIC PAVEMENT MARKING - LINE 24"            | FOOT  | 111              | 111                         |  |  |  |  |
| * 78100100                        | RAISED REFLECTIVE PAVEMENT MARKER                    | EACH  | 177              | 177                         |  |  |  |  |
| 78300200                          | RAISED REFLECTIVE PAVEMENT MARKER REMOVAL            | EACH  | 177              | 177                         |  |  |  |  |
| X0320050                          | CONSTRUCTION LAYOUT (SPECIAL)                        | LSUM  | 1                | 1                           |  |  |  |  |
| <input type="checkbox"/> X5537800 | STORM SEWERS TO BE CLEANED 12"                       | FOOT  | 1200             | 1200                        |  |  |  |  |

| SUMMARY OF QUANTITIES |  |       |                  | CONSTRUCTION TYPE CODE 0005 |  |  |  |  |
|-----------------------|--|-------|------------------|-----------------------------|--|--|--|--|
| CODE NO               | ITEM   | UNIT  | TOTAL QUANTITIES | 0005                        |  |  |  |  |
| X6030310              | FRAMES AND LIDS TO BE ADJUSTED (SPECIAL)                     | EACH  | 9                | 9                           |  |  |  |  |
| Z0004562              | COMBINATION CONCRETE CURB AND GUTTER REMOVAL AND REPLACEMENT | FOOT  | 365              | 365                         |  |  |  |  |
| Z0018500              | DRAINAGE STRUCTURES TO BE CLEANED                            | EACH  | 10               | 10                          |  |  |  |  |
| Z0030850              | TEMPORARY INFORMATION SIGNING                                | SO FT | 51.4             | 51.4                        |  |  |  |  |
| Z0048665              | RAILROAD PROTECTIVE LIABILITY INSURANCE                      | L SUM | 1                | 1                           |  |  |  |  |

|  |                          |                |               |   |   |   |                     |                |                    |                |
|--|--------------------------|----------------|---------------|---|---|---|---------------------|----------------|--------------------|----------------|
| FILE NAME:<br>P:\VLD\BHE\BID\ETG\trns\pwr\DOT\Documents\1001 | USER NAME:<br>pjr2005110 | DESIGNED:<br>- | REVISED:<br>- | <b>STATE OF ILLINOIS<br/>DEPARTMENT OF TRANSPORTATION</b> | <b>MADISON ST. (THATCHER AVE. TO VAN BUREN ST.)<br/>SUMMARY OF QUANTITIES</b> | F.A.U. RTE.<br>1419                             | SECTION<br>0405RS-6 | COUNTY<br>COOK | TOTAL SHEETS<br>21 | SHEET NO.<br>4 |
| OFFICE:<br>District 1  | PROJECT:<br>1005415      | CHECKED:<br>-  | REVISED:<br>- |   |   | CONTRACT NO. 62A03                              |                     |                |                    |                |
| PLOT SCALE:<br>100,000' / 1" =                               | DATE:<br>-               | CHECKED:<br>-  | REVISED:<br>- |   |   | FED. ROAD DIST. NO. 1 ILLINOIS FED. AID PROJECT |                     |                |                    |                |
| PLOT DATE:<br>10/26/2006                                     | DATE:<br>-               | CHECKED:<br>-  | REVISED:<br>- |   |   | SCALE: SHEET NO. OF SHEETS STA. TO STA.         |                     |                |                    |                |

\* SPECIALTY ITEM       NON-PART. (100% STATE)

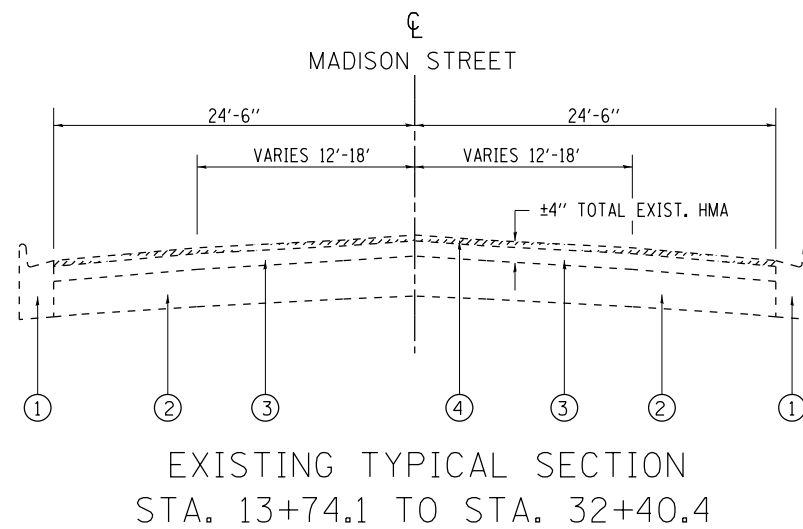

**LEGEND**

- ① EXIST. COMB. CURB & GUTTER, TYPE B-6.12
- ② EXIST. PCC PAVEMENT, ±9"
- ③ EXIST. HOT-MIX ASPHALT SURFACE COURSE, 4"
- ④ PROP. HOT-MIX ASPHALT SURFACE REMOVAL, 2 1/4"
- ⑤ PROP. POLY. LEVELING BINDER (MM), IL-4.75, N50, 3/4"
- ⑥ PROP. HOT-MIX ASPHALT SURFACE COURSE, MIX "D", N70, 1 1/2"

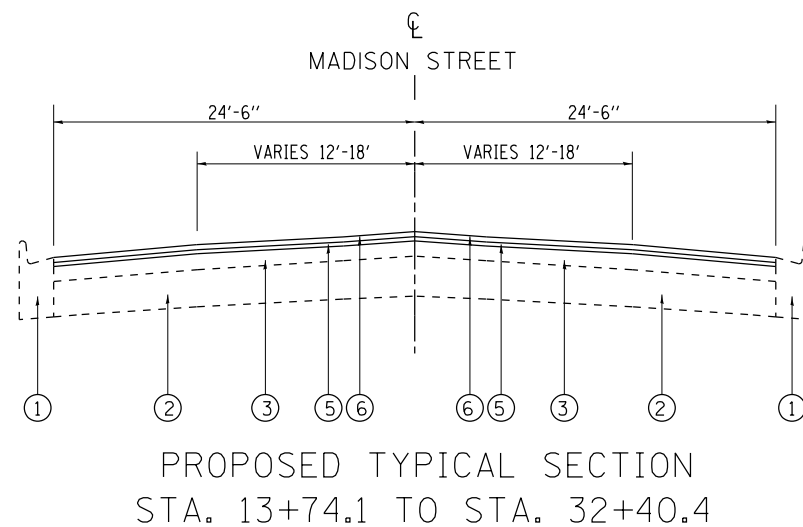

**HMA MIXTURE REQUIREMENTS**

| MIXTURE TYPE   | AIR VOIDS @ NDES | QUALITY MANAGEMENT PROGRAM (QMP) |
|--|------------------|----------------------------------|
| <b>PAVEMENT RESURFACING</b>  |                  |                                  |
| HOT-MIX ASPHALT SURFACE COURSE, MIX "D", N70 (IL 9.5 mm)   | 4% @ 70 GYR      | QCP                              |
| POLYMERIZED LEVELING BINDER, (MM), IL 4.75, N50  | 3.5% @ 50 GYR    | QCP                              |
| <b>PAVEMENT PATCHING</b>   |                  |                                  |
| HOT-MIX ASPHALT REPLACEMENT OVER PATCHES (HMA BINDER IL-19mm)                                      | 4% @ 70 GYR      | QC/QA                            |
| CLASS D PATCHES (HMA BINDER IL-19mm)   | 4% @ 70 GYR      | QC/QA                            |
| QMP DESIGNATION: QUALITY CONTROL/ QUALITY ASSURANCE (QC/QA); QUALITY CONTROL FOR PERFORMANCE (QCP) |                  |                                  |

THE UNIT WEIGHT USED TO CALCULATE ALL HOT-MIX ASPHALT SURFACE MIXTURE QUANTITIES IS 112 LBS/SQYD/IN.

THE "AC TYPE" FOR POLYMERIZED HMA MIXES SHALL BE "SBS/SBR PG 76 -22" AND FOR NON-POLYMERIZED HMA THE "AC TYPE" SHALL BE "PG 64 -22" UNLESS MODIFIED BY DISTRICT ONE SPECIAL PROVISIONS. FOR USE OF RECYCLED MATERIALS SEE SPECIAL PROVISIONS. QUALITY MANAGEMENT PROGRAM (QMP) IDENTIFIES THE PARTICULAR QUALITY CONTROL SPECIFICATION THAT APPLIES TO THE HMA MIXTURE.

**NOTE:**  
**CONTRACTOR SHALL PATCH FIRST BEFORE MILLING**

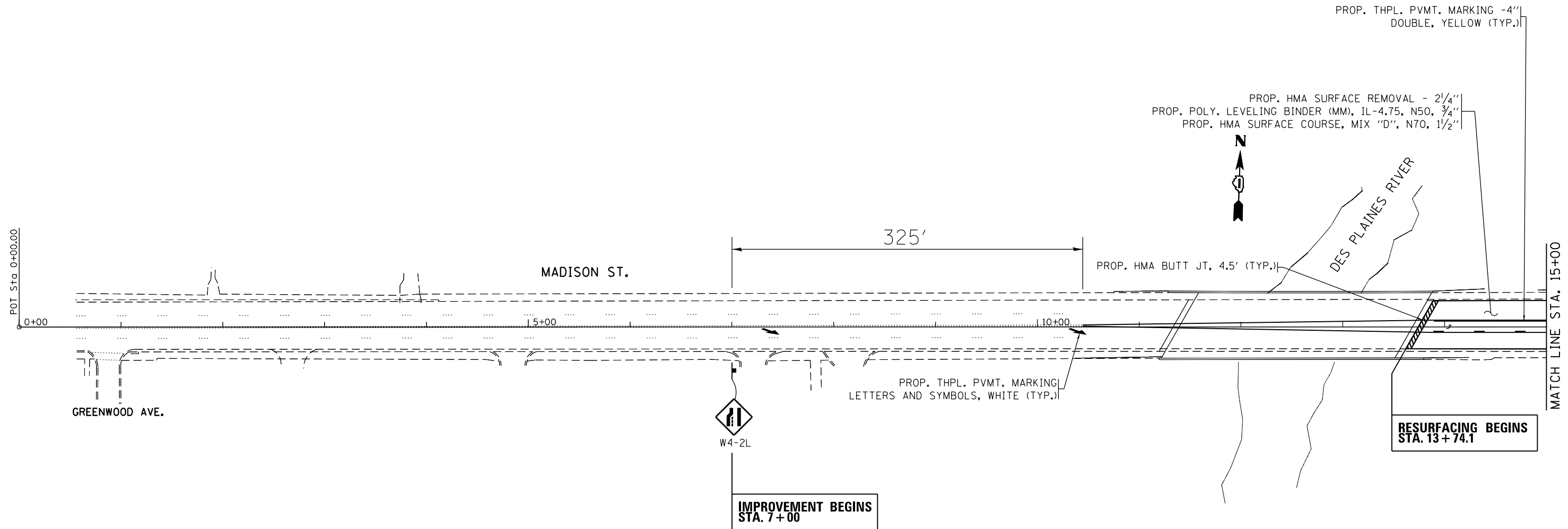

|  |                         |            |           |
|--|-------------------------|------------|-----------|
| FILE NAME =  | USER NAME = pyrzenowski | DESIGNED - | REVISED - |
| pw:\IL\084EBIDINTEG.illinois.gov\PIWIDOT\Documents\IDOT Offices\District 1\Projects\DI05415\Drawings\Design\DI05415-sht-plen.dgn |                         | CHECKED -  | REVISED - |
| Default  | PLOT DATE = 10/26/2016  | DATE -     | REVISED - |

**STATE OF ILLINOIS  
DEPARTMENT OF TRANSPORTATION**

**EXISTING AND PROPOSED ROADWAY PLANS  
MADISON STREET (THATCHER AVENUE TO VAN BUREN STREET)**

| F.A.U. RTE.        | SECTION  | COUNTY | TOTAL SHEETS              | SHEET NO. |
|--------------------|----------|--------|---------------------------|-----------|
| 1419               | 0405RS-6 | COOK   | 18                        | 6         |
| CONTRACT NO. 62A03 |          |        | ILLINOIS FED. AID PROJECT |           |

SCALE: 1" = 50'      SHEET OF SHEETS      STA. TO STA.

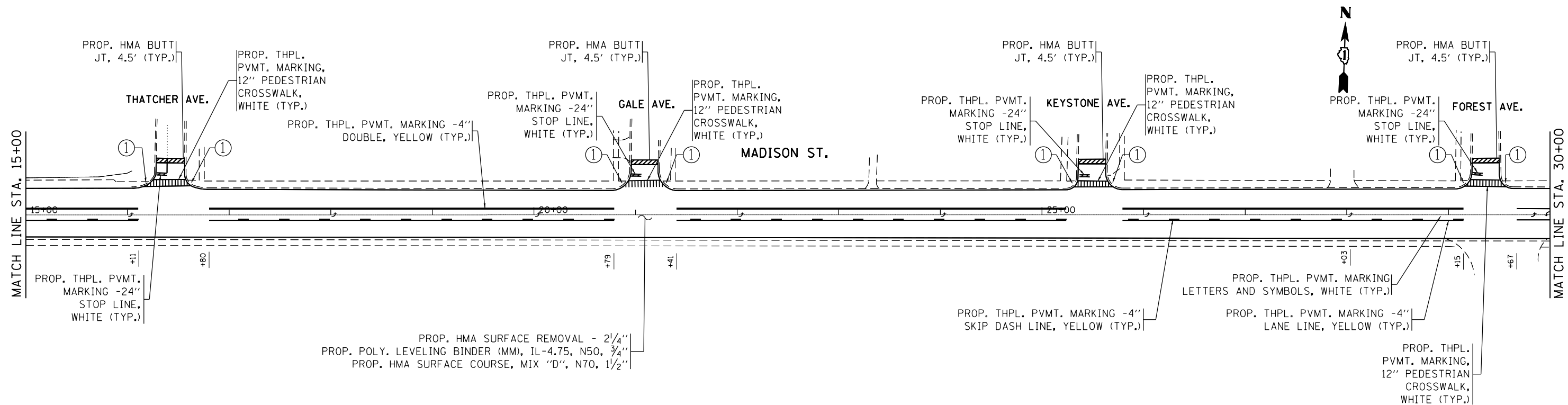

- ① PROP. SIDEWALK REMOVAL
- PROP. PCC SIDEWALK RAMP (SEE ADA RAMP DETAILS SHEETS 9-11)
- PROP. DETECTABLE WARNINGS

|  |                              |            |           |   |   |                              |          |   |              |           |
|--|------------------------------|------------|-----------|---|---|------------------------------|----------|---|--------------|-----------|
| FILE NAME =<br>p:\11\084EBIDINTEG.illinois.gov\PIWIDOT\Documents\IDOT Offices\District 1\Projects\DI05415-sht-plen.dgn | USER NAME = pyrzenowskirb    | DESIGNED - | REVISED - | <b>STATE OF ILLINOIS<br/>DEPARTMENT OF TRANSPORTATION</b> | <b>EXISTING AND PROPOSED ROADWAY PLANS<br/>MADISON STREET (THATCHER AVENUE TO VAN BUREN STREET)</b> | F.A.U. RTE.                  | SECTION  | COUNTY  | TOTAL SHEETS | SHEET NO. |
|  | PLOT SCALE = 100.0000' / in. | CHECKED -  | REVISED - |   |   | 1419                         | 0405RS-6 | COOK  | 18           | 7         |
| Default  | PLOT DATE = 10/26/2016       | DATE -     | REVISED - | SCALE: 1" = 50'   |   | SHEET OF SHEETS STA. TO STA. |          | CONTRACT NO. 62A03<br>ILLINOIS FED. AID PROJECT |              |           |

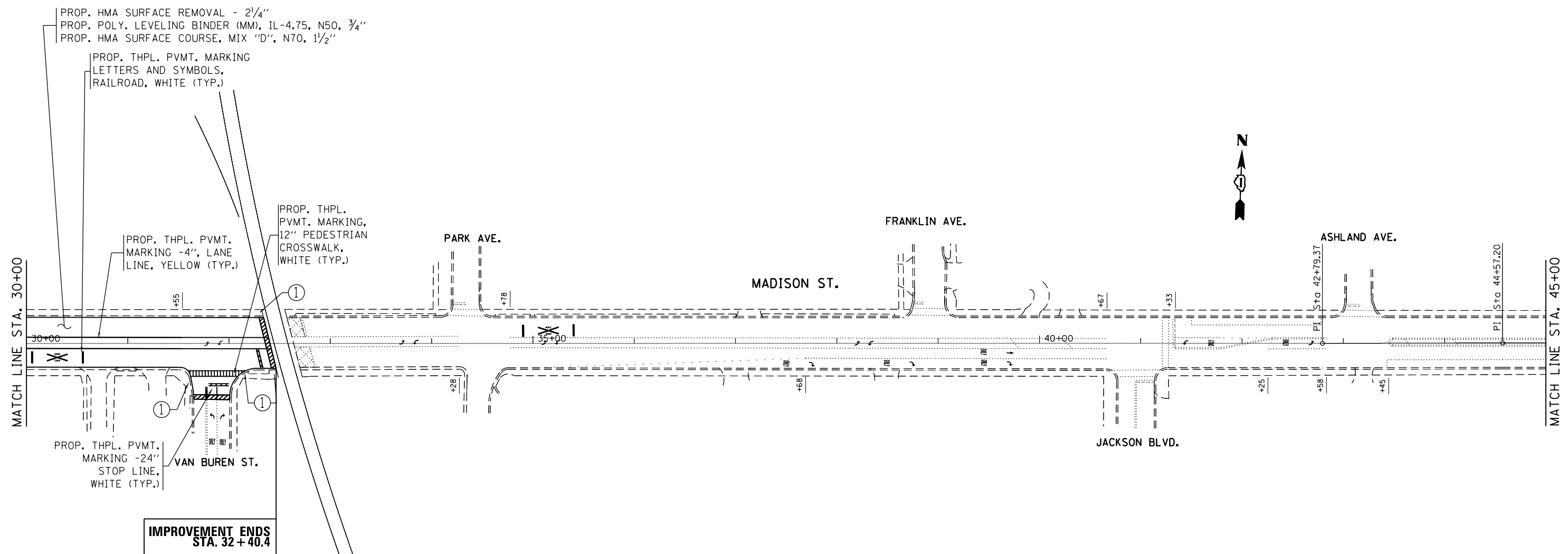

- ① PROP. SIDEWALK REMOVAL
- PROP. PCC SIDEWALK RAMP (SEE ADA RAMP DETAILS SHEETS 9-11)
- PROP. DETECTABLE WARNINGS

|   |                              |            |           |
|---|------------------------------|------------|-----------|
| FILE NAME =   | USER NAME = pyrzenowski      | DESIGNED - | REVISED - |
| pw\11084EBIDINTEG\illinois.gov\PWIDOT\Documents\IDOT Offices\District 1\Projects\DI05415\Drawings\DI05415-sht-pln.dgn |                              | CHECKED -  | REVISED - |
| Default   | PLOT SCALE = 100.0000' / in. | DATE -     | REVISED - |
|   | PLOT DATE = 10/26/2016       |            |           |

**STATE OF ILLINOIS**  
**DEPARTMENT OF TRANSPORTATION**

**EXISTING AND PROPOSED ROADWAY PLANS**  
**MADISON STREET (THATCHER AVENUE TO VAN BUREN STREET)**

SCALE: 1" = 50'    SHEET    OF    SHEETS    STA.    TO    STA.

| F.A.U. RTE.        | SECTION  | COUNTY | TOTAL SHEETS              | SHEET NO. |
|--------------------|----------|--------|---------------------------|-----------|
| 1419               | 0405RS-6 | COOK   | 18                        | 8         |
| CONTRACT NO. 62A03 |          |        | ILLINOIS FED. AID PROJECT |           |



NOTE:

ASSUMING AN OFFSET LIMIT OF 2 FEET BEYOND THE EDGE OF SIDEWALK, FOLLOWING ARE THE ESTIMATED QUANTITIES FOR LANDSCAPING RESTORATION:

TOPSOIL FURNISH & PLACE 4", 4 SY  
SODDING SALT TOLERANT, 4 SY

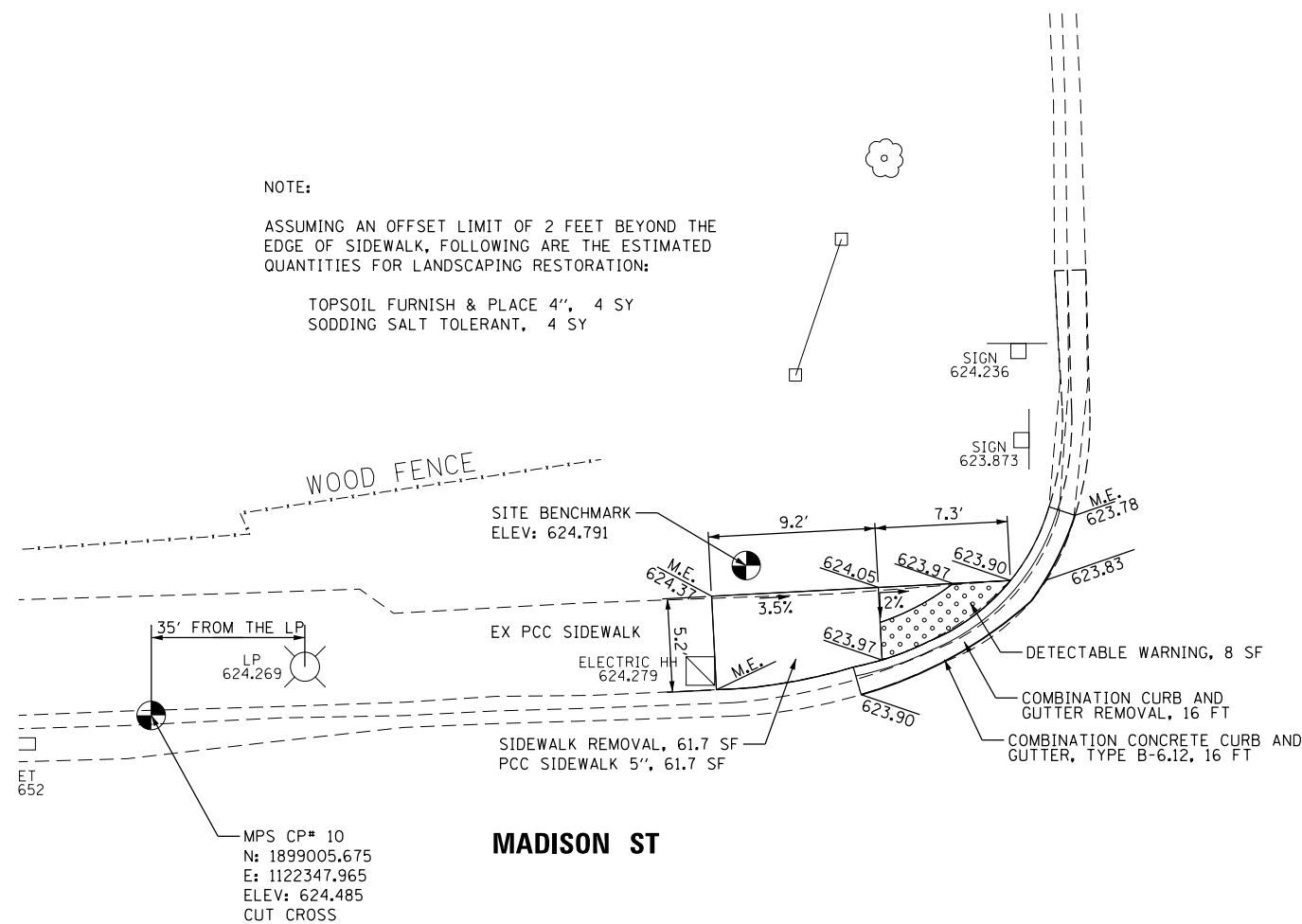

MPS CP# 10  
N: 1899005.675  
E: 1122347.965  
ELEV: 624.485  
CUT CROSS

MADISON ST

NOTE:

ASSUMING AN OFFSET LIMIT OF 2 FEET BEYOND THE EDGE OF SIDEWALK, FOLLOWING ARE THE ESTIMATED QUANTITIES FOR LANDSCAPING RESTORATION:

TOPSOIL FURNISH & PLACE 4", 8 SY  
SODDING SALT TOLERANT, 8 SY

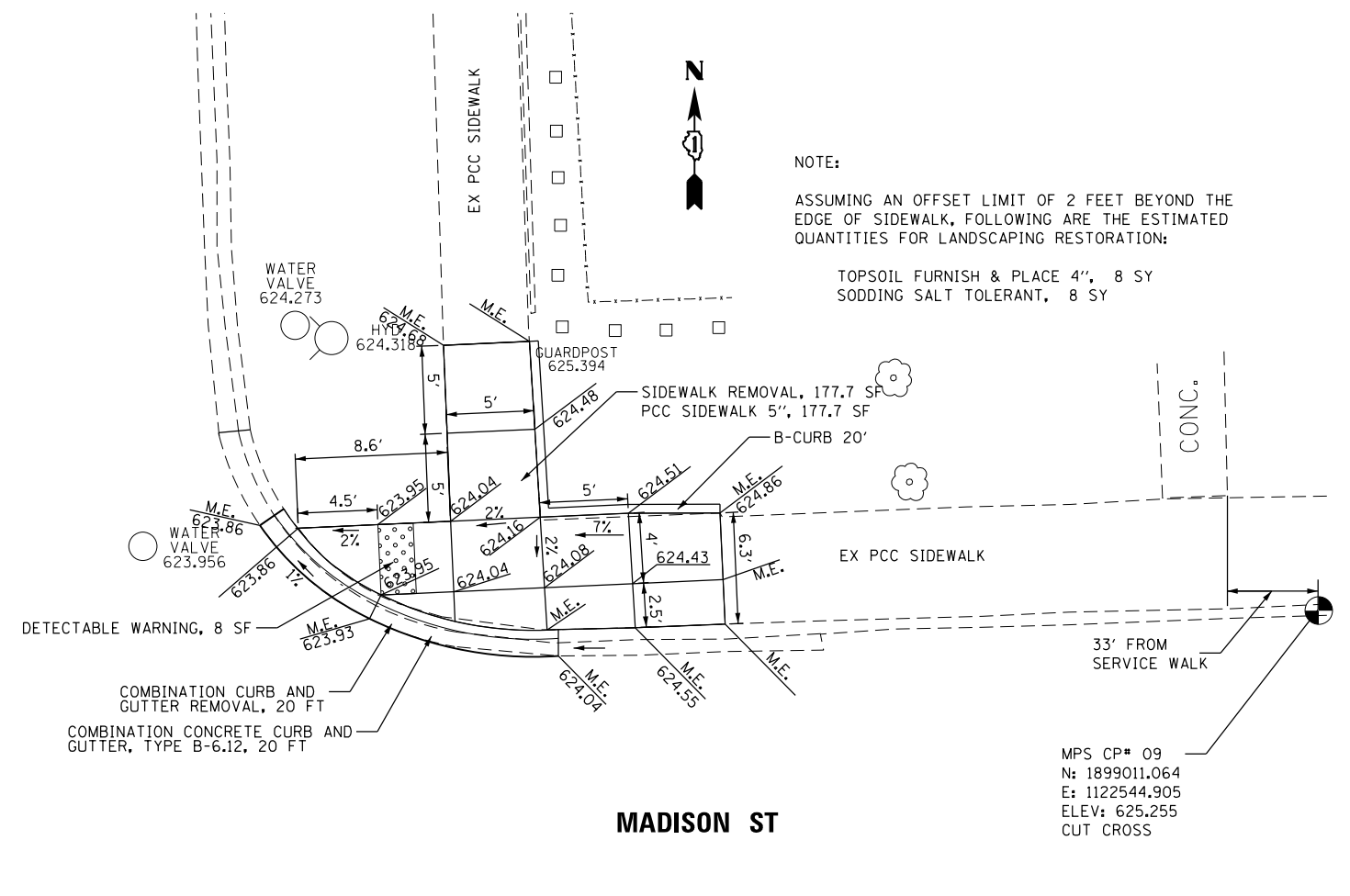

MPS CP# 09  
N: 1899011.064  
E: 1122544.905  
ELEV: 625.255  
CUT CROSS

MADISON ST

NOTE:

ASSUMING AN OFFSET LIMIT OF 2 FEET BEYOND THE EDGE OF SIDEWALK, FOLLOWING ARE THE ESTIMATED QUANTITIES FOR LANDSCAPING RESTORATION:

TOPSOIL FURNISH & PLACE 4", 5 SY  
SODDING SALT TOLERANT, 5 SY

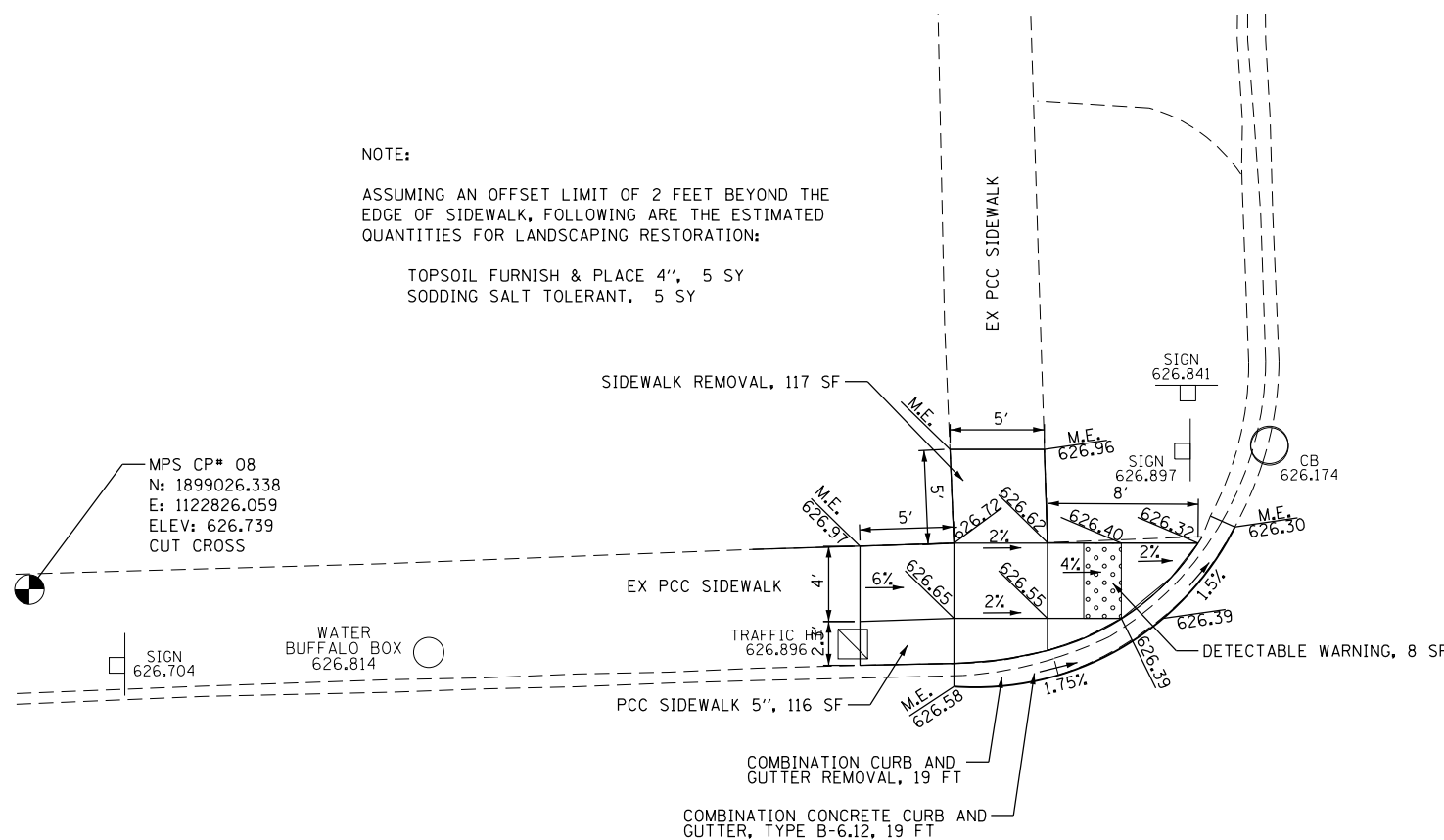

MPS CP# 08  
N: 1899026.338  
E: 1122826.059  
ELEV: 626.739  
CUT CROSS

MADISON ST

NOTE:

ASSUMING AN OFFSET LIMIT OF 2 FEET BEYOND THE EDGE OF SIDEWALK, FOLLOWING ARE THE ESTIMATED QUANTITIES FOR LANDSCAPING RESTORATION:

TOPSOIL FURNISH & PLACE 4", 5 SY  
SODDING SALT TOLERANT, 5 SY

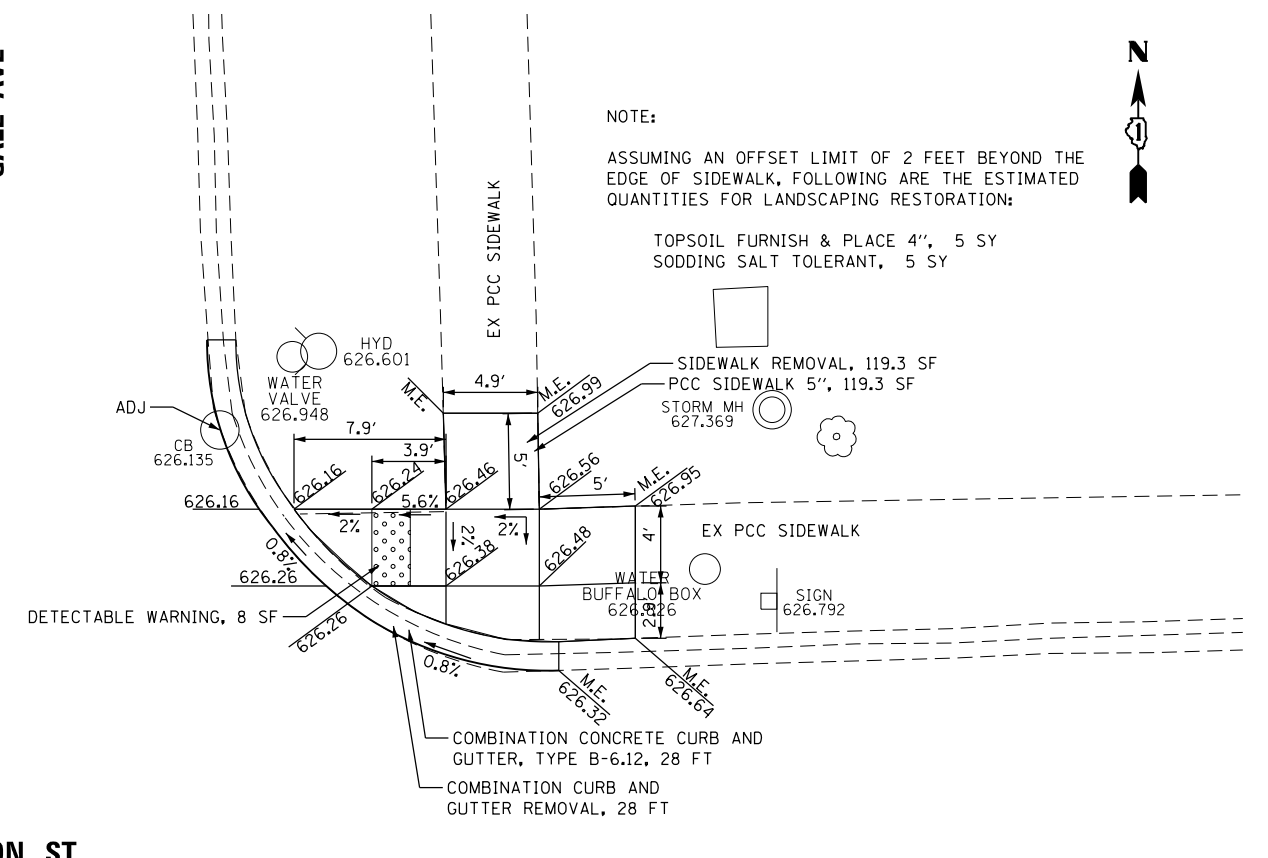

SIDEWALK REMOVAL, 119.3 SF  
PCC SIDEWALK 5", 119.3 SF  
STORM MH 627.369

COMBINATION CONCRETE CURB AND GUTTER, TYPE B-6.12, 28 FT  
COMBINATION CURB AND GUTTER REMOVAL, 28 FT

ADA-01

STATE OF ILLINOIS  
DEPARTMENT OF TRANSPORTATION

ADA SIDEWALK RAMP DETAILS  
MADISON ST - THATCHER AVE TO VAN BUREN ST.

| F.A.P. RTE. | SECTION  | COUNTY | TOTAL SHEETS | SHEET NO. |
|-------------|----------|--------|--------------|-----------|
| 1419        | 0405RS-6 | COOK   | 21           | 9         |

SCALE: 1"=5' SHEET NO. OF SHEETS STA. TO STA.

FED. ROAD DIST. NO. 1 ILLINOIS FED. AID PROJECT CONTRACT NO. 62A03

FILE NAME: c:\pwworkspace\bauserd1\0422798\0162A03\_40A-sh101.dgn  
PLOT SCALE: 1/8"=1'-0"  
USER NAME: bauserd1

2600 Warrenville Road, Suite 203, Downers Grove, IL 60515  
630.705.0110 voice, 630.839.2566 fax  
www.mps-il.com

MILLENNIA PROFESSIONAL SERVICES

|                   |           |
|-------------------|-----------|
| DESIGNED - TVN    | REVISED - |
| DRAWN - JP        | REVISED - |
| CHECKED - TVN     | REVISED - |
| DATE - 10/26/2016 | REVISED - |

c:\pwworkspace\bauserd1\0422798\0162A03\_40A-sh101.dgn



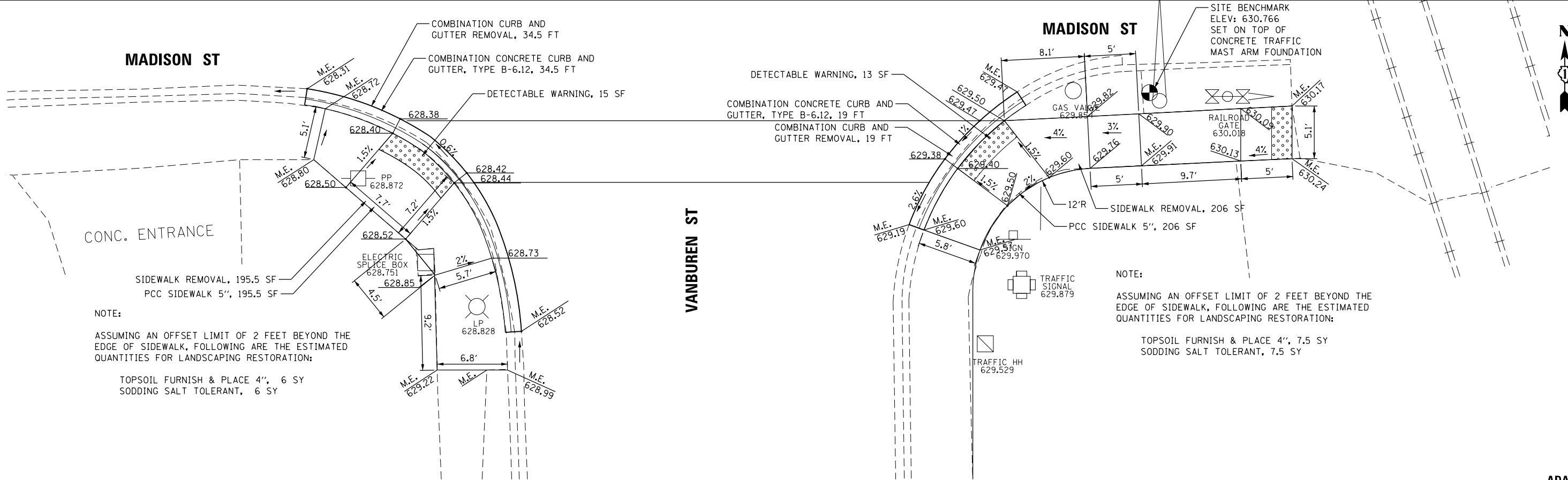
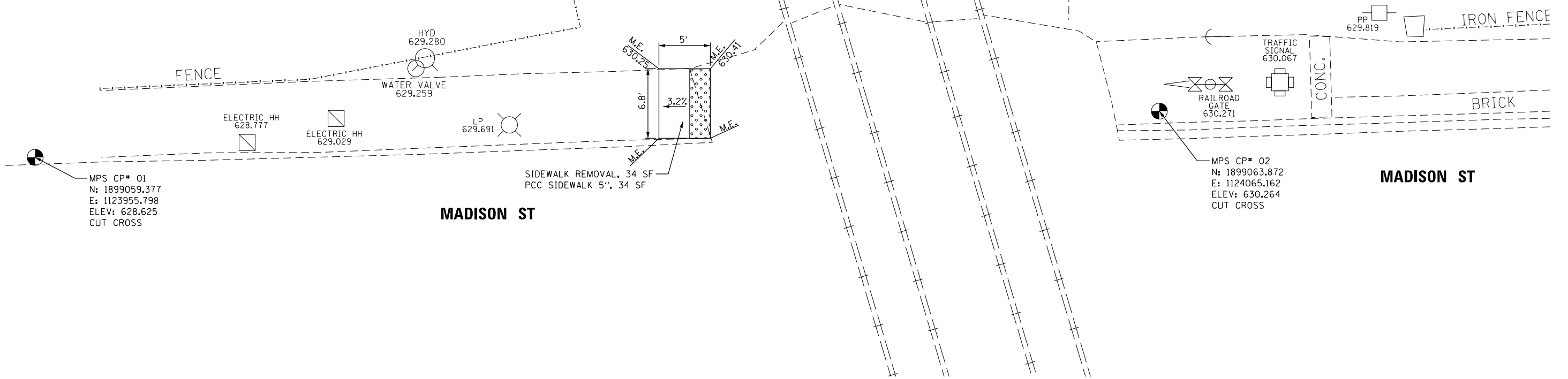

ADA-03

FILE NAME : c:\pwworking\miller\projects\622798\01622403.dwg  
 PLOT SCALE : 1/8"=1'-0"  
 USER NAME : jbaumer



2600 Warrenville Road, Suite 203, Downers Grove, IL 60515  
 630.705.0110 voice, 630.839.2566 fax  
 www.mps-il.com  
**MILLENNIA PROFESSIONAL SERVICES**

|                   |           |
|-------------------|-----------|
| DESIGNED - TVN    | REVISED - |
| DRAWN - JP        | REVISED - |
| CHECKED - TVN     | REVISED - |
| DATE - 10/26/2016 | REVISED - |

**STATE OF ILLINOIS**  
**DEPARTMENT OF TRANSPORTATION**

| ADA SIDEWALK RAMP DETAILS                  |                     |              |  |
|--|---------------------|--------------|--|
| MADISON ST - THATCHER AVE TO VAN BUREN ST. |                     |              |  |
| SCALE:                                     | SHEET NO. OF SHEETS | STA. TO STA. |  |

|   |          |        |              |           |
|---|----------|--------|--------------|-----------|
| F.A.P. RTE.                                       | SECTION  | COUNTY | TOTAL SHEETS | SHEET NO. |
| 1419  | 0405RS-6 | COOK   | 21           | 11        |
| CONTRACT NO.                                      |          |        | 62A03        |           |
| FED. ROAD DIST. NO. 1   ILLINOIS FED. AID PROJECT |          |        |              |           |

c:\pwworking\miller\projects\622798\01622403.dwg

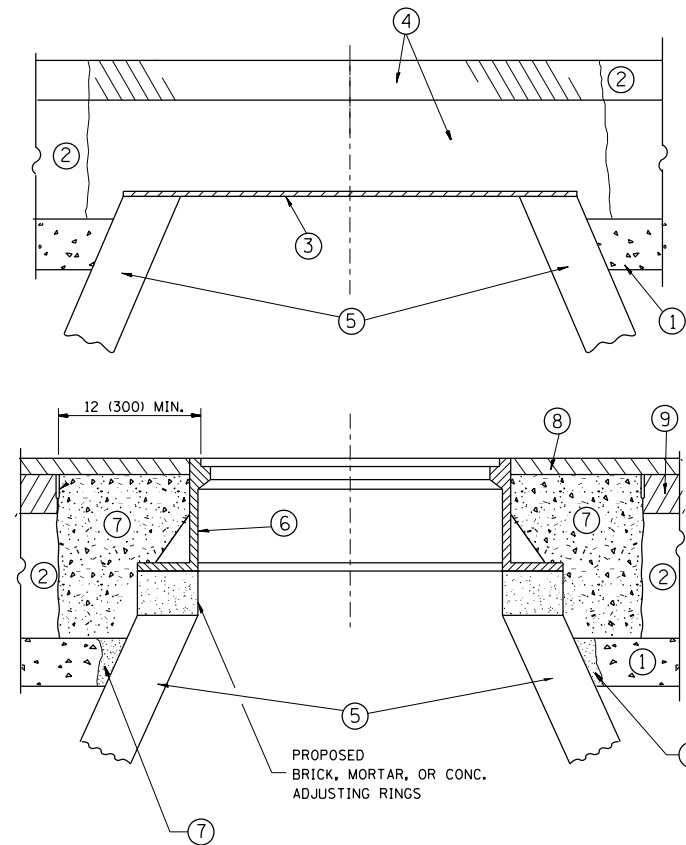

**CONSTRUCTION PROCEDURES**

**STAGE 1 (BEFORE PAVEMENT MILLING)**

- A) REMOVE A MINIMUM OF 12 (300) OF THE PAVEMENT FROM AROUND THE STRUCTURE.
- B) REMOVE THE EXISTING FRAME AND LID FROM THE STRUCTURE.
- C) COVER THE STRUCTURE OPENING WITH A 36 (900) DIAMETER METAL PLATE.
- D) BACKFILL WITH CRUSHED STONE AND A MINIMUM 1/2 (40) THICK HMA SURFACE MIX APPROVED BY THE ENGINEER.

**STAGE 2 (AFTER PAVEMENT MILLING)**

- A) REMOVE THE HMA SURFACE MIX AND CRUSHED STONE.
- B) INSTALL THE FRAME AND LID; ADJUST THE FRAME TO ITS FINAL SURFACE ELEVATION.
- C) THE SURROUNDING SPACE SHALL BE FILLED WITH CLASS PP-1\* CONCRETE TO THE ELEVATION OF THE SURFACE OF THE EXISTING BASE COURSE OR THE BINDER COURSE.

\* UNLESS OTHERWISE SPECIFIED IN THE PLANS.

THE PROCEDURE EXPLAINED ABOVE SHALL CONFORM TO THE APPLICABLE PORTIONS OF SECTIONS 353, 406, 602, AND 603 OF THE STANDARD SPECIFICATIONS EXCEPT THAT "THE CONTRACTOR SHALL ADJUST THE STRUCTURES TO THE FINISHED PAVEMENT ELEVATION NO MORE THAN 5 CALENDAR DAYS PRIOR TO PLACEMENT OF THE FINAL LIFT OF SURFACE UNLESS APPROVED BY THE ENGINEER."

**LEGEND**

- ① SUB-BASE GRANULAR MATERIAL
- ② EXISTING PAVEMENT
- ③ 36 (900) DIAMETER METAL PLATE
- ④ PROPOSED CRUSHED STONE AND HMA SURFACE MIX
- ⑤ EXISTING STRUCTURE
- ⑥ FRAME AND LID (SEE NOTES)
- ⑦ CLASS PP-1\* CONCRETE
- ⑧ PROPOSED HMA SURFACE COURSE
- ⑨ PROPOSED HMA BINDER COURSE

**LOCATION OF STRUCTURES:**

THE CONTRACTOR WILL BE REQUIRED TO KEEP A RECORD OF THE LOCATIONS OF THE BURIED STRUCTURES ACCORDING TO THE STATION AND DISTANCE LEFT OR RIGHT OF THE CENTERLINE OF PAVEMENT. UPON COMPLETION OF THE WORK, THE CONTRACTOR WILL DELIVER THE RECORD TO THE ENGINEER.

**BASIS OF PAYMENT:**

REMOVING FRAMES AND LIDS ON DRAINAGE AND UTILITY STRUCTURES IN THE PAVEMENT PRIOR TO MILLING, AND ADJUSTING TO FINAL GRADE PRIOR TO PLACING THE SURFACE COURSE, WILL BE PAID FOR AT THE CONTRACT UNIT PRICE EACH FOR "FRAMES AND LIDS TO BE ADJUSTED (SPECIAL)."

THIS WORK WILL NOT BE PAID FOR WHEN DRAINAGE AND UTILITY STRUCTURES ARE SPECIFIED FOR PAYMENT AS STRUCTURE RECONSTRUCTION.

NEW FRAMES AND LIDS, WHEN SPECIFIED, WILL BE PAID FOR SEPARATELY.

**NOTES:**

EXISTING BROKEN FRAMES AND LIDS SHALL BE REMOVED AND DISPOSED OF BY THE CONTRACTOR AND SHALL BE REPLACED AS DIRECTED BY THE ENGINEER. REPLACEMENT FRAMES AND LIDS WILL BE PAID FOR IN ACCORDANCE WITH ARTICLE 109.04 OF THE STANDARD SPECIFICATIONS UNLESS A SEPARATE PAY ITEM HAS BEEN PROVIDED.

IF THE EXISTING LIDS ARE OPEN, THE FRAME WILL BE ADJUSTED TO THE ELEVATION OF THE MILLED PAVEMENT SURFACE PRIOR TO THE MILLING OPERATION. THE FRAME WILL NOT BE REMOVED AND COVERED BY THE METAL PLATE.

CITY OF CHICAGO CASTINGS ARE THE PROPERTY OF THE CITY AND THE CONTRACTOR SHALL NOTIFY THE CITY FOR REMOVAL AND DISPOSITION OF THE CASTINGS.

THE METAL PLATE USED TO COVER THE STRUCTURE SHALL REMAIN THE PROPERTY OF THE CONTRACTOR.

WHEN STRUCTURES ARE TO BE ADJUSTED OR RECONSTRUCTED, THE LOWERING AND RAISING OF THE FRAMES AND LIDS WILL NOT BE PAID FOR SEPARATELY BUT WILL BE INCLUDED IN THE COST OF THE CORRESPONDING PAY ITEM.

**DETAILS FOR FRAMES AND LIDS ADJUSTMENT WITH MILLING**

ALL DIMENSIONS ARE IN INCHES (MILLIMETERS) UNLESS OTHERWISE SHOWN

|   |                         |                    |                                |
|---|-------------------------|--------------------|--------------------------------|
| FILE NAME =   | USER NAME = pyrzenowski | DESIGNED - R. SHAH | REVISED - R. WIEDEMAN 05-14-04 |
| pw\11084EBIDINTEG\illinois.gov\PIWIDOT\Documents\IDOT Offices\District 1\Projects\DI05415\Design\DI05415-sht-plen.dgn |                         |                    | REVISED - R. BORO 01-01-07     |
|   |                         | CHECKED -          | REVISED - R. BORO 03-09-11     |
|   |                         | DATE - 10-25-94    | REVISED - R. BORO 12-06-11     |

**STATE OF ILLINOIS  
DEPARTMENT OF TRANSPORTATION**

|  |                         |      |         |
|--|-------------------------|------|---------|
| <b>DETAILS FOR<br/>FRAMES AND LIDS ADJUSTMENT WITH MILLING</b> |                         |      |         |
| SCALE: NONE  | SHEET NO. 1 OF 1 SHEETS | STA. | TO STA. |

|   |          |                           |              |           |
|---|----------|---------------------------|--------------|-----------|
| F.A. RTE.                                       | SECTION  | COUNTY                    | TOTAL SHEETS | SHEET NO. |
| 1419  | 0405RS-6 | COOK                      | 21           | 12        |
| <b>BD600-03 (BD-8)</b>                          |          | <b>CONTRACT NO. 62A03</b> |              |           |
| FED. ROAD DIST. NO. 1 ILLINOIS FED. AID PROJECT |          |                           |              |           |

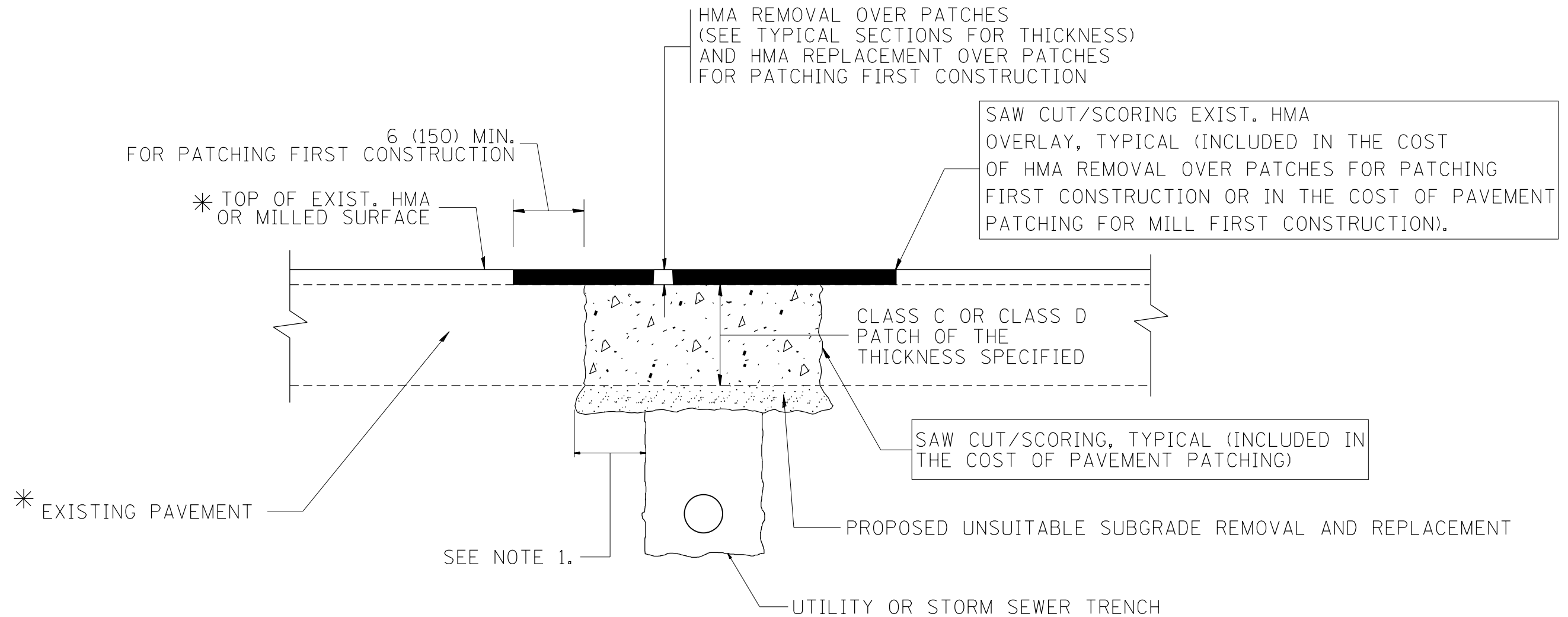

\* SEE TYPICAL SECTIONS FOR THICKNESS AND MATERIALS

**NOTES:**

1. THE WIDTH OF THE FULL DEPTH PATCH OVER A TRENCH SHALL BE 12 (300) WIDER ON EACH SIDE OF THE TRENCH.
2. FOR METHOD OF MEASUREMENT AND BASIS OF PAYMENT, SEE RECURRING SPECIAL PROVISION "PATCHING WITH HOT-MIX ASPHALT OVERLAY REMOVAL".

SEQUENCE OF CONSTRUCTION (PATCHING FIRST)

1. REMOVE THE EXISTING HMA MATERIAL OVER THE AREA TO BE PATCHED.
2. REMOVE AND REPLACE WITH CLASS C OR D PATCH.
3. REPLACE HMA MATERIAL OVER THE AREA TO BE PATCHED.

SEQUENCE OF CONSTRUCTION (MILLING FIRST)

1. MILL HMA FIRST IF THERE IS AT LEAST 4 1/2 INCHES OR MORE OF HMA MATERIAL ON TOP OF THE EXISTING PAVEMENT OR IF THE PAVEMENT IS FULL DEPTH HMA. A MINIMUM OF 2 INCHES OF HMA MATERIAL SHALL BE IN PLACE AFTER MILLING.
2. REMOVE AND REPLACE WITH FULL DEPTH CLASS D PATCHES TO TOP OF MILLED SURFACE.

ALL DIMENSIONS ARE IN INCHES (MILLIMETERS) UNLESS OTHERWISE SHOWN.

|   |                               |                    |                             |   |  |                         |      |                           |   |        |              |           |
|---|-------------------------------|--------------------|-----------------------------|---|--|-------------------------|------|---------------------------|---|--------|--------------|-----------|
| FILE NAME =   | USER NAME = pyzenowski        | DESIGNED - R. SHAH | REVISED - A. ABBAS 04-27-98 | <b>STATE OF ILLINOIS<br/>DEPARTMENT OF TRANSPORTATION</b> | <b>PAVEMENT PATCHING FOR<br/>HMA SURFACED PAVEMENT</b> |                         |      | F.A. RTE.                 | SECTION   | COUNTY | TOTAL SHEETS | SHEET NO. |
| pw:\IL\084EBIDINTEG\illinois.gov\PWIDOT\Documents\IDOT Offices\District 1\Projects\DI054\Drawings\Design\DI05415-sht-plen.dgn | PLOT SCALE = 100.0000' / 1in. | CHECKED -          | REVISED - R. BORO 01-01-07  |   |  |                         |      | 1419                      | 0405RS-6  | COOK   | 21           | 13        |
|   | PLOT DATE = 10/26/2016        | DATE - 10-25-94    | REVISED - R. BORO 09-04-07  |   | <b>BD400-04 (BD-22)</b>                                |                         |      | <b>CONTRACT NO. 62A03</b> |   |        |              |           |
|   |                               |                    | REVISED - K. ENG 10-27-08   |   | SCALE: NONE  | SHEET NO. 1 OF 1 SHEETS | STA. | TO STA.                   | FED. ROAD DIST. NO. 1 ILLINOIS FED. AID PROJECT |        |              |           |

VARIABLE - TO MEET EXISTING DIMENSIONS AND FIELD CONDITIONS (SEE NOTE ②)

PROP. CONC. CURB OR CURB AND GUTTER REPLACEMENT IN ACCORDANCE WITH STATE STANDARD 606001. (SEE NOTE ②)

SAW CUT FULL DEPTH - INCLUDED IN THE COST OF SIDEWALK, DRIVEWAY OR MEDIAN SURFACE REMOVAL PAY ITEM.

SEE STATE STANDARD 606001  
EXISTING OR PROPOSED HMA SURFACE (IF APPLICABLE)

18" (450) MAX.

1/4" (5) \*\*

EXISTING SIDEWALK, DRIVEWAY, MEDIAN SURFACE, SOD OR GROUND.

PROPOSED SIDEWALK, DRIVEWAY PAVEMENT, MEDIAN SURFACE OR SODDING SALT TOLERANT WITH TOP SOIL, 4" (100) SOD RESTORATION (SEE NOTE ①).

EXISTING CONCRETE PAVEMENT, CONCRETE BASE COURSE OR FLEXIBLE PAVEMENT

3" (75) MIN.

SUITABLE BACKFILL MATERIAL (INCLUDED IN THE COST OF CURB OR CURB AND GUTTER REMOVAL AND REPLACEMENT)

PROPOSED 3/4" (20) PREFORMED EXPANSION JOINT AT CONCRETE SIDEWALKS, DRIVEWAYS, AND MEDIANS. (INCLUDED IN THE COST OF CURB OR CURB AND GUTTER REMOVAL AND REPLACEMENT.)

\* 3" (75) MINIMUM FROM TOP AND BOTTOM OF THE CONCRETE PAVEMENT OR BASE COURSE.

\*\* IF THE FINAL SURFACE OF THE PAVEMENT IS CONCRETE, THE GUTTER IS TO BE FLUSH WITH THE PAVEMENT.

UNSUITABLE SUB-BASE MATERIAL TO BE REMOVED, IF DIRECTED BY THE ENGINEER, SHALL BE REPLACED WITH EITHER SUB-BASE GRANULAR MATERIAL, TYPE B OR ADDITIONAL THICKNESS OF CONCRETE.

NOTE: ① SIDEWALK, DRIVEWAY PAVEMENT OR MEDIAN SURFACE SHALL BE SIMILAR TO THE MATERIAL BEING REMOVED AND WILL BE PAID FOR SEPARATELY.

SODDING, SALT TOLERANT AND TOP SOIL, FURNISH AND PLACE 4" WILL BE PAID FOR SEPARATELY.

REMOVAL AND REPLACEMENT 4" (100) OR LESS IS INCLUDED IN THE COST OF CURB OR CURB AND GUTTER REMOVAL AND REPLACEMENT.

② FERTILIZER FOR THE PLACEMENT OF THE SOD IS NOT REQUIRED

③ CURB OR CURB AND GUTTER REPLACEMENT SHALL MATCH THE SHAPE OF THE EXISTING CURB OR CURB AND GUTTER UNLESS OTHERWISE SPECIFIED.

REMOVAL AND REPLACEMENT IN EXCESS OF 4" (100) WILL BE PAID FOR IN ACCORDANCE WITH ARTICLE 109.04 OF THE STANDARD SPECIFICATIONS.

④ FOR CURB OR CURB AND GUTTER REMOVAL AND REPLACEMENT ADJACENT TO FLEXIBLE PAVEMENT DELETE EPOXY COATED TIE BARS.

PROPOSED #6 (20) EPOXY COATED TIE BARS 24" (600) LONG AT 24" (600) CENTERS WILL NOT BE PAID FOR SEPARATELY. DELETE EPOXY COATED TIE BARS IF EXISTING TIE BARS ARE USABLE AS DETERMINED BY THE ENGINEER. (SEE NOTE ③).

⑤ LONGITUDINAL BARS, IF ENCOUNTERED IN THE EXISTING CURB OR CURB AND GUTTER, ARE NOT TO BE REPLACED. CUTTING AND REMOVING LONGITUDINAL BARS SHALL BE INCLUDED IN THE COST OF CURB OR CURB AND GUTTER REMOVAL AND REPLACEMENT.

⑥ THE COST OF HMA SURFACE REMOVAL IN THE EXISTING GUTTER FLAG SHALL BE INCLUDED IN THE COST OF THE CURB AND GUTTER REMOVAL AND REPLACEMENT.

BASIS OF PAYMENT:  
THIS WORK WILL BE PAID FOR AT THE CONTRACT UNIT PRICE PER FOOT (METER) FOR "CURB REMOVAL AND REPLACEMENT" OR "COMBINATION CONCRETE CURB AND GUTTER REMOVAL AND REPLACEMENT".

⑦ THE REMOVAL AND REPLACEMENT OF THE EXISTING CURB OR CURB AND GUTTER SHALL BE DONE IN ACCORDANCE WITH THE APPLICABLE PORTIONS OF SECTION 440 AND 606 OF THE STANDARD SPECIFICATIONS.

⑧ THE LOCATIONS OF REMOVAL AND REPLACEMENT OF EXISTING CURB OR CURB AND GUTTER SHALL BE DETERMINED BY THE RESIDENT ENGINEER AT THE TIME OF CONSTRUCTION.

# CURB OR CURB AND GUTTER REMOVAL AND REPLACEMENT

ALL DIMENSIONS ARE IN INCHES (MILLIMETERS) UNLESS OTHERWISE SHOWN.

|  |                                 |                             |                             |   |  |                         |                         |                           |              |   |
|--|---------------------------------|-----------------------------|-----------------------------|---|--|-------------------------|-------------------------|---------------------------|--------------|---|
| FILE NAME =  | USER NAME = pyrzenowskirb       | DESIGNED - A. HOUSEH        | REVISED - R. SHAH 10-03-96  | <b>STATE OF ILLINOIS<br/>DEPARTMENT OF TRANSPORTATION</b> | <b>CURB OR CURB AND GUTTER<br/>REMOVAL AND REPLACEMENT</b> | F.A. RTE.               | SECTION                 | COUNTY                    | TOTAL SHEETS | SHEET NO.   |
| pw:\IL\084EBIDINTEG\illinois.gov\PIWIDOT\Documents\DOT Offices\District 1\Projects\DI054\Design\DI05415-shr-plan.dgn | PLotted SCALE = 100.0000' / in. | CHECKED -                   | REVISED - A. ABBAS 03-21-97 |   |  | 1419                    | 0405RS-6                | COOK                      | 21           | 14  |
| PLotted DATE = 10/26/2016  | DATE - 03-11-94                 | REVISED - M. GOMEZ 01-22-01 | REVISED - R. BORO 12-15-09  |   |  | <b>BD600-06 (BD-24)</b> |                         | <b>CONTRACT NO. 62A03</b> |              |   |
|  |                                 |                             |                             |   |  | SCALE: NONE             | SHEET NO. 1 OF 1 SHEETS | STA.                      | TO STA.      | FED. ROAD DIST. NO. 1   ILLINOIS FED. AID PROJECT |

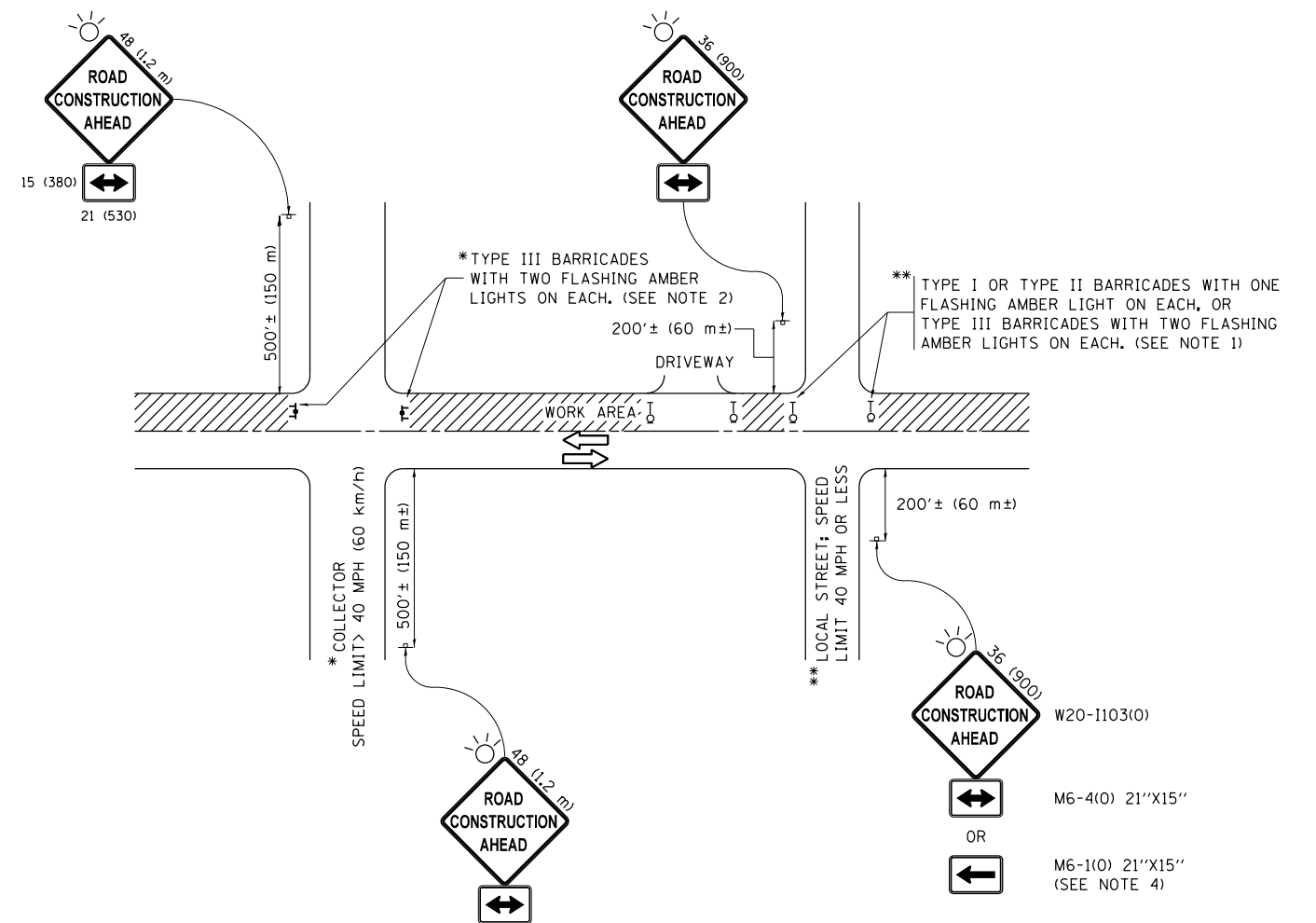

**NOTES:**

1. SIDE ROAD WITH A SPEED LIMIT OF 40 MPH (60 km/h) OR LESS AS SHOWN ON THE DRAWING AND AS DIRECTED BY THE ENGINEER:
  - a) ONE "ROAD CONSTRUCTION AHEAD" SIGN 36 x 36 (900x900) WITH A FLASHER MOUNTED ON IT APPROXIMATELY 200' (60 m) IN ADVANCE OF THE MAIN ROUTE.
  - b) THE CLOSED PORTION OF THE MAIN ROUTE SHALL BE PROTECTED BY BLOCKING WITH TYPE I, TYPE II OR TYPE III BARRICADES, 1/3 OF THE CROSS SECTION OF THE CLOSED PORTION.
2. SIDE ROAD WITH A SPEED LIMIT GREATER THAN 40 MPH (60 km/h) AS SHOWN ON THE DRAWING AND AS DIRECTED BY THE ENGINEER:
  - a) ONE "ROAD CONSTRUCTION AHEAD" SIGN 48 x 48 (1.2 m x 1.2 m) WITH A FLASHER MOUNTED ON IT APPROXIMATELY 500' (150 m) IN ADVANCE OF THE MAIN ROUTE.
  - b) THE CLOSED PORTION OF THE MAIN ROUTE SHALL BE PROTECTED BY BLOCKING WITH TYPE III BARRICADES, 1/2 OF THE CROSS SECTION OF THE CLOSED PORTION.
3. CONES MAY BE SUBSTITUTED FOR BARRICADES OR DRUMS AT HALF THE SPACING DURING DAY OPERATIONS. CONES SHALL BE A MINIMUM OF 28 (710) IN HEIGHT.
4. WHEN THE SIDE ROAD LIES BETWEEN THE BEGINNING OF THE MAINLINE SIGNING AND THE WORK ZONE, A SINGLE HEADED ARROW (M6-1) SHALL BE USED IN LIEU OF THE DOUBLE HEADED ARROW (M6-4).
5. WHEN WORK IS BEING PERFORMED ON A SIDE ROAD OR DRIVEWAY, FOLLOW THE APPLICABLE STANDARD(S). THE DIRECTIONAL ARROW (M6-1 OR M6-4) SHALL BE COVERED OR REMOVED WHEN NO LONGER CONSISTENT WITH THE TRAFFIC CONTROL SET-UP.
6. ADVANCE WARNING SIGNS ARE TO BE OMITTED ON DRIVEWAYS UNLESS OTHERWISE SPECIFIED IN THE PLANS OR BY THE ENGINEER.
7. THE TRAFFIC CONTROL AND PROTECTION FOR SIDE ROADS, INTERSECTIONS, AND DRIVEWAYS SHALL BE INCLUDED IN THE COST OF SPECIFIED TRAFFIC CONTROL STANDARDS OR ITEMS.

All dimensions are in inches (millimeters) unless otherwise shown.

|   |                              |                   |                                 |
|---|------------------------------|-------------------|---------------------------------|
| FILE NAME =   | USER NAME = pyznowskirb      | DESIGNED - L.H.A. | REVISED - A. HOUSEH 10-15-96    |
| pw:\IL\084EBIDINTEG\illinois.gov\PWIDOT\Documents\IDOT Offices\District 1\Projects\DI054\Drawings\Design\DI05415-sht-plan.dgn |                              |                   | REVISED - T. RAMMACHER 01-06-00 |
| Default   | PLOT SCALE = 100.0000' / in. | CHECKED -         | REVISED - A. SCHUETZE 07-01-13  |
|   | PLOT DATE = 10/26/2016       | DATE - 06-89      | REVISED - A. SCHUETZE 09-15-16  |

**STATE OF ILLINOIS  
DEPARTMENT OF TRANSPORTATION**

**TRAFFIC CONTROL AND PROTECTION FOR  
SIDE ROADS, INTERSECTIONS, AND DRIVEWAYS**

SCALE: NONE SHEET 1 OF 1 SHEETS STA. TO STA.

| F.A. RTE.                 | SECTION  | COUNTY | TOTAL SHEETS              | SHEET NO. |
|---------------------------|----------|--------|---------------------------|-----------|
| 1419                      | 0405RS-6 | COOK   | 21                        | 15        |
| <b>TC-10</b>              |          |        | <b>CONTRACT NO. 62A03</b> |           |
| ILLINOIS FED. AID PROJECT |          |        |                           |           |

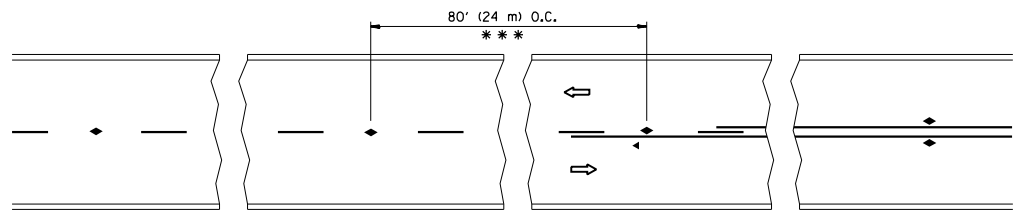

\*\*\* REDUCE TO 40' (12 m) O.C. ON CURVES WITH POSTED OR ADVISORY SPEED 45 M.P.H. (70 km/h) OR LESS.

TWO-LANE/TWO-WAY

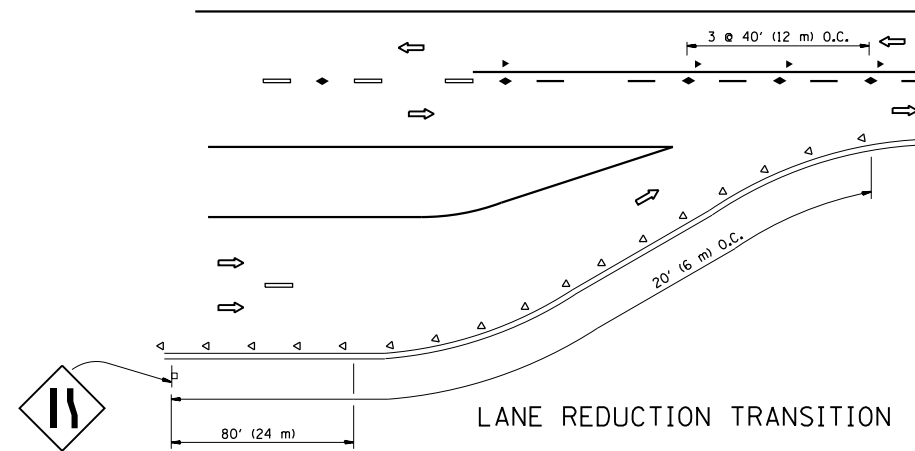

LANE REDUCTION TRANSITION

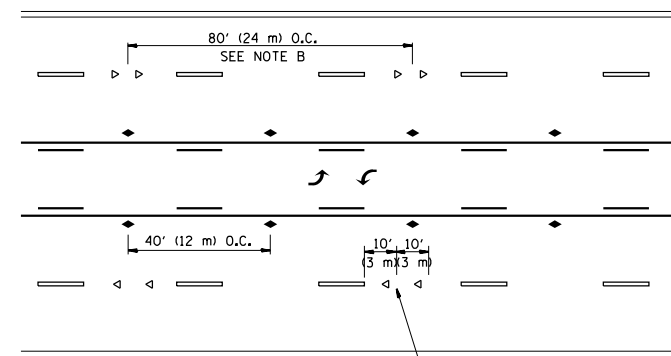

TWO-WAY LEFT TURN

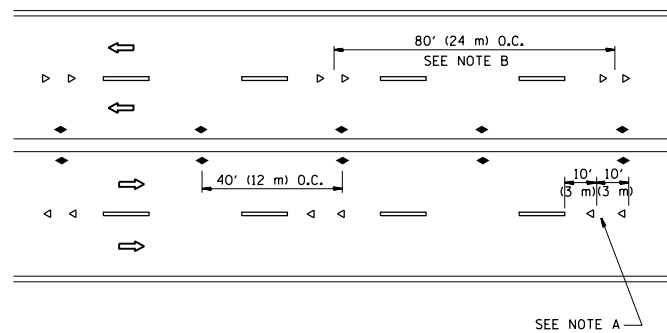

MULTI-LANE/UNDIVIDED

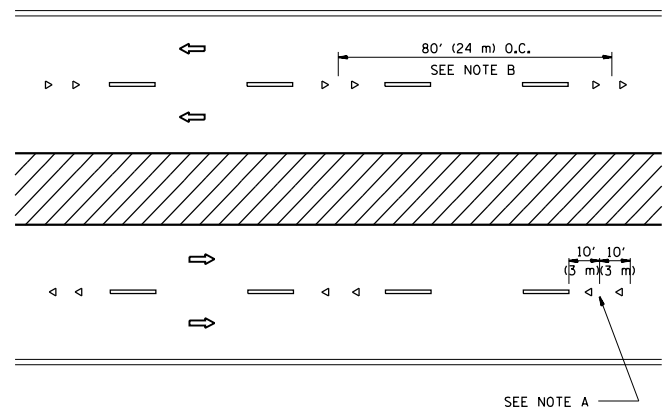

MULTI-LANE/DIVIDED

GENERAL NOTES

1. MARKERS USED WITH DASHED LINES SHALL BE CENTERED IN THE GAP BETWEEN SEGMENTS.
2. MARKERS USED ADJACENT TO SOLID LINES SHALL BE OFFSET 2 TO 3 (50 TO 75) TOWARD TRAFFIC AS SHOWN.
3. MARKERS THROUGH TANGENTS LESS THAN 500' (150 m) IN LENGTH BETWEEN CURVES SHALL BE INSTALLED AT THE LESSER OF THE TWO CURVE SPACINGS.

SYMBOLS

- YELLOW STRIPE
- WHITE STRIPE
- ◀ ONE-WAY AMBER MARKER
- ◁ ONE-WAY CRYSTAL MARKER (W/O)
- ◆ TWO-WAY AMBER MARKER

LANE MARKER NOTES

- A. USE DOUBLE LANE LINE MARKERS SPACED AS SHOWN.
- B. REDUCE TO 40' (12 m) O.C. ON CURVES WHERE ADVISORY SPEEDS ARE 10 M.P.H (20 km/h) LOWER THAN POSTED SPEEDS.

DESIGN NOTES

1. DOUBLE LANE LINE MARKERS SHALL BE USED UNLESS SPECIFIED OTHERWISE.
2. EXCEPT AS SHOWN ON THE LANE REDUCTION TRANSITION AND FREEWAY EXIT RAMP DETAIL, MARKERS ARE NOT TO BE SPECIFIED ON RIGHT EDGE LINES.
3. THE EXACT MARKER LIMITS, SPACING, AND COLOR SHALL BE INCLUDED IN THE PLANS WHEN STANDARD SPECIFICATIONS ARE NOT BEING USED.
4. MARKERS SHOULD NOT BE USED ALONGSIDE CURBS EXCEPT FOR EXTREMELY SHORT SECTIONS OF CURBS WHERE NOT MORE THAN TWO MARKERS WOULD BE INVOLVED.

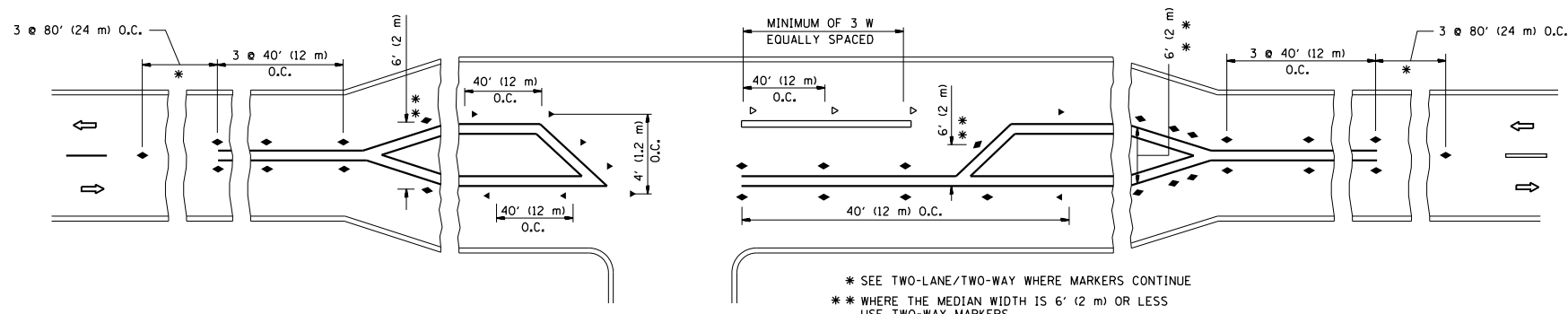

LEFT TURN

\* SEE TWO-LANE/TWO-WAY WHERE MARKERS CONTINUE  
 \*\* WHERE THE MEDIAN WIDTH IS 6' (2 m) OR LESS USE TWO-WAY MARKERS.

All dimensions are in inches (millimeters) unless otherwise shown.

|   |                                  |                                 |                                 |   |  |                         |                           |           |                       |                           |              |           |
|---|----------------------------------|---------------------------------|---------------------------------|---|--|-------------------------|---------------------------|-----------|-----------------------|---------------------------|--------------|-----------|
| FILE NAME =   | USER NAME = pyrzenowski          | DESIGNED -                      | REVISED - T. RAMMACHER 09-19-94 | <b>STATE OF ILLINOIS<br/>DEPARTMENT OF TRANSPORTATION</b> | <b>TYPICAL APPLICATIONS<br/>RAISED REFLECTIVE PAVEMENT MARKERS (SNOW-PLOW RESISTANT)</b> |                         |                           | F.A. RTE. | SECTION               | COUNTY                    | TOTAL SHEETS | SHEET NO. |
| pw:\IL\084EBIDINTEG\illinois.gov\PIWIDOT\Documents\IDOT Offices\District 1\Projects\DI05415\Design\DI05415-sht-plen.dgn | PLotted SCALE = 100.0000' / 1" = | CHECKED -                       | REVISED - T. RAMMACHER 03-12-99 |   |  |                         |                           | 1419      | 0405RS-6              | COOK                      | 21           | 16        |
| PLotted DATE = 10/26/2016   | DATE -                           | REVISED - T. RAMMACHER 01-06-00 | REVISED - C. JUCIUS 09-09-09    |   | <b>TC-11</b>   |                         | <b>CONTRACT NO. 62A03</b> |           | FED. ROAD DIST. NO. 1 | ILLINOIS FED. AID PROJECT |              |           |
|   |                                  |                                 |                                 |   | SCALE: NONE  | SHEET NO. 1 OF 1 SHEETS | STA.                      | TO STA.   |                       |                           |              |           |



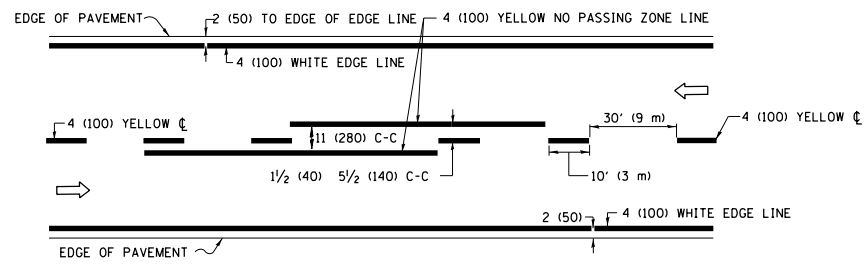

**2-LANE ROADWAY**

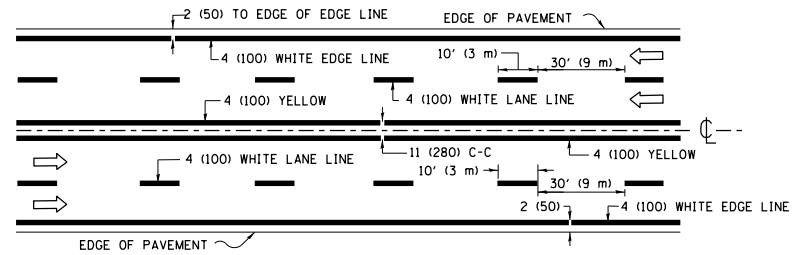

**MULTI-LANE UNDIVIDED**

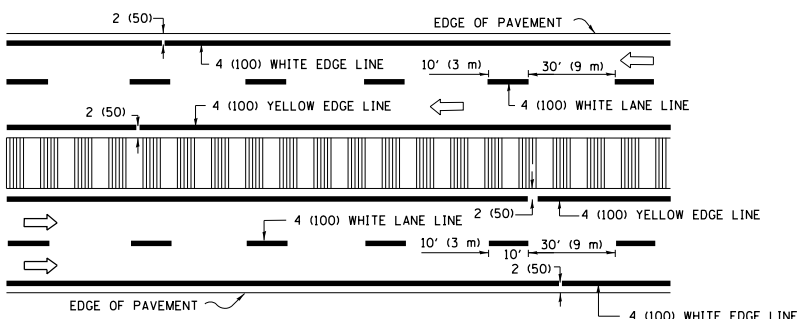

**MULTI-LANE DIVIDED WITH MEDIAN**

**TYPICAL LANE AND EDGE LINE MARKING**

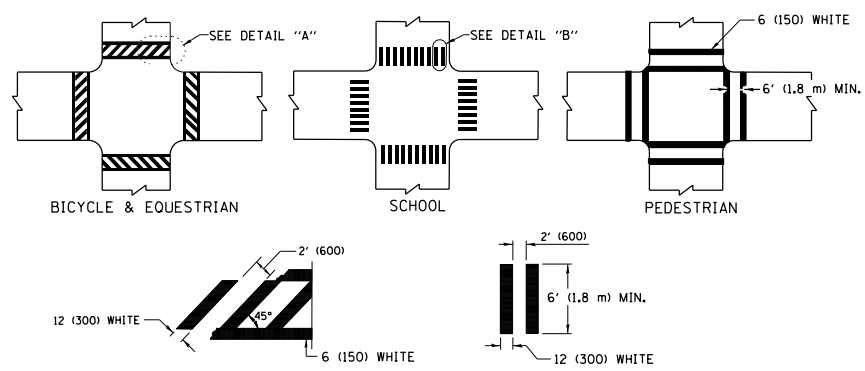

**TYPICAL CROSSWALK MARKING**

\* MARKINGS SHALL BE INSTALLED PARALLEL TO THE CENTERLINE OF THE ROAD WHICH IT CROSSES

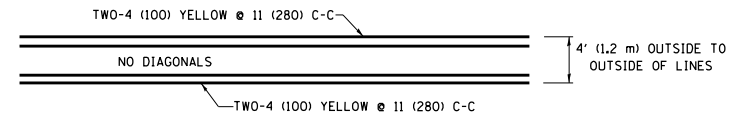

**4' (1.2 m) WIDE MEDIANS ONLY**

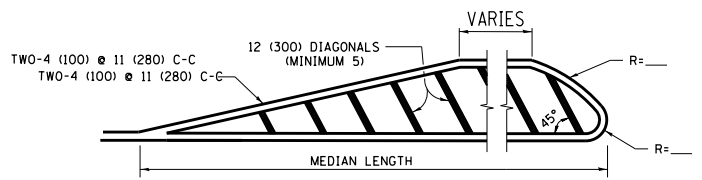

**MEDIANS OVER 4' (1.2 m) WIDE**

DIAGONAL LINE SPACING: 50' (15 m) C-C (LESS THAN 30MPH (50 km/h))  
75' (25 m) C-C 30MPH (50 km/h) TO 45MPH (70 km/h)  
150' (45 m) C-C (MORE THAN 45MPH (70 km/h))

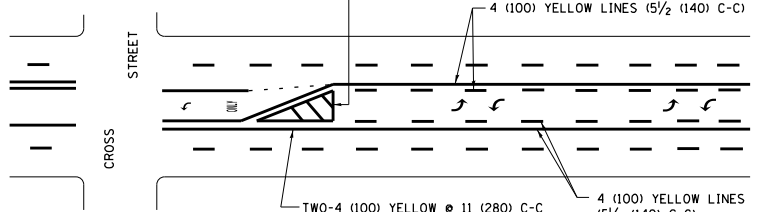

**MEDIAN WITH TWO-WAY LEFT TURN LANE  
TYPICAL PAINTED MEDIAN MARKING**

A MINIMUM OF TWO PAIRS OF TURN ARROWS SHALL BE USED, WHITE IN COLOR. ADDITIONAL PAIRS SHALL BE PLACED AT 200' (60 m) TO 300' (90 m) INTERVALS.

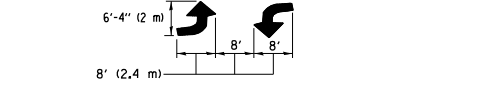

**TYPICAL LEFT (OR RIGHT) TURN LANE**

**TYPICAL TURN LANE MARKING**

FULL SIZE LETTERS 8' (2.4 m) AND ARROWS SHALL BE USED.  
AREA = 15.6 SQ. FT. (1.5 m<sup>2</sup>) ONLY AREA = 20.8 SQ. FT. (1.9 m<sup>2</sup>)  
\* TURN LANES IN EXCESS OF 400' (120 m) IN LENGTH MAY HAVE AN ADDITIONAL SET OF ARROW - "ONLY" INSTALLED MIDWAY BETWEEN THE OTHER TWO SETS OF ARROW - "ONLY".

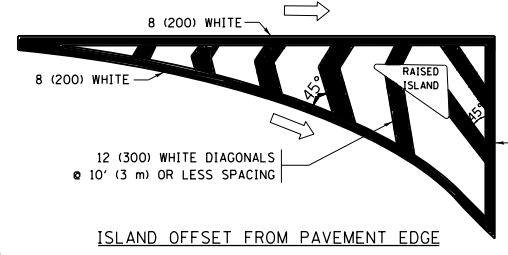

**ISLAND OFFSET FROM PAVEMENT EDGE**

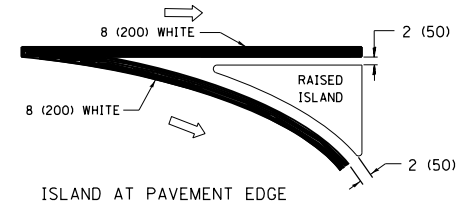

**ISLAND AT PAVEMENT EDGE  
TYPICAL ISLAND MARKING**

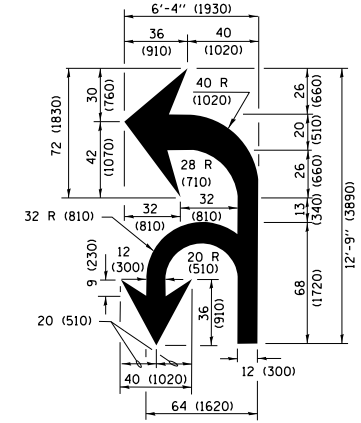

**COMBINATION LEFT AND U-TURN**

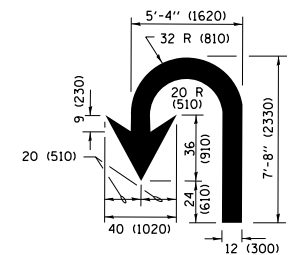

**U-TURN**

**LANE REDUCTION TRANSITION**

\* LANE REDUCTION ARROWS REQUIRED AT SPEEDS OF 45 MPH OR GREATER OR WHEN SPECIFIED IN PLANS.

| D(FT) | SPEED LIMIT |
|-------|-------------|
| 345   | 30          |
| 425   | 35          |
| 500   | 40          |
| 580   | 45          |
| 665   | 50          |
| 750   | 55          |

| TYPE OF MARKING   | WIDTH OF LINE  | PATTERN                      | COLOR   | SPACING /REMARKS  |
|---|--|------------------------------|---|---|
| CENTERLINE ON 2 LANE PAVEMENT   | 4 (100)  | SKIP-DASH                    | YELLOW  | 10' (3 m) LINE WITH 30' (9 m) SPACE   |
| CENTERLINE ON MULTI-LANE UNDIVIDED PAVEMENT   | 2 @ 4 (100)  | SOLID                        | YELLOW  | 11 (280) C-C  |
| NO PASSING ZONE LINES FOR ONE DIRECTION FOR BOTH DIRECTIONS                                       | 4 (100)<br>2 @ 4 (100)   | SOLID<br>SOLID               | YELLOW<br>YELLOW  | 5 1/2 (140) C-C FROM SKIP-DASH CENTERLINE<br>11 (280) C-C<br>OMIT SKIP-DASH CENTERLINE BETWEEN  |
| LANE LINES  | 4 (100)<br>5 (125) ON FREEWAYS   | SKIP-DASH<br>SKIP-DASH       | WHITE<br>WHITE  | 10' (3 m) LINE WITH 30' (9 m) SPACE   |
| DOTTED LINES (EXTENSIONS OF CENTER, LANE OR TURN LANE MARKINGS)                                   | SAME AS LINE BEING EXTENDED  | SKIP-DASH                    | SAME AS LINE BEING EXTENDED                             | 2' (600) LINE WITH 6' (1.8 m) SPACE   |
| EDGE LINES  | 4 (100)  | SOLID                        | YELLOW-LEFT<br>WHITE-RIGHT                              | OUTLINE MEDIANS IN YELLOW   |
| TURN LANE MARKINGS  | 6 (150) LINE; FULL SIZE LETTERS & SYMBOLS (8' (2.4m))                                      | SOLID                        | WHITE   | SEE TYPICAL TURN LANE MARKING DETAIL  |
| TWO WAY LEFT TURN MARKING   | 2 @ 4 (100) EACH DIRECTION<br>8' (2.4m) LEFT ARROW   | SKIP-DASH AND SOLID IN PAIRS | YELLOW<br>WHITE   | 10' (3 m) LINE WITH 30' (9 m) SPACE FOR SKIP-DASH; 5 1/2 (140) C-C BETWEEN SOLID LINE AND SKIP-DASH LINE<br>SEE TYPICAL TWO-WAY LEFT TURN MARKING DETAIL            |
| CROSSWALK LINES (PEDESTRIAN)<br>A. DIAGONALS (BIKE & EQUESTRIAN)<br>B. LONGITUDINAL BARS (SCHOOL) | 2 @ 6 (150)<br>12 (300) @ 45°<br>12 (300) @ 90°  | SOLID<br>SOLID<br>SOLID      | WHITE<br>WHITE<br>WHITE                                 | NOT LESS THAN 6' (1.8 m) APART<br>2' (600) APART<br>SEE TYPICAL CROSSWALK MARKING DETAILS.  |
| STOP LINES  | 24 (600)   | SOLID                        | WHITE   | PLACE 4' (1.2 m) IN ADVANCE OF AND PARALLEL TO CROSSWALK, IF PRESENT, OTHERWISE, PLACE AT DESIRED STOPPING POINT, PARALLEL TO CROSSROAD CENTERLINE, WHERE POSSIBLE. |
| PAINTED MEDIANS   | 2 @ 4 (100) WITH 12 (300) DIAGONALS @ 45°<br>NO DIAGONALS USED FOR 4' (1.2 m) WIDE MEDIANS | SOLID                        | YELLOW;<br>TWO WAY TRAFFIC<br>WHITE;<br>ONE WAY TRAFFIC | 11 (280) C-C FOR THE DOUBLE LINE<br>SEE TYPICAL PAINTED MEDIAN MARKING.   |
| GORE MARKING AND CHANNELIZING LINES   | 8 (200) WITH 12 (300) DIAGONALS @ 45°  | SOLID                        | WHITE   | DIAGONALS:<br>15' (4.5 m) C-C (LESS THAN 30MPH (50 km/h))<br>20' (6 m) C-C 30MPH (50 km/h) TO 45MPH (70 km/h)<br>30' (9 m) C-C (OVER 45MPH (70 km/h))               |
| RAILROAD CROSSING   | 24 (600) TRANSVERSE LINES; "RR" IS 6' (1.8 m) LETTERS; 16 (400) LINE FOR "X"               | SOLID                        | WHITE   | SEE STATE STANDARD 780001<br>AREA OF:<br>"R"=3.6 SQ. FT. (0.33 m <sup>2</sup> ) EACH<br>"X"=54.0 SQ. FT. (5.0 m <sup>2</sup> )                                      |
| SHOULDER DIAGONALS (REQUIRED FOR SHOULDERS ≥ 8')  | 12 (300) @ 45°   | SOLID                        | WHITE - RIGHT<br>YELLOW - LEFT                          | 50' (15 m) C-C (LESS THAN 30MPH (50 km/h))<br>75' (25 m) C-C (30 MPH (50 km/h) TO 45MPH (70 km/h))<br>150' (45 m) C-C (OVER 45MPH (70 km/h))                        |
| U TURN ARROW  | SEE DETAIL   | SOLID                        | WHITE   | 16.3 SF   |
| 2 ARROW COMBINATION LEFT AND U TURN   | SEE DETAIL   | SOLID                        | WHITE   | 30.4 SF   |

FOR FURTHER DETAILS ON PAVEMENT MARKING REFER TO STANDARD SPECIFICATIONS FOR ROAD AND BRIDGE CONSTRUCTION AND STATE STANDARD 780001.

All dimensions are in inches (millimeters) unless otherwise shown.

|   |                              |                  |                              |
|---|------------------------------|------------------|------------------------------|
| FILE NAME =   | USER NAME = pyrzanowski      | DESIGNED - EVERS | REVISED - C. JUCIUS 09-09-09 |
| pw\1\084EBIDINTEG\illinois.gov\PIWIDOT\Documents\DOT Offices\District 1\Projects\01054\Drawings\Design\0105415-sht-plen.dgn |                              | CHECKED -        | REVISED - C. JUCIUS 07-01-13 |
| Default   | PLOT SCALE = 100.0000' / in. | DATE - 03-19-90  | REVISED - C. JUCIUS 12-21-15 |
|   |                              |                  | REVISED - C. JUCIUS 04-12-16 |

**STATE OF ILLINOIS  
DEPARTMENT OF TRANSPORTATION**

|                                  |         |             |              |
|----------------------------------|---------|-------------|--------------|
| <b>DISTRICT ONE</b>              |         |             |              |
| <b>TYPICAL PAVEMENT MARKINGS</b> |         |             |              |
| SCALE: NONE                      | SHEET 1 | OF 1 SHEETS | STA. TO STA. |

|                           |          |                           |              |           |
|---------------------------|----------|---------------------------|--------------|-----------|
| F.A. RTE.                 | SECTION  | COUNTY                    | TOTAL SHEETS | SHEET NO. |
| 1419                      | 0405RS-6 | COOK                      | 21           | 17        |
| <b>TC-13</b>              |          | <b>CONTRACT NO. 62A03</b> |              |           |
| ILLINOIS FED. AID PROJECT |          |                           |              |           |

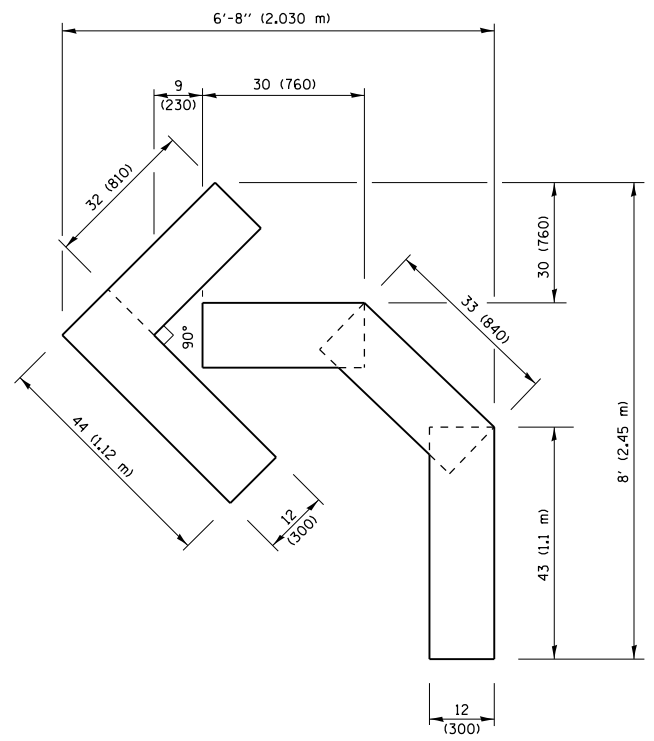

**QUANTITY**  
 4 (100) LINE = 45.5 ft. (13.9 m)  
 15.2 sq. ft. (1.41 sq. m)

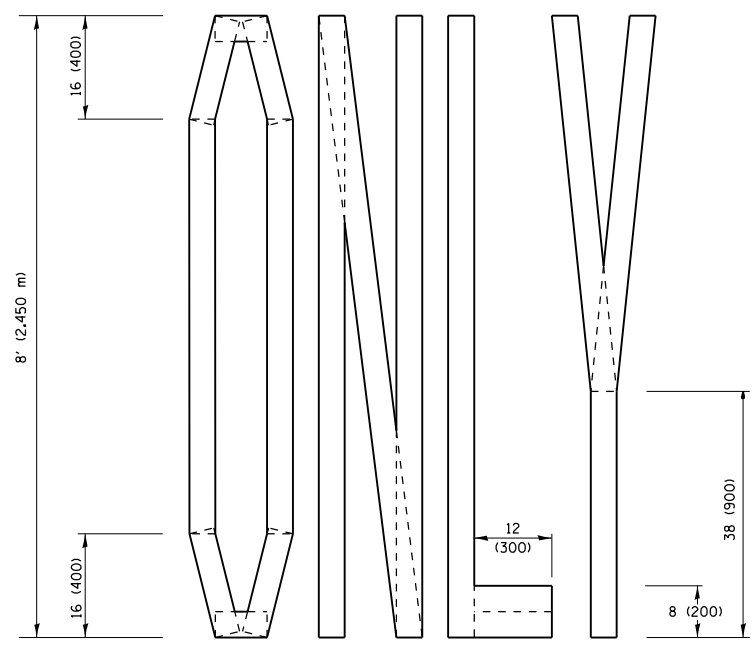
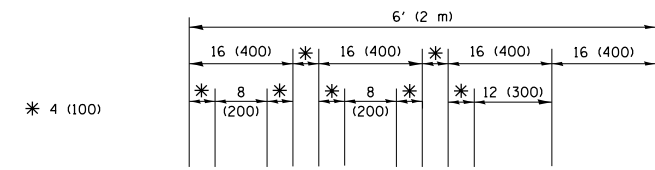

**QUANTITY**  
 4 (100) LINE = 64.1 ft. (19.5 m)  
 21.4 sq. ft. (1.99 sq. m)

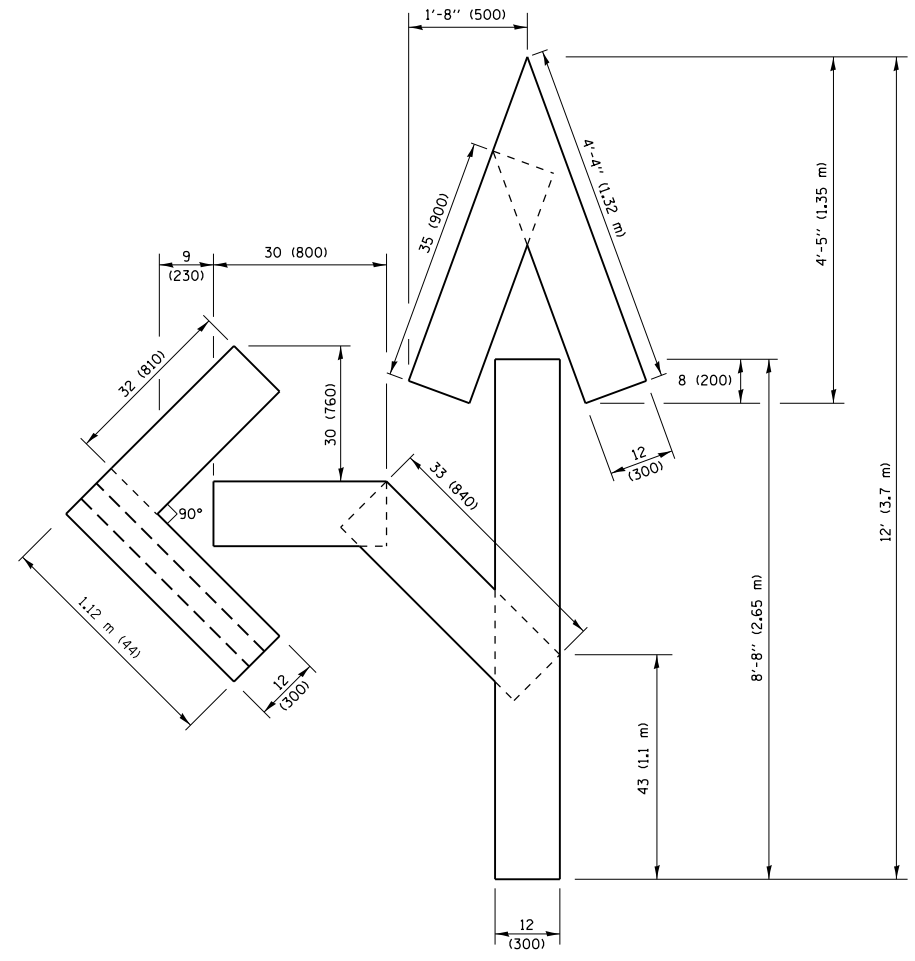

**QUANTITY**  
 4 (100) LINE = 82.5 ft. (25.1 m)  
 27.5 sq. ft. (2.53 sq. m)

**NOTE:**  
 ALL QUANTITIES OF PLACEMENT ARE REPRESENTED IN LINEAR FEET OF 4" LINES TO MATCH THE 4" TEMPORARY TAPE PAY ITEM AND REPRESENTS THE TOTAL QUANTITY OF 4" TAPE REQUIRED.

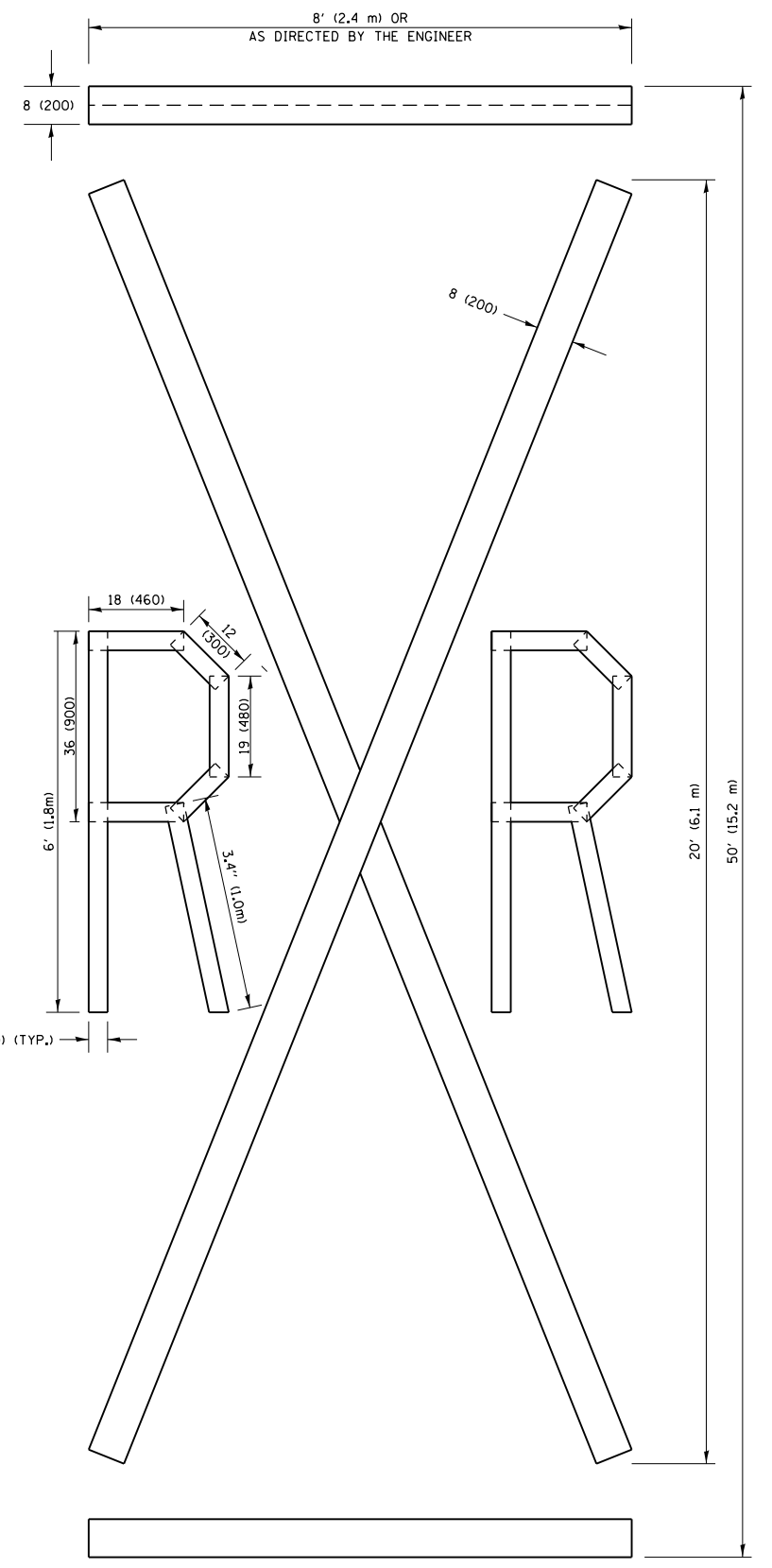

**QUANTITY**  
 4 (100) LINE = 225.9 ft. (68.9 m)  
 75.3 sq. ft. (6.99 sq. m)

All dimensions are in inches (millimeters) unless otherwise shown.

|   |                         |            |                                |
|---|-------------------------|------------|--------------------------------|
| FILE NAME =   | USER NAME = pyrzenowski | DESIGNED - | REVISED -T. RAMMACHER 03-02-98 |
| p:\11\084EBIDINTEG.illinois.gov\PIWIDOT\Documents\DOT Offices\District 1\Projects\DI054\Design\DI05415-sht-plen.dgn |                         | CHECKED -  | REVISED -E. GOMEZ 08-28-00     |
|   |                         | DATE -     | REVISED -E. GOMEZ 08-28-00     |
|   |                         |            | REVISED -A. SCHUETZE 09-15-16  |

**STATE OF ILLINOIS  
 DEPARTMENT OF TRANSPORTATION**

|  |                         |      |         |
|--|-------------------------|------|---------|
| <b>SHORT TERM PAVEMENT MARKING LETTERS AND SYMBOLS</b> |                         |      |         |
| SCALE: NONE  | SHEET NO. 1 OF 1 SHEETS | STA. | TO STA. |

|   |          |                           |              |           |
|---|----------|---------------------------|--------------|-----------|
| F.A. RTE.                                       | SECTION  | COUNTY                    | TOTAL SHEETS | SHEET NO. |
| 1419  | 0405RS-6 | COOK                      | 21           | 18        |
| <b>TC-16</b>                                    |          | <b>CONTRACT NO. 62A03</b> |              |           |
| FED. ROAD DIST. NO. 1 ILLINOIS FED. AID PROJECT |          |                           |              |           |

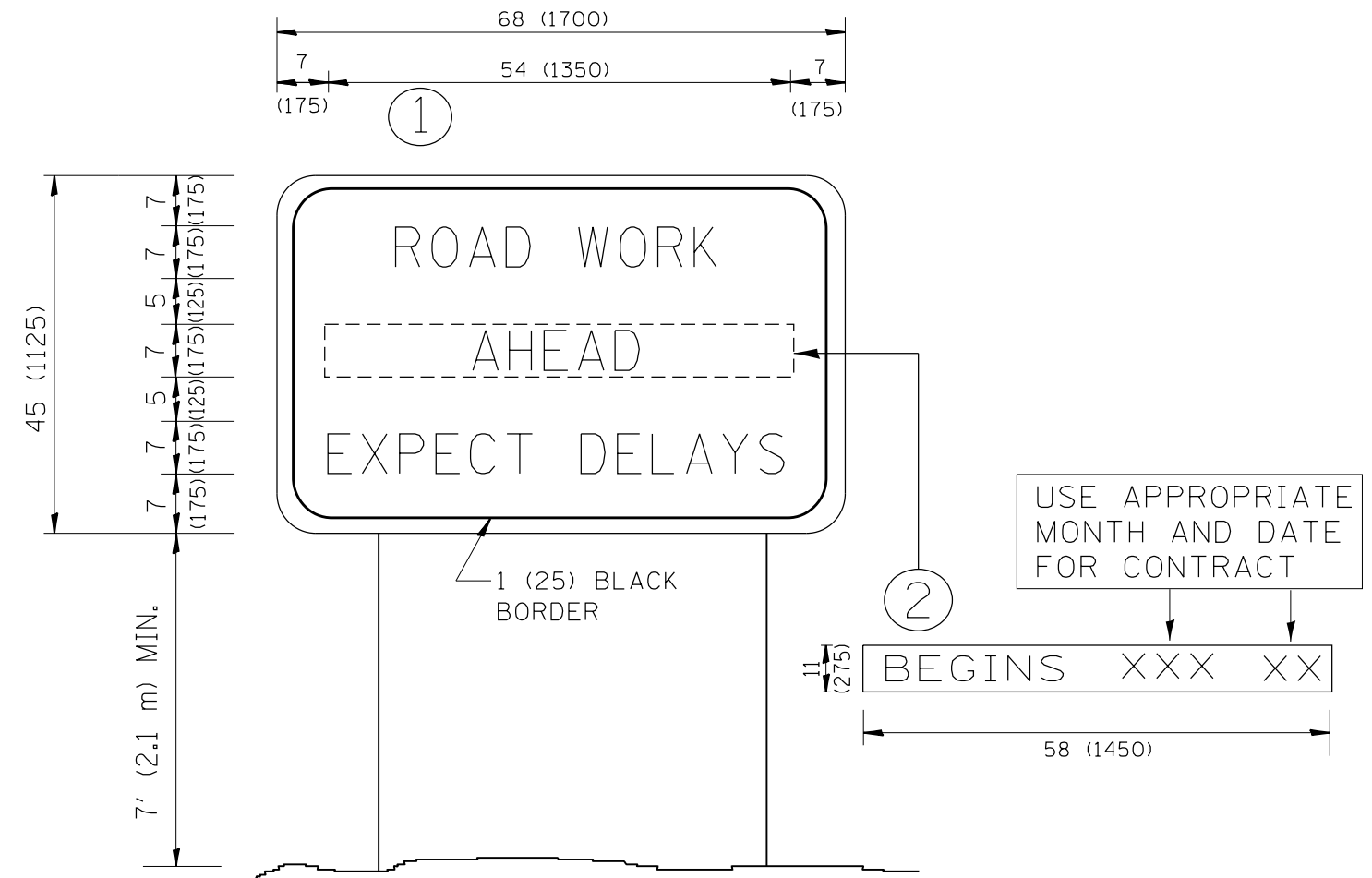

**NOTES:**

1. USE BLACK LETTERING ON ORANGE BACKGROUND.
2. ERECT SIGNS IN ADVANCE OF THE LOCATION FOR THE "ROAD CONSTRUCTION AHEAD" SIGN AT LOCATIONS AS DIRECTED BY THE ENGINEER.
3. ERECT SIGN ① WITH INSTALLED PANEL ② ONE WEEK PRIOR TO THE START OF CONSTRUCTION.
4. REMOVE PANEL ② SOON AFTER THE START OF CONSTRUCTION.
5. SEE SPECIAL PROVISION FOR "TEMPORARY INFORMATION SIGNING" FOR ADDITIONAL INFORMATION.
6. ONE SIGN ASSEMBLY EQUALS 25.70 SQ. FT. (2.3 SQ. M.)
7. SHALL BE PAID FOR AS TEMPORARY INFORMATION SIGNING.

ALL DIMENSIONS ARE IN INCHES (MILLIMETERS) UNLESS OTHERWISE SHOWN.

|  |                         |                               |                                 |   |   |          |         |                           |         |        |              |           |
|--|-------------------------|-------------------------------|---------------------------------|---|---|----------|---------|---------------------------|---------|--------|--------------|-----------|
| FILE NAME =  | USER NAME = pyznowskirb | DESIGNED -                    | REVISED - R. MIRS 09-15-97      | <b>STATE OF ILLINOIS<br/>DEPARTMENT OF TRANSPORTATION</b> | <b>ARTERIAL ROAD<br/>INFORMATION SIGN</b>         |          |         | F.A. RTE.                 | SECTION | COUNTY | TOTAL SHEETS | SHEET NO. |
| p:\11\084EBIDINTEG.illinois.gov\PWIDOT\Documents\DOT Offices\District 1\Projects\DI0544\Drawings\Design\DI05415-sht-plen.dgn |                         | DRAWN -                       | REVISED - R. MIRS 12-11-97      |   | 1419  | 0405RS-6 | COOK    | 21                        | 19      |        |              |           |
|  |                         | CHECKED -                     | REVISED - T. RAMMACHER 02-02-99 |   | <b>TC-22</b>                                      |          |         | <b>CONTRACT NO. 62A03</b> |         |        |              |           |
|  |                         | DATE -                        | REVISED - C. JUCIUS 01-31-07    |   | FED. ROAD DIST. NO. 1   ILLINOIS FED. AID PROJECT |          |         |                           |         |        |              |           |
|  |                         | PLOT SCALE = 100.0000' / 1in. |                                 | SCALE: NONE   | SHEET NO. 1 OF 1 SHEETS                           | STA.     | TO STA. |                           |         |        |              |           |

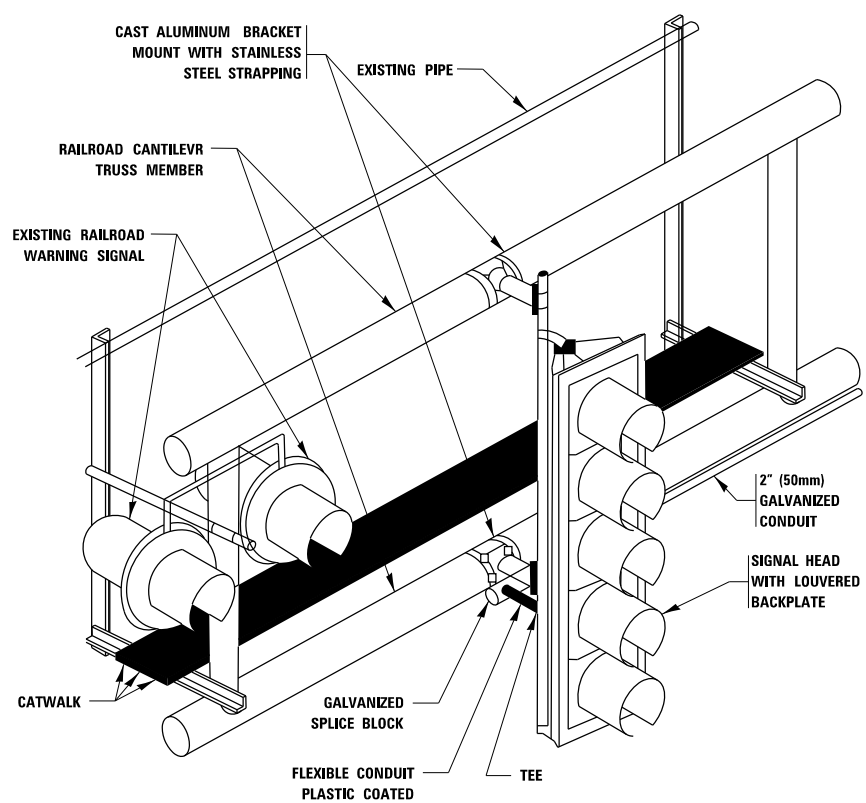

**RAILROAD CANTILEVER SIGNAL HEAD MOUNTING**  
 USE NON-CONDUCTIVE SPACERS BETWEEN THE TRAFFIC SIGNAL EQUIPMENT AND THE RAILROAD CANTILEVER TO PREVENT DISSIMILAR METAL CORROSION  
 N.T.S.

**SIGNING AND PAVEMENT MARKING AT RAILROAD CROSSINGS**

SIGNING AND PAVEMENT MARKING TRAFFIC CONTROL STANDARD (TC-23) HAS BEEN DEVELOPED IN CONSULTATION WITH THE ILLINOIS COMMERCE COMMISSION AND THE U.S. DEPARTMENT OF TRANSPORTATION'S GRADE CROSSING SAFETY TASK FORCE. THIS STANDARD PROVIDES INFORMATION ON UPDATES TO THE PAVEMENT MARKING AND SIGNING DETAILS IN ORDER TO INCORPORATE CHANGES ADOPTED IN THE 2009 NATIONAL MANUAL ON UNIFORM TRAFFIC CONTROL DEVICE (MUTCD). THESE NEW DETAILS HAVE BEEN STUDIED AND TESTED BY THE DEPARTMENT AND ACCEPTED BY THE ILLINOIS COMMERCE COMMISSION.

THIS APPLIES TO PROJECTS WHICH INCLUDE RAILROAD INTERCONNECTED TRAFFIC SIGNALS, WITH OR WITHOUT PRE-SIGNALS. THIS STANDARD ALSO APPLIES TO NON-SIGNALIZED INTERSECTIONS THAT ARE WITHIN 81 FEET OF A RAILROAD GRADE CROSSING. THE ILLINOIS SUPPLEMENT TO THE MUTCD SHOULD BE CONSULTED FOR ADDITIONAL INFORMATION ON SIGN REQUIREMENTS AT NON-SIGNALIZED INTERSECTIONS NEAR RAILROAD GRADE CROSSINGS.

THESE DETAILS WILL BE INCLUDED IN A FUTURE UPDATE TO THE BUREAU OF OPERATIONS TRAFFIC POLICIES AND PROCEDURES MANUAL.

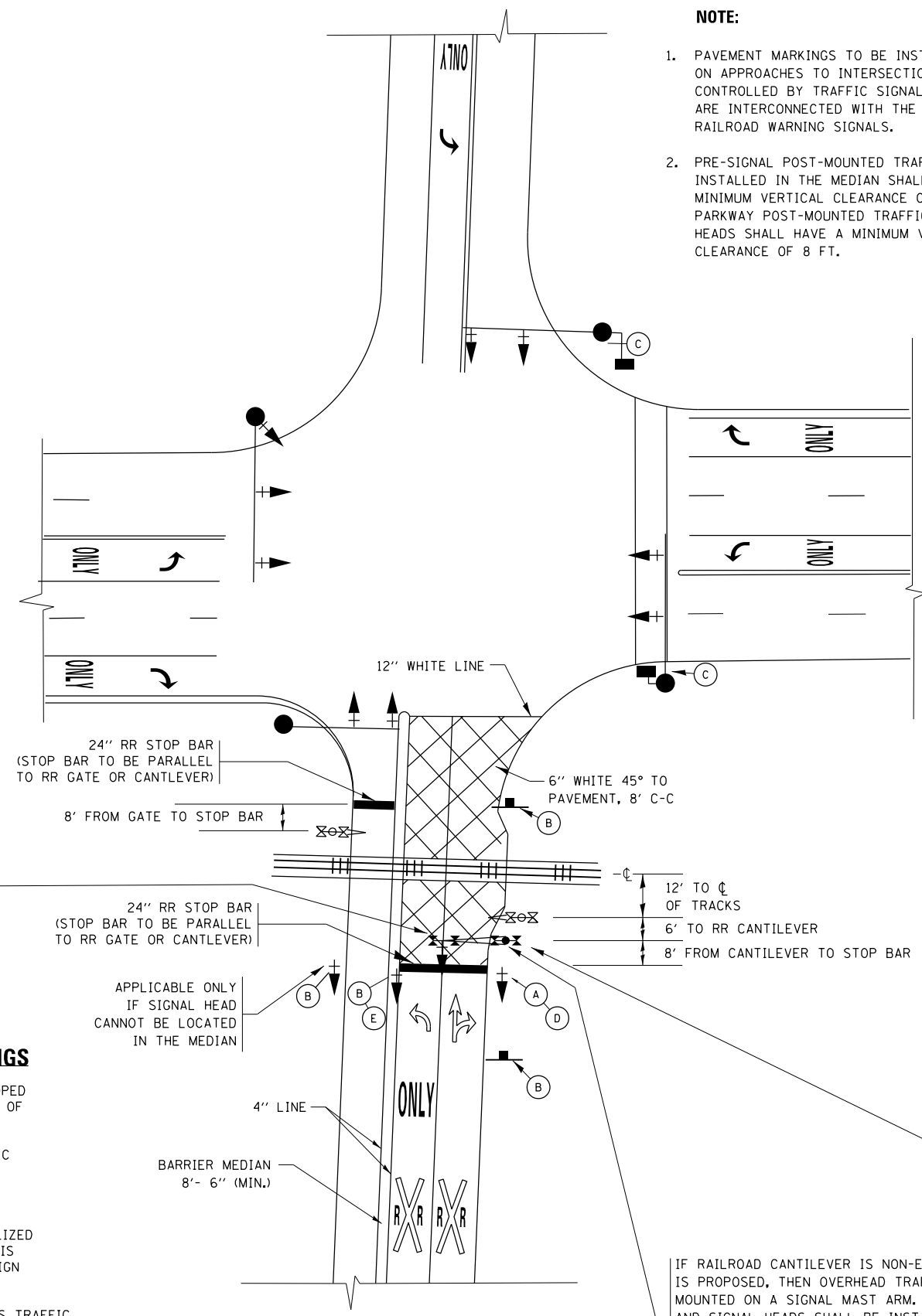

**SIGNALIZED INTERSECTION WITH NEAR-SIDE TRAFFIC SIGNAL**

- NOTE:**
- PAVEMENT MARKINGS TO BE INSTALLED ONLY ON APPROACHES TO INTERSECTIONS CONTROLLED BY TRAFFIC SIGNALS WHICH ARE INTERCONNECTED WITH THE RAILROAD WARNING SIGNALS.
  - PRE-SIGNAL POST-MOUNTED TRAFFIC SIGNAL HEADS INSTALLED IN THE MEDIAN SHALL HAVE A MINIMUM VERTICAL CLEARANCE OF 4.5 FT. PARKWAY POST-MOUNTED TRAFFIC SIGNAL HEADS SHALL HAVE A MINIMUM VERTICAL CLEARANCE OF 8 FT.

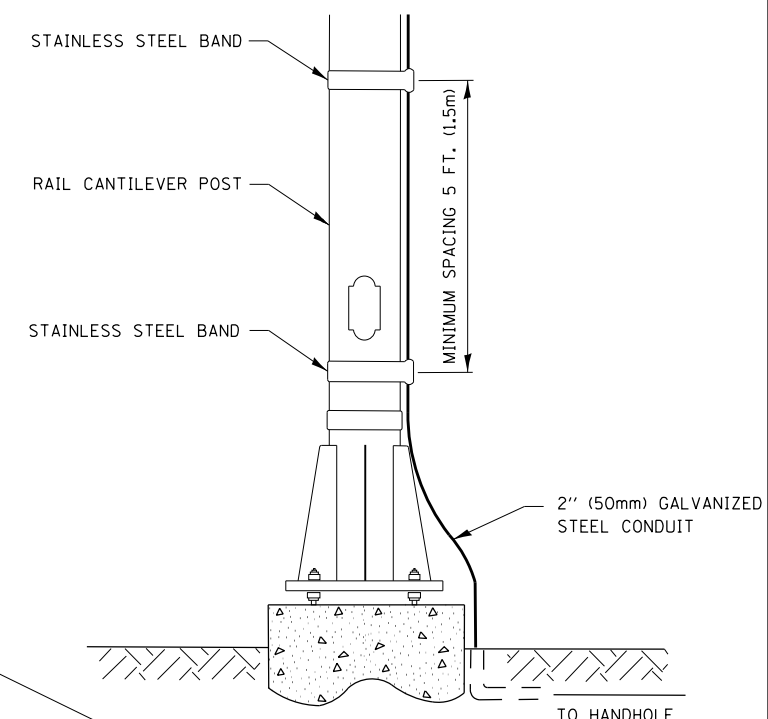
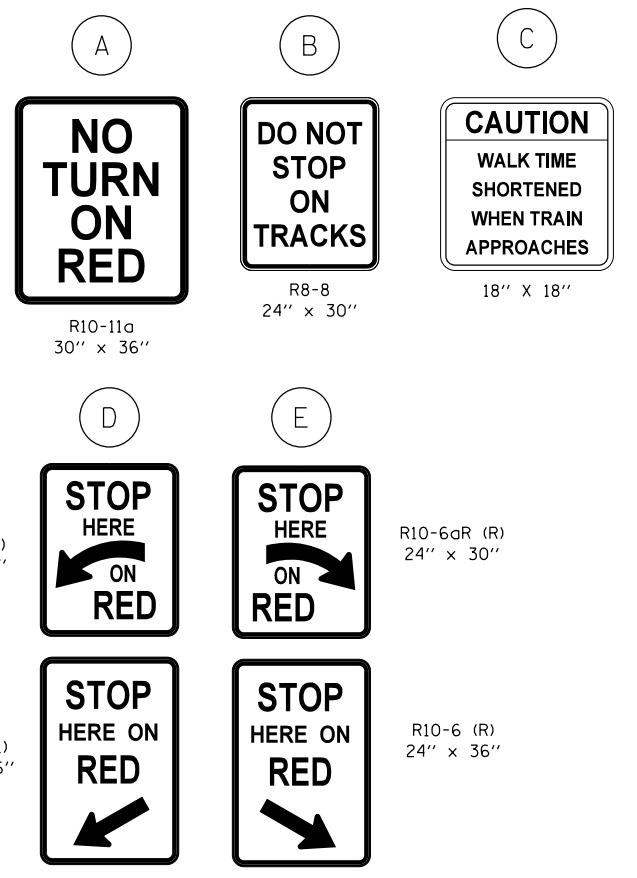

**SIGNAL CONDUIT CONNECTION TO RAIL CANTILEVER DETAIL**

USE NON-CONDUCTIVE SPACERS BETWEEN THE TRAFFIC SIGNAL EQUIPMENT AND THE RAILROAD CANTILEVER TO PREVENT DISSIMILAR METAL CORROSION.

ALL DIMENSIONS ARE IN INCHES (MILLIMETERS) UNLESS OTHERWISE SHOWN.

IF RAILROAD CANTILEVER IS NON-EXISTANT AND NONE IS PROPOSED, THEN OVERHEAD TRAFFIC SIGNAL TO BE MOUNTED ON A SIGNAL MAST ARM. SIGNAL MAST ARM AND SIGNAL HEADS SHALL BE INSTALLED AS CLOSE AS PRACTICABLE TO THE RAILROAD TRACKS WITHOUT OBSTRUCTING ANY RAILROAD WARNING DEVICES. SIGNAL MAST ARM SHALL BE AT LEAST 12 FT. FROM NEAREST RAIL.

|   |                               |            |                         |
|---|-------------------------------|------------|-------------------------|
| FILE NAME =   | USER NAME = pyrzenowski       | DESIGNED - | REVISED - 02-25-11      |
| pw\1\084EBIDINTEG.illinois.gov\PIWIDOT\Documents\DOT Offices\District 1\Projects\DI054\Drawings\Design\DI05415-sht-plen.dgn |                               | CHECKED -  | REVISED - 04-26-12      |
| Default   | PLOT SCALE = 100.0000' / 1in. | DATE -     | REVISED - A.R. 07-11-16 |
|   | PLOT DATE = 10/26/2016        |            | REVISED -               |

STATE OF ILLINOIS  
 DEPARTMENT OF TRANSPORTATION

TYPICAL SUPPLEMENTAL SIGNING AND PAVEMENT MARKING  
 TREATMENT FOR RAILROAD CROSSINGS

SCALE: NONE SHEET 1 OF 2 SHEETS STA. TO STA.

| F.A. RTE.                 | SECTION  | COUNTY             | TOTAL SHEETS | SHEET NO. |
|---------------------------|----------|--------------------|--------------|-----------|
| 1419                      | 0405RS-6 | COOK               | 21           | 20        |
| TC-23                     |          | CONTRACT NO. 62A03 |              |           |
| ILLINOIS FED. AID PROJECT |          |                    |              |           |

# TYPICAL SUPPLEMENTAL SIGNING AND PAVEMENT MARKING TREATMENT FOR RAILROAD CROSSINGS

## WITH SIGNALIZED INTERSECTION

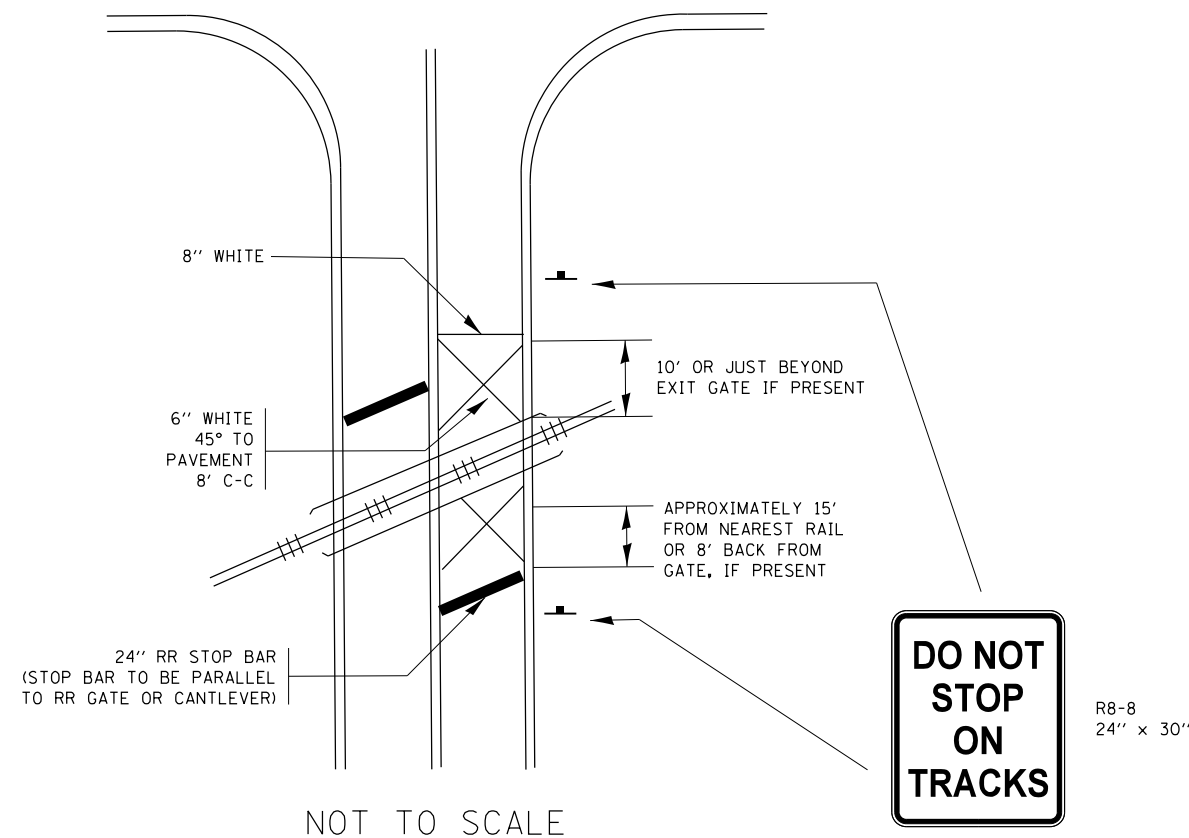

### NOTE:

- PAVEMENT MARKINGS TO BE INSTALLED ONLY ON APPROACHES TO INTERSECTIONS CONTROLLED BY TRAFFIC SIGNALS WHICH ARE INTERCONNECTED WITH THE RAILROAD WARNING SIGNALS.
- WHERE NEAR-SIDE TRAFFIC SIGNALS ARE USED THE PAVEMENT MARKINGS EXTEND TO THE INTERSECTION. (SEE DETAIL FOR PRE-SIGNALS).

## WITH NON-SIGNALIZED INTERSECTION 81' OR LESS TO CLOSEST RAIL

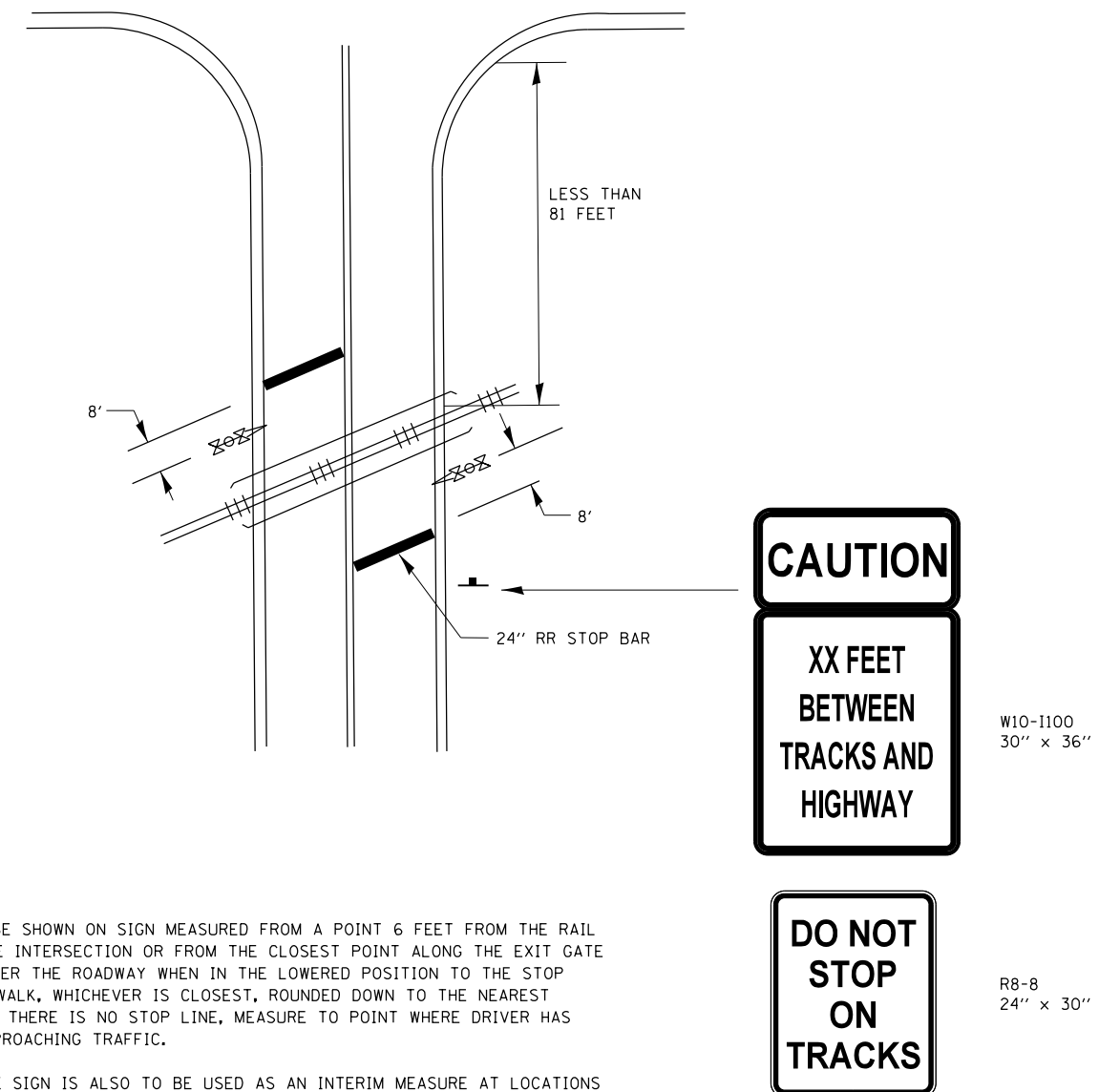

### NOTE:

- DISTANCE TO BE SHOWN ON SIGN MEASURED FROM A POINT 6 FEET FROM THE RAIL CLOSEST TO THE INTERSECTION OR FROM THE CLOSEST POINT ALONG THE EXIT GATE IF PRESENT OVER THE ROADWAY WHEN IN THE LOWERED POSITION TO THE STOP BAR OR CROSSWALK, WHICHEVER IS CLOSEST, ROUNDED DOWN TO THE NEAREST 5 FEET. WHERE THERE IS NO STOP LINE, MEASURE TO POINT WHERE DRIVER HAS A VIEW OF APPROACHING TRAFFIC.
- THE CLEARANCE SIGN IS ALSO TO BE USED AS AN INTERIM MEASURE AT LOCATIONS WITH INTERCONNECTED INTERSECTION TRAFFIC SIGNALS WHERE IT IS PLANNED TO CHANGE THEM TO NEAR-SIDE SIGNALS AT A FUTURE TIME. IN THIS CASE, THE DISTANCE TO BE SHOWN ON THE SIGN IS MEASURED FROM THE EDGE OF THE STRIPED-OUT AREA INSTEAD OF 6 FEET FROM THE RAIL. THE SIGN IS TO BE REMOVED WHEN THE NEAR-SIDE SIGNALS ARE INSTALLED AND THE PAVEMENT MARKING EXTEND TO THE INTERSECTION.

ALL DIMENSIONS ARE IN INCHES (MILLIMETERS)  
UNLESS OTHERWISE SHOWN.

|  |                         |            |                         |   |   |                           |          |                           |              |           |
|--|-------------------------|------------|-------------------------|---|---|---------------------------|----------|---------------------------|--------------|-----------|
| FILE NAME =  | USER NAME = pyrzenowski | DESIGNED - | REVISED - 02-25-11      | <b>STATE OF ILLINOIS<br/>DEPARTMENT OF TRANSPORTATION</b> | <b>TYPICAL SUPPLEMENTAL SIGNING AND PAVEMENT MARKING<br/>TREATMENT FOR RAILROAD CROSSINGS</b> | F.A. RTE.                 | SECTION  | COUNTY                    | TOTAL SHEETS | SHEET NO. |
| pw:\IL\084EBIDINTEG\illinois.gov\PIDOT\Documents\IDOT Offices\District 1\Projects\DI054\Drawings\Design\DI05415-sht-plen.dgn | PLotted                 | CHECKED -  | REVISED - 04-26-12      |   |   | 1419                      | 0405RS-6 | COOK                      | 21           | 21        |
| Default  | PLotted                 | DATE -     | REVISED - A.R. 07-11-16 |   |   | <b>TC-23</b>              |          | <b>CONTRACT NO. 62A03</b> |              |           |
|  | PLotted                 | DATE -     | REVISED -               |   |   | ILLINOIS FED. AID PROJECT |          |                           |              |           |
|  |                         |            |                         |   |   | SCALE: NONE               | SHEET 2  | OF 2 SHEETS               | STA.         | TO STA.   |