







STA. 82+98
N=375469.8
E=801374.0

LEGEND

-  PROPOSED SIGN STRUCTURE
-  EXISTING SIGN STRUCTURE
-  EXISTING SIGN PANEL TO REMAIN
-  EXISTING SIGN PANEL TO BE REMOVED
-  PROPOSED SIGN PANEL
-  EXISTING GROUND MOUNTED SIGN
-  PROPOSED GROUND MOUNTED SIGN

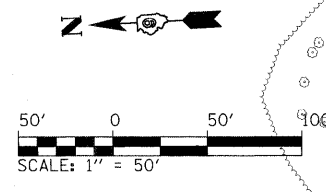

MATCHLINE STA. 82+00

MATCHLINE STA. 96+00

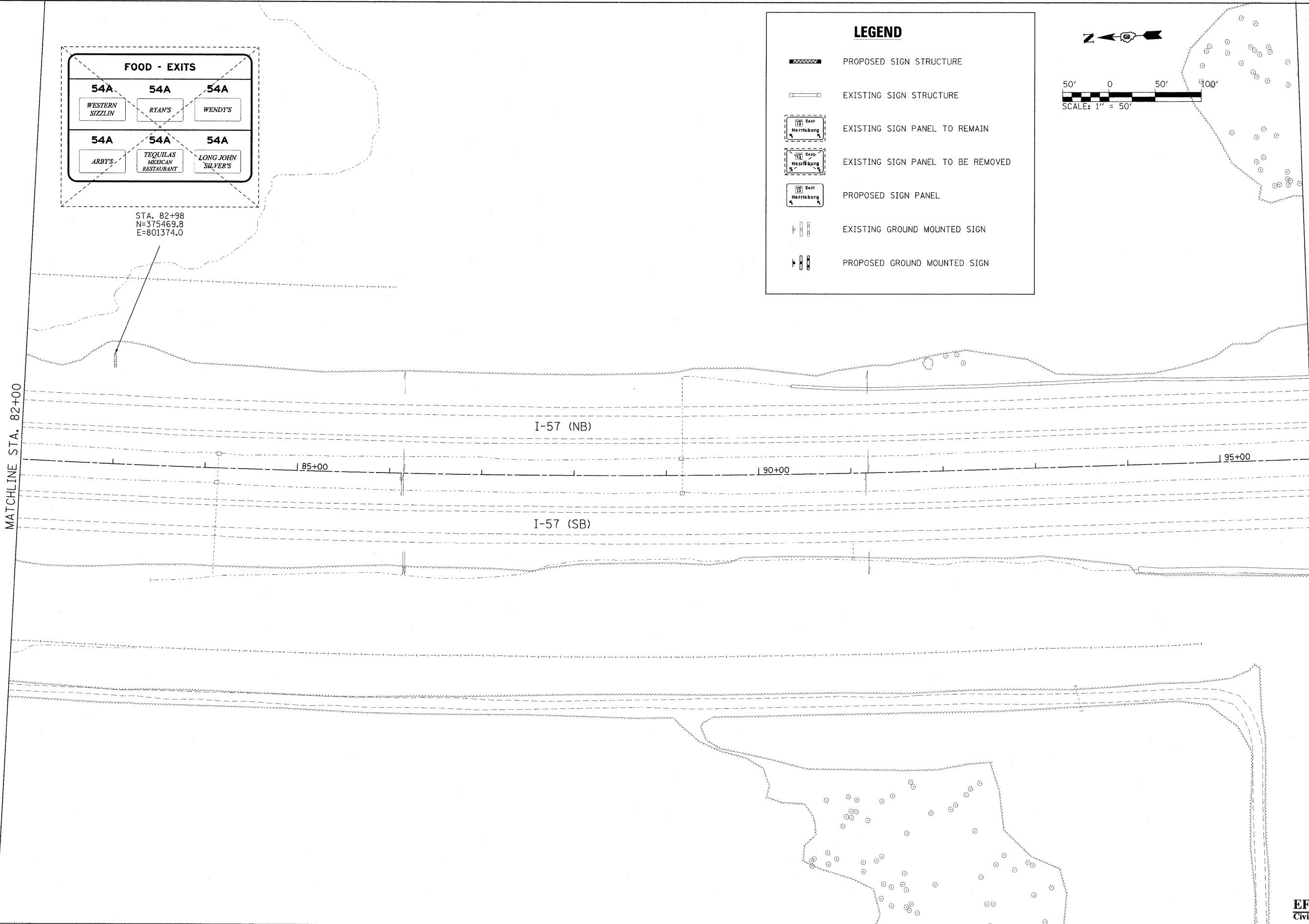

FILE NAME = ...D978182-sht-sign828-157.dgn	USER NAME = Brad Downen	DESIGNED - LE/JD	REVISED -	STATE OF ILLINOIS DEPARTMENT OF TRANSPORTATION	SIGN PLAN INTERSTATE 57		F.A. RTE.	SECTION	COUNTY	TOTAL SHEETS	SHEET NO.
	PLOT SCALE = 50.0000' / IN.	CHECKED - SD	REVISED -		* (X1-6-2)HBK-2, HB-1,2; (IX-1)R-1	WILLIAMSON	968	440			
	PLOT DATE = 10/10/2011	DATE = 10/07/11	REVISED -		* F.A.I. 57 AND F.A.P. 331	CONTRACT NO. 78182					
				SCALE: 1" = 50' SHEET NO. 28 OF 43 SHEETS STA. 82+00 TO STA. 96+00		ILLINOIS FED. AID PROJECT					

EFK Moen, LLC
Civil Engineering Design