

FAS ROUTE NO.	COUNTY	SECTION	CONTRACT	CO. HWY. NO.	SHEET NO.	TOTAL SHEETS
372	MARSHALL	05-00087-00-RS	89401	6	4	4
372	STARK	05-00152-00-RS	89401	2	4	4

BEGINNING INTERSECTION DETAIL
LT. & RT. STA. 625+72.5

Marshall County

Total Area 438.1 SQ YDS
Thickness Required 3" COMP.
▲ Incidental **HMA** Surfacing Required 73.6 TON
* **HMA** Surface Removal-Butt Joint 180.55 SQ YDS

42600982 Hot Mix Asphalt SURFACE REMOVAL - BUTT JOINT

LOCATION
* STA. 623+80
* RT STA. 625+72.5
* LT STA. 625+72.5

WIDTH QUANTITY REQUIRED
VAR 58.33 SQ YD
VAR 61.11 SQ YD
VAR 61.11 SQ YD

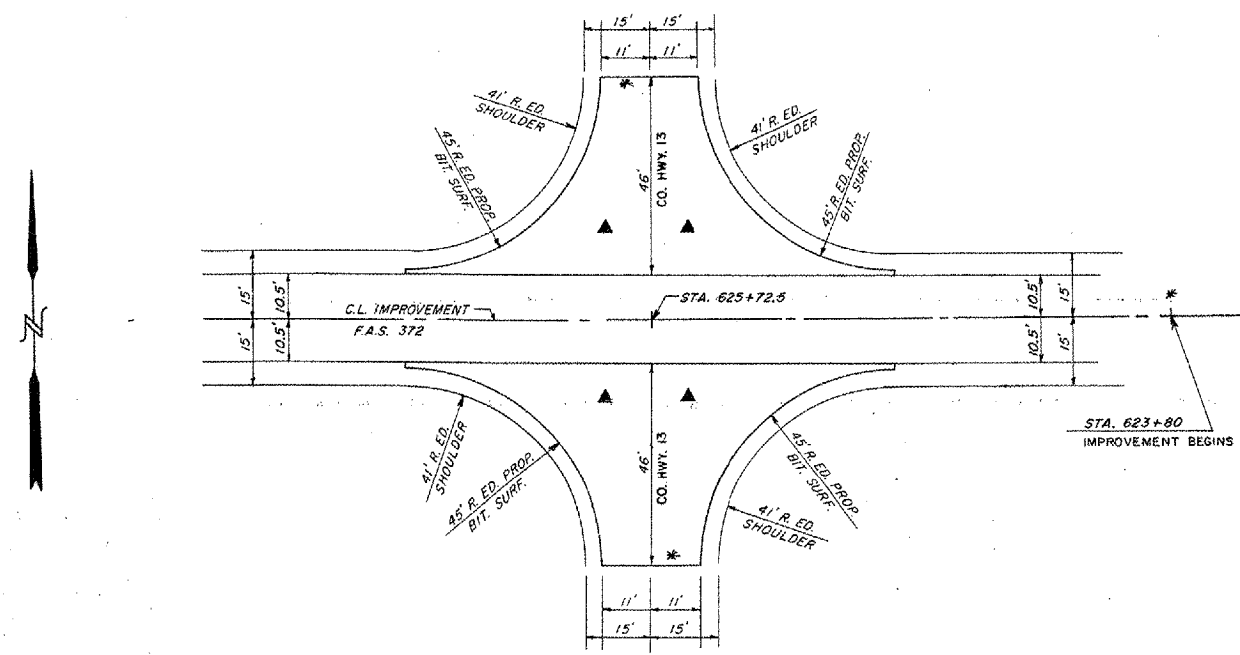

LOCATION MAP SHOWING REQUIRED BARRICADE AND SIGN PLACEMENT

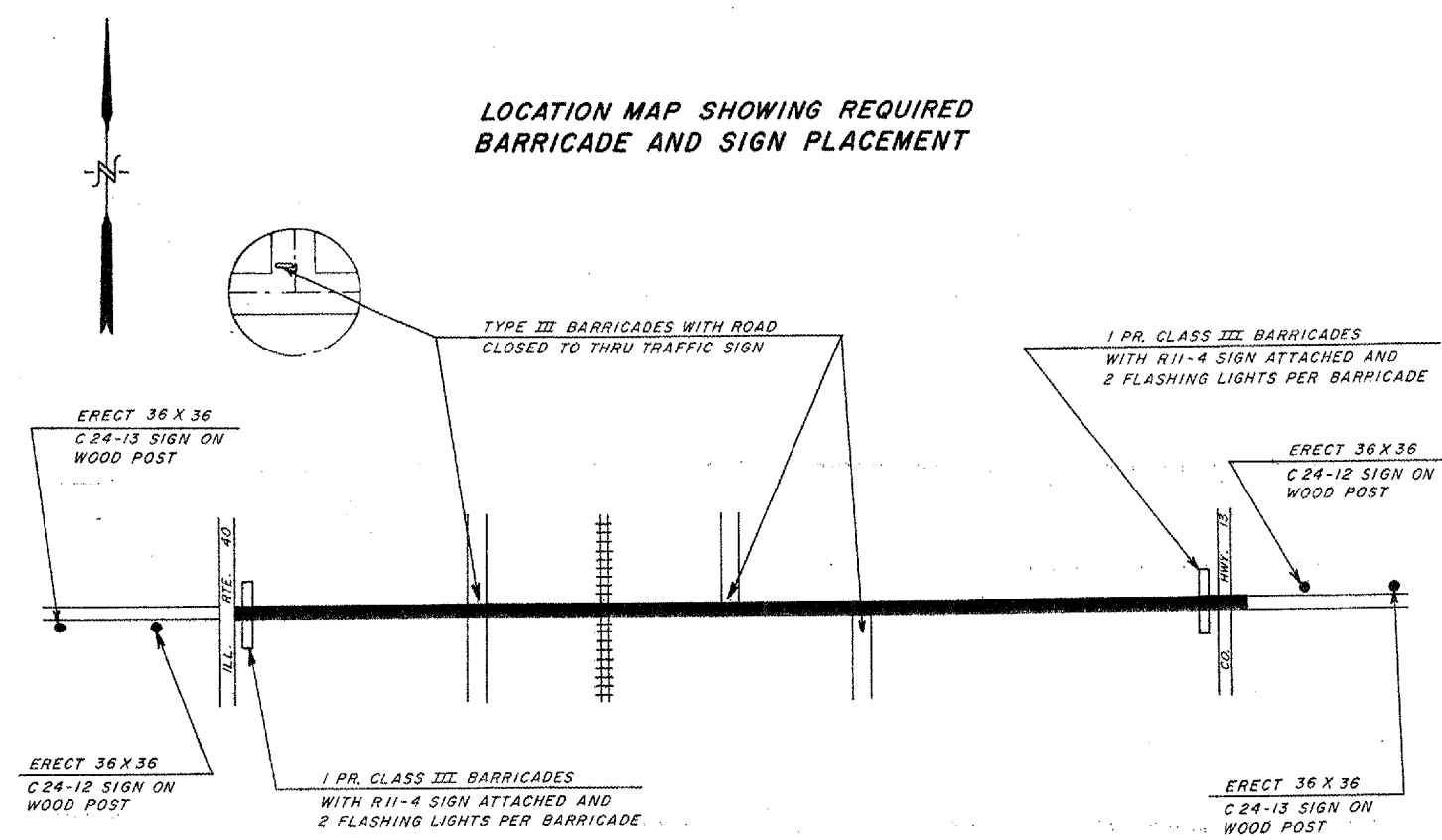

NOTE: REFER TO STANDARD 702001 FOR ERECTION OF SIGNS AND PLACEMENT OF TYPE III BARRICADES. TYPE A LOW INTENSITY LIGHTS ARE REQUIRED ABOVE THE FIRST WARNING SIGN FROM EACH DIRECTION AS PER STANDARD BLR 22-4

NOTE: CONTRACTOR SHALL PLACE TEMPORARY SIGNS ON STATE ROUTE 40 WHENEVER WORKING ON INTERSECTION

SIGN LEGEND

C24-12	ROAD CLOSED 500 FT.
C24-13	ROAD CLOSED 1000 FT.
R11-4	ROAD CLOSED TO THRU TRAFFIC (WHITE)

ENDING INTERSECTION DETAIL
STA. 806+70

Stark County

Total Area 592.5 SQ YDS
Thickness Required 3" COMP.
▲ Incidental **HMA** Surfacing Required 99.5 TON
* **HMA** Surface Removal-Butt Joint 183.3 SQ YDS

NOTE: ANY BASE WIDENING REQUIRED SHALL BE DONE BY STARK COUNTY HIGHWAY FORCES

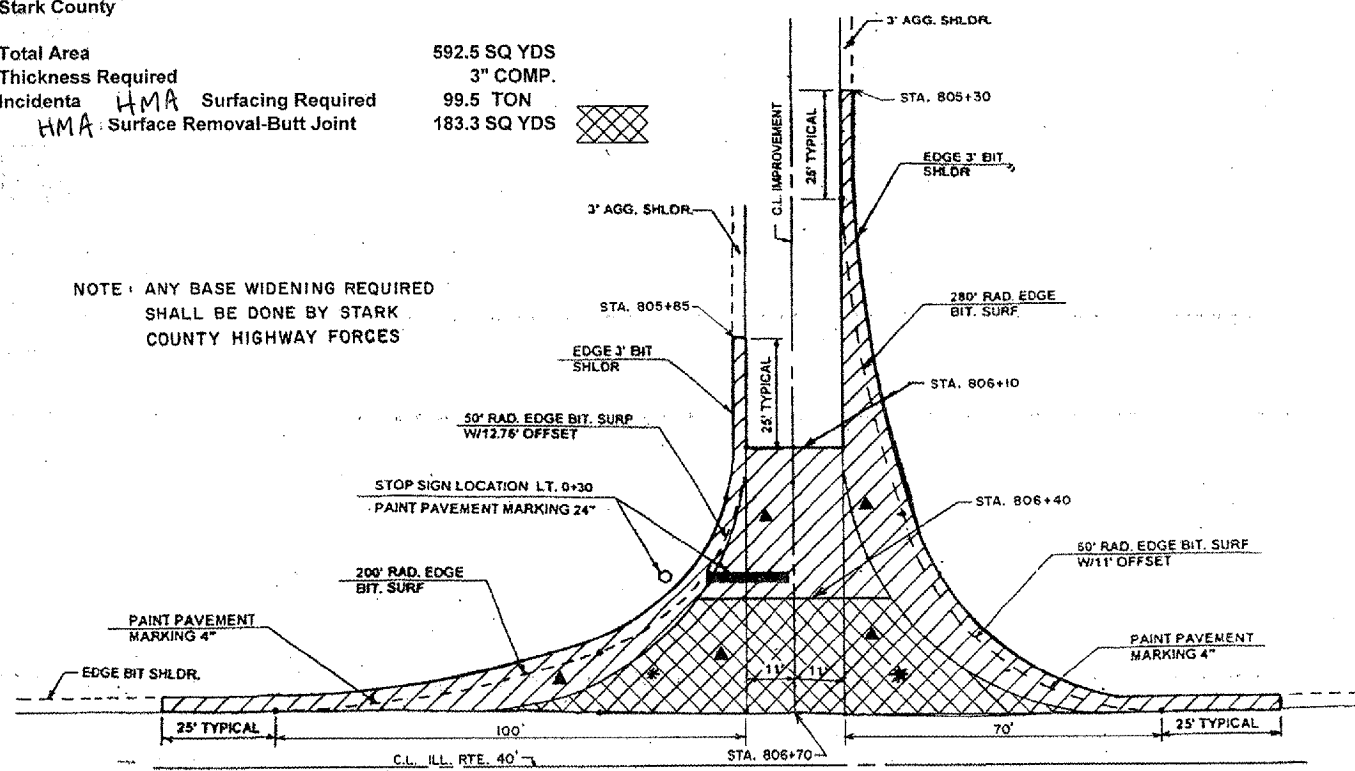

SIDE ROADS

* INCIDENTAL **HMA** SURFACING REQUIRED

STATION	SQ YDS	TONS MIXT. REQUIRED	TONS MIXT. REQUIRED
LT 679+32.5	169.7	28.50	
RT 705+50.7	169.7	28.50	
RT 753+78.5	169.7		28.50
LT 753+78.5	169.7		28.50
	678.8	57.0 TON	57.0 TON

(USE 114 TON)

* CONSISTS OF 3" Hot Mix Asphalt SURFACE COURSE. MIX "C" N50

