

F.A.P. RTE.	SECTION	COUNTY	TOTAL SHEETS	SHEET NO.
789	54BR-1	MADISON	62	19
STA. 274+00.00 TO STA. 290+50.00				
FED. ROAD DIST. NO. 1		ILLINOIS	FED. AID PROJECT	

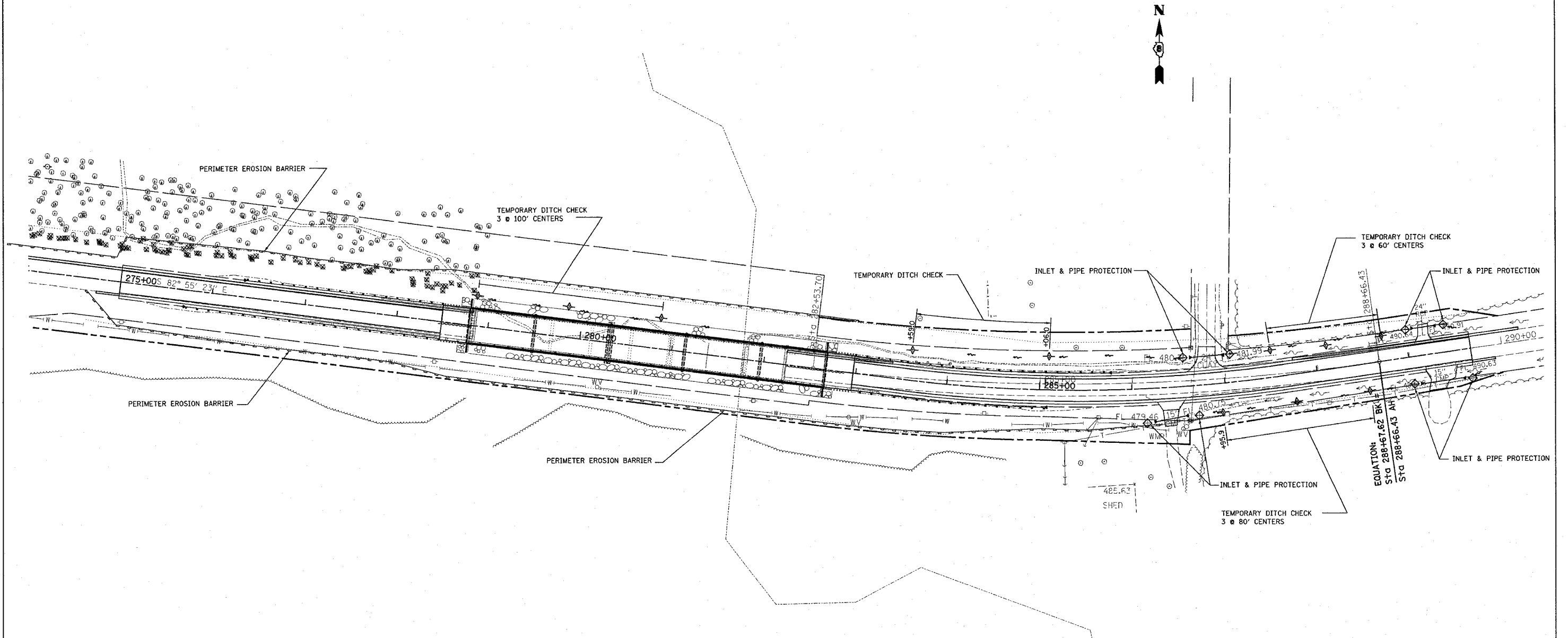

REVISIONS		NAME	DATE
NO.	DESCRIPTION		

ILLINOIS DEPARTMENT OF TRANSPORTATION
STORM WATER POLLUTION PREVENTION PLAN
 FAP ROUTE 789
 SECTION 54BR-1
 MADISON COUNTY

SCALE: VERT. _____
 HORIZ. _____

DATE _____ DRAWN BY _____
 CHECKED BY _____

PLOT DATE = 10/18/2006
 FILE NAME = c:\proj\p06\789\54br1\1485\plan\plan181485.dgn
 PLOT SCALE = 50.000000 / 1 IN.
 REFERENCE = #REF#