

F.A.P. RTE.	SECTION	COUNTY	TOTAL SHEETS	SHEET NO.
607	(124)TS-1	LASALLE	3	1

STATE OF ILLINOIS
DEPARTMENT OF TRANSPORTATION
DIVISION OF HIGHWAYS

**PROPOSED
HIGHWAY PLANS**

FAP ROUTE 607 (US 52)
SECTION (124)TS-1

LASALLE COUNTY

C - 93 - 014 - 07

INSTALL 2 YELLOW ADVANCE FLASHERS ON
US RTE 52 AT THE INTERSECTION OF HOXSEY ROAD (CH 2)

INDEX OF SHEETS

- 1 COVER SHEET
- 2 GENERAL NOTES AND SUMMARY OF QUANTITIES
- 3 FLASHER PLANS

STANDARDS

- 000001-04 STANDARD SYMBOLS, ABBREVIATIONS AND PATTERNS
- 701001-01 OFF-ROAD OPERATIONS 2L, 2W, MORE THAN 4.5 m (15') AWAY
- 701006-02 OFF-ROAD OPERATIONS 2L, 2W, 4.5 m (15') TO 600 mm (24") FROM PAVEMENT EDGE
- 701201-02 LANE CLOSURE, 2L, 2W, DAY ONLY, FOR SPEEDS ≥ 45 MPH
- 701301-02 LANE CLOSURE, 2L, 2W, SHORT TIME OPERATIONS
- 702001-06 TRAFFIC CONTROL DEVICES
- 814001-01 HANDHOLES
- 880001 SPAN WIRE MOUNTED SIGNALS AND FLASHING BEACON INSTALLATION



FUNCTIONAL CLASSIFICATION
RURAL - OTHER PRINCIPAL ARTERIAL
FAP 607 (US ROUTE 52)
2005 ADT = 2100
P.V. = 79.3% M.U. = 4.8% S.U. = 7.1%

PROJECT LOCATION

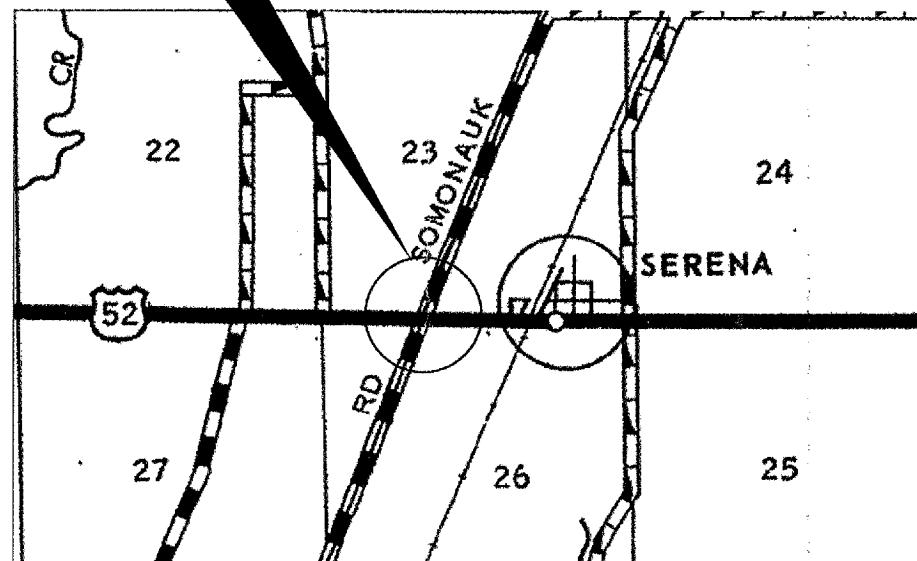

LOCATION MAP
NOT TO SCALE
SPOT IMPROVEMENT

MICROFILMED _____
REEL NUMBER _____
AWARDED _____
RESIDENT ENGINEER _____
AS BUILT CHANGES WERE MADE
ON THE FOLLOWING SHEETS _____

J.U.L.I.E.
JOINT UTILITY LOCATION INFORMATION FOR EXCAVATION
1-800-892-0123

DISTRICT 3 NO. (815) 434-6131

PROJECT ENGINEER: TOM HUFNAGEL
UNIT CHIEF: DAN DEVINE

CONTRACT NO. 66693

STATE OF ILLINOIS
DEPARTMENT OF TRANSPORTATION
DIVISION OF HIGHWAYS

SUBMITTED *October 26, 1999*
Don O'Keefe, P.E.
DEPUTY DIRECTOR OF HIGHWAYS, REGION ENGINEER

December 8, 2006
Eric E. Horn, P.E.
ENGINEER OF DESIGN AND ENVIRONMENT

December 8, 2006
Milton R. Sees, P.E.
DIRECTOR OF HIGHWAYS, CHIEF ENGINEER

PRINTED BY THE AUTHORITY
OF THE STATE OF ILLINOIS