

01-18-2019 LETTING ITEM 011

FOR INDEX OF SHEETS, SEE SHEET NO. 2
FOR STATE STANDARDS, SEE SHEET NO. 2

STATE OF ILLINOIS
DEPARTMENT OF TRANSPORTATION
DIVISION OF HIGHWAYS
**PROPOSED
HIGHWAY PLANS**

FAS ROUTE 1177 (IL 251)
SECTION 110CR
LEE COUNTY
C-92-015-19

F.A.S. RTE.	SECTION	COUNTY	TOTAL SHEETS	SHEET NO.
1177	110CR	LEE	6	1
ILLINOIS			CONTRACT NO. 64N24	

D-92-070-18



LOCATION OF SECTION INDICATED THIS -

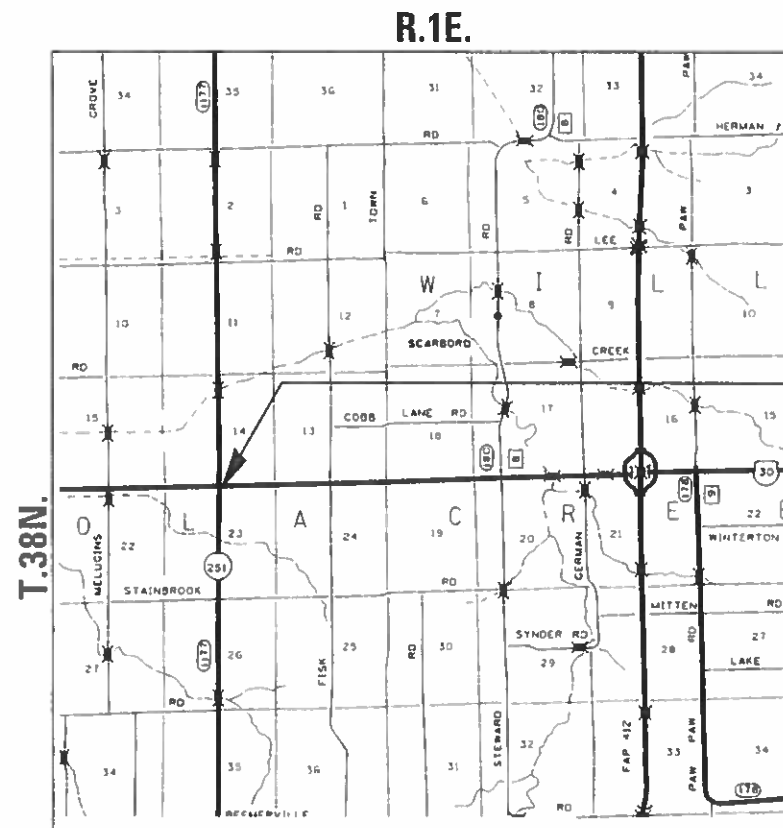

IL 251
PROJECT LOCATION

J.U.L.I.E.
JOINT UTILITY LOCATION INFORMATION FOR EXCAVATION
1-800-892-0123
OR 811

SQUAD LEADER: LANCE NICKLAUS 815-284-5407
PROJECT ENGINEER: SCOTT KULLERSTRAND

CONTRACT NO. 64N24

FAS 1177 (IL 251) SECTION 110CR LEE COUNTY

STATE OF ILLINOIS
DEPARTMENT OF TRANSPORTATION
DIVISION OF HIGHWAYS

SUBMITTED 10-19 2018
[Signature]
REGION ENGINEER

Dec 7 2018
[Signature]
ENGINEER OF DESIGN AND ENVIRONMENT

Dec 7 2018
[Signature]
DIRECTOR OF HIGHWAYS, PROJECT IMPLEMENTATION

PRINTED BY THE AUTHORITY
OF THE STATE OF ILLINOIS

INDEX

1	Cover Sheet
2	Index of Sheets / State Standards
3	Summary of Quantities
4	General Notes
5-6	Plan Sheet

FAS 1177 (IL 251)
SECTION 110CR
LEE COUNTY
Sheet 2 of 5
Contract #64N24

STATE STANDARDS

442201-03	CLASS C AND D PATCHES
701006-05	OFF-ROAD OPERATIONS, 2L, 2W, 15' (4.5m) TO 24" (600mm) FROM PAVEMENT EDGE
701201-05	LANE CLOSURE, 2L, 2W, DAY ONLY, FOR SPEEDS \geq 45 MPH
701901-08	TRAFFIC CONTROL DEVICES
720011-01	METAL POST FOR SIGNS, MARKERS AND DELINEATORS
728001-01	TELESCOPING STEEL SIGN SUPPORT
729001-01	APPLICATIONS OF TYPES A AND B METAL POST (FOR SIGNS & MARKERS)

SUMMARY OF QUANTITIES

FAS 1177 (IL 251)
SECTION 110CR
LEE COUNTY
CONTRACT #64N24
SHEET 3 OF 6

100% State
0004

CODE NO.	ITEM	UNIT	TOTAL QUANTITY
20200100	EARTH EXCAVATION	CU YD	224
35101400	AGGREGATE BASE COURSE, TYPE B	TON	152
44201796	CLASS D PATCHES, TYPE IV, 12 INCH	SQ YD	270
542A0229	PIPE CULVERTS, CLASS A, TYPE 1, 24"	FOOT	230
67100100	MOBILIZATION	L SUM	1
70100450	TRAFFIC CONTROL AND PROTECTION, STANDARD 701201	L SUM	1
70103815	TRAFFIC CONTROL SURVEILLANCE	CAL DAY	7

REV. 11/13/18

*SPECIALTY ITEM

GENERAL NOTES

All Borrow/Waste/Use sites must be approved by the Department prior to removing any material from the project or initiating any earthmoving activities, including temporary stockpiling outside the limits of construction.

The final top 4 inches of soil in any right-of-way area disturbed by the Contractor must be capable of supporting vegetation. The soil must be from the A horizon (zero to 2' deep) of soil profiles of local soils. The cost of this work shall be included in the unit prices bid and no additional compensation will be allowed.

The Contractor shall seed all disturbed areas within the project limits. Seeding Class 4 or 2A shall be used, except in front of properties where the grass will be mowed, then use Seeding, Class 1A. Class 2A shall be used on front slopes and ditch bottoms. Class 4 shall be used behind Type A gutter, on all backslopes and areas behind the backslope, and beyond the toe of front slope on fill sections without ditches. This work will be included in the contract unit price per Cubic Yard for EARTH EXCAVATION.

Fertilizer shall be applied to all disturbed areas and incorporated into the seedbed prior to seeding or placement of sod at the rate specified in Sections 250 and 252 of the Standard Specifications. This work shall be included in the cost of EARTH EXCAVATION.

Mulch Method II shall be applied over all seeded areas. This shall be included in the cost of the EARTH EXCAVATION.

Placement and compaction of the backfill for proposed across road culverts and existing across road culverts that are removed shall conform to Article 502.10 of the Standard Specifications, except that the material shall conform to Article 208.02 of the Standard Specifications, and shall be compacted to a minimum of 95% of the standard laboratory density. Any material conforming to the requirements of Article 1003.04 or 1004.05 for trench backfill which has been excavated from the trenches shall be used for backfilling the trenches. The entire excavation, within 2 feet outside of each shoulder, shall be backfilled with trench backfill material to the bottom of the proposed subgrade. Impervious material shall be used on the outer 3 feet of each end of the culvert. This trench backfill material will not be measured for payment, but shall be included in unit price item of the work for which it is required.

Cost of removal and disposal of material from the temporary patch shall be included in AGGREGATE BASE COURSE, TYPE B.

The following Mixture Requirements are applicable for this project:

Location(s):	PATCH	PATCH
Mixture Use(s):	BOTTOM PATCH	PATCH SURFACE
PG:	PG 64-22	PG 64-22
Design Air Voids:	3.0@N50	3.0@N50
Mixture Composition (Mixture Gradation):	IL 19.0	IL 9.5
Friction Aggregate:	N/A	C
Mixture Weight:		112 LBS/SY/IN
Quality Management Program:	QC/QA	QC/QA
Sublot Size:		
Number of Roller Passes ¹⁾ :		

1) When a number of roller passes is specified, the Contractor may opt to use intelligent compaction in lieu of density testing under the Quality Control for Performance (QCP) program.

Culvert & bridge flows must be maintained throughout the project. Normal flow shall be allowed to pass at the rate it enters the jobsite. High flows shall be allowed to pass without causing damage to upstream properties.

The Contractor shall be responsible for locating and protecting utility property during construction operations as outlined in Article 107.39 of the Standard Specifications. A minimum of 48 hours advance notice is required for non-emergency work. The JULIE number is 800-892-0123. The following listed utilities located within the project limits or immediately adjacent to the project construction limits are members of JULIE:

Aldridge Electric	(815)467-0428
Frontier (North)	(815)544-6171
Commonwealth Edison Co.	(630)985-4043

IDOT is not a member of JULIE. If you are near any overhead lighting, intersection lighting or traffic signals, contact the IDOT Traffic Office at 815/284-5469 at least 48 hours prior to work.

The existing headwall and manhole will need to be modified in order to accommodate the proposed concrete culvert. After the installation of the concrete culvert, grout shall be used to seal around the pipe. The modification and sealing of the headwall and grouting shall be included in the cost of the PIPE CULVERT of the class and type specified.

The culvert shall be installed under traffic controlled by flaggers. At the end of each days work all lanes of traffic shall be open. A temporary patch consisting of Aggregate Base Course, Type B, or other material as approved by the Engineer, shall be placed flush with the existing roadway surface. After completion of the culvert installation the temporary patch shall be removed and replaced with the permanent patch within 5 calendar days.

FILE NAME = 64N24GN.DOCX	USER NAME =	DESIGNED - Engineering Systems	REVISED -	STATE OF ILLINOIS DEPARTMENT OF TRANSPORTATION	GENERAL NOTES	ROUTE	SECTION	COUNTY	TOTAL SHEETS	SHEET NO.	
	PLOT SCALE =	CHECKED -	REVISED -			1177	110 CR	Lee	6	4	
	PLOT DATE = 10/9/2018 1:31 PM	DATE = 10/1/2018 3:53 PM	REVISED -			CONTRACT NO. 64N24					
				SCALE:	SHEET NO.	OF	SHEETS	STA.	TO STA.	ILLINOIS	FED. AID PROJECT

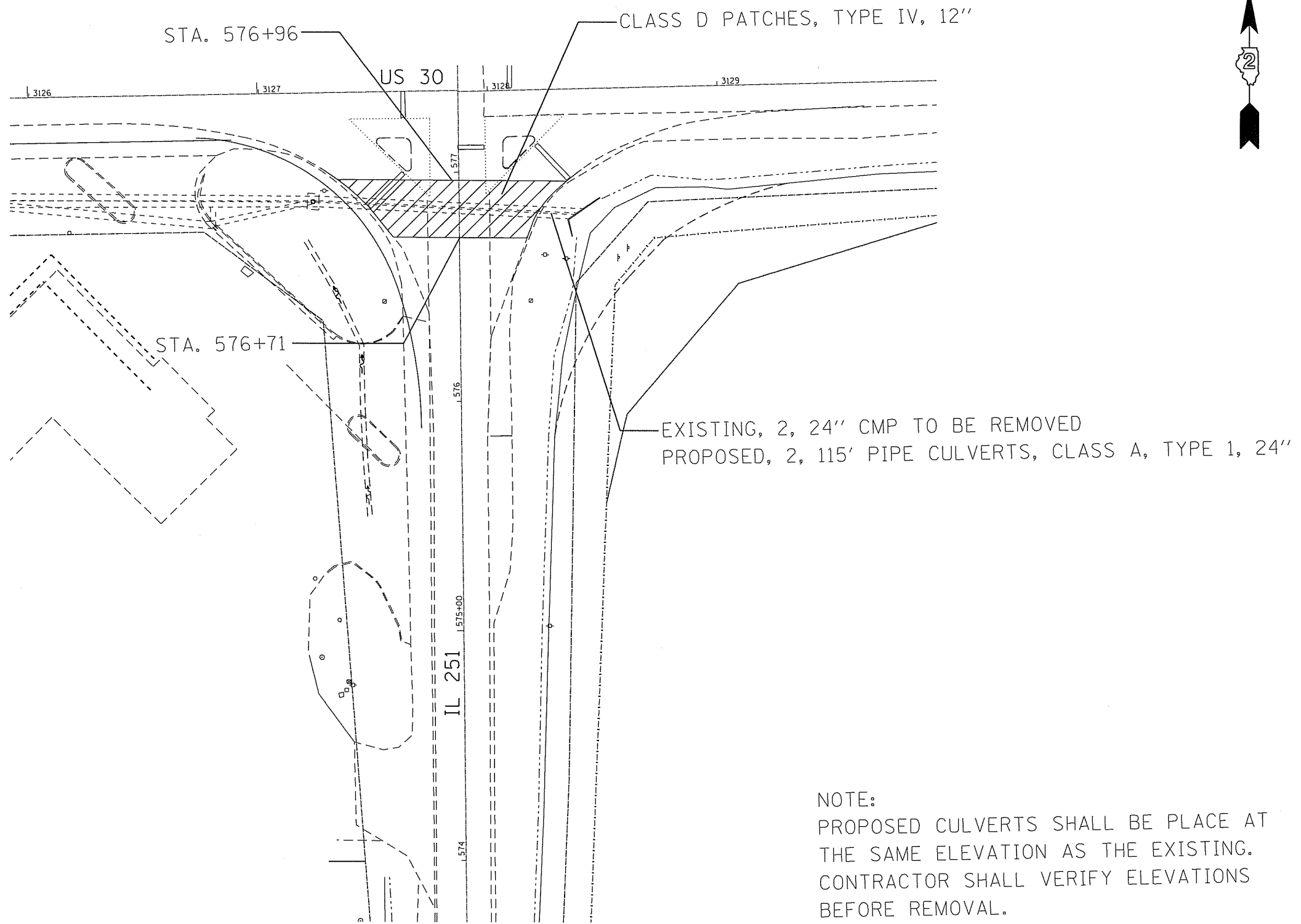

EXISTING, 2, 24" CMP TO BE REMOVED
 PROPOSED, 2, 115' PIPE CULVERTS, CLASS A, TYPE 1, 24"

NOTE:
 PROPOSED CULVERTS SHALL BE PLACE AT
 THE SAME ELEVATION AS THE EXISTING.
 CONTRACTOR SHALL VERIFY ELEVATIONS
 BEFORE REMOVAL.

PLOT DATE = Oct-09-2018 01:22:24 PM

REVISED - ____	REGION 2 / DISTRICT 2			F.A.S. RTE.	SECTION	COUNTY	TOTAL SHEETS	SHEET NO.
REVISED - ____				1177	110CR	LEE	6	5
REVISED - ____				CONTRACT NO. 64N24				
REVISED - ____				SCALE: 51.4981' / 1" =	SHEET NO. ____ OF ____ SHEETS	STA. _____ TO STA. _____	FED. ROAD DIST. NO. _	ILLINOIS

CULVERT DETAIL

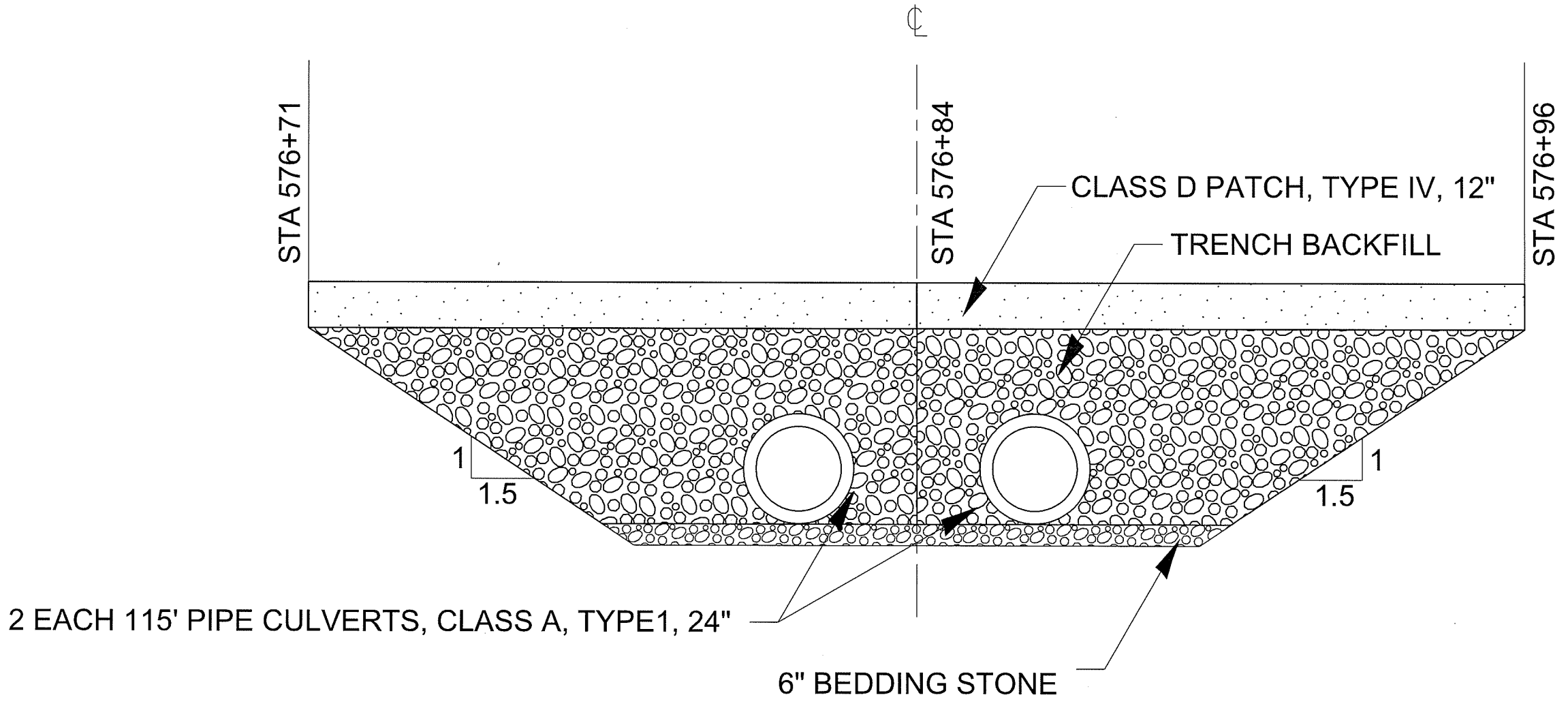

NOTE:
 TRENCH BACKFILL AND
 BEDDING STONE INCLUDE
 IN THE COST OF PIPE CULVERTS
 OF THE CLASS AND TYPE SPECIFIED.

FILE NAME =	USER NAME = nicklausle	DESIGNED -	REVISED -	STATE OF ILLINOIS DEPARTMENT OF TRANSPORTATION	CULVERT DETAIL			F.A.S RTE.	SECTION	COUNTY	TOTAL SHEETS	SHEET NO.
G:\NPL\Nicklaus\FY 19 jobs\David AVIL 251	cedd\0206512-shr-culvert_detail.dgn	DRAWN -	REVISED -		1177	110CR	LEE	6	6			
Default	PLOT SCALE = 3.0899' / in.	CHECKED -	REVISED -		SCALE: _____ SHEET ____ OF ____ SHEETS STA. _____ TO STA. _____			CONTRACT NO. 64N24				
	PLOT DATE = Oct-09-2018 01:38:03 PM	DATE -	REVISED -		ILLINOIS FED. AID PROJECT							