

STATE OF ILLINOIS  
DEPARTMENT OF TRANSPORTATION

\* 13 + 2 = 15 TOTAL SHEETS

F.A.P. RITE	SECTION	COUNTY	TOTAL SHEETS	SHEET NO.
607	27-B-1	WILL	13	1
		ILLINOIS	CONTRACT NO. 60M99	

FOR INDEX OF SHEETS, SEE SHEET NO. 2

IMPROVEMENT LOCATED IN  
THE CITY OF JOLIET

DESIGN DESIGNATION

OTHER PRINCIPAL ARTERIAL  
ADT 16,100 (2017)  
SPEED LIMIT 30 MPH

PROPOSED  
HIGHWAY PLANS

FAP ROUTE 607 /US ROUTE 30 /CASS STREET  
OVER SPRING CREEK (0.4 MILE EAST OF IL 171)

SECTION: 27-B-1

PROJECT: NHPP-6KEQ(724)

BRIDGE DECK REPAIR /BRIDGE DECK OVERLAY  
WILL COUNTY

C-91-205-11

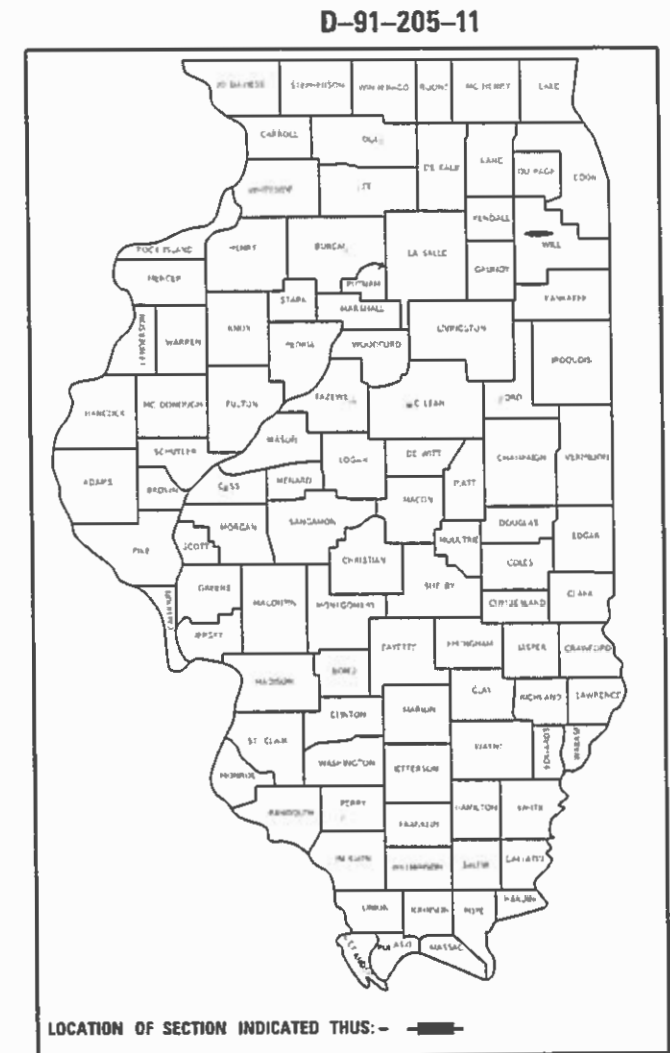

IMPROVEMENT LOCATION  
US 30 /CASS STREET  
OVER SPRING CREEK  
STRUCTURE NO: 099-0263

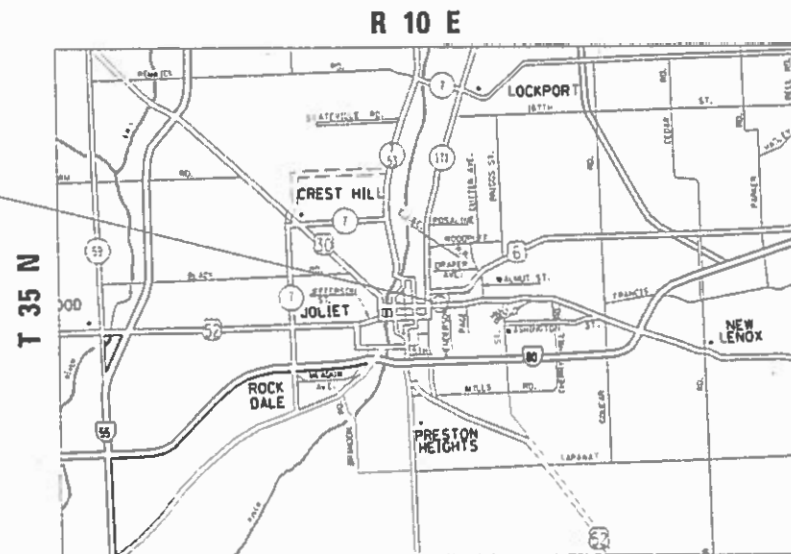

IGROSS AND NET LENGTH = 44 FT. = 0.008 MILE

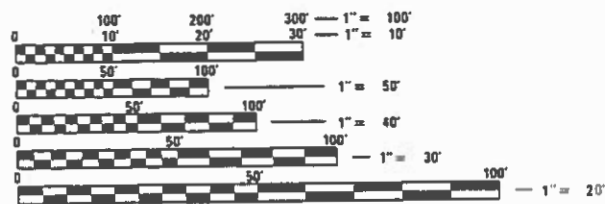

FULL SIZE PLANS HAVE BEEN PREPARED USING STANDARD  
ENGINEERING SCALES. REDUCED SIZED PLANS WILL NOT  
CONFORM TO STANDARD SCALES. IN MAKING MEASUREMENTS  
ON REDUCED PLANS, THE ABOVE SCALES MAY BE USED.

J.U.L.I.E.  
JOINT UTILITY LOCATION INFORMATION FOR EXCAVATION  
1-800-892-0123  
OR 811

PROJECT ENGINEER: ALAIN MIDY (847) 221-3056  
PROJECT MANAGER: FAWAD AQUEEL (847) 705-4247

CONTRACT NO. 60M99

STATE OF ILLINOIS  
DEPARTMENT OF TRANSPORTATION

SUBMITTED 10-11 20 18

Art J. Quillen  
REGIONAL ENGINEER

Dec 7 20 18  
Scott A. Elk  
ENGINEER OF DESIGN AND ENVIRONMENT

Dec 11 20 18  
Paul J. [Signature]  
DIRECTOR OF HIGHWAYS PROJECT IMPLEMENTATION

PRINTED BY THE AUTHORITY  
OF THE STATE OF ILLINOIS

**INDEX OF SHEETS**

- 1 Title Sheet
- 2 Index of Sheets, General Notes and Highway Standards
- 3 Summary of Quantities
- 4-5 Maintenance of Traffic
- 5A Roadway Plan
- 6-9 Structure Plans S1-S4
- 10 TC10 - Traffic Control & Protection for Side Roads, Intersections and Driveways
- 11 TC11 - Typical Applications Raised Reflective Pavement Markers (Snow-Plow Resistant)
- 12 TC13 - District One Typical Pavement Markings
- 13 TC22 - Arterial Road Information Sign
- 13A TC26 - Driveway Entrance Signing

**INDEX OF HIGHWAY STANDARDS**

Standard No.	Description
420001-09	Pavement Joints
515001-03	Name Plate For Bridges
701301-04	Lane Closure, 2L, 2W, Short Time Operations
701306-04	Lane Closure, 2L, 2W, Slow Moving Operations, Day Only
701611-01	Urban Half Road Closure, Multilane, 2W with Mountable Median
701801-06	Lane Closure, Multilane 1W or 2W, Crosswalk or Sidewalk Closure
701901-08	Traffic Control Devices
780001-05	Typical Pavement Markings

**GENERAL NOTES**

1. These plans have been prepared from notes received from IDOT Field Maintenance Engineers.
2. 10 ft (3 m) transitions shall be used to match proposed items of work to existing items in the field, unless otherwise shown. The transitions shall be paid for at the contract unit price for the proposed item of work specified.
3. Where artificial lighting is utilized in night operations, the Contractor shall exercise the utmost precautions in preventing adverse visibility to the motoring public and adjoining residential areas.
4. For stabilization, all Type III barricades shall require a minimum of four (4) sandbags per barricade.
5. The Resident Engineer must contact the Traffic Control Supervisor at (847) 705-4470 at least 72 hours prior to installation of the temporary control devices.
6. The Resident Engineer shall contact the Area Traffic Field Engineer, Eric Campos at (815) 485-6475 / eric.campos@illinois.gov at least two (2) weeks prior to the placement of permanent pavement markings.
7. All pavement markings and raised reflectors affected by the bridge repairs shall be replaced. Nominal quantities have been included in the contract for this work according to TC-13 and TC-11)
8. The Contractor will not be allowed to set up a yard or field office on State property without written permission from the Department.
9. Do not scale these plans for construction purposes.
10. Plan dimensions and details relative to existing plans are subject to routine variations. The Contractor shall field verify existing dimensions and details affecting new construction and make necessary approved adjustments prior to construction or ordering of materials. Such variations shall not be cause for additional compensation for a change in scope of the work. However, the Contractor will be paid for the quantity actually furnished based upon the unit price bid for the work.
11. During construction operations, loose material deposits that obstruct the flow of water in draining the area shall be removed before the end of each work day. At the conclusion of construction operations, all drainage structures (new and existing) shall be free from all dirt and debris. This work will not be paid for separately but shall be considered incidental to the contract.
12. All raised reflective pavement markers (bridge) shall be low profile.
13. Before beginning any work, the Contractor shall retain and record for future reference, all existing pavement marking lines, symbols and letters (and raised reflective markers) in order that these locations can be re-established for striping. Exact locations of all pavement markings and raised reflective pavement markers shall be as directed by the Engineer.
14. The plans do not represent a complete depiction of all utilities that may be impacted by the proposed work. The Contractor shall conduct his or her own investigation to determine the ownership of impacted utilities. The Contractor shall coordinate with the utility owners and may be required to provide temporary support, adjust, relocate or remove utilities that are impacted by the proposed improvement. This work shall be considered incidental to the project.
15. Contractor shall maintain one sidewalk throughout the duration of the project.

MODEL: Default  
 FILE NAME: p:\IL\08\EBID\NTEC\Illinois.gov\PWIDOT\Documents\DOT Offices\District 1\Projects\0120511\CADD\Drawings\0120511-shr-cover.dgn

REV. - MS

USER NAME = mullerta	DESIGNED -	REVISED -	<b>STATE OF ILLINOIS DEPARTMENT OF TRANSPORTATION</b>	SCALE:	SHEET	OF	SHEETS	STA.	TO STA.	F.A.P. RTE.	SECTION	COUNTY	TOTAL SHEETS	SHEET NO.
	DRAWN -	REVISED -								607	27-B-1	WILL	13	2
PLOT SCALE = 100.0000' / in.	CHECKED -	REVISED -								CONTRACT NO.				
PLOT DATE = 10/16/2018	DATE -	REVISED -								ILLINOIS FED. AID PROJECT				

SUMMARY OF QUANTITIES			URBAN TOTAL QUANTITIES	CONSTRUCTION TYPE CODE					
CODE NO	ITEM	UNIT		80% FED 20% STATE 0013					
50102400	CONCRETE REMOVAL	CU YD	1	1					
67000400	ENGINEER'S FIELD OFFICE, TYPE A	CAL MO	6	6					
67100100	MOBILIZATION	L SUM	1	1					
70300904	PAVEMENT MARKING TAPE, TYPE IV 4"	FOOT	4524	4524					
* 78000200	THERMOPLASTIC PAVEMENT MARKING - LINE 4"	FOOT	2000	2000					
* 78008210	POLYUREA PAVEMENT MARKING TYPE I - LINE 4"	FOOT	625	625					
* 78100300	REPLACEMENT REFLECTOR	EACH	92	92					
X0327980	PAVEMENT MARKING REMOVAL - WATER BLASTING	SO FT	875	875					
X7010216	TRAFFIC CONTROL AND PROTECTION, (SPECIAL)	L SUM	1	1					
X7030005	TEMPORARY PAVEMENT MARKING REMOVAL	SO FT	1196	1196					
Z0001800	APPROACH SLAB REPAIR (PARTIAL DEPTH)	SO YD	7.5	7.5					
Z0012102	CONCRETE BRIDGE DECK SCARIFICATION 3/8"	SO YD	216	216					
Z0012193	BRIDGE DECK THIN POLYMER OVERLAY 3/8"	SO YD	216	216					
Z0016200	DECK SLAB REPAIR (PARTIAL)	SO YD	11.3	11.3					
Z0030850	TEMPORARY INFORMATION SIGNING	SO FT	52	52					

SUMMARY OF QUANTITIES			URBAN TOTAL QUANTITIES	CONSTRUCTION TYPE CODE					
CODE NO	ITEM	UNIT		80% FED 20% STATE 0013					
20041895	POLYMER CONCRETE	CU FT	5.5	5.5					
* SPECIALTY ITEMS									

FILE NAME =	USER NAME = mullerto	DESIGNED -	REVISED -
pw:\NLOB\EBID\INT\EG\Illinois.gov\FWIDOT\Documents\DOT	Offices\District N\Projects\DI205\IN\CADD\Design\DI205-	DRAWN -	REVISED -
	PLOT SCALE = 100,0000' / 1in	CHECKED -	REVISED -
	PLOT DATE = 10/16/2018	DATE -	REVISED -

**STATE OF ILLINOIS  
DEPARTMENT OF TRANSPORTATION**

<b>SUMMARY OF QUANTITIES</b>			
SCALE:	SHEET NO.	OF SHEETS	STA. TO STA.

F.A.P. RTE.	SECTION	COUNTY	TOTAL SHEETS	SHEET NO.
607	27-B-1	WILL	13	3
CONTRACT NO. 60M99				
FED. ROAD DIST. NO. 1   ILLINOIS FED. AID PROJECT				

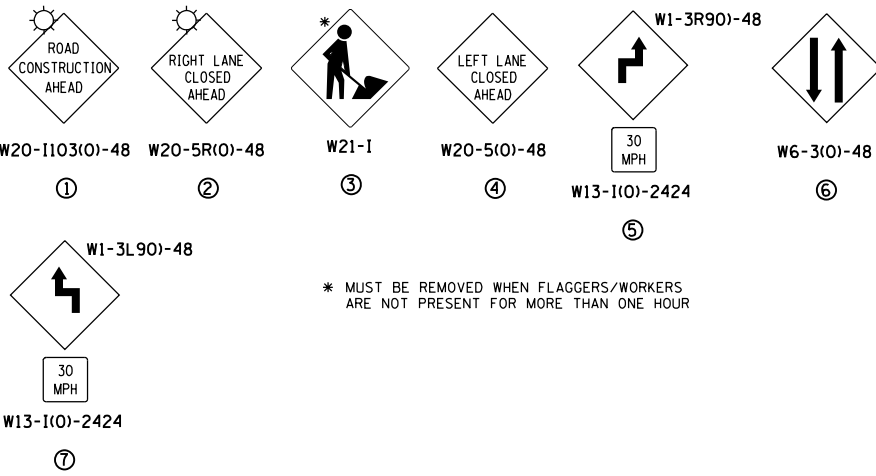

\* MUST BE REMOVED WHEN FLAGGERS/WORKERS ARE NOT PRESENT FOR MORE THAN ONE HOUR

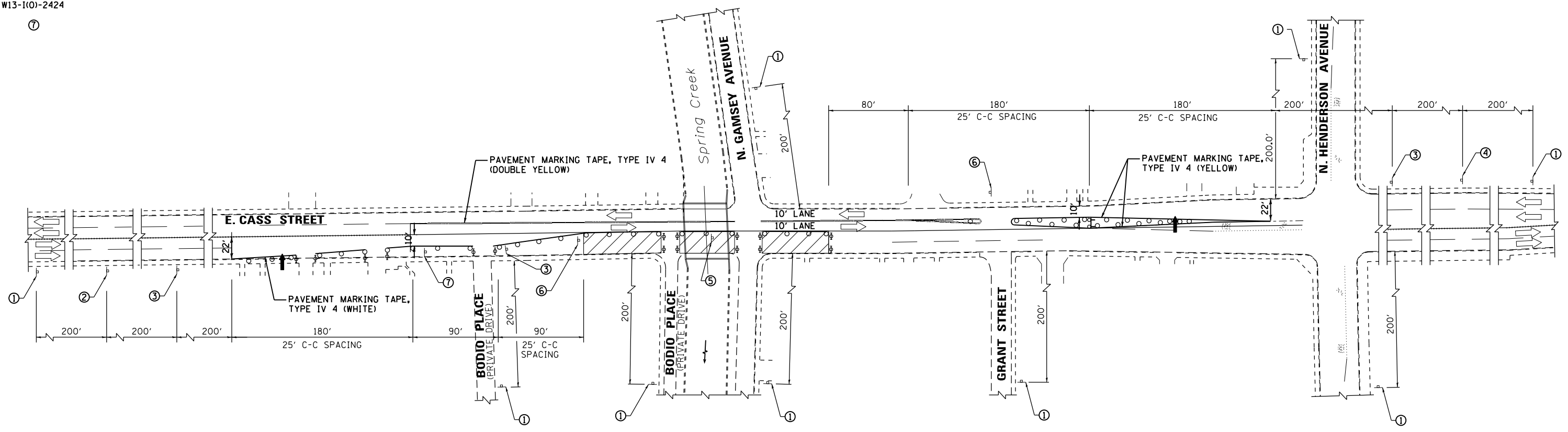

STAGE I PLAN

**NOTE:**  
ESTABLISH TRAFFIC CONTROL PER HIGHWAY STANDARD 701611 AND AS DETAILED IN THE SPECIAL PROVISION FOR TRAFFIC CONTROL PLAN.

LEGEND	
	ARROW BOARD
	SIGN ON PORTABLE OR PERMANENT SUPPORT
	WORK AREA
	TYPE I OR TYPE II BARRICADES
	TYPE III BARRICADE WITH FLASHING LIGHTS
	DRUM OR TYPE II BARRICADE AT 25' CENTERS (UNLESS NOTED OTHERWISE)
	DIRECTION OF TRAFFIC

MODEL: Default  
 FILE NAME: p:\u0008\B&E\BID\ITEC\Illinois\gov\PIWDOT\Documents\DOT\_Offices\Bldg\1\Projects\20511\CADD\B&E\Design\20511-eh-std\stage1.dgn

USER NAME = nullerta	DESIGNED -	REVISED -
	DRAWN -	REVISED -
PLOT SCALE = 100.0000' / in.	CHECKED -	REVISED -
PLOT DATE = 10/16/2018	DATE -	REVISED -

**STATE OF ILLINOIS  
DEPARTMENT OF TRANSPORTATION**

**EAST CASS STREET (FAP 607)  
MAINTENANCE OF TRAFFIC STAGE I**

SCALE: SHEET 1 OF 2 SHEETS STA. TO STA.

F.A.P. RTE. 607	SECTION 27-B-1	COUNTY WILL	TOTAL SHEETS 13	SHEET NO. 4
CONTRACT NO. 60M99				
ILLINOIS FED. AID PROJECT				

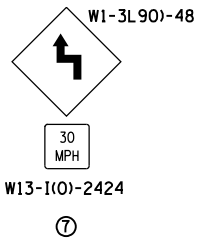
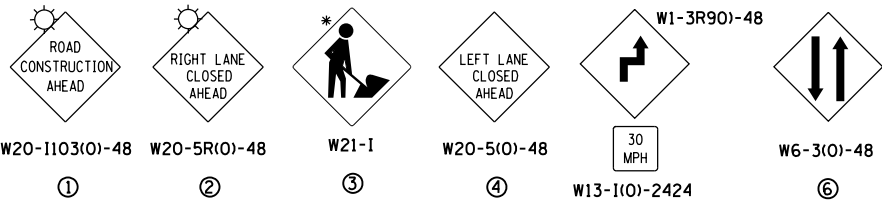

\* MUST BE REMOVED WHEN FLAGGERS/WORKERS ARE NOT PRESENT FOR MORE THAN ONE HOUR

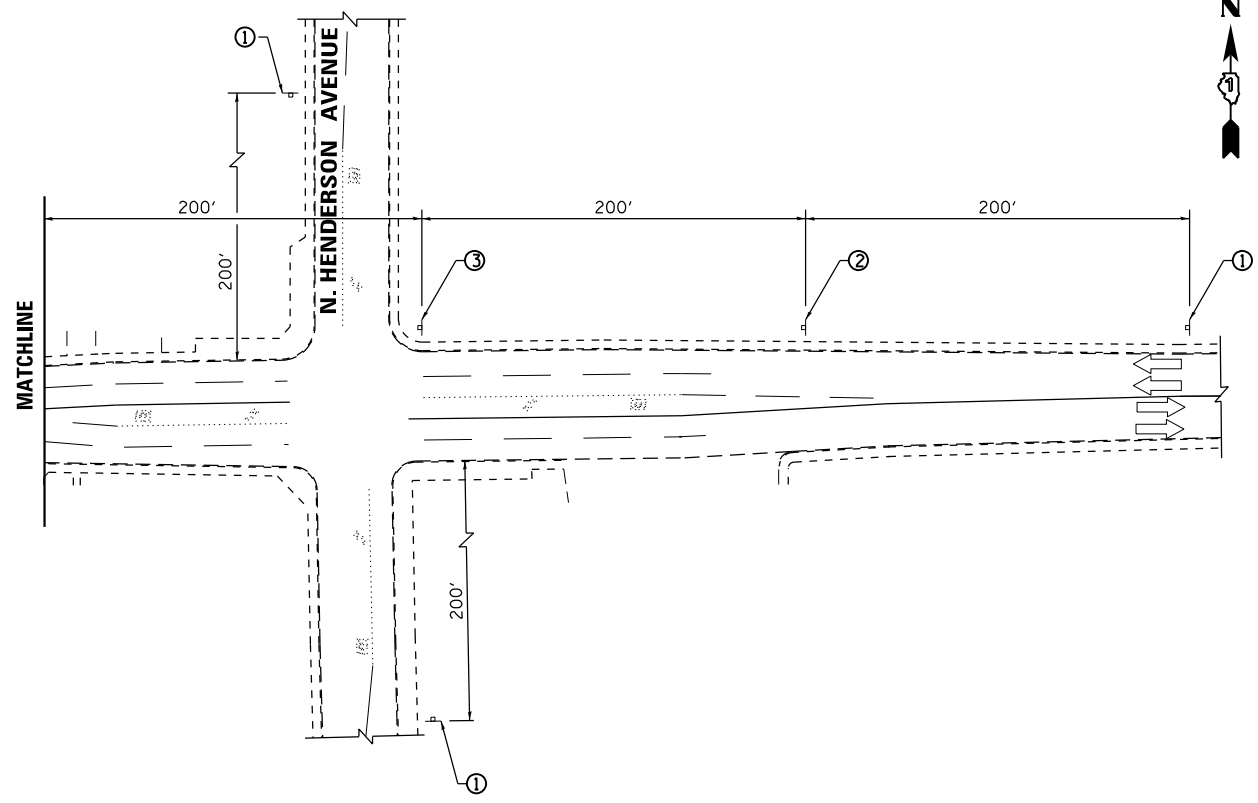
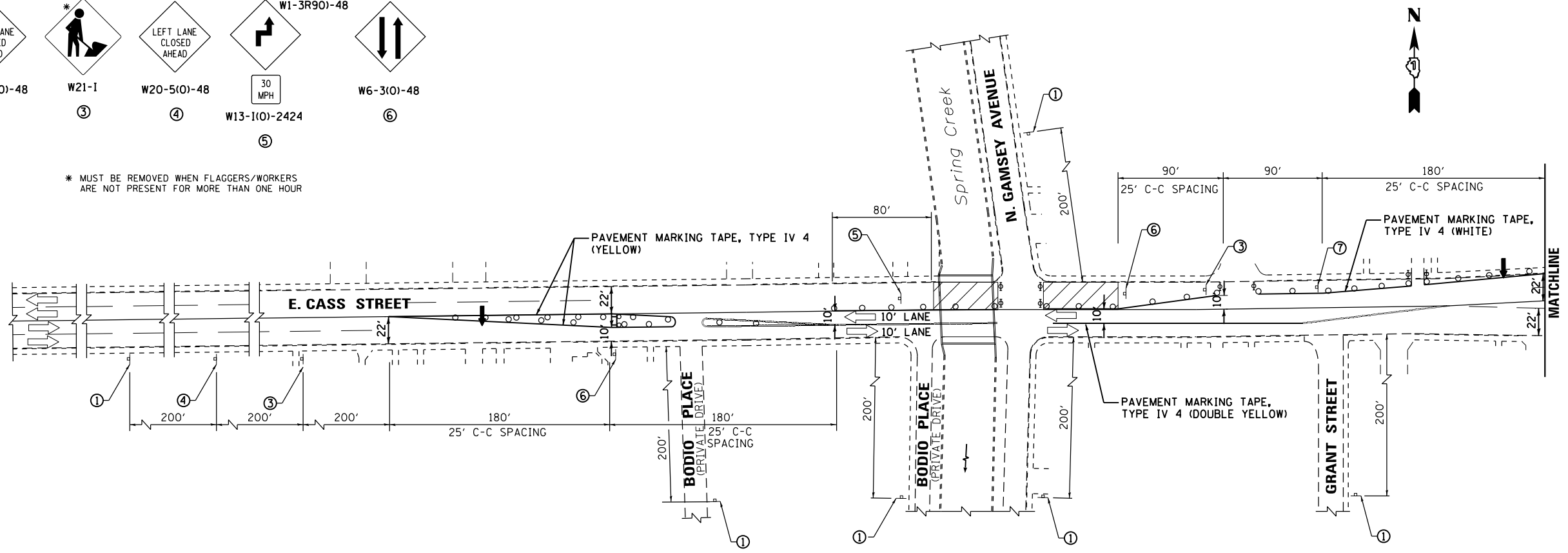

STAGE II PLAN

LEGEND	
	ARROW BOARD
	SIGN ON PORTABLE OR PERMANENT SUPPORT
	WORK AREA
	TYPE I OR TYPE II BARRICADES
	TYPE III BARRICADE WITH FLASHING LIGHTS
	DRUM OR TYPE II BARRICADE AT 25' CENTERS (UNLESS NOTED OTHERWISE)
	DIRECTION OF TRAFFIC

MODEL: Default  
 FILE: \\nas01c.psu.edu\B084E8D8\NTEC\Illinois\gov\PIV\DOT\Documents\DOT\_Offices\Director\Projects\ID120511\CADD\Drawings\ID120511-eh-std\stage2.dgn

USER NAME = mullerta	DESIGNED -	REVISED -
	DRAWN -	REVISED -
PLOT SCALE = 100.0000' / in.	CHECKED -	REVISED -
PLOT DATE = 10/16/2018	DATE -	REVISED -

**STATE OF ILLINOIS  
DEPARTMENT OF TRANSPORTATION**

<b>EAST CASS STREET (FAP 607) MAINTENANCE OF TRAFFIC STAGE II</b>			
SCALE:	SHEET 2 OF 2 SHEETS	STA. TO STA.	

F.A.P. RTE. 607	SECTION 27-B-1	COUNTY WILL	TOTAL SHEETS 13	SHEET NO. 5
CONTRACT NO. 60M99				
ILLINOIS FED. AID PROJECT				

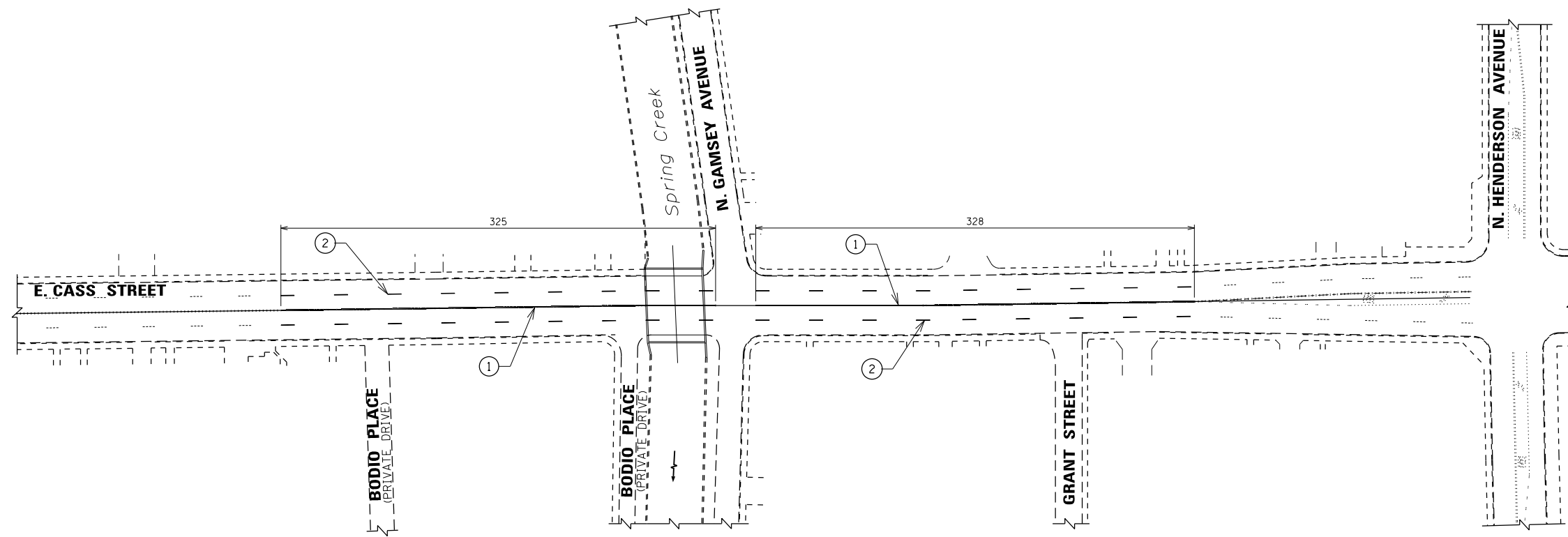

- ① PROP. THERMOPLASTIC PVMT MARKING 4", DOUBLE YELLOW @ 11" C-C (TYP.)
- ② PROP. THERMOPLASTIC PVMT MARKING 4", 10' DASH 30' SKIP, WHITE (TYP.)

MODEL: Default  
 FILE: \\nas01c.pva\ill08a\EBID\NTEC\Illinois.gov\FWIDOT\Documents\DOT\_Offices\Director\Projects\ID12051\ICADD\data\Design\ID120511-shr-yp\cal.dgn

USER NAME = mullerta	DESIGNED -	REVISED -
	DRAWN -	REVISED -
PLOT SCALE = 100.0000' / in.	CHECKED -	REVISED -
PLOT DATE = 10/16/2018	DATE -	REVISED -

**STATE OF ILLINOIS**  
**DEPARTMENT OF TRANSPORTATION**

<b>ROADWAY PLAN</b>			
<b>US 30 / CASS STREET (FAP 607)</b>			
SCALE:	SHEET	OF SHEETS	STA. TO STA.

F.A.P. RTE.	SECTION	COUNTY	TOTAL SHEETS	SHEET NO.
607	27-B-1	WILL	13	5A
CONTRACT NO. 60M99				
		ILLINOIS	FED. AID PROJECT	

Existing Structure: The existing structure is a single span steel beam bridge with a 7 $\frac{1}{2}$ " reinforced concrete deck. The original structure was built in 1984 as section 27B-82. Staged construction shall be utilized to maintain traffic during construction.

No Salvage.

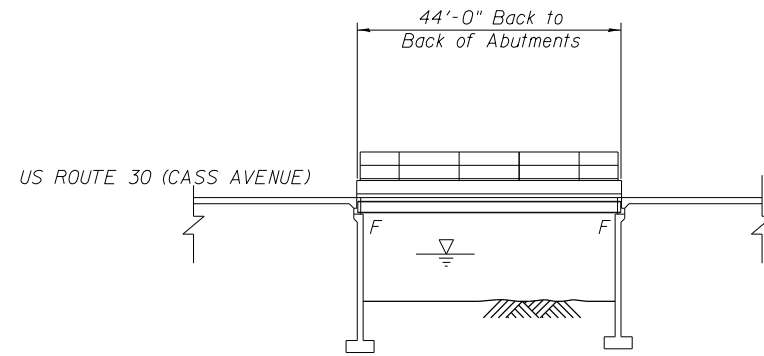

**ELEVATION**

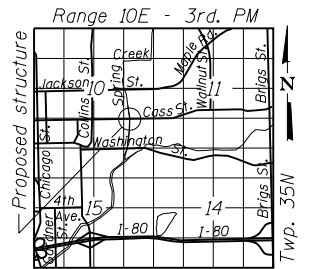

**LOCATION SKETCH**

**SCOPE OF WORK**

1. Repair bridge deck.
2. Reconstruct transverse joints.
3. Repair sidewalk.

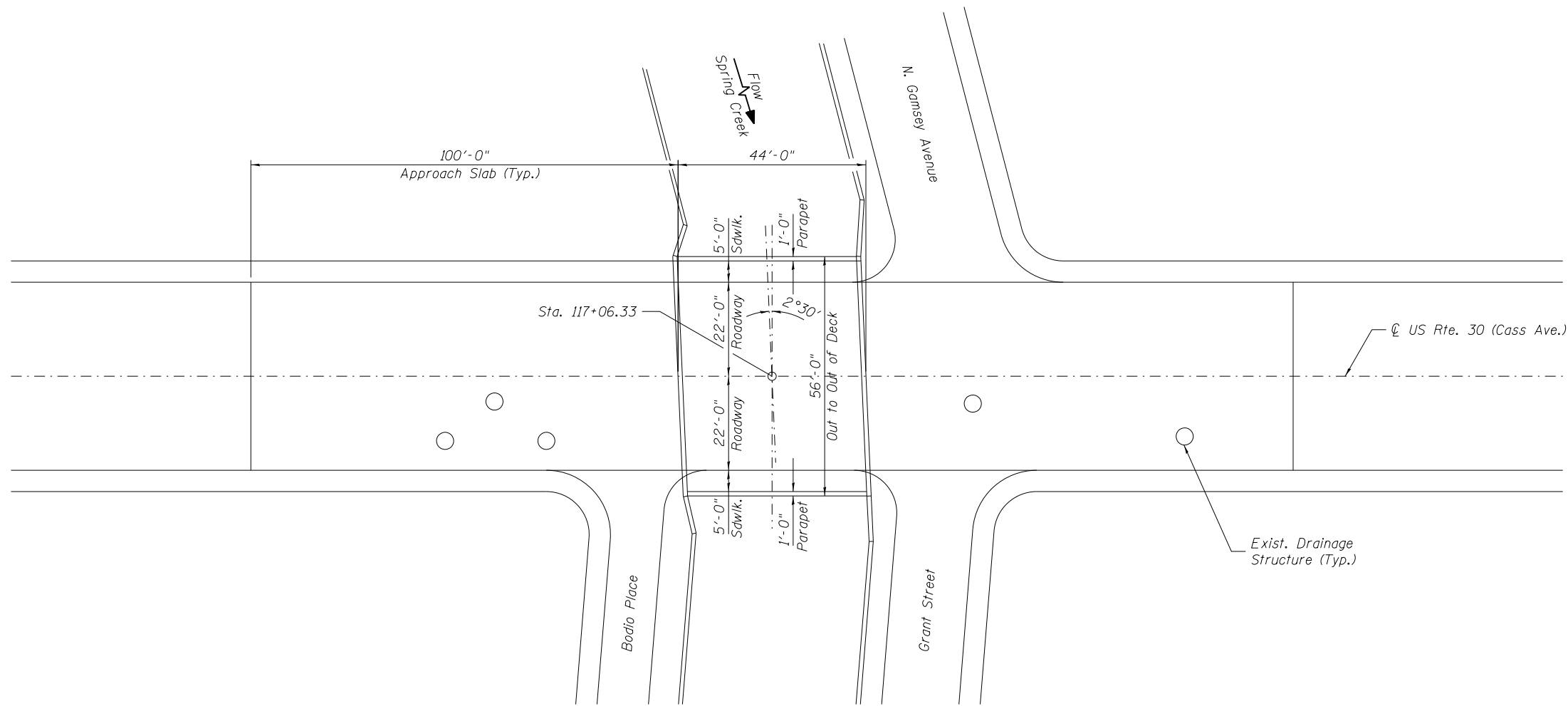

**PLAN**

FILE NAME =	USER NAME =	DESIGNED - JMH	REVISED -
		CHECKED - JMH	REVISED -
	PLOT SCALE =	DRAWN - JMH/DR	REVISED -
	PLOT DATE =	CHECKED - JMH	REVISED -

**STATE OF ILLINOIS  
DEPARTMENT OF TRANSPORTATION**

**GENERAL PLAN AND ELEVATION  
US ROUTE 30 / CASS AVENUE OVER SPRING CREEK  
STRUCTURE NO. 099-0263**

SHEET NO. 51 OF 54 SHEETS

F.A.P. RTE.	SECTION	COUNTY	TOTAL SHEETS	SHEET NO.
607	27-B-1	WILL	13	6
			CONTRACT NO. 60M99	
ILLINOIS FED. AID PROJECT				

**INDEX OF SHEETS**

- S1. General Plan and Elevation
- S2. General Notes, Bill of Materials and Index of Sheets
- S3. Stage Construction Details
- S4. Bridge Deck Repair

**GENERAL NOTES:**

1. Plan dimensions and details relative to existing plans are subject to nominal construction variations. The Contractor shall field verify existing dimensions and details affecting new construction and make necessary approved adjustments prior to construction or ordering of materials. Such variations shall not be cause for additional compensation for a change in scope of the work, however, the Contractor will be paid for the quantity actually furnished at the unit price bid for the work.
2. Stage construction shall be utilized to maintain traffic during construction.
3. The Contractor shall exercise care during removal of existing joints to ensure that the slabs integrity will not be detrimentally impacted. The Contractor shall repair any damage(s) to the slab caused by his operation as directed by the Engineer at no additional cost to the Department.

**TOTAL BILL OF MATERIAL**

ITEM DESCRIPTION	UNIT	QUANTITY
Concrete Removal	Cu. Yd.	1
Deck Slab Repair (Partial Depth)	Sq. Yd.	11.3
Bridge Deck Thin Polymer Overlay, 3/8"	Sq. Yd.	216
Polymer Concrete	Cu. Ft.	5.5
Approach Slab Repair (Partial Depth)	Sq. Yd.	7.5



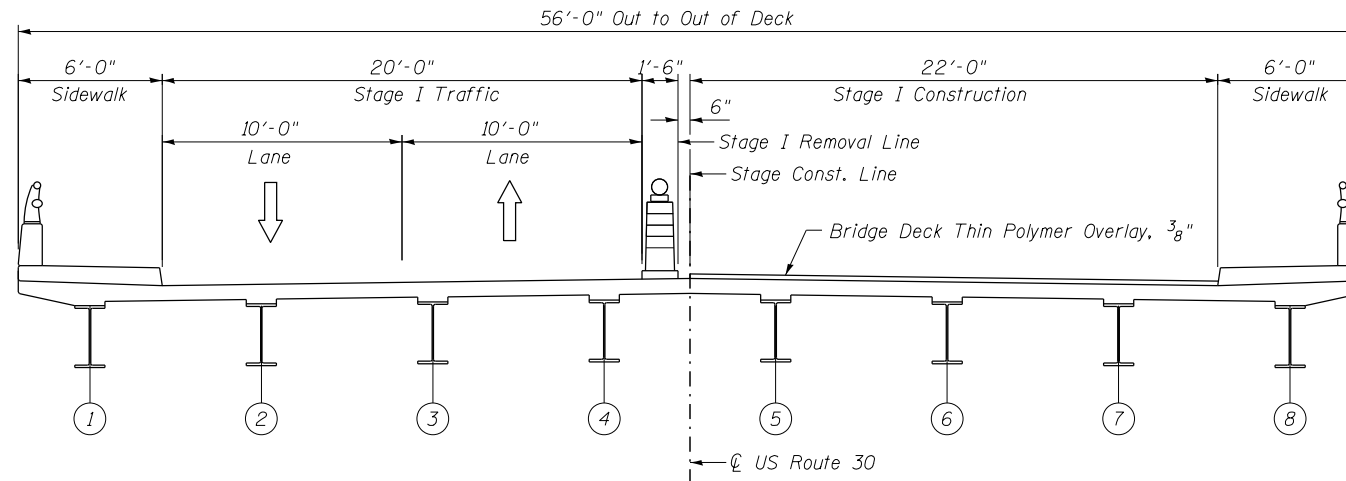

**STAGE I CROSS SECTION**

Looking East

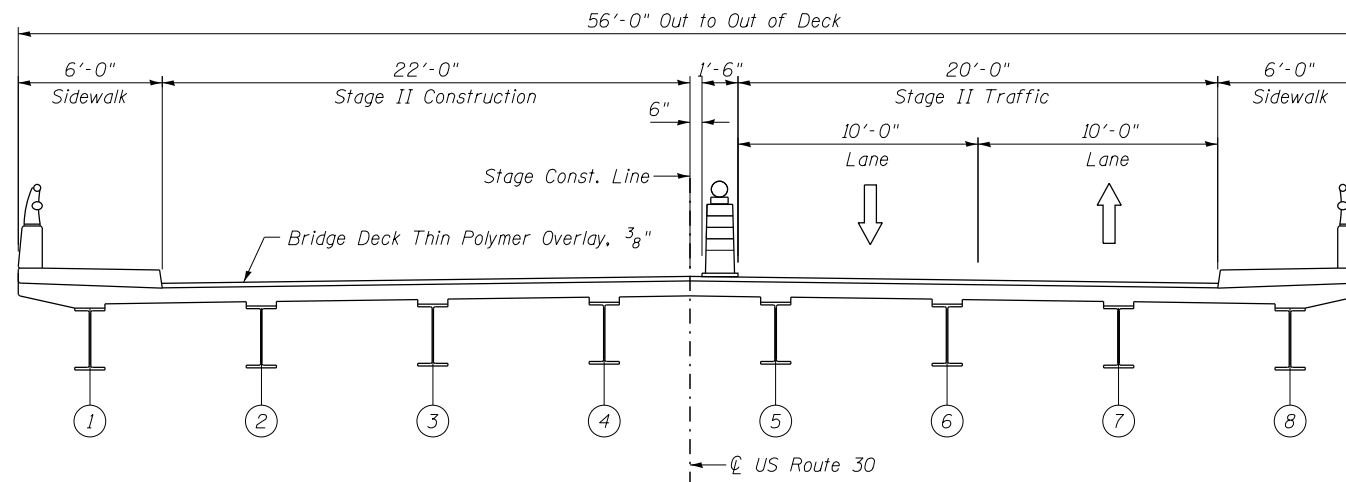

**STAGE II CROSS SECTION**

Looking East

FILE NAME =	USER NAME =	DESIGNED - JMH	REVISED -	<b>STATE OF ILLINOIS DEPARTMENT OF TRANSPORTATION</b>	<b>STAGE CONSTRUCTION DETAILS STRUCTURE NO. 099-0263</b>	F.A.P. RTE.	SECTION	COUNTY	TOTAL SHEETS	SHEET NO.	
		CHECKED - JMH	REVISED -			607	27-B-I	WILL	13	8	
		DRAWN - JMH/ DR	REVISED -			<b>CONTRACT NO. 60M99</b>					
		CHECKED - JMH	REVISED -			SHEET NO. S3 OF S4 SHEETS					
				ILLINOIS FED. AID PROJECT							

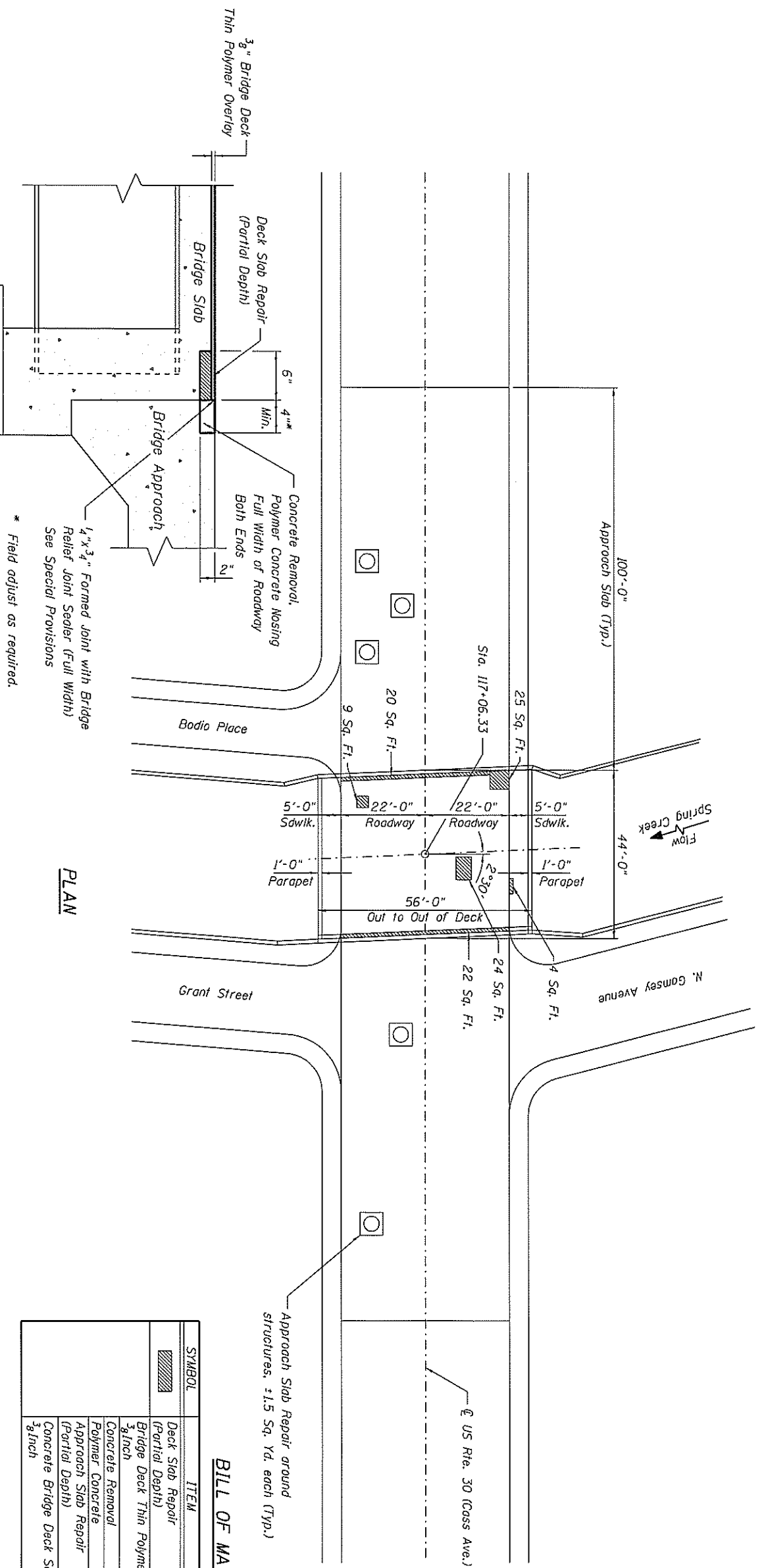
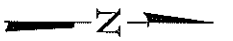

**PLAN**

**BILL OF MATERIAL**

SYMBOL	ITEM	UNIT	QUANTITY
	Deck Slab Repair (Partial Depth)	Sq. Yd.	11.3
	Bridge Deck Thin Polymer Overlay, 3/8 Inch	Sq. Yd.	216
	Concrete Removal	Cu. Yd.	1
	Polymer Concrete	Cu. Ft.	5.5
	Approach Slab Repair (Partial Depth)	Sq. Yd.	7.5
	Concrete Bridge Deck Scarification 3/8 Inch	Sq. Yd.	216

Approach Slab Repair around structures, ±1.5 Sq. Yd. each (Typ.)

US Rte. 30 (Cass Ave.)

**CONCRETE NOSING DETAIL AT BRIDGE ABUTMENTS**

**Notes:** When the polymer concrete nosing is to be installed adjacent to a deck overlay, the nosing shall be installed after the overlay is placed.

Polymer Concrete must be placed in direct contact with the concrete deck. Removal of all HMA or other material that may be adhered to the Polymer Concrete contact areas is required. The cost for this work shall be included in the pay item for Polymer Concrete. See Special Provisions for other requirements.

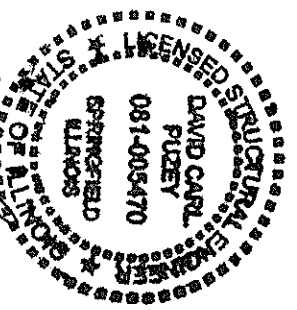

*David Carl Puzey*  
*Expires 11/30/18*

FILE NAME :	DESIGNED :	REVISIONS :
USER NAME :	CHECKED :	REVISIONS :
PLAT SCALE :	DRAWN :	REVISIONS :
PLAT DATE :	CHECKED :	REVISIONS :

STATE OF ILLINOIS  
 DEPARTMENT OF TRANSPORTATION

BRIDGE DECK REPAIR  
 STRUCTURE NO. 099-0263

F.A.P. FILE NO.	SECTION	COUNTY	TOTAL SHEETS
607	27-B-1	WILL.	13
			9

CONTRACT NO. 60M99  
 ILLINOIS FED. AID PROJECT

- NOTES:**
- Deck repair areas are estimated based on visual inspection. Actual repair areas and locations shall be determined by the Engineer and shown on As-built plans.
  - Bridge Deck Thin Polymer Overlay shall be applied over the limits of the bridge deck.
  - Costs for saw cuts shall be included in the item Being Removed.

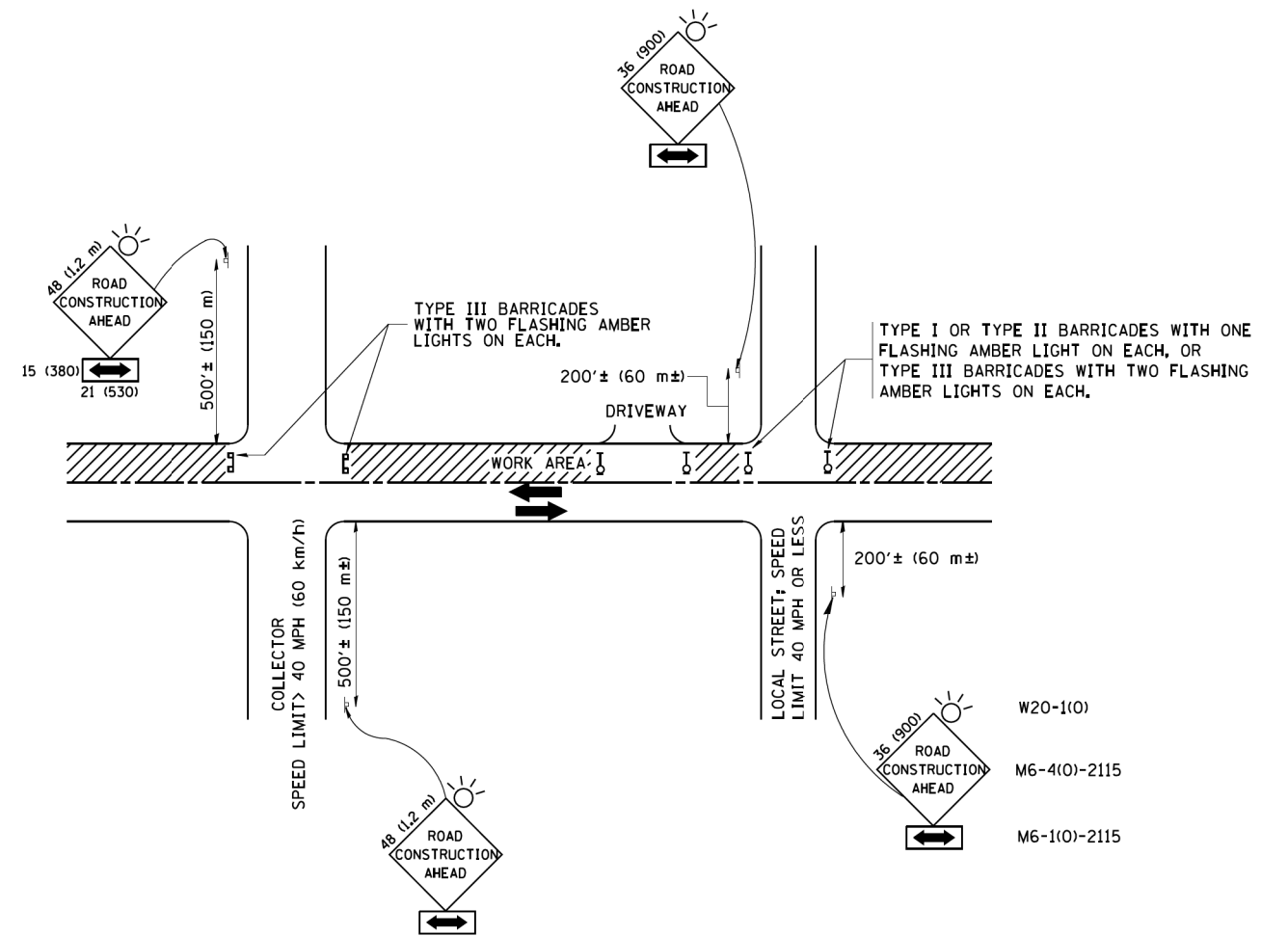

TRAFFIC CONTROL AND PROTECTION FOR SIDE ROADS, INTERSECTIONS, AND DRIVEWAYS

NOTES:

A. FOR NO LANE RESTRICTION ON THE SIDE ROAD OR DRIVEWAYS

1. SIDE ROAD WITH A SPEED LIMIT OF 40 MPH (60 km/h) OR LESS AS SHOWN ON THE DRAWING AND AS DIRECTED BY THE ENGINEER:
  - a) ONE ROAD CONSTRUCTION AHEAD SIGN 36 x 36 (900x900) WITH A FLASHER AND FLAG MOUNTED ON IT APPROXIMATELY 200' (60 m) IN ADVANCE OF THE MAIN ROUTE.
  - b) THE CLOSED PORTION OF THE MAIN ROUTE SHALL BE PROTECTED BY BLOCKING WITH TYPE I, TYPE II OR TYPE III BARRICADES, 1/3 OF THE CROSS SECTION OF THE CLOSED PORTION.
2. SIDE ROAD WITH A SPEED LIMIT GREATER THAN 40 MPH (60 km/h) AS SHOWN ON THE DRAWING AND AS DIRECTED BY THE ENGINEER:
  - a) ONE ROAD CONSTRUCTION AHEAD SIGN 48 x 48 (1.2 m x 1.2 m) WITH A FLASHER MOUNTED ON IT APPROXIMATELY 500' (150 m) IN ADVANCE OF THE MAIN ROUTE.
  - b) THE CLOSED PORTION OF THE MAIN ROUTE SHALL BE PROTECTED BY BLOCKING WITH TYPE III BARRICADES, 1/2 OF THE CROSS SECTION OF THE CLOSED PORTION.
3. WHEN THE SIDE ROAD LIES BETWEEN THE BEGINNING OF THE MAINLINE SIGNING AND THE WORK ZONE, A SINGLE HEADED ARROW (M6-1) SHALL BE USED IN LIEU OF THE DOUBLE HEADED ARROW (M6-4).

B. FOR A LANE CLOSURE ON A SIDE ROAD OR DRIVEWAY:

- USE APPLICABLE PORTIONS OF THE TYPICAL APPLICATION OF TRAFFIC CONTROL DEVICES (STD. 701501, STD. 701606 OR THE APPROPRIATE STANDARD). THE SPACING OF SIGNS AND BARRICADES SHALL BE ADJUSTED FOR FIELD CONDITIONS AS DIRECTED BY THE ENGINEER. THE DIRECTIONAL ARROW SHALL BE COVERED OR REMOVED WHEN NO LONGER CONSISTENT WITH THE SIDE ROAD LANE CLOSURE.
- C. ADVANCE WARNING SIGNS ARE TO BE OMITTED ON DRIVEWAY UNLESS OTHERWISE NOTED.
- D. THE TRAFFIC CONTROL AND PROTECTION FOR SIDE ROADS, INTERSECTIONS, AND DRIVEWAYS SHALL BE INCIDENTAL TO THE COST OF SPECIFIED TRAFFIC CONTROL STANDARDS OR ITEMS.

All dimensions are in millimeters (Inches) unless otherwise shown.

FILE NAME = W:\diststd\22x34\td10.dgn	USER NAME = gegl1enobt	DESIGNED - LHA	REVISED - J. OBERLE 10-18-95
		DRAWN -	REVISED - A. HOUSEH 03-06-96
	PLOT SCALE = 50.000' / IN.	CHECKED -	REVISED - A. HOUSEH 10-15-96
	PLOT DATE = 1/4/2008	DATE - 06-89	REVISED - T. RAMMACHER 01-06-00

STATE OF ILLINOIS  
DEPARTMENT OF TRANSPORTATION

TRAFFIC CONTROL AND PROTECTION FOR  
SIDE ROADS, INTERSECTIONS, AND DRIVEWAYS

SCALE: NONE SHEET NO. 1 OF 1 SHEETS STA. TO STA.

F.A.P. RTE.	SECTION	COUNTY	TOTAL SHEETS	SHEET NO.
607	27-B-1	WILL	13	10
TC-10			CONTRACT NO. 60M99	
FED. ROAD DIST. NO. 1 ILLINOIS FED. AID PROJECT				

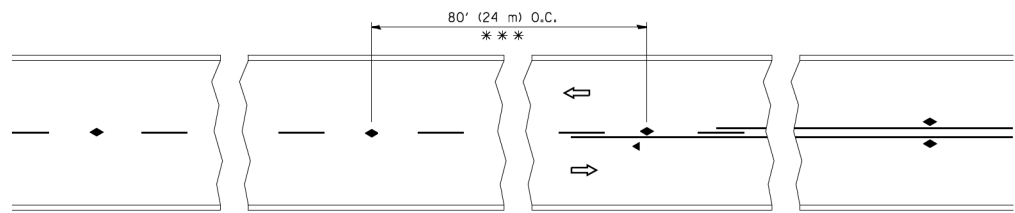

\*\*\* REDUCE TO 40' (12 m) O.C. ON CURVES WITH POSTED OR ADVISORY SPEED 45 M.P.H. (70 km/h) OR LESS.

TWO-LANE/TWO-WAY

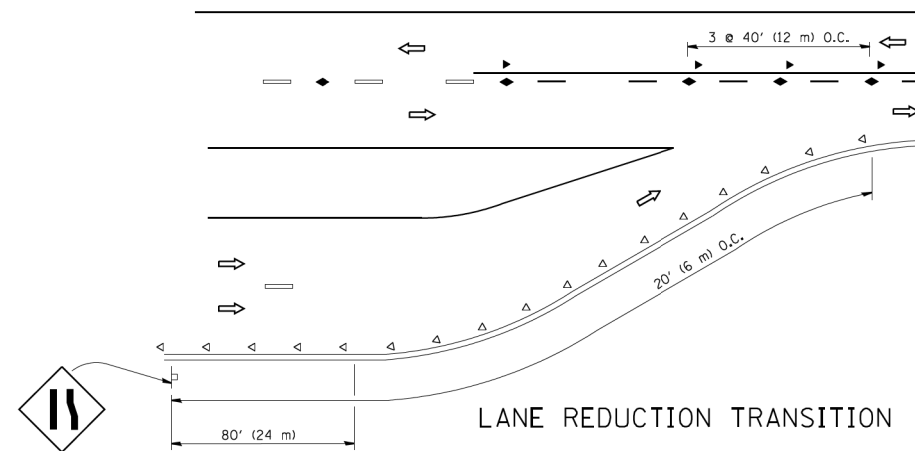

LANE REDUCTION TRANSITION

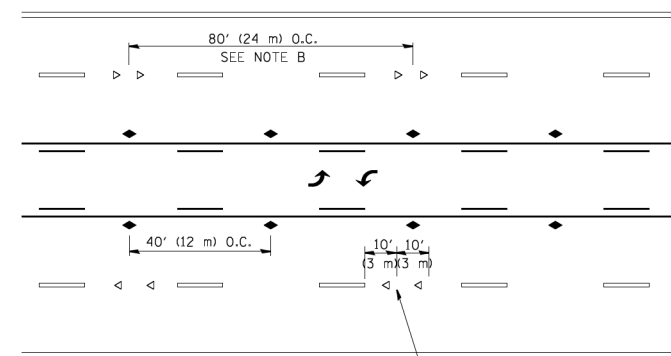

TWO-WAY LEFT TURN

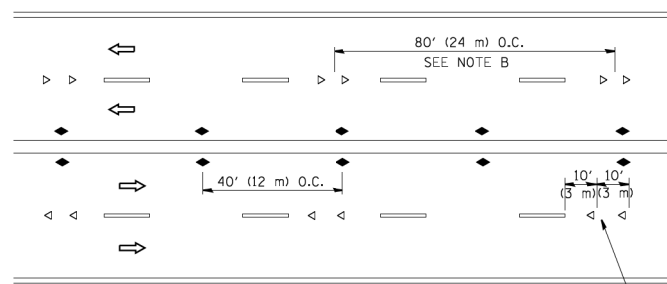

MULTI-LANE/UNDIVIDED

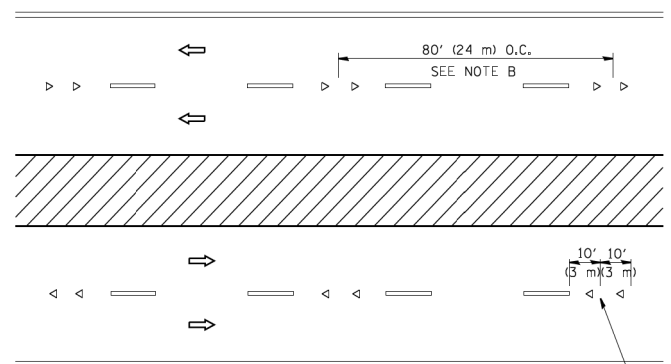

MULTI-LANE/DIVIDED

GENERAL NOTES

1. MARKERS USED WITH DASHED LINES SHALL BE CENTERED IN THE GAP BETWEEN SEGMENTS.
2. MARKERS USED ADJACENT TO SOLID LINES SHALL BE OFFSET 2 TO 3 (50 TO 75) TOWARD TRAFFIC AS SHOWN.
3. MARKERS THROUGH TANGENTS LESS THAN 500' (150 m) IN LENGTH BETWEEN CURVES SHALL BE INSTALLED AT THE LESSER OF THE TWO CURVE SPACINGS.

SYMBOLS

- YELLOW STRIPE
- WHITE STRIPE
- ◀ ONE-WAY AMBER MARKER
- ◁ ONE-WAY CRYSTAL MARKER (W/O)
- ◆ TWO-WAY AMBER MARKER

LANE MARKER NOTES

- A. USE DOUBLE LANE LINE MARKERS SPACED AS SHOWN.
- B. REDUCE TO 40' (12 m) O.C. ON CURVES WHERE ADVISORY SPEEDS ARE 10 M.P.H (20 km/h) LOWER THAN POSTED SPEEDS.

DESIGN NOTES

1. DOUBLE LANE LINE MARKERS SHALL BE USED UNLESS SPECIFIED OTHERWISE.
2. EXCEPT AS SHOWN ON THE LANE REDUCTION TRANSITION AND FREEWAY EXIT RAMP DETAIL, MARKERS ARE NOT TO BE SPECIFIED ON RIGHT EDGE LINES.
3. THE EXACT MARKER LIMITS, SPACING, AND COLOR SHALL BE INCLUDED IN THE PLANS WHEN STANDARD SPECIFICATIONS ARE NOT BEING USED.
4. MARKERS SHOULD NOT BE USED ALONGSIDE CURBS EXCEPT FOR EXTREMELY SHORT SECTIONS OF CURBS WHERE NOT MORE THAN TWO MARKERS WOULD BE INVOLVED.

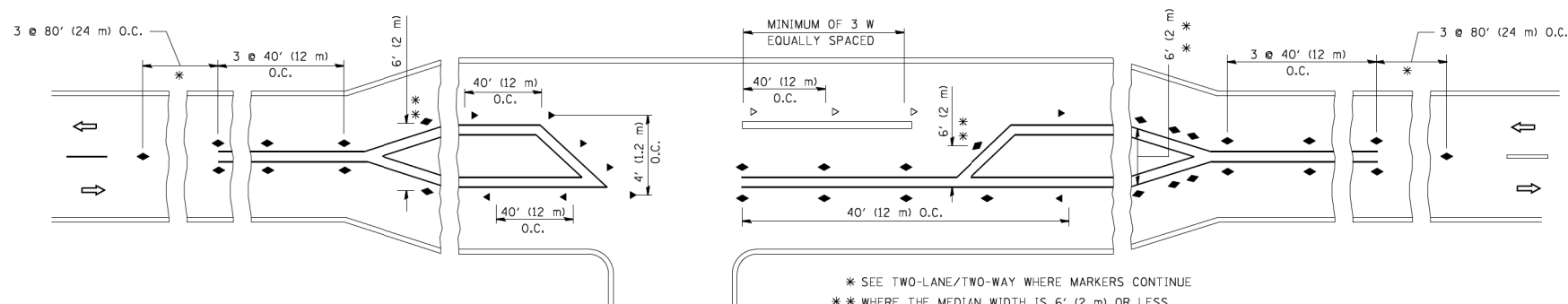

LEFT TURN

\* SEE TWO-LANE/TWO-WAY WHERE MARKERS CONTINUE  
 \*\* WHERE THE MEDIAN WIDTH IS 6' (2 m) OR LESS USE TWO-WAY MARKERS.

All dimensions are in inches (millimeters) unless otherwise shown.

FILE NAME =	USER NAME = lveysa	DESIGNED -	REVISED - T. RAMMACHER 09-19-94	<b>STATE OF ILLINOIS DEPARTMENT OF TRANSPORTATION</b>	<b>TYPICAL APPLICATIONS RAISED REFLECTIVE PAVEMENT MARKERS (SNOW-PLOW RESISTANT)</b>			F.A.P. RTE.	SECTION	COUNTY	TOTAL SHEETS	SHEET NO.
ca:\pki\work\pki\dot\veysa\d0108315\tcl1.dgn		DRAWN -	REVISED - T. RAMMACHER 03-12-99		607	27-B-I	WILL	13	11			
		PLOT SCALE = 50.000' / IN.	REVISED - T. RAMMACHER 01-06-00		<b>TC-11</b>			<b>CONTRACT NO. 60M99</b>				
		PLOT DATE = 3/2/2011	REVISED - C. JUCIUS 09-09-09		SCALE: NONE	SHEET NO. 1 OF 1 SHEETS	STA. TO STA.	FED. ROAD DIST. NO. 1 ILLINOIS FED. AID PROJECT				

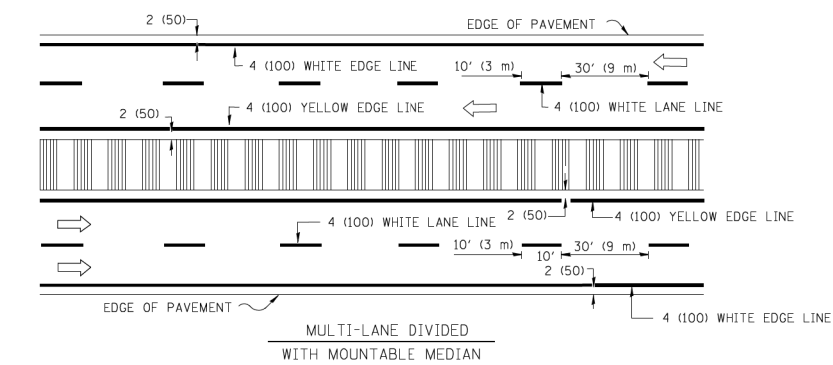
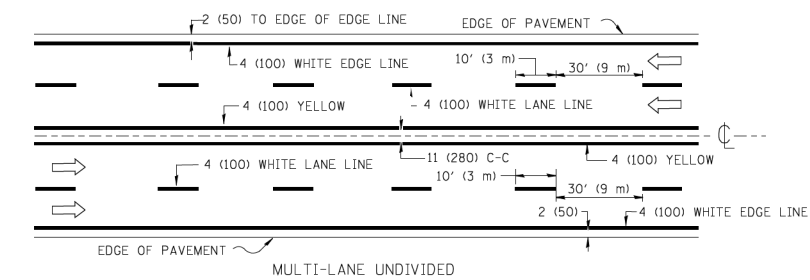
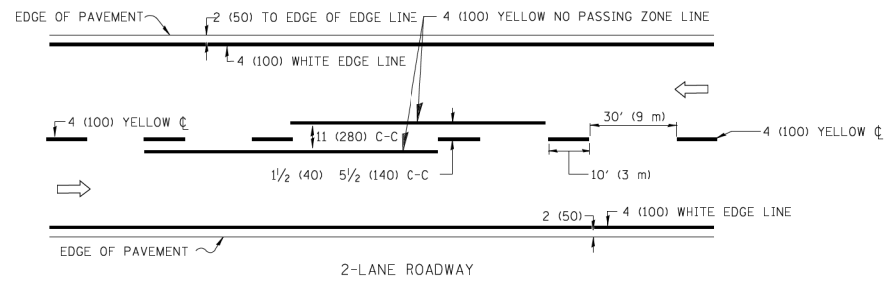

NOTE: MEDIANS WITH BARRIER CURB DO NOT REQUIRE AN EDGE LINE

### TYPICAL LANE AND EDGE LINE MARKING

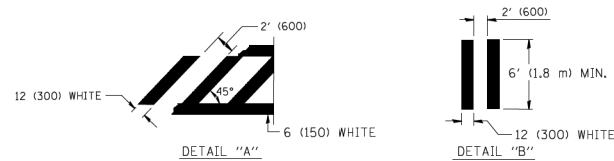
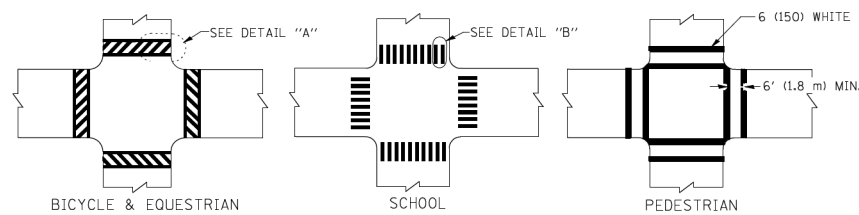

### TYPICAL CROSSWALK MARKING

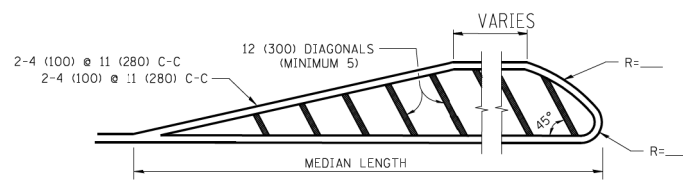
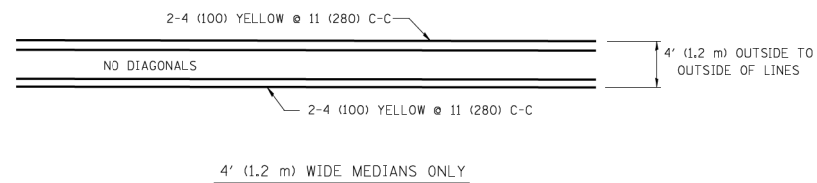

FOR MEDIAN LENGTHS WHERE DIAGONAL SPACING CANNOT BE ATTAINED, USE 5 (FIVE) EQUALLY SPACED DIAGONAL LINES.

DIAGONAL LINE SPACING: 50' (15 m) C-C (LESS THAN 30MPH (50 km/h))  
75' (25 m) C-C 30MPH (50 km/h) TO 45MPH (70 km/h)  
150' (45 m) C-C (MORE THAN 45MPH (70 km/h))

### MEDIANS OVER 4' (1.2 m) WIDE

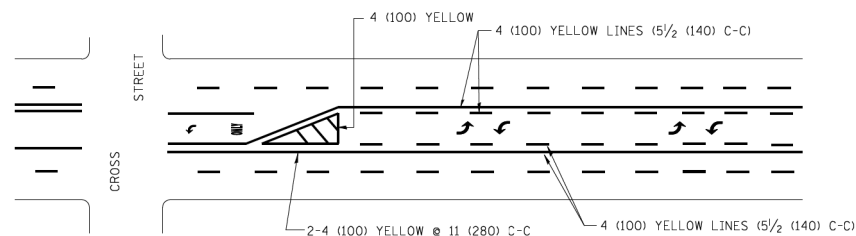

A MINIMUM OF TWO PAIRS OF TURN ARROWS SHALL BE USED, WHITE IN COLOR. ADDITIONAL PAIRS SHALL BE PLACED AT 200' (60 m) TO 300' (90 m) INTERVALS.

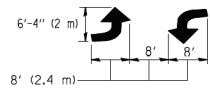

### MEDIAN WITH TWO-WAY LEFT TURN LANE

### TYPICAL PAINTED MEDIAN MARKING

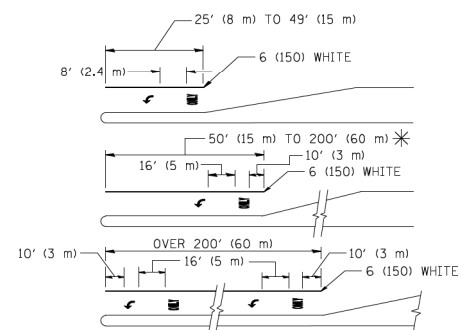

FULL SIZE LETTERS 8' (2.4 m) AND ARROWS SHALL BE USED.  
AREA = 15.6 SQ. FT. (1.5 m<sup>2</sup>) ONLY AREA = 20.8 SQ. FT. (1.9 m<sup>2</sup>)

\* TURN LANES IN EXCESS OF 400' (120 m) IN LENGTH MAY HAVE AN ADDITIONAL SET OF ARROW - "ONLY" INSTALLED MIDWAY BETWEEN THE OTHER TWO SETS OF ARROW - "ONLY".

### TYPICAL LEFT (OR RIGHT) TURN LANE

### TYPICAL TURN LANE MARKING

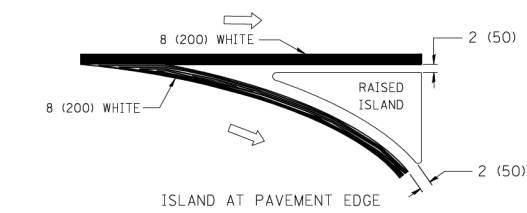
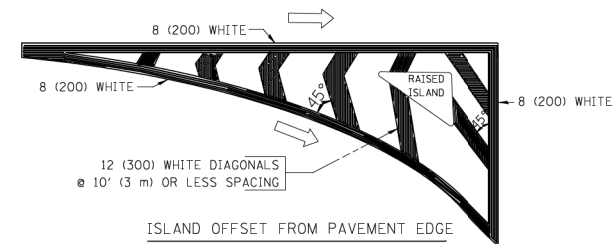

### TYPICAL ISLAND MARKING

TYPE OF MARKING	WIDTH OF LINE	PATTERN	COLOR	SPACING / REMARKS
CENTERLINE ON 2 LANE PAVEMENT	4 (100)	SKIP-DASH	YELLOW	10' (3 m) LINE WITH 30' (9 m) SPACE
CENTERLINE ON MULTI-LANE UNDIVIDED PAVEMENT	2 @ 4 (100)	SOLID	YELLOW	11 (280) C-C
NO PASSING ZONE LINES: FOR ONE DIRECTION FOR BOTH DIRECTIONS	4 (100) 2 @ 4 (100)	SOLID SOLID	YELLOW YELLOW	5/2 (140) C-C FROM SKIP-DASH CENTERLINE 11 (280) C-C OMIT SKIP-DASH CENTERLINE BETWEEN
LANE LINES	4 (100) 5 (125) ON FREEWAYS	SKIP-DASH SKIP-DASH	WHITE WHITE	10' (3 m) LINE WITH 30' (9 m) SPACE
DOTTED LINES (EXTENSIONS OF CENTER, LANE OR TURN LANE MARKINGS)	SAME AS LINE BEING EXTENDED	SKIP-DASH	SAME AS LINE BEING EXTENDED	2' (600) LINE WITH 6' (1.8 m) SPACE
EDGE LINES	4 (100)	SOLID	YELLOW-LEFT WHITE-RIGHT	OUTLINE MOUNTABLE MEDIANS IN YELLOW; EDGE LINES ARE NOT USED NEXT TO BARRIER CURB
TURN LANE MARKINGS	6 (150) LINE; FULL SIZE LETTERS & SYMBOLS (8' (2.4m))	SOLID	WHITE	SEE TYPICAL TURN LANE MARKING DETAIL
TWO WAY LEFT TURN MARKING	2 @ 4 (100) EACH DIRECTION 8' (2.4m) LEFT ARROW	SKIP-DASH AND SOLID IN PAIRS	YELLOW WHITE	10' (3 m) LINE WITH 30' (9 m) SPACE FOR SKIP-DASH; 5/2 (140) C-C BETWEEN SOLID LINE AND SKIP-DASH LINE SEE TYPICAL TWO-WAY LEFT TURN MARKING DETAIL
CROSSWALK LINES (PEDESTRIAN) A. DIAGONALS (BIKE & EQUESTRIAN) B. LONGITUDINAL BARS (SCHOOL)	2 @ 6 (150) 12 (300) @ 45° 12 (300) @ 90°	SOLID SOLID SOLID	WHITE WHITE WHITE	NOT LESS THAN 6' (1.8 m) APART 2' (600) APART 2' (600) APART SEE TYPICAL CROSSWALK MARKING DETAILS.
STOP LINES	24 (600)	SOLID	WHITE	PLACE 4' (1.2 m) IN ADVANCE OF AND PARALLEL TO CROSSWALK, IF PRESENT. OTHERWISE, PLACE AT DESIRED STOPPING POINT. PARALLEL TO CROSSROAD CENTERLINE, WHERE POSSIBLE
PAINTED MEDIANS	2 @ 4 (100) WITH 12 (300) DIAGONALS @ 45° NO DIAGONALS USED FOR 4' (1.2 m) WIDE MEDIANS	SOLID	YELLOW: TWO WAY TRAFFIC WHITE: ONE WAY TRAFFIC	11 (280) C-C FOR THE DOUBLE LINE SEE TYPICAL PAINTED MEDIAN MARKING.
GORE MARKING AND CHANNELIZING LINES	8 (200) WITH 12 (300) DIAGONALS @ 45°	SOLID	WHITE	DIAGONALS: 15' (4.5 m) C-C (LESS THAN 30MPH (50 km/h)) 20' (6 m) C-C 30MPH (50 km/h) TO 45MPH (70 km/h) 30' (9 m) C-C (OVER 45MPH (70 km/h))
RAILROAD CROSSING	24 (600) TRANSVERSE LINES; "RR" IS 6' (1.8 m) LETTERS; 16 (400) LINE FOR "X"	SOLID	WHITE	SEE STATE STANDARD 780001 AREA OF: "R"=3.6 SQ. FT. (0.33 m <sup>2</sup> ) EACH "X"=54.0 SQ. FT. (5.0 m <sup>2</sup> )
SHOULDER DIAGONALS	12 (300) @ 45°	SOLID	WHITE - RIGHT YELLOW - LEFT	50' (15 m) C-C (LESS THAN 30MPH (50 km/h)) 75' (25 m) C-C 30 MPH (50 km/h) TO 45MPH (70 km/h) 150' (45 m) C-C (OVER 45MPH (70 km/h))

FOR FURTHER DETAILS ON PAVEMENT MARKING REFER TO STANDARD SPECIFICATIONS FOR ROAD AND BRIDGE CONSTRUCTION AND STATE STANDARD 780001.

All dimensions are in inches (millimeters) unless otherwise shown.

FILE NAME = c:\p\work\p\dot\drivakosgn\d0108315\to3.dgn	USER NAME = drivakosgn	DESIGNED - EVERS	REVISED - T. RAMMACHER 10-27-94
		DRAWN -	REVISED - C. JUCIUS 09-09-09
	PLOT SCALE = 50.000' / IN.	CHECKED -	REVISED -
	PLOT DATE = 9/9/2009	DATE - 03-19-90	REVISED -

## STATE OF ILLINOIS DEPARTMENT OF TRANSPORTATION

DISTRICT ONE		F.A.P. RTE. 607	SECTION 27-B-1	COUNTY WILL	TOTAL SHEETS 13	SHEET NO. 12
TYPICAL PAVEMENT MARKINGS		TC-13		CONTRACT NO. 60M99		
SCALE: NONE	SHEET NO. 1 OF 1 SHEETS	STA.	TO STA.	FED. ROAD DIST. NO. 1 ILLINOIS FED. AID PROJECT		

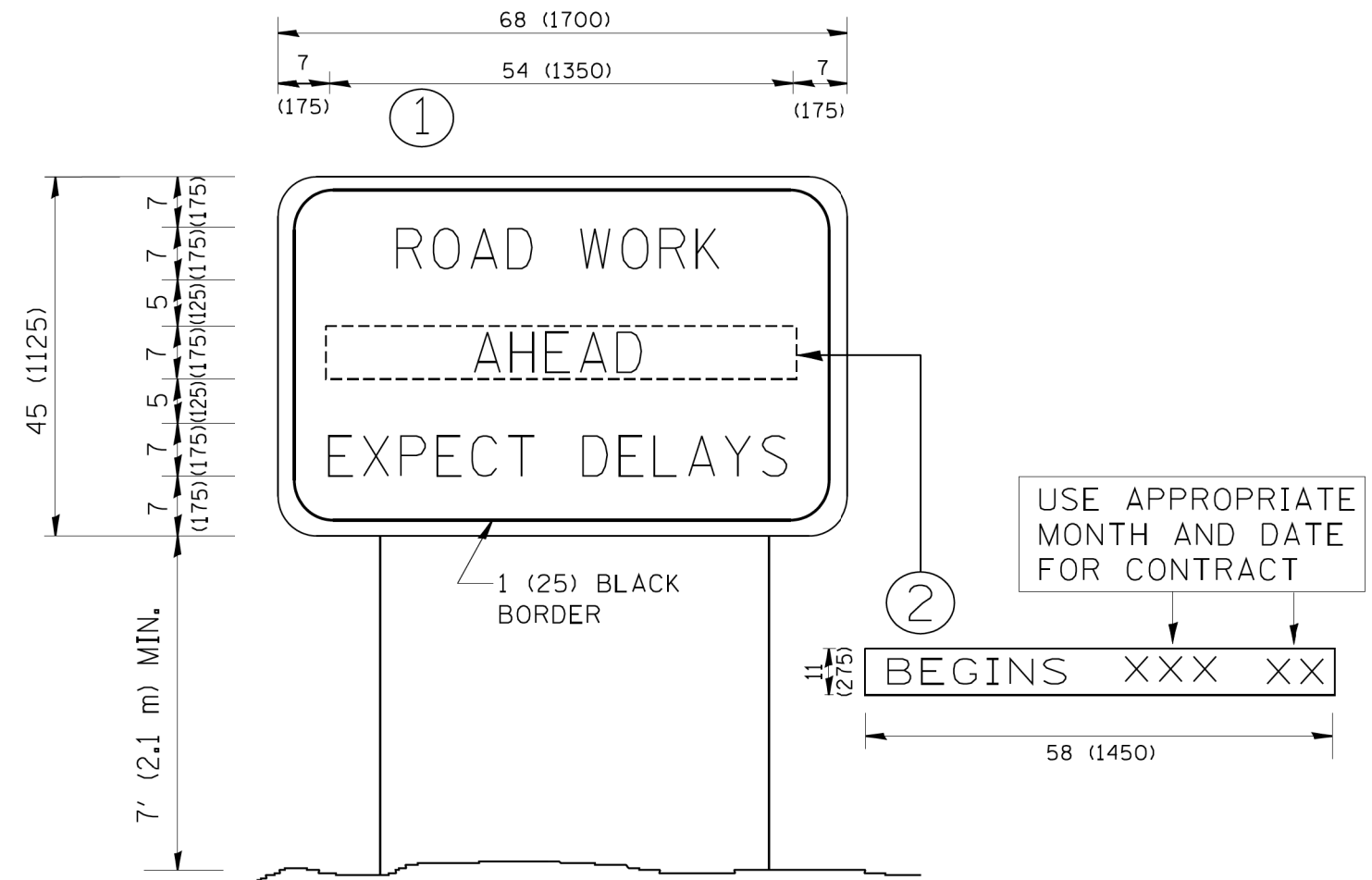

**NOTES:**

1. USE BLACK LETTERING ON ORANGE BACKGROUND.
2. ERECT SIGNS IN ADVANCE OF THE LOCATION FOR THE "ROAD CONSTRUCTION AHEAD" SIGN AT LOCATIONS AS DIRECTED BY THE ENGINEER.
3. ERECT SIGN ① WITH INSTALLED PANEL ② ONE WEEK PRIOR TO THE START OF CONSTRUCTION.
4. REMOVE PANEL ② SOON AFTER THE START OF CONSTRUCTION.
5. SEE SPECIAL PROVISION FOR "TEMPORARY INFORMATION SIGNING" FOR ADDITIONAL INFORMATION.
6. ONE SIGN ASSEMBLY EQUALS 25.70 SQ. FT. (2.3 SQ. M.)
7. SHALL BE PAID FOR AS TEMPORARY INFORMATION SIGNING.

ALL DIMENSIONS ARE IN INCHES (MILLIMETERS)  
UNLESS OTHERWISE SHOWN.

FILE NAME = W:\diststd\22x34\tc22.dgn	USER NAME = gegl1enobt	DESIGNED -	REVISED - R, MIRS 09-15-97
		DRAWN -	REVISED - R, MIRS 12-11-97
	PLOT SCALE = 50.000 ' / IN.	CHECKED -	REVISED - T. RAMMACHER 02-02-99
	PLOT DATE = 1/4/2008	DATE -	REVISED - C. JUCIUS 01-31-07

**STATE OF ILLINOIS  
DEPARTMENT OF TRANSPORTATION**

**ARTERIAL ROAD  
INFORMATION SIGN**

SCALE: NONE SHEET NO. 1 OF 1 SHEETS STA. TO STA.

F.A.P. RTE.	SECTION	COUNTY	TOTAL SHEETS	SHEET NO.
607	27-B-1	WILL	13	13
<b>TC-22</b>			<b>CONTRACT NO. 60M99</b>	
<small>FED. ROAD DIST. NO. 1 ILLINOIS FED. AID PROJECT</small>				

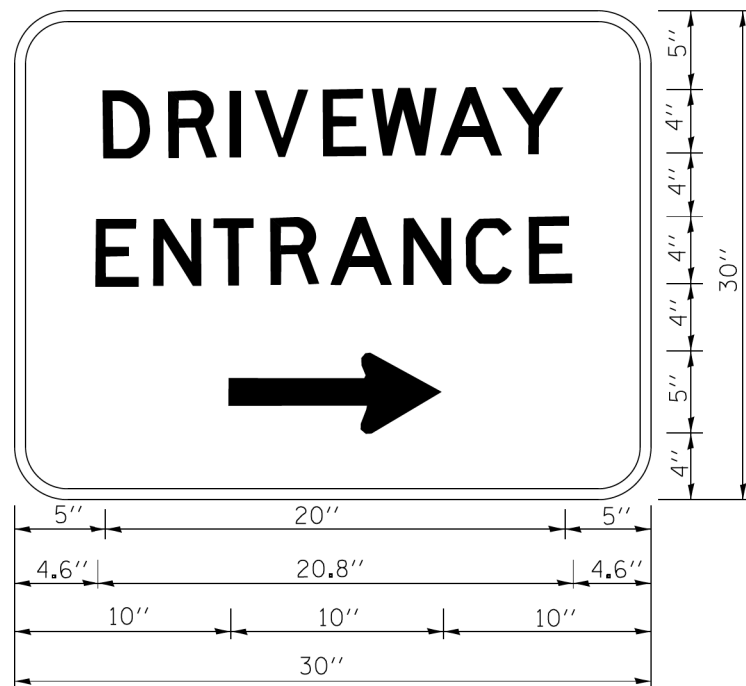

3.0" RADIUS, 0.5" BORDER, WHITE ON GREEN; REFLECTORIZED  
 "DRIVEWAY" D; "ENTRANCE" D; STANDARD ARROW CUSTOM 12.0" x 5.0"

**NOTES:**

1. HALF OF THE SIGNS WILL REQUIRE A LEFT HAND FACING ARROW.
2. TWO SIGNS SHALL BE USED AT EACH COMMERCIAL ENTRANCE  
 PLACED BACK-TO-BACK; ONE WITH A RIGHT HAND ARROW (SHOWN)  
 SHALL BE PLACED ON THE NEAR RIGHT SIDE THE DRIVEWAY  
 AND ONE WITH A LEFT HAND ARROW SHALL BE PLACED ON THE  
 FAR LEFT SIDE OF THE DRIVEWAY.
3. SIGNS TO BE PAID FOR AS ITEM "TEMPORARY INFORMATION SIGNING".

FILE NAME =	USER NAME = gaglianob	DESIGNED -	REVISED - C. JUCIUS 02-15-07
ca\pwork\pwork\gaglianob\d0108315\tp6.dgn		DRAWN -	REVISED -
		CHECKED -	REVISED -
		DATE -	REVISED -

**STATE OF ILLINOIS  
 DEPARTMENT OF TRANSPORTATION**

**DRIVEWAY ENTRANCE SIGNING**

SCALE: NONE SHEET NO. 1 OF 1 SHEETS STA. TO STA.

F.A.P. RTE.	SECTION	COUNTY	TOTAL SHEETS	SHEET NO.
607	27-B-I	WILL	13	13A
TC-26			CONTRACT NO. 60M99	
FED. ROAD DIST. NO. 1 ILLINOIS FED. AID PROJECT				