

F.A.U. RTE.	SECTION	COUNTY	TOTAL SHEETS	SHEET NO.
-	08-00461-00-LS	SANGAMON	7	1

• PW - CITY OF SPRINGFIELD

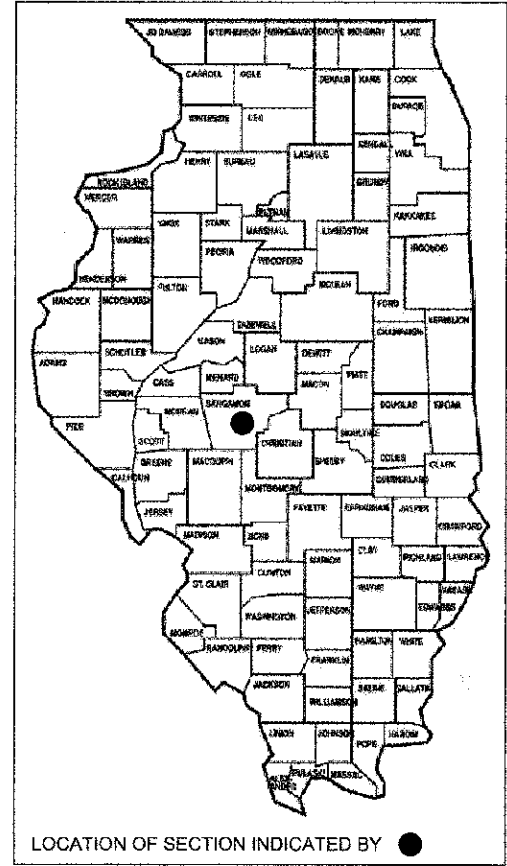

LOCATION OF SECTION INDICATED BY ●

1-18-13 LETTING ITEM 120 STATE OF ILLINOIS DEPARTMENT OF TRANSPORTATION DIVISION OF HIGHWAYS SPRINGFIELD GREEN - MADISON/JEFFERSON/CLEAR LAKE (LANDSCAPE PORTION)

ILLINOIS TRANSPORTATION ENHANCEMENT PROGRAM (ITEP NO. 602025)
(FOR CONSTRUCTION SECTION)
SECTION 08-00461-00LS
PROJECT TE-00D6(085)
CITY OF SPRINGFIELD, SANGAMON COUNTY
JOB NUMBER C-96-235-08

UTILITY NOTE

THE LOCATIONS OF THOSE BURIED AND ABOVEGROUND UTILITIES SHOWN ARE APPROXIMATE, ARE SHOWN FOR CONTRACTOR INFORMATIONAL USE ONLY, AND ARE NOT TO BE REFERENCED FOR CONSTRUCTION PURPOSES. THE IMPLIED PRESENCE OR ABSENCE OF UTILITIES IS NOT TO BE CONSTRUED BY THE OWNER, ENGINEER, CONTRACTOR, OR SUBCONTRACTORS TO BE AN ACCURATE AND COMPLETE REPRESENTATION OF UTILITIES THAT MAY OR MAY NOT EXIST ON THE CONSTRUCTION SITE. BURIED AND ABOVEGROUND UTILITY LOCATION, IDENTIFICATION, AND MARKING ARE THE SOLE RESPONSIBILITY OF THE CONTRACTOR. REROUTING, DISCONNECTION, PROTECTION, ETC. OF ANY UTILITIES MUST BE COORDINATED BETWEEN THE CONTRACTOR, UTILITY COMPANY, AND OWNER. SITE SAFETY INCLUDING THE AVOIDANCE OF HAZARDS, ASSOCIATED WITH BURIED AND ABOVEGROUND UTILITIES, REMAIN THE SOLE RESPONSIBILITY OF THE CONTRACTOR.

J.U.L.I.E.
JOINT UTILITY LOCATING INFORMATION FOR EXCAVATORS
1-800-892-0123

Utility Companies

- | | |
|---|---|
| City Water, Light and Power - Water Dept.
401 N. 11th Street
Springfield, IL 62707
Attention: Steve Stewart (217) 789-2022 | Springfield Metro Sanitary District
3017 N. 8th Street Road
Springfield, IL 62707
Attention: Gregg Humphrey (217) 528-0491 |
| City Water, Light and Power - Electric Dept.
1008 East Miller
Springfield, IL 62701
Attention: Roleen Thoelz (217) 757-8520 | Comcast
711 S. Dirksen Parkway
Springfield, IL 62703
Attention: David Bly (217) 527-2967 |
| AT&T
529 S. Seventh Street, Floor 3E
Springfield, IL 62721
Attention: Rich Weingand (217) 789-8227 | Ameren CILCO (Gas)
825 N. Macarthur Boulevard
Springfield, IL 62702
Attention: Rick Combs (217) 753-5187 |
| Office of Public Works
Room 201, Municipal Center West
Springfield, IL 62701
Attention: Lori Williams, Traffic Engineer (217) 789-8227 | |

Index of Sheets

- 1 Cover Sheet
- 2 Summary of Quantities
- 3 Planting Plan - Sta 34+00 to 39+00
- 4 Planting Plan - Sta 39+00 to 48+00
- 5 Planting Plan - Sta 48+00 to 58+00
- 6 Planting Plan - Sta 58+00 to 67+00
- 7 Plant Details

Highway Standards

- 701001-02
- 701101-03
- 701502-05
- 701601-08
- 701606-08
- 701701-08
- 701901-02

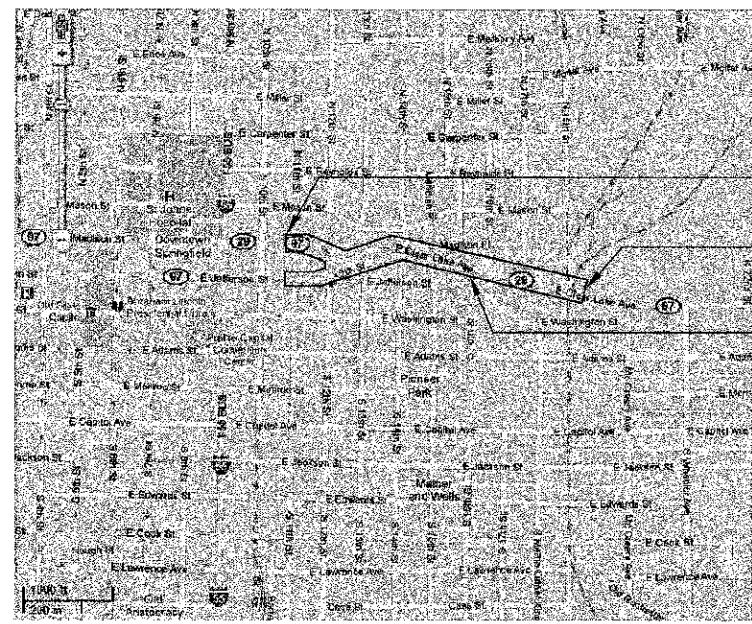

Begin Enhancement
STA 34+00 - CLEAR LAKE AVE.

End Enhancement
STA 67+00 - CLEAR LAKE AVE.

Corridor Improvements
Project Location



DESIGN DESIGNATION: URBAN COLLECTOR
LENGTH ENHANCEMENT = 3,300.00 FT. = 0.625 MILES

**Massie & Massie
Associates**

1210 S. 5th Street, Springfield, IL 62703 217-544-3210
www.Massie-Massie-Associates.com



SIGNATURE: *Neil F. Burnhove*
DATE SIGNED: 10/4/2012
LISC. EXP. DATE: 8/31/2013

APPROVED October 26, 2012
Nathan Bottom
Acting CITY ENGINEER

APPROVED November 1, 2012
James Wharton
DISTRICT LOCAL ROADS AND STREETS ENGINEER

APPROVED November 1, 2012
Ron Chubb
DISTRICT CONSTRUCTION ENGINEER

RELEASING FOR
BID BASED ON
LIMITED REVIEW November 1, 2012
Boyd Oriskany
DEPUTY DIRECTOR OF HIGHWAYS, REGION FOUR ENGINEER

CONTRACT NO. **93581**

SUMMARY OF QUANTITIES

CODE NO	ITEM DESCRIPTION	UNIT	TOTAL QUANTITY
25000400	NITROGEN FERTILIZER NUTRIENT	POUND	3
25000500	PHOSPHORUS FERTILIZER NUTRIENT	POUND	3
25000600	POTASSIUM FERTILIZER NUTRIENT	POUND	3
25000210	SEEDING, CLASS 2A	ACRE	0.05
67100100	MOBILIZATION	L SUM	1
A2000090	TREE, ACER X FREEMANII ARMSTRONG (ARMSTRONG FREEMAN MAPLE), 3" CALIPER, BALLED AND BURLAPPED	EACH	5
B2001168	TREE, CERCIS CANADENSIS (EASTERN REDBUD), 7' HEIGHT, CLUMP FORM, BALLED AND BURLAPPED	EACH	7
B2001420	TREE, CORNUS MAS (CORNELIAN CHERRY DOGWOOD) 2" CALIPER, TREE FORM, BALLED AND BURLAPPED	EACH	7
B2004116	TREE, MALUS PRAIRIFIRE (PRAIRIFIRE CRABAPPLE) 2" CALIPER, TREE FORM, BALLED AND BURLAPPED	EACH	7
B2005016	TREE, MALUS SNOWDRIFT (SNOWDRIFT CRABAPPLE), 2" CALIPER, TREE FORM, BALLED AND BURLAPPED	EACH	3
C2000448	SHRUB, ARONIA ARBUTIFOLIA BRILLIANT ISSIMA (BRILLIANT RED CHOKEBERRY), 4' HEIGHT, BALLED AND BURLAPPED	EACH	43
D2001788	EVERGREEN, PICEA ABIES (NORWAY SPRUCE), 8' HEIGHT, BALLED AND BURLAPPED	EACH	3
D2002996	EVERGREEN, PINUS STROBUS (EASTERN WHITE PINE), 10' HEIGHT, BALLED AND BURLAPPED	EACH	5
* K0012990	PERENNIAL PLANTS, ORNAMENTAL TYPE, GALLON POT	UNIT	28
X2010505	CLEARING, SPECIAL	L SUM	1
X2110100	TOPSOIL FURNISH AND PLACE, SPECIAL	CU YD	100
X7010216	TRAFFIC CONTROL AND PROTECTION, (SPECIAL)	L SUM	1
C2004548	SHRUB, MYRICA PENNSYLVANICA (BAYBERRY), 4' HEIGHT, BALLED AND BURLAPPED	EACH	18
C2C078G5	SHRUB, ROSA X KNOCK OUT (KNOCK OUT ROSE), CONTAINER GROWN, 5 - GALLON	EACH	57

* QUANTITY OF 100 PERENNIAL PLANTS IS EQUAL TO 1 UNIT.

CONSTRUCTION TYPE CODE: 0031

**Massie & Massie
Associates**

1210 S. 5th Street, Springfield, IL 62703 217-544-3210
421 West Main Street, Decatur, IL 62522 217-424-0792

FILE NAME =	USER NAME =	DESIGNED - KM	REVISED -	STATE OF ILLINOIS DEPARTMENT OF TRANSPORTATION	SPRINGFIELD GREEN- MADISON/JEFFERSON/CLEAR LAKE (LANDSCAPE PORTION)		F.A. RTE.	SECTION	COUNTY	TOTAL SHEETS	SHEET NO.
FILE#		DRAWN - NFB	REVISED -		SUMMARY OF QUANTITIES		N/A	08-00461-00LS	SANAGAMON	7	2
	PLOT SCALE =	CHECKED - KM	REVISED -		SCALE: N/A	SHEET NO. 2 OF 7 SHEETS	STA. N/A TO STA. N/A	CONTRACT NO. 08-00461-00LS			
	PLOT DATE = 10-5-2012	DATE - 10-5-2012	REVISED -		FED. ROAD DIST. NO. - ILLINOIS FED. AID PROJECT						

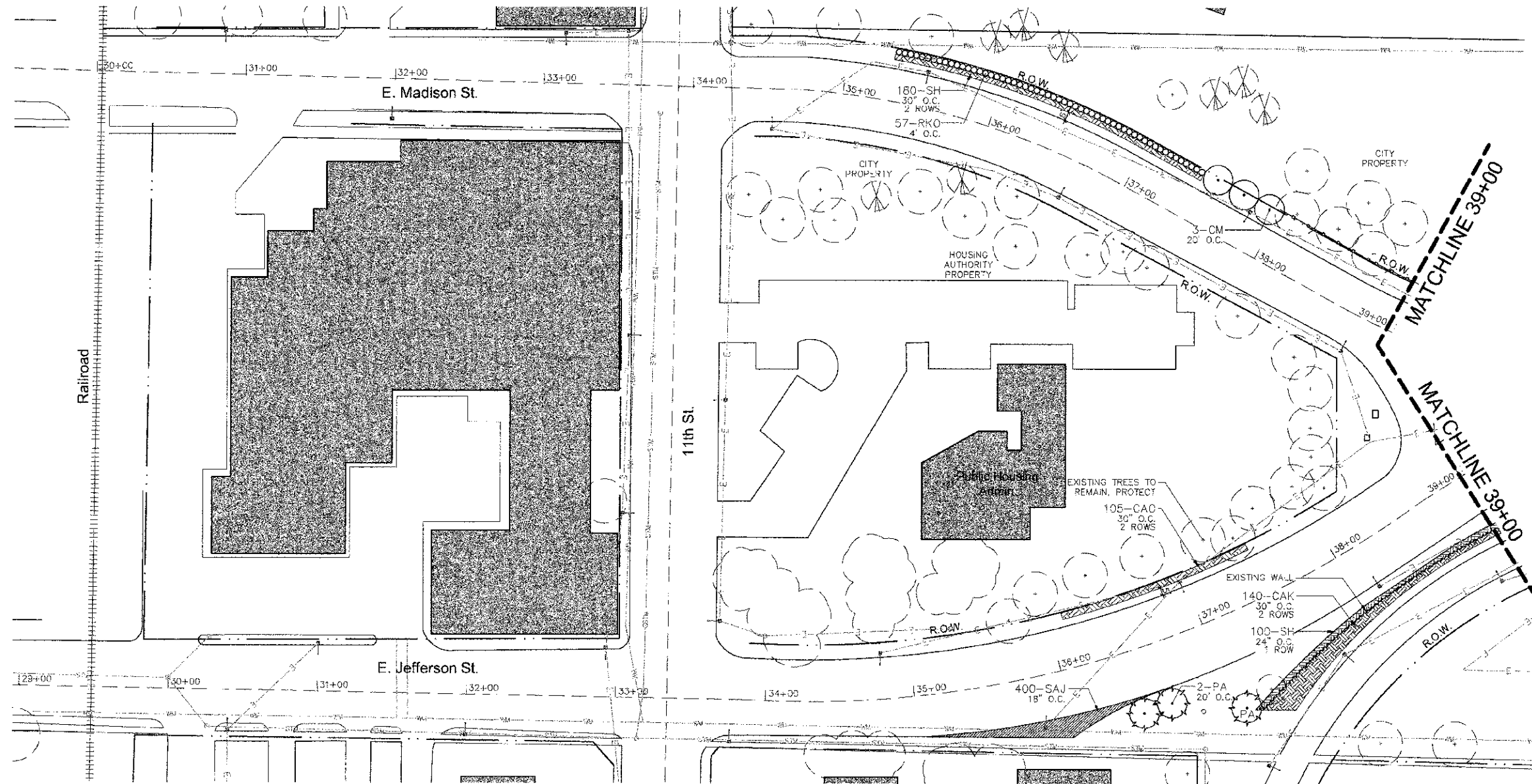

LEGEND

Right-of-Way	---
Property Line	---
Existing Fence	---o---
Street Light	--- ---
Overhead Electric	---E---
Water Line	---W---
Sanitary Sewer	---S---
Existing Trees	○
Proposed Shade Tree	⊕
Proposed Evergreen Tree	⊛
Proposed Ornamental or Columnar Tree	⊙
Proposed Shrub	○
Perennial Planting	▨
Ornamental Grasses	▩
Turf Seeding	▧
Buildings	▩

* Mulch entire plant bed areas.

PLANT SCHEDULE - STA. 34+00 TO 39+00

QTY	SYM	BOTANICAL NAME	COMMON NAME	SIZE
EVERGREEN TREE				
3	PA	PICEA ABIES	NORWAY SPRUCE	8' HEIGHT, BB
ORNAMENTAL/COLUMNAR TREE				
3	CM	CORNUS MAS	CORNELIAN CHERRY DOGWOOD	2" CAL., B.B. TREE FORM
SHRUB				
57	RKO	ROSA X 'KNOCK OUT'	KNOCK OUT ROSE	5-GAL., 3' HT.
PERENNIALS AND ORNAMENTAL GRASS				
140	CAK	CALAMAGROSTIS ACUTIFLORA 'KARL FOERSTER'	KARL FOERSTER REED GRASS	1-GAL. WELL DEVELOPED
105	CAO	CALAMAGROSTIS ACUTIFLORA 'OVERDAM'	OVERDAM REED GRASS	1-GAL. WELL DEVELOPED
400	SAJ	SEDUM 'AUTUMN JOY'	AUTUMN JOY SEDUM	1-GAL. WELL DEVELOPED
280	SH	SPOROBOLUS HETEROLEPIS	PRAIRIE DROPSEED	1-GAL. WELL DEVELOPED

NOTES:

- CONTRACTOR TO CONTACT J.U.L.E. (1-800-882-0123) BEFORE DIGGING TO LOCATE UNDERGROUND UTILITIES.
- ALL UTILITY LOCATIONS ARE PER UTILITY AND CITY OF SPRINGFIELD RECORD DRAWINGS. SPECIFIC LOCATIONS WERE NOT EXCAVATED FOR FIELD VERIFICATION.

40 0 40 80

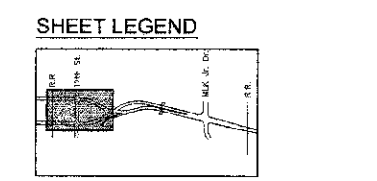

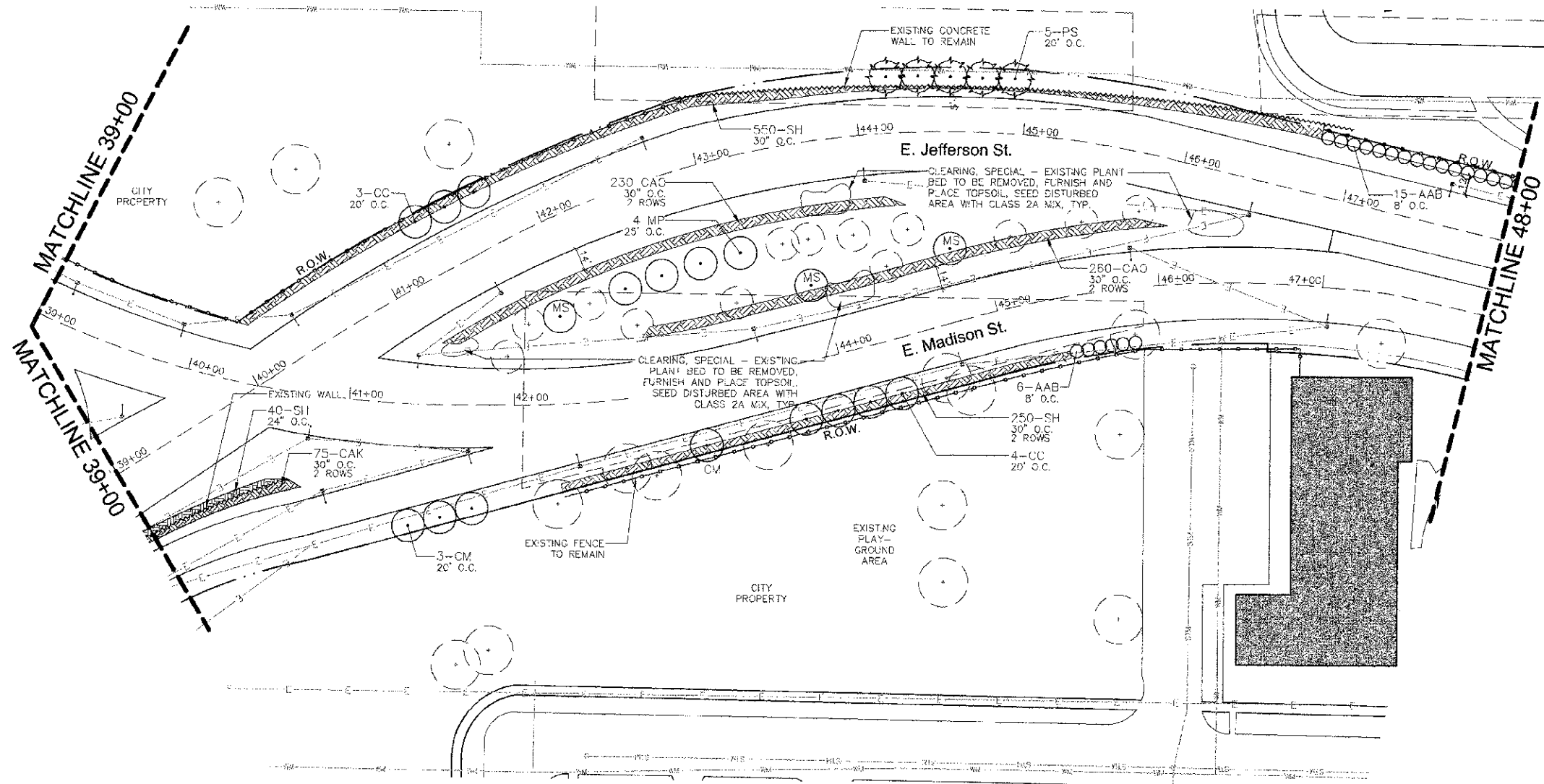

LEGEND

- Right-of-Way
- Property Line
- Existing Fence
- Street Light
- Overhead Electric
- Water Line
- Sanitary Sewer
- Existing Trees
- Proposed Shade Tree
- Proposed Evergreen Tree
- Proposed Ornamental or Columnar Tree
- Proposed Shrub
- Perennial Planting
- Ornamental Grasses
- Turf Seeding
- Buildings

* Mulch entire plant bed areas.

PLANT SCHEDULE - STA. 39+00 TO 48+00

QTY	SYM	BOTANICAL NAME	COMMON NAME	SIZE
EVERGREEN TREE				
5	PS	PINUS STROBUS	EASTERN WHITE PINE	10' HEIGHT, BB
ORNAMENTAL/COLUMNAR TREE				
7	CC	CERCIS CANADENSIS	EASTERN REDBUD	7' HEIGHT, BB CLUMP FORM
4	CM	CORNUS MAS	CORNELIAN CHERRY DOGWOOD	2" CAL., B.B. TREE FORM
4	MP	MALUS X 'PRAIRIFIRE'	PRAIRIFIRE CRABAPPLE	2" CAL., BB TREE FORM
3	MS	MALUS SNOWDRIFT	SNOWDRIFT CRABAPPLE	2" CAL., BB TREE FORM
SHRUB				
21	AAB	ARONIA ARBUTIFOLIA BRILLIANTISSIMA	BRILLIANT RED CHOKEBERRY	4' HEIGHT B.B.
PERENNIALS OR ORNAMENTAL GRASS				
75	CAK	CALAMAGROSTIS ACUTIFLORA 'KARL FOERSTER'	KARL FOERSTER REED GRASS	1-GAL. WELL DEVELOPED
490	CAO	CALAMAGROSTIS ACUTIFLORA 'OVERDAM'	OVERDAM REED GRASS	1-GAL. WELL DEVELOPED
840	SH	SPOROBOLUS HETEROLEPIS	PRAIRIE DROPSEED	1-GAL. WELL DEVELOPED

SEEDING SCHEDULE - STA. 39+00 TO 48+00

CLASS 2A - SALT TOLERANT ROADSIDE MIXTURE	
COMMON NAME	LBS./ACRE
INFERNO TALL FESCUE OR TARHEEL II TALL FESCUE	60
PERENNIAL RYEGRASS	20
AUDUBON RED FESCUE	30
RESCUE 911 HARD FESCUE	30
FULTS SALT GRASS!	60

NOTES:

- CONTRACTOR TO CONTACT J.U.L.I.E. (1-800-892-0123) BEFORE DIGGING TO LOCATE UNDERGROUND UTILITIES.
- ALL UTILITY LOCATIONS ARE PER UTILITY AND CITY OF SPRINGFIELD RECORD DRAWINGS. SPECIFIC LOCATIONS WERE NOT EXCAVATED FOR FIELD VERIFICATION.

40 0 40 80

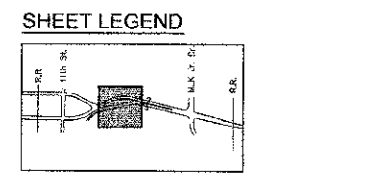

FILE NAME = \$FILEL\$	USER NAME =	DESIGNED - KM	REVISED -	STATE OF ILLINOIS DEPARTMENT OF TRANSPORTATION	SPRINGFIELD GREEN- MADISON/JEFFERSON/CLEAR LAKE (LANDSCAPE PORTION) PLANTING PLAN - STA. 39+00 TO STA. 48+00	F.A. RTE. =	SECTION =	COUNTY =	TOTAL SHEETS =	SHEET NO. =	
	PLANT SCALE = 1" = 40'	DRAWN - NFB	REVISED -			N/A	08-00461-00LS	SANAGAMON	7	4	
	PLANT DATE = 10-5-2012	CHECKED - KM	REVISED -			SCALE: 1"=40'	SHEET NO. 4 OF 7 SHEETS	STA. 39+00 TO STA. 48+00	CONTRACT NO. 93581		
		DATE = 10-5-2012	REVISED -			FED. ROAD DIST. NO. - ILLINOIS FED. AID PROJECT					

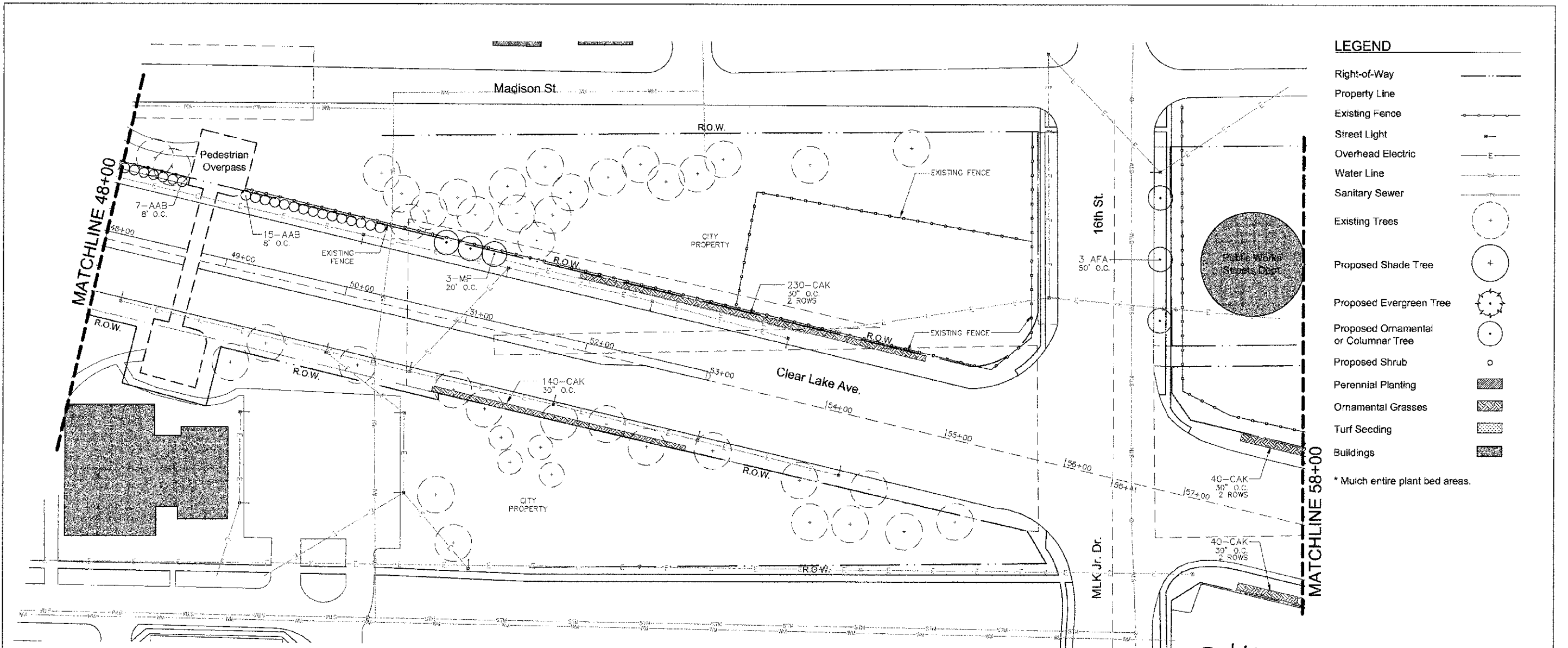

LEGEND

Right-of-Way	---
Property Line	---
Existing Fence	—o—o—o—
Street Light	— —
Overhead Electric	—E—
Water Line	—W—
Sanitary Sewer	—S—
Existing Trees	○+
Proposed Shade Tree	○+
Proposed Evergreen Tree	○*
Proposed Ornamental or Columnar Tree	○•
Proposed Shrub	○
Perennial Planting	▨
Ornamental Grasses	▩
Turf Seeding	▧
Buildings	■

* Mulch entire plant bed areas.

PLANT SCHEDULE - STA. 48+00 TO 58+00

QTY	SYM	BOTANICAL NAME	COMMON NAME	SIZE
SHADE TREE				
3	AFA	ACER X FREEMANI ARMSTRONG	ARMSTRONG FREEMAN MAPLE	3" CAL., BB
ORNAMENTAL/COLUMNAR TREE				
3	MP	MALUS X 'PRAIRIFIRE'	PRAIRIFIRE CRABAPPLE	2" CAL., BB TREE FORM
SHRUB				
22	AAB	ARONIA ARBUTIFOLIA BRILLIANTISSIMA	BRILLIANT RED CHOKEBERRY	4' HEIGHT B.B.
PERENNIALS OR ORNAMENTAL GRASS				
450	CAK	CALAMAGROSTIS ACUTIFLORA 'KARL FOERSTER'	KARL FOERSTER REED GRASS	1-GAL. WELL DEVELOPED

NOTES:

- CONTRACTOR TO CONTACT J.U.L.I.E. (1-800-892-0123) BEFORE DIGGING TO LOCATE UNDERGROUND UTILITIES.
- ALL UTILITY LOCATIONS ARE PER UTILITY AND CITY OF SPRINGFIELD RECORD DRAWINGS. SPECIFIC LOCATIONS WERE NOT EXCAVATED FOR FIELD VERIFICATION.

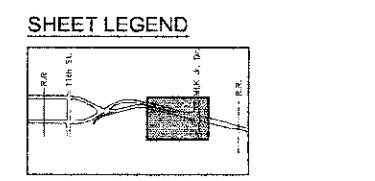

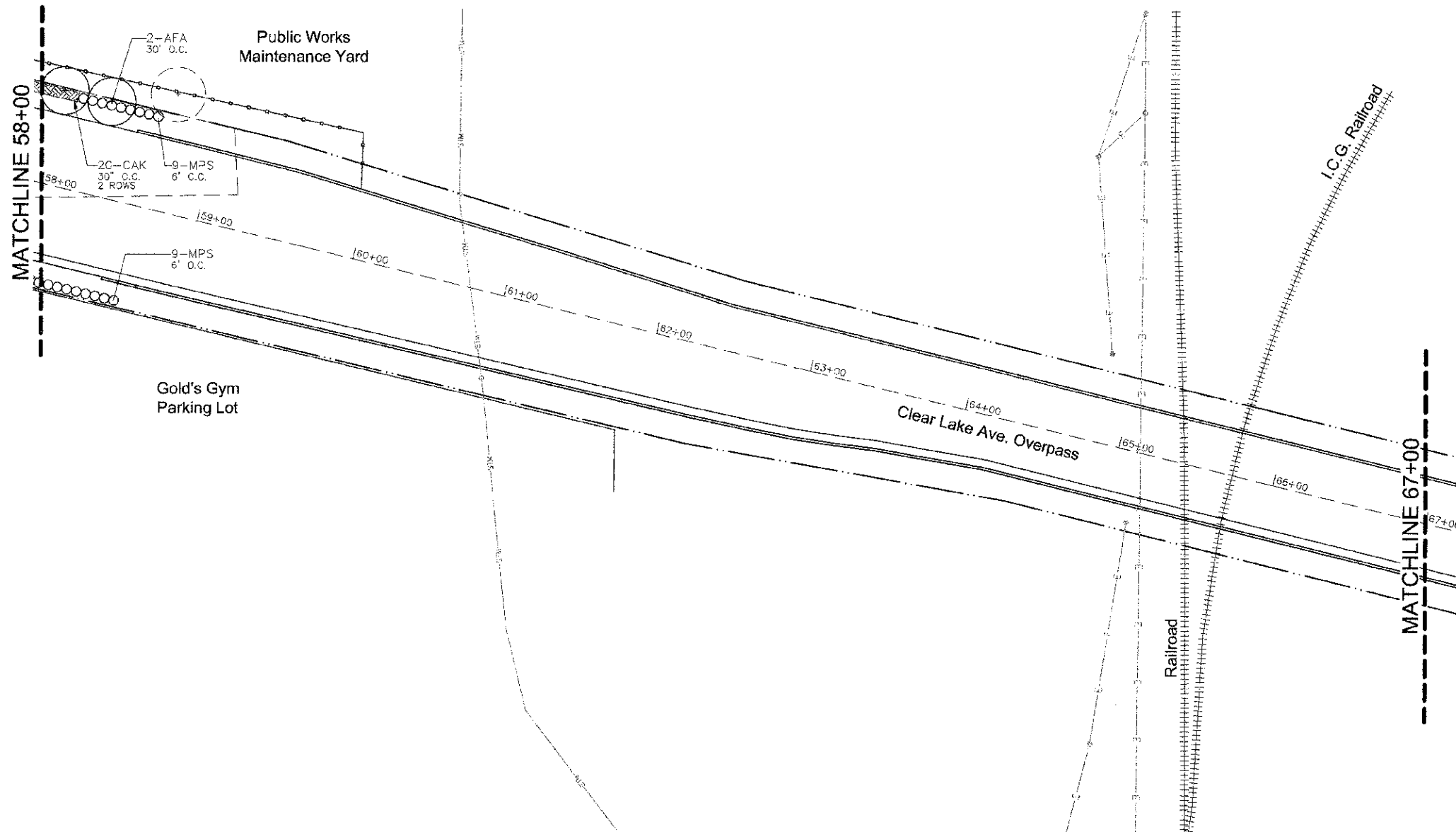

LEGEND

- Right-of-Way
- Property Line
- Existing Fence
- Street Light
- Overhead Electric
- Water Line
- Sanitary Sewer
- Existing Trees
- Proposed Shade Tree
- Proposed Evergreen Tree
- Proposed Ornamental or Columnar Tree
- Proposed Shrub
- Perennial Planting
- Ornamental Grasses
- Turf Seeding
- Buildings

* Mulch entire plant bed areas.

NOTES:

1. CONTRACTOR TO CONTACT J.U.L.I.E. (1-800-892-0123) BEFORE DIGGING TO LOCATE UNDERGROUND UTILITIES.
2. ALL UTILITY LOCATIONS ARE PER UTILITY AND CITY OF SPRINGFIELD RECORD DRAWINGS. SPECIFIC LOCATIONS WERE NOT EXCAVATED FOR FIELD VERIFICATION.



SHEET LEGEND

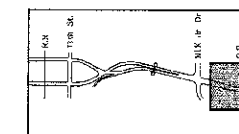

PLANT SCHEDULE - STA. 58+00 TO 67+00				
QTY	SYM	BOTANICAL NAME	COMMON NAME	SIZE
SHADE TREE				
2	AFA	ACER X FREEMANII ARMSTRONG	ARMSTRONG FREEMAN MAPLE	3" CAL. BB
SHRUB				
18	MPS	MYRICA PENNSYLVANICA	BAYBERRY	4' HEIGHT B.B.
PERENNIALS OR ORNAMENTAL GRASS				
20	CAK	CALAMAGROSTIS ACUTIFLORA 'KARL FOERSTER'	KARL FOERSTER REED GRASS	1-GAL. WELL DEVELOPED

FILE NAME =	USER NAME =	DESIGNED - KM	REVISED -
#FILE#		DRAWN - NFB	REVISED -
	PLOT SCALE = 1" = 40'	CHECKED - KM	REVISED -
	PLOT DATE = 10-5-2012	DATE - 10-5-2012	REVISED -

STATE OF ILLINOIS
DEPARTMENT OF TRANSPORTATION

SPRINGFIELD GREEN- MADISON/JEFFERSON/CLEAR LAKE
(LANDSCAPE PORTION)
PLANTING PLAN - STA. 58+00 TO STA 67+00

SCALE: 1"=40'	SHEET NO. 6 OF 7 SHEETS	STA. 58+00 TO STA. 67+00	F.A. RTE. N/A	SECTION 08-00461-00LS	COUNTY SANAGAMON	TOTAL SHEETS 7	SHEET NO. 6
			CONTRACT NO. 08-00461-00LS				
FED. ROAD DIST. NO. - [ILLINOIS] FED. AID PROJECT							

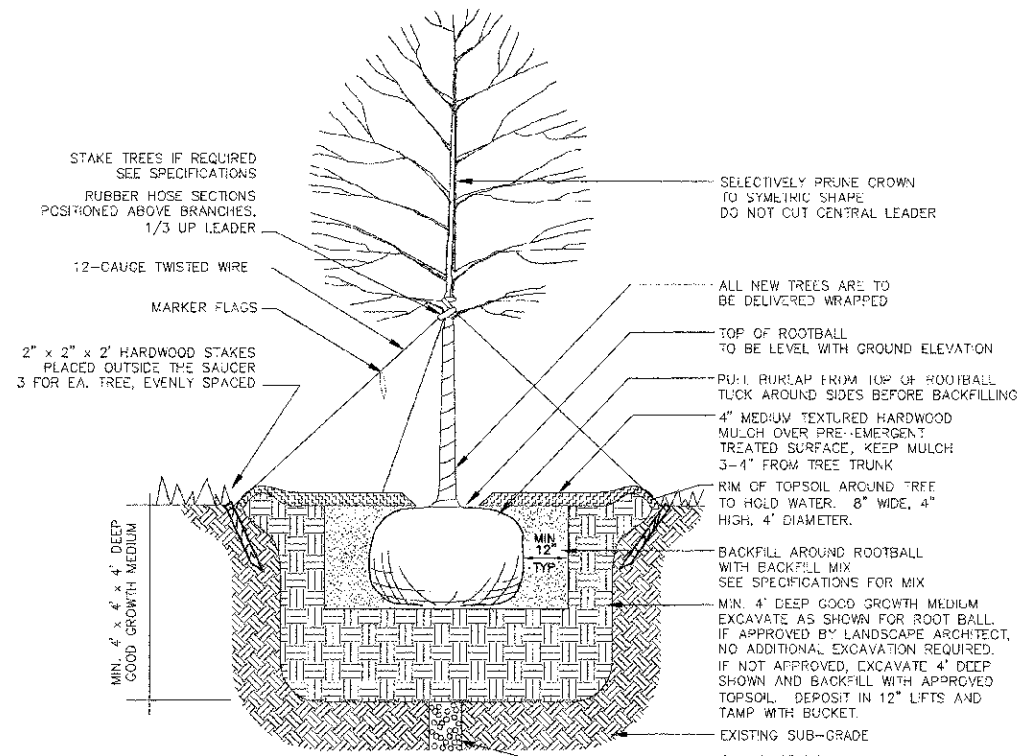

A TREES NOT TO SCALE

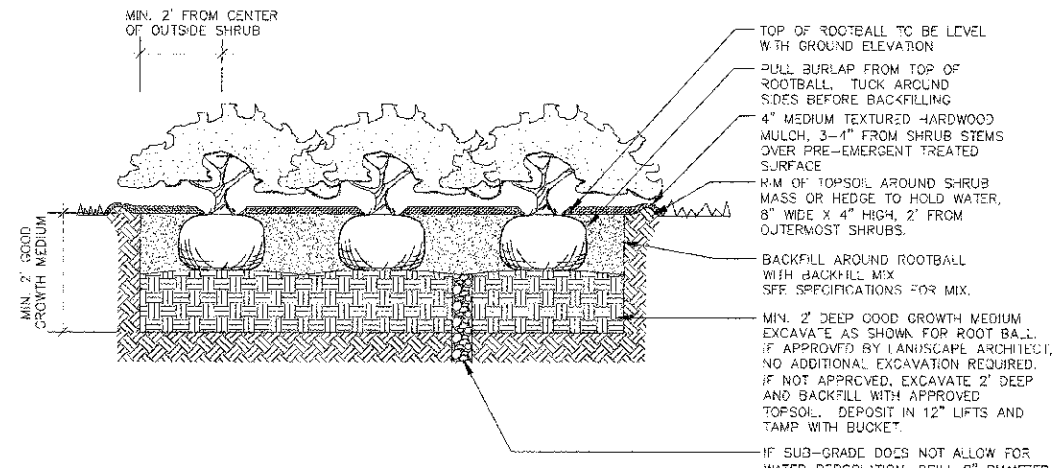

B SHRUB BEDS NOT TO SCALE

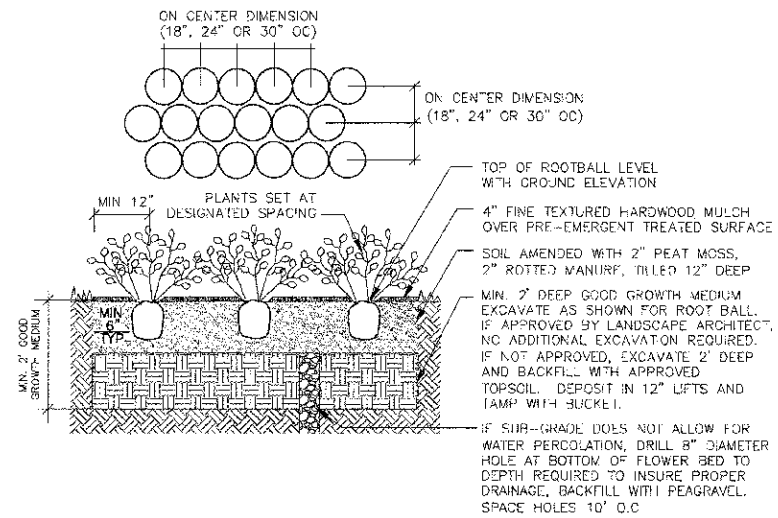

C ORNAMENTAL GRASS AND PERENNIAL BEDS NOT TO SCALE

- NOTES:**
- CONTRACTOR TO CONTACT J.U.L.I.E. (1-800-892-0123) BEFORE DIGGING TO LOCATE UNDERGROUND UTILITIES.
 - ALL UTILITY LOCATIONS ARE PER UTILITY AND CITY OF SPRINGFIELD RECORD DRAWINGS. SPECIFIC LOCATIONS WERE NOT EXCAVATED FOR FIELD VERIFICATION.

FILE NAME =	USER NAME =	DESIGNED - KM	REVISED -	STATE OF ILLINOIS DEPARTMENT OF TRANSPORTATION	SPRINGFIELD GREEN- MADISON/JEFFERSON/CLEAR LAKE (LANDSCAPE PORTION) PLANTING DETAILS	F.A. RITE	SECTION	COUNTY	TOTAL SHEETS	SHEET NO.	
#FILE#	PLOT SCALE = N/A	DRAWN - NFB	REVISED -			N/A	08-00461-00LS	SANAGAMON	7	7	
	PLOT DATE = 10-9-2012	CHECKED - KM	REVISED -			CONTRACT NO. 08-00461-00LS					
		DATE - 10-9-2012	REVISED -			FED. ROAD DIST. NO. - [ILLINOIS] FED. AID PROJECT					
				SCALE: N/A		SHEET NO. 7 OF 7 SHEETS		STA. N/A TO STA. N/A			