

SECTION 29, T. 14 N., R. 11 W., 2nd P.M.

ROUTE	SECTION	COUNTY	TOTAL SHEETS	SHEET NO.
FAS 684 (CH-2)	10-00103-02-RS	EDGAR	41	10
EDGAR COUNTY, ILLINOIS		FED. AID PROJECT		

CONTRACT NO. 91471

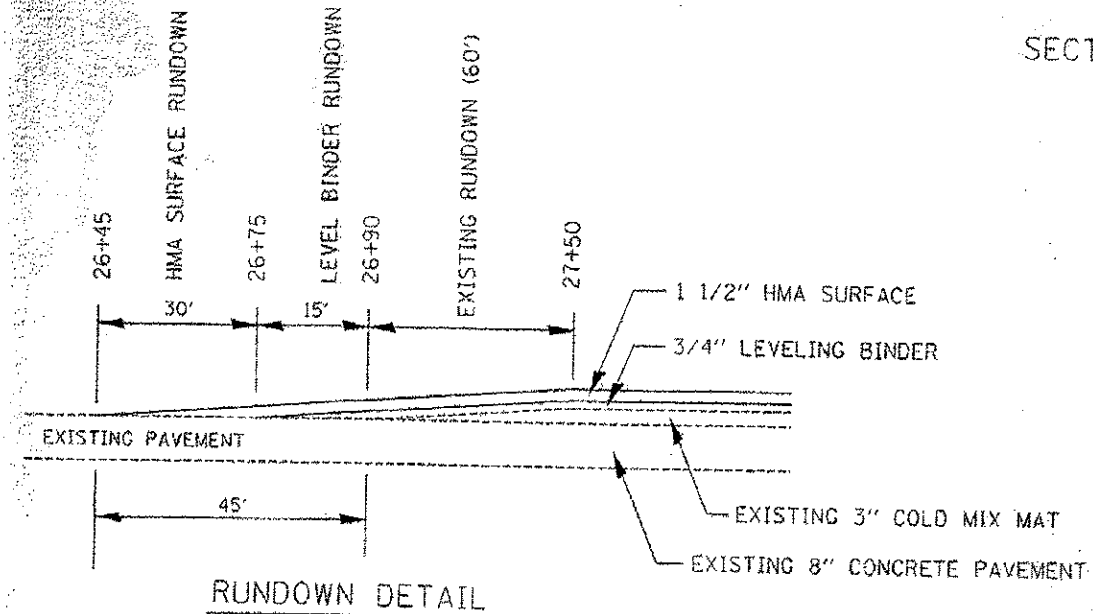
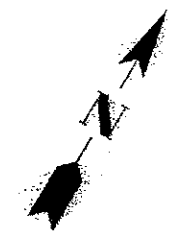

RUNDOWN DETAIL

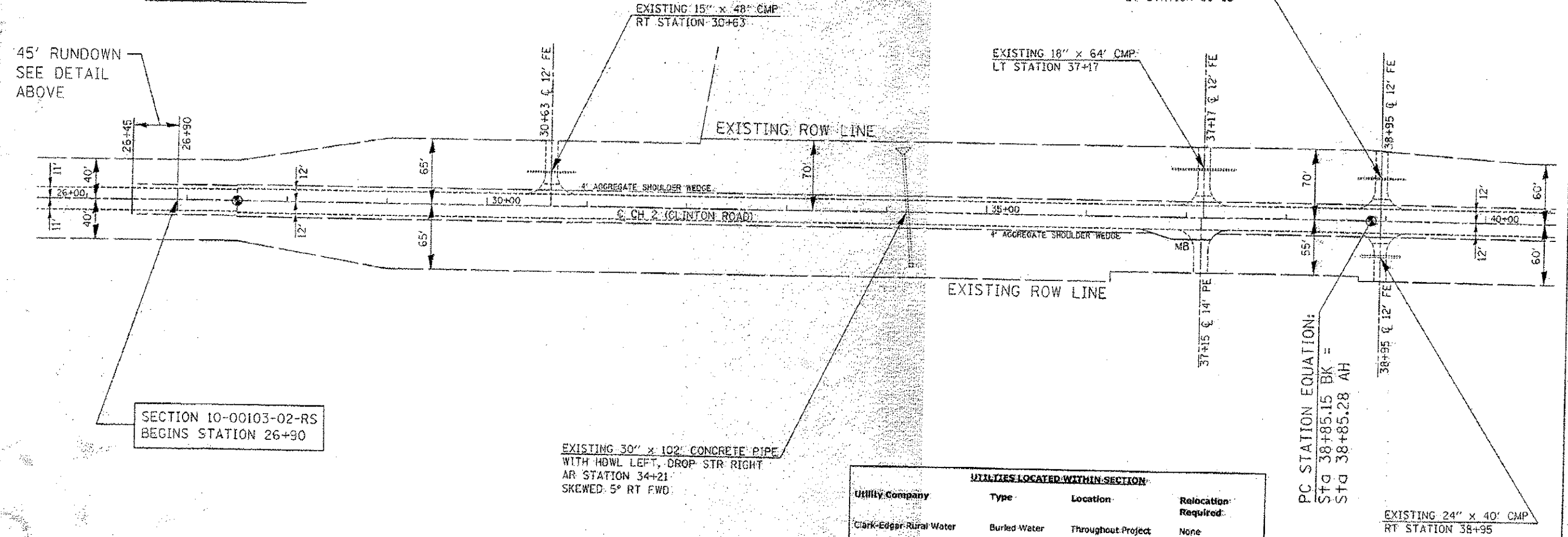

45' RUNDOWN  
SEE DETAIL  
ABOVE

SECTION 10-00103-02-RS  
BEGINS STATION 26+90

EXISTING 30" x 102' CONCRETE PIPE  
WITH HOWL LEFT, DROP STR. RIGHT  
AR STATION 34+21  
SKEWED 5° RT FWD.

PC STATION EQUATION:  
STG 38+85.15 BK =  
STG 38+85.28 AH

UTILITIES LOCATED WITHIN SECTION			
Utility Company	Type	Location	Relocation Required
Clark-Edgar Rural Water	Buried Water	Throughout Project	None
Enerstar Power Corp.	Aerial Electric	Throughout Project	None
Frontier Communications	Aerial Telephone	Throughout Project	None
Midwestern Gas Trans.	Buried Gas Main	Station 228+10	None

EXISTING 24" x 40' CMP  
RT STATION 38+95

SCALE: 1"=50'

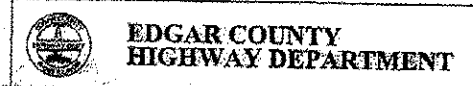

SECTION 29, T. 14 N., R. 11 W., 2nd P.M.