

Benchmark: B.M. W-63, chiseled "□" on northwest corner of bridge on curb. Elev. 370.781 NAVD

Existing structure: S.N. 035-0012 built 1952 as F.A. Route 35, Section 11-B-1 at station 228+28 as a 3-span reinforced concrete T-beam (haunched) bridge. 122'-0" back-to-back abutments, 34'-2 1/2" out-to-out, supported on steel piles. Partial concrete deck removal in 1990 with 2 1/2" PPC overlay. Existing bridge to be removed and replaced. Traffic maintained utilizing stage construction.

No salvage.

INDEX OF SHEETS

- 1 General Plan & Elevation
- 2 General Data
- 3 Stage Construction & Temporary Sheet Piling Details
- 4 Temporary Concrete Barrier for Stage Construction
- 5-6 Top of Slab Elevations
- 7 Top of West Approach Slab Elevations
- 8 Top of East Approach Slab Elevations
- 9 Superstructure
- 10 Superstructure Details
- 11 Integral Abutment Diaphragm Details
- 12-13 Bridge Approach Slab Details
- 14 Structural Steel
- 15 Structural Steel Details
- 16 West Abutment
- 17 East Abutment
- 18 Bar Splicer Assembly Details
- 19 HP Pile Details
- 20-21 Soil Boring Logs

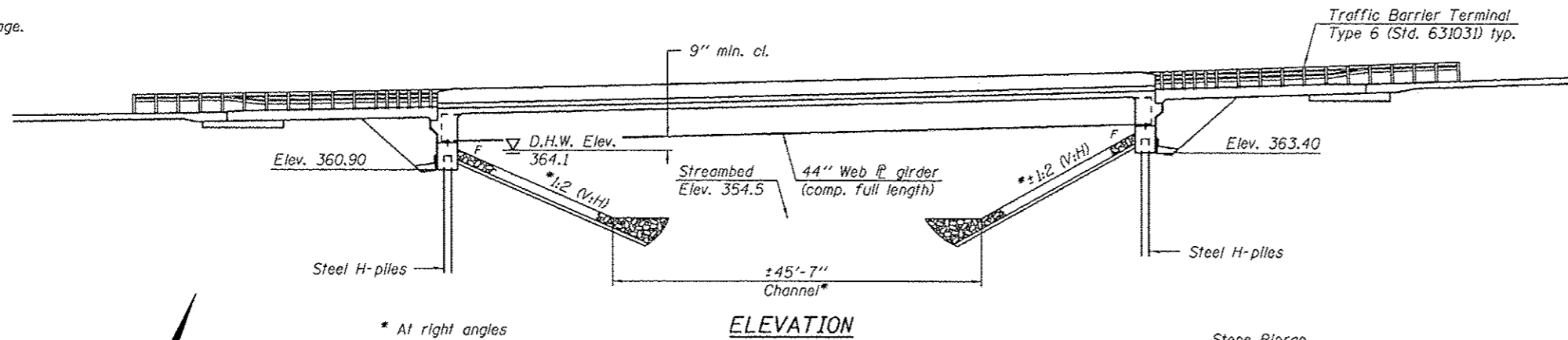

ELEVATION

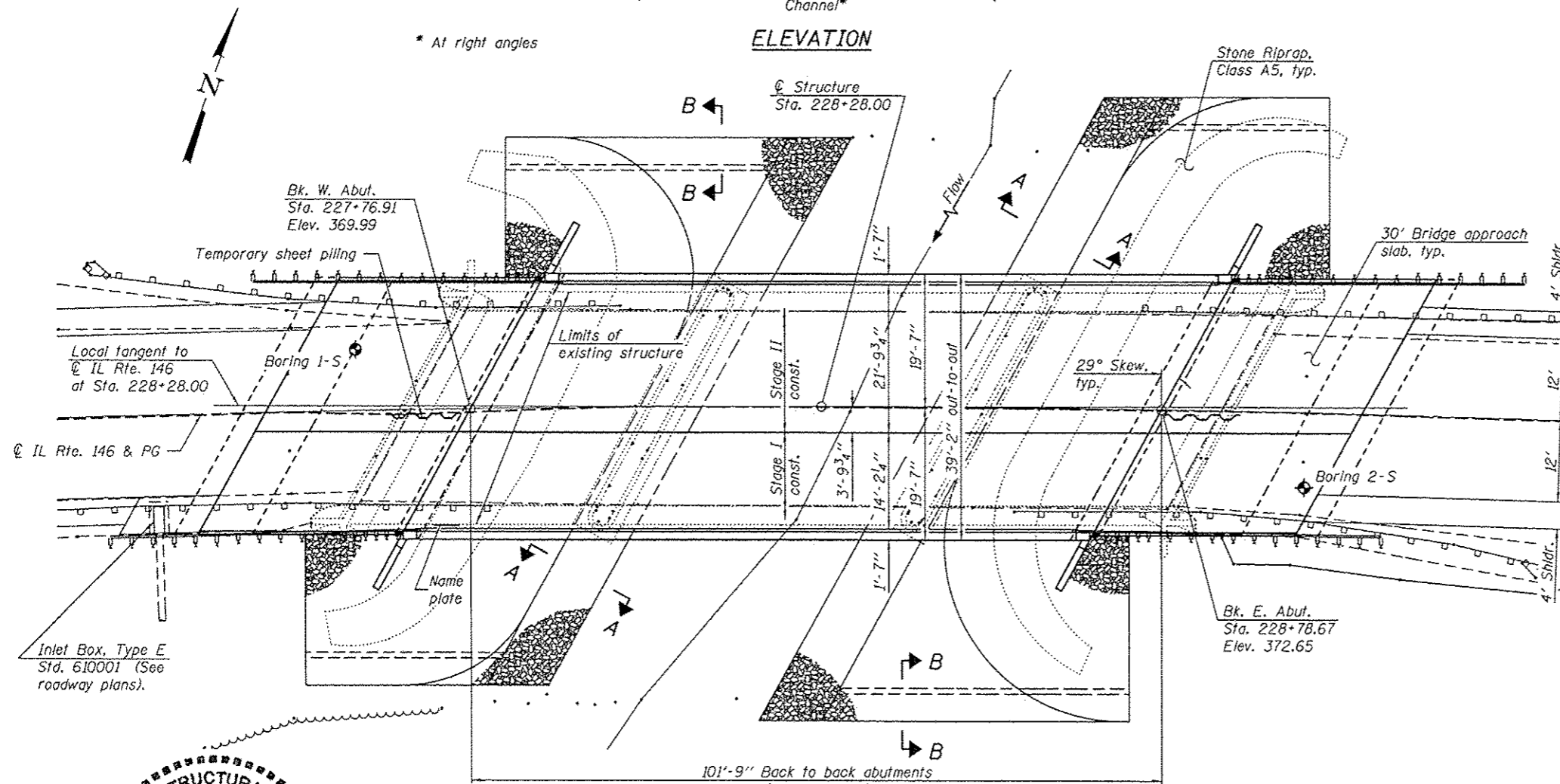

PLAN

STATION 228+28.00
BUILT 20 BY
STATE OF ILLINOIS
F.A.P. RTE. 885 SEC. 11B-1
LOADING HL-93
STRUCTURE NO. 035-0016

NAME PLATE
See Std. 515001

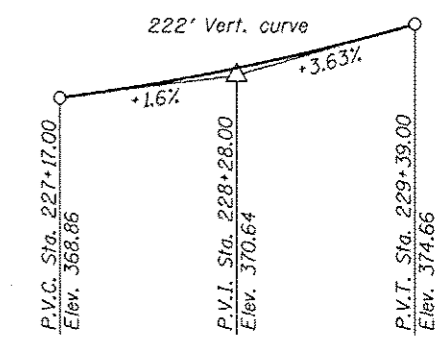

PROFILE GRADE
(Along centerline of roadway)

DESIGN SPECIFICATIONS

2010 AASHTO LRFD Bridge Design Specifications with 2010 Interims

DESIGN STRESSES

FIELD UNITS

- $f'_c = 3,500$ psi
- $f_y = 60,000$ psi (Reinforcement)
- $f_y = 50,000$ psi (M270 Grade 50)
- $f_y = 36,000$ psi (M270 Grade 36)

LOADING HL-93

Allow 50#/sq. ft. for future wearing surface.

SEISMIC DATA

- Seismic Performance Zone (SPZ) = 3
- Design Spectral Acceleration at 1.0 sec. (S_{D1}) = 0.334
- Design Spectral Acceleration at 0.2 sec. (S_{D5}) = 0.785
- Soil Site Class = D

WATERWAY INFORMATION

Drainage Area = 5.38 mi

Flood	Freq. Yr.	C.F.S.	Opening Sq. Ft.		Nat. H.W.E.		Head - Ft.		Headwater El.	
			Exist.	Prop.	Exist.	Prop.	Exist.	Prop.	Exist.	Prop.
Design	50	3860	401.0	491.0	362.9	0.6	0.2	363.5	363.1	
Base	100	4460	516.0	616.0	364.5	1.2	0.4	365.7	364.9	
Max. Calc.	500	6050	602.0	705.0	365.6	1.8	0.7	367.4	366.3	

Exist. Low Grade Elev. 367.30 @ Sta. 225+50
Prop. Low Grade Elev. 367.30 @ Sta. 225+50

DESIGN SCOUR ELEVATION TABLE

Design Scour Elevation (ft.)	W. Abut.	E. Abut.
	360.90	363.40

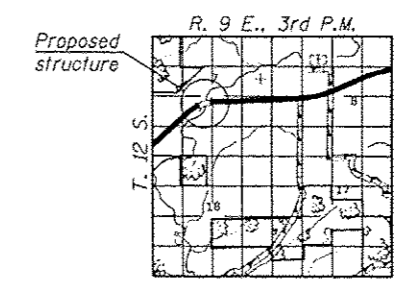

LOCATION SKETCH

GENERAL PLAN & ELEVATION
ILLINOIS ROUTE 146 OVER
PETERS CREEK
F.A.P. RTE. 885 - SEC. 11B-1
HARDIN COUNTY
STATION 228+28.00
STRUCTURE NO. 035-0016



Expires 11/30/14