

FABRICATED TOP OF BEAM ELEVATION TABLE

Location	Beam No. 1	Beam No. 2	Beam No. 3	Beam No. 4	Beam No. 5	Beam No. 6	Beam No. 7
℄ Brg. S. Abut.	424.24	424.55	424.86	425.17	425.47	425.78	426.09
℄ Brg. N. Abut.	422.98	423.29	423.60	423.91	424.21	424.52	424.83

For fabrication use only.

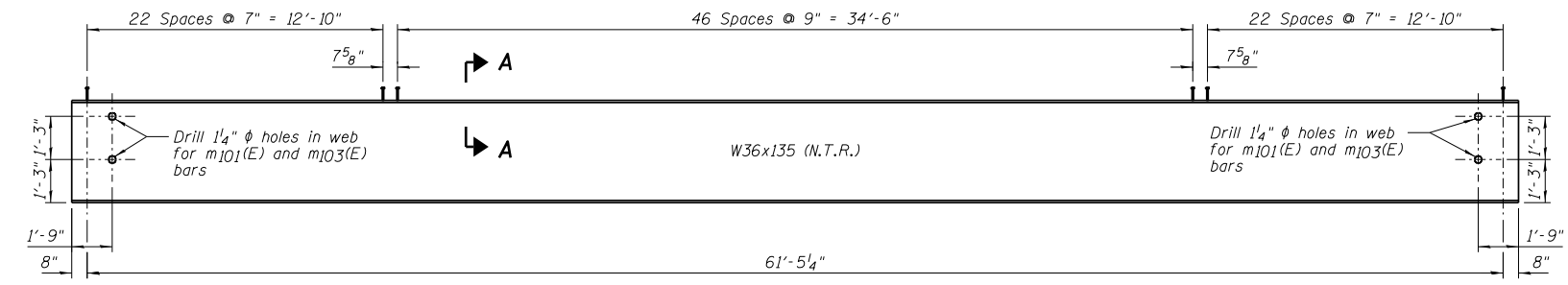

- NOTES:**
- See Sheet A26 for Diaphragm Details.
 - Load carrying components designated N.T.R. shall conform to the Impact Testing Requirements, Zone 2.
 - All diaphragms shall be installed as steel is erected and secured with erection pins and bolts except as otherwise noted. Individual diaphragms at supports may be temporarily disconnected to install bearing anchor rods.

Farnsworth GROUP, INC.
 2700 McGraw Drive
 Bloomington, Illinois 61704
 309-663-8435, 309-663-1571 fax

DESIGNED - TCR/JCZ	REVISION
CHECKED - JML	REVISION
DRAWN - DJM/JWK	REVISION
CHECKED - MSW	REVISION
DATE - 06/26/12	REVISION

**STATE OF ILLINOIS
 DEPARTMENT OF TRANSPORTATION**

**STRUCTURAL STEEL, SOUTHBOUND ROADWAY
 STRUCTURE NO. 082-0385 NB & 082-0386 SB**

SHEET NO. A24 OF 48 SHEETS

F.A.P. RTE.	SECTION	COUNTY	TOTAL SHEETS	SHEET NO.
788	520-1-2B	ST. CLAIR	94	55
ILLINOIS FED. AID PROJECT			CONTRACT NO. 76F69	