

See sheet 10 of 22 for scupper location relative to parapet.

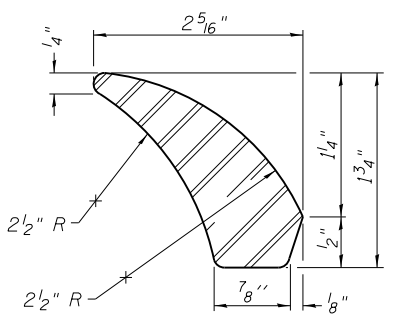
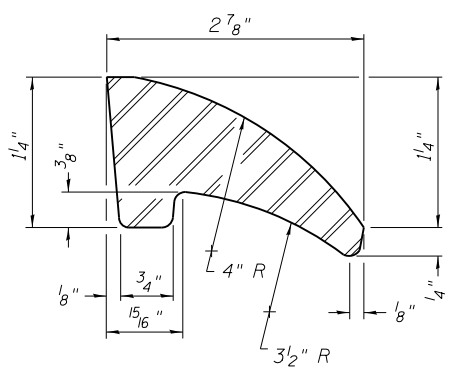

BILL OF MATERIAL

ITEM	UNIT	QUANTITY
Drainage Scupper, DS-33	Each	6

FILE NAME = \\c:\projects\116BR-1\116BR-1.dwg
 USER = sparksgw
 PLOT DATE = Oct-19-2012 02:14:52PM
 PROJECT NO. 108005-1

DS-33
 7-1-10
Coombe-Bloxdorf P.C.
 CIVIL ENGINEERS-
 STRUCTURAL ENGINEERS-
 LAND SURVEYORS
 Design Firm License No. 184-002703

USER NAME = sparksgw	DESIGNED - CME	REVISED -
PLOT SCALE = 0:2.0000 1' = 1/4"	CHECKED - MCB	REVISED -
PLOT DATE = Oct-19-2012 02:14:52PM	DRAWN - MML	REVISED -
	CHECKED - MCB	REVISED -

STATE OF ILLINOIS
DEPARTMENT OF TRANSPORTATION

DRAINAGE SCUPPER, DS-33
STRUCTURE NO. 059-0515
 SHEET NO. 14 OF 22 SHEETS

F.A.P. RTE. 325	SECTION 116BR-1	COUNTY MACOUPIN	TOTAL SHEETS 67	SHEET NO. 50
			CONTRACT NO. 72A19	
ILLINOIS FED. AID PROJECT				