

JOHN P. JOHNSON AS TRUSTEE, OF THE JOHN P. JOHNSON REVOCABLE LIVING TRUST AS TO UNDIVIDED 1/2 INTEREST;
 & ESTATE OF WANDA M. JOHNSON, DECEASED AS TO UNDIVIDED 1/2 INTEREST

PARCEL NO. 6238110A

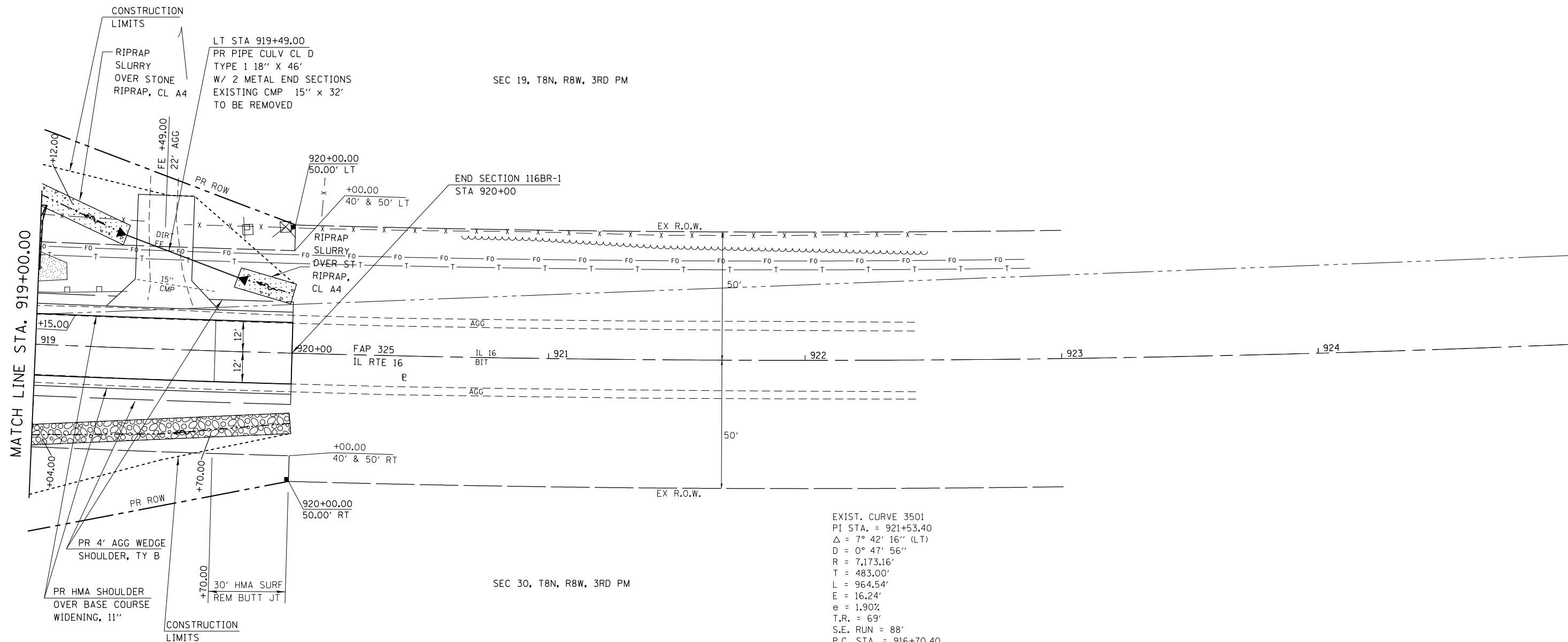
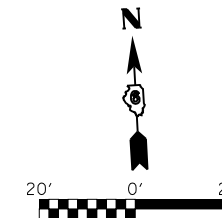

EXIST. CURVE 3501
 PI STA. = 921+53.40
 $\Delta = 7^\circ 42' 16''$ (LT)
 $D = 0^\circ 47' 56''$
 $R = 7,173.16'$
 $T = 483.00'$
 $L = 964.54'$
 $E = 16.24'$
 $e = 1.90\%$
 $T.R. = 69'$
 $S.E. RUN = 88'$
 $P.C. STA. = 916+70.40$
 $P.T. STA. = 926+34.94$
 ATTAIN SE STA 915+42.26 TO STA 916+99.73

JOHN P. JOHNSON AS TRUSTEE, OF THE JOHN P. JOHNSON REVOCABLE LIVING TRUST AS TO UNDIVIDED 1/2 INTEREST;
 & ESTATE OF WANDA M. JOHNSON, DECEASED AS TO UNDIVIDED 1/2 INTEREST

PARCEL NO. 6238110B

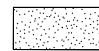
-  INDICATES LIMITS OF STONE RIPRAP CLASS A4
-  EXISTING RIPRAP - TBR COST INCLUDED IN COST FOR EARTH EX

| | | | |
|--|------------------------------------|------------|-----------|
| FILE NAME = | USER NAME = sparksgw | DESIGNED - | REVISED - |
| ct:\pw\work\p\id\sparksgw\0325252\d672\19-sht-023-plan-3.dgn | | DRAWN - | REVISED - |
| | PLOT SCALE = 40.000000' / in. | CHECKED - | REVISED - |
| CB PROJECT NO | PLOT DATE = Oct-19-2012 02:14:15PM | DATE - / / | REVISED - |

STATE OF ILLINOIS
 DEPARTMENT OF TRANSPORTATION

PLAN - IL 16

SCALE: SHEET NO. 3 OF 3 SHEETS STA. 919+00 TO STA. 924+00

CB Coombe-Bloxdorf P.C.
 - CIVIL ENGINEERS -
 - STRUCTURAL ENGINEERS -
 - LAND SURVEYORS -
 Design Firm License No. 184-002703

| F.A.P. RTE. | SECTION | COUNTY | TOTAL SHEETS | SHEET NO. |
|---------------------------|---------|----------|--------------|--------------------|
| 325 | 116BR-1 | MACOUPIN | 67 | 23 |
| | | | | CONTRACT NO. 72A19 |
| ILLINOIS FED. AID PROJECT | | | | |