

DATE	
BY	
FINISHED SURVEY	
PLOTTED	
TEMPLATE	
AREAS CHECKED	
NO.	

DATE	
BY	
ORIGINAL SURVEY	
PLOTTED	
TEMPLATE	
AREAS CHECKED	
NO.	

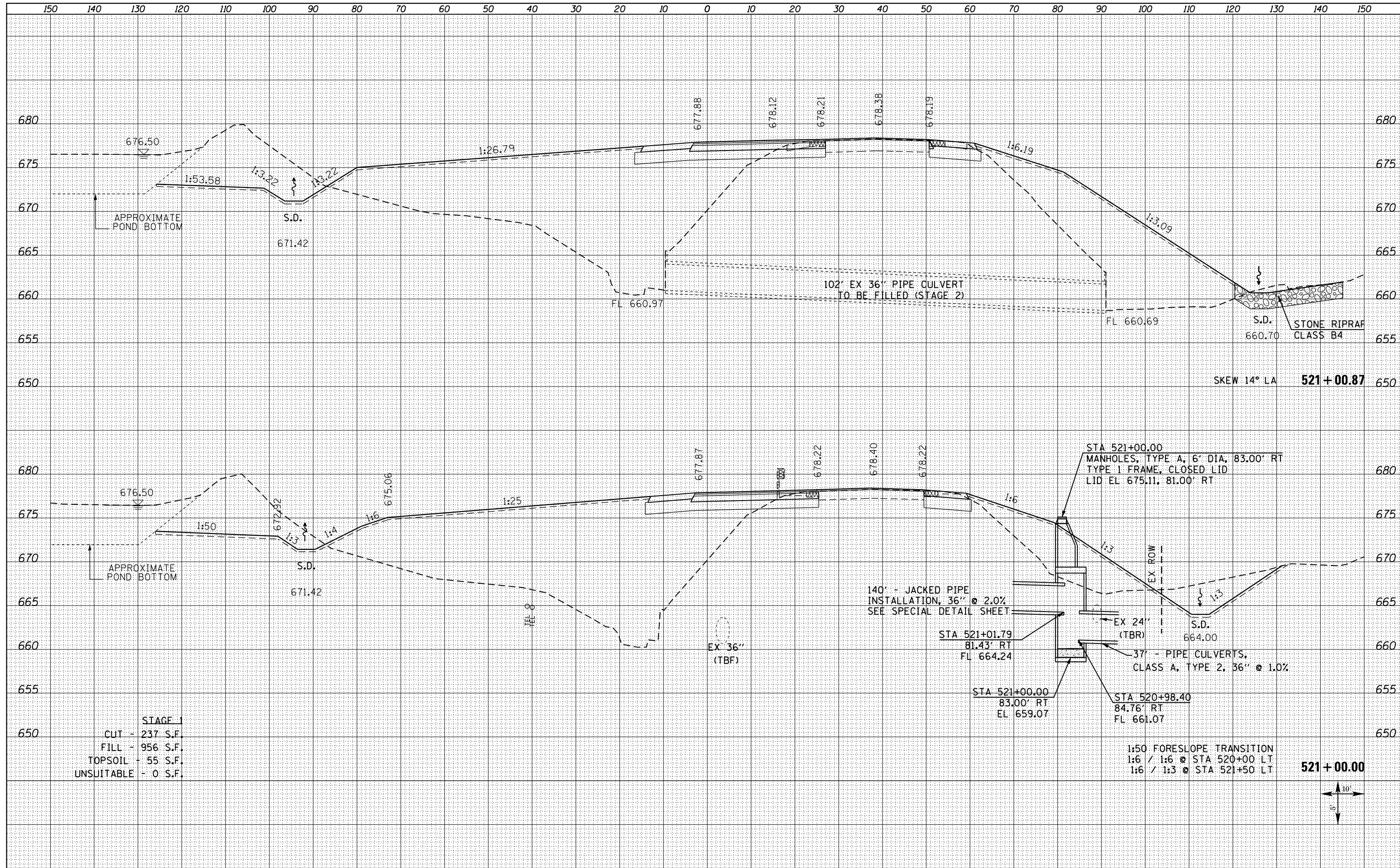

STAGE 1
 CUT - 237 S.F.
 FILL - 956 S.F.
 TOPSOIL - 55 S.F.
 UNSUITABLE - 0 S.F.

140' - JACKED PIPE
 INSTALLATION, 36" @ 2.0%
 SEE SPECIAL DETAIL SHEET

STA 521+00.00
 MANHOLES, TYPE A, 6' DIA, 83.00' RT
 TYPE 1 FRAME, CLOSED LID
 LID EL 675.11, 81.00' RT

STA 521+01.79
 81.43' RT
 FL 664.24

37' - PIPE CULVERTS,
 CLASS A, TYPE 2, 36" @ 1.0%

STA 521+00.00
 83.00' RT
 EL 659.07

STA 520+98.40
 84.76' RT
 FL 661.07

1:50 FORESLOPE TRANSITION
 1:6 / 1:6 @ STA 520+00 LT
 1:6 / 1:3 @ STA 521+50 LT

521 + 00.00

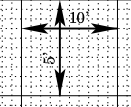

FILE NAME =
 D468409-SHT-XSHT-US34-A.dgn

USER NAME = danw
 DESIGNED -
 DRAWN -
 CHECKED -
 DATE -

REVISOR -
 REVISION -
 REVISION -
 REVISION -

STATE OF ILLINOIS
 DEPARTMENT OF TRANSPORTATION

CROSS SECTIONS
 US ROUTE 34

SCALE: NOTED SHEET NO. 13 OF 209 SHEETS STA. 521+00.00 TO STA. 521+00.87

F.A.P. RTE.	SECTION	COUNTY	TOTAL SHEETS	SHEET NO.
313	7-2 ; 6-1	HENDERSON	976	588
CONTRACT NO. 68409			ILLINOIS FED. AID PROJECT	