

Notes:
 See sheet 13 of 23 for Sections C-C & D-D and View E-E.
 $a_5(E)$ and $a_6(E)$ bar spacings measured along \varnothing Rdwy.
 See sheet 9 of 23 for median details.
 Concrete and reinforcement in median on approaches are billed on sheet 13 of 23.

*** Cost included with Concrete Superstructure.

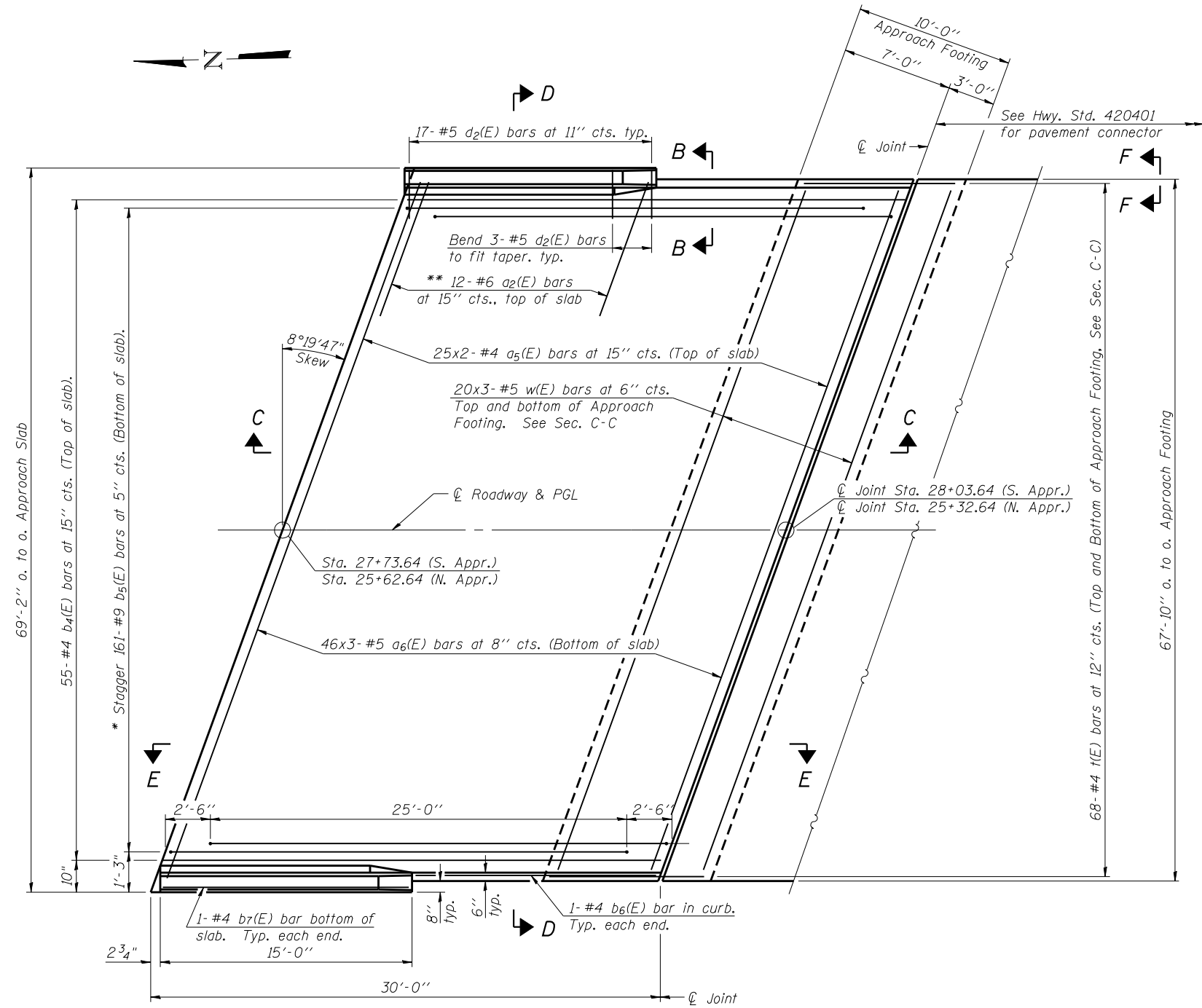

PLAN - S. APPROACH
 (N. Approach similar)

* Tilt #9 $b_5(E)$ bars as required to maintain clearance.
 ** Space between $a_5(E)$ bars, typ. each parapet.

MIN. BAR LAP
 #4 = 2'-4"
 #5 = 2'-7"

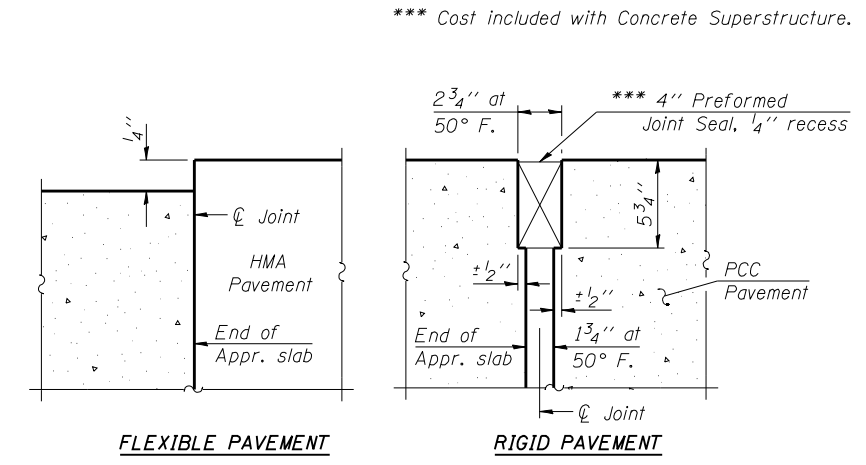

DETAIL A

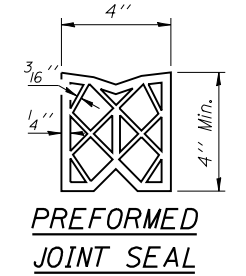

PREFORMED JOINT SEAL

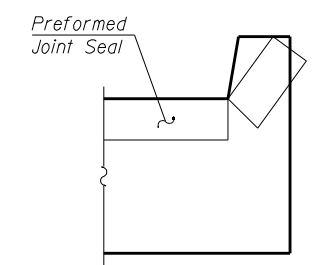

VIEW F-F

Angle Preformed Joint Seal at 45° at curbs when req'd for drainage.

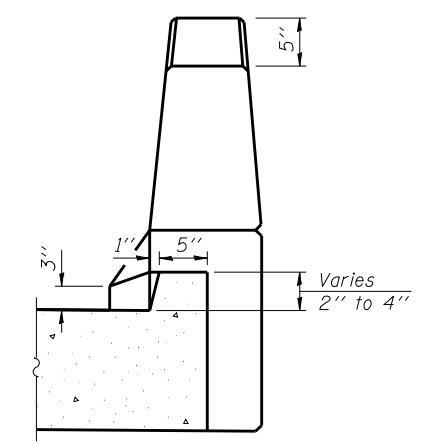

VIEW B-B

FILE NAME = E:\09-09-012-ppr-slab-sdgn
 CB PROJECT NO. 04065

BA-L

1-27-12

Coombe-Bloxdorf P.C.
 CIVIL ENGINEERS-
 STRUCTURAL ENGINEERS-
 LAND SURVEYORS-
 Design Firm License No. 184-002703

USER NAME = .MML.	DESIGNED - RKM	REVISED -
PLOT SCALE = 0/2' = 1/4" IN.	CHECKED -	REVISED -
PLOT DATE = 11/28/2012	DRAWN - MML	REVISED -
	CHECKED - MCB	REVISED -

STATE OF ILLINOIS
DEPARTMENT OF TRANSPORTATION

BRIDGE APPROACH SLAB DETAILS
STRUCTURE NO. 036-0065

SHEET NO. 12 OF 23 SHEETS

F.A.P. RTE.	SECTION	COUNTY	TOTAL SHEETS	SHEET NO.
534	7-2, 6-1	HENDERSON	976	510
CONTRACT NO. 68409				
ILLINOIS FED. AID PROJECT				

(Sheet 1 of 2)