

- (A) 60' CONC GUTTER, TYPE A
STA 69+65.0, 25.0' RT, FL 676.85 TO
STA 69+80.0, 25.0' RT, FL 676.25 TO
STA 70+25.0, 25.0' RT, FL 677.00
- (B) STONE RIPRAP, CLASS B3
BEHIND CURB
L100' X W8'
- (C) FORESLOPE TRANSITION
MEASURE ALONG B-6.24 CURB
1:2 @ STA 69+65.00 RT
1:2 @ STA 70+25.00 RT
1:3 @ STA 70+75.00 RT
1:4 @ STA 71+00.00 RT

SA-EX STA 70+85.27, 107.55' RT
MAN TA 3' DIA T8G
TO BE REMOVED
GRATE EL = 676.43
SE INV = 673.43 (EX 8" RCP)
W INV = 665.93 (EX 18" RCP)
S INV = 659.43 (EX 24" CSP)
N INV = 659.43 (EX 4' X 4' RCB)

SA-1 STA 70+85.27, 107.55' RT
MAN TA 6' DIA T1F OL
GRATE EL = 676.43
SE INV = 673.43 (EX 8" CSP)
W INV = 663.61 (PR 24" RCP)
S INV = 659.43 (EX 24" CSP)
N INV = 659.43 (EX 4' X 4' RCB)

SA-2 STA 70+81.16, 14.32' RT
MAN TA 5' DIA T1F CL
LID EL = 679.47
W INV = 671.54
S INV = 665.62
E INV = 665.37

SA-3 STA 69+12.00, 13.00' RT
INLET-MAN 5' DIA TY G-1 (SPECIAL)
GRATE EL = 678.67
SW INV = 673.42
E INV = 671.95
N INV = 668.95

SB-1 STA 70+79.12, 32.05' LT
INLET-MAN 4' DIA TY G-1 (SPECIAL)
GRATE EL = 679.67
S INV = 672.63
E INV = 672.38

SB-2 STA 70+40.00, 36.50' LT
INLETS TA T8G
GRATE EL = 676.00
N INV = 673.00

SC-EX STA 70+79.40, 25.76' LT
EX DROP INLET, TY 3
TO BE REMOVED
GRATE EL = 679.29
S INV = 672.59 (18" CSP)
E INV = 672.59 (18" RCP)

SC-1 STA 69+12.00, 30.30' RT
MAN TA 4' DIA T8G
GRATE EL = 676.50
N INV = 672.37
S INV = 672.44
W INV = 672.30

SC-2 STA 68+46.50, 30.40' RT
INLETS TA T8G
GRATE EL = 676.00
N INV = 673.25

SC-3 STA 69+80.00, 25.00' RT
INLETS TA T8G
GRATE EL = 676.25
S INV = 673.10

SC-4 STA 68+79.40, 13.00' LT
INLET-MAN 4' DIA, TY G-1 (SPECIAL)
GRATE EL = 678.73
S INV = 674.54
NE INV = 674.22

SC-5 STA 68+73.30, 13.00' LT
INLET-MAN 4' DIA, TY G-1 (SPECIAL)
GRATE EL = 678.73
N INV = 674.86

- PA-EX 133' - STORM SEW, CL A 1, 18" @ 2.00%
TO BE REMOVED
- PB-EX 398' - STORM SEW, CSP, 24" @ 1.75%
- PA-1 90' - STORM SEW, T1, WMQ, 24" @ 2.00%
- PA-2 166' - STORM SEW, T1, WMQ, 24" @ 2.00%
- PB-1 43' - STORM SEW, T1, WMQ, 18" @ 2.00%
- PB-2 36' - STORM SEW, T1, WMQ, 12" @ 1.00%
- PC-1 12' - STORM SEW, T1, WMQ, 12" @ 2.00%
- PC-2 62' - STORM SEW, T1, WMQ, 12" @ 1.29%
- PC-3 65' - STORM SEW, T1, WMQ, 12" @ 0.95%
- PC-4 40' - STORM SEW, T1, WMQ, 18" @ 2.00%
- PC-5 3' - STORM SEW, T1, WMQ, 12" @ 8.00%

• WMQ - WATER MAIN QUALITY

MATCH LINE STA. 67+00 TR 150 (1700 E)

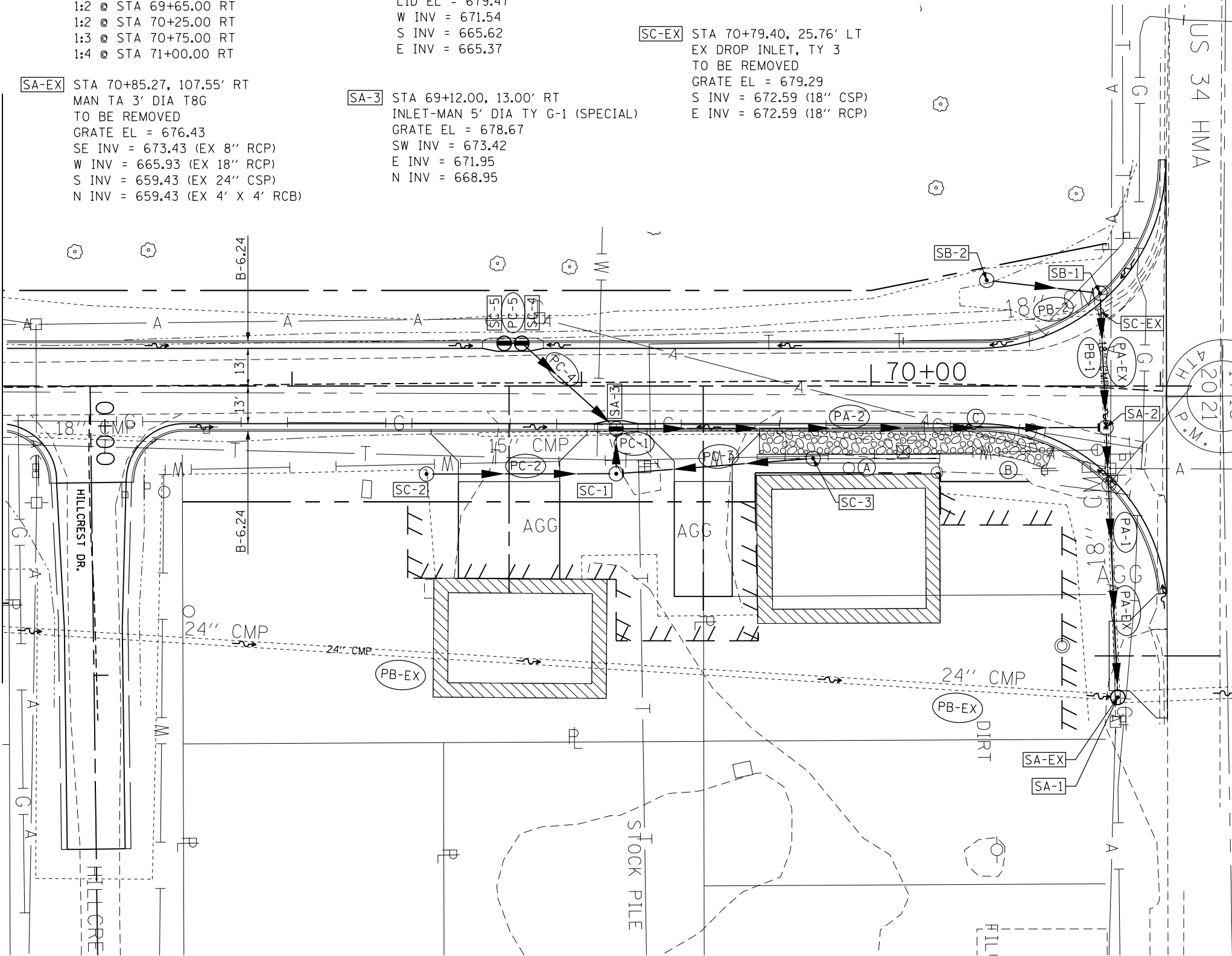

FILE NAME = D468409-SHT-4B-DRAIN-TR150-03A.dgn	USER NAME = zachl	DESIGNED - DBS	REVISED -	STATE OF ILLINOIS DEPARTMENT OF TRANSPORTATION	DRAINAGE PLAN VIEW TR 150 (1700E)			F.A.P. RTÉ. 313	SECTION 7-2 ; 6-1	COUNTY HENDERSON	TOTAL SHEETS 976	SHEET NO. 323
	PLOT SCALE = 48.0000' / in.	CHECKED - CSB	REVISED -		SCALE: 1" = 20'	SHEET NO. 48 OF 61 SHEETS	STA. 67+00 TO STA. 71+10.77	CONTRACT NO. 68409				
PLOT DATE = 10/16/2012	DATE = 10/2012	REVISED -	REVISED -	ILLINOIS FED. AID PROJECT								