

PLAN	SURVEYED	BY	DATE
	PLOTTED		
	NOTE BOOK		
	NO.		
	CHECKED		
	FILE NAME		

PROFILE	SURVEYED	BY	DATE
	GRADES CHECKED		
	STRUCTURE		
	NOTATIONS		
	NO.		

- 66 58' PIPE CULVERTS, CLASS A, TYPE 2, 42" 2 PRCFES 42" USFL = 679.18', 43+55.00, 38.00' LT DSFL = 678.84', 43+55.00, 36.00' RT
- A STONE RIPRAP CLASS B4 L20' X W20'
- B STONE RIPRAP CLASS B5 L28' X W31.5'
- C STONE RIPRAP CLASS B4 L20' X W22'

- 67 67' PIPE CULVERTS, CLASS D, TYPE 2, 18" 2 MFES 18" USFL = 681.96', 45+12.65, 31.26' RT DSFL = 680.62', 44+45.61, 36.07' RT

- 68 60' PIPE CULVERTS, CLASS D, TYPE 1, 42" 2 MFES 42" USFL = 680.22', 45+08.00, 37.64' LT DSFL = 679.68', 44+48.00, 40.63' LT

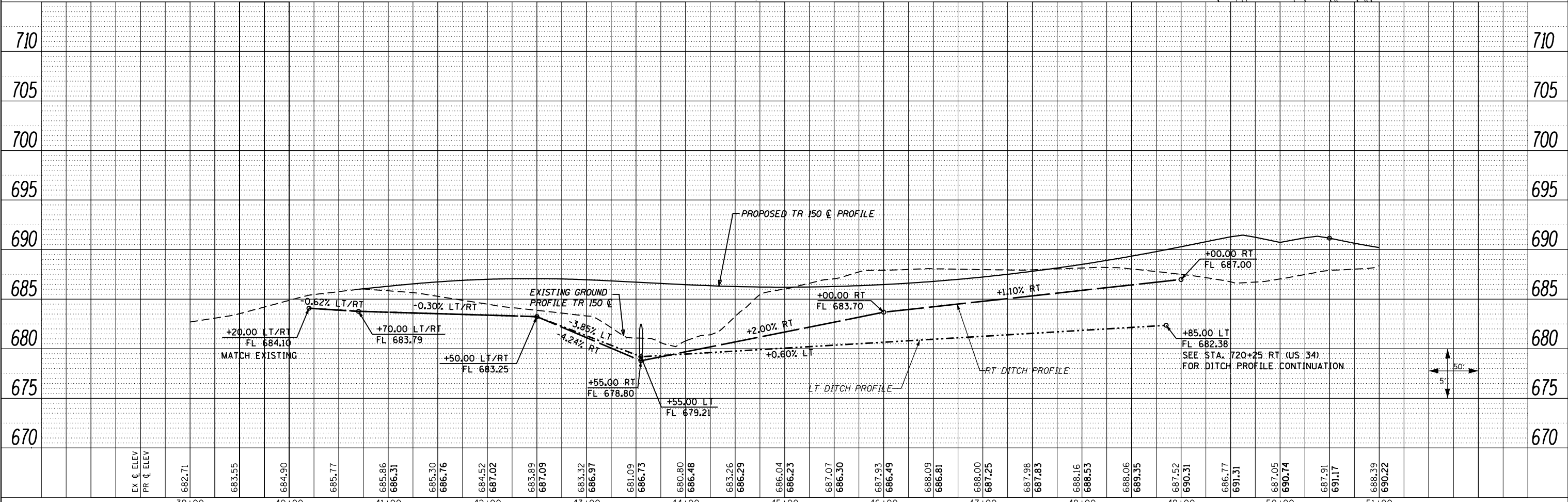
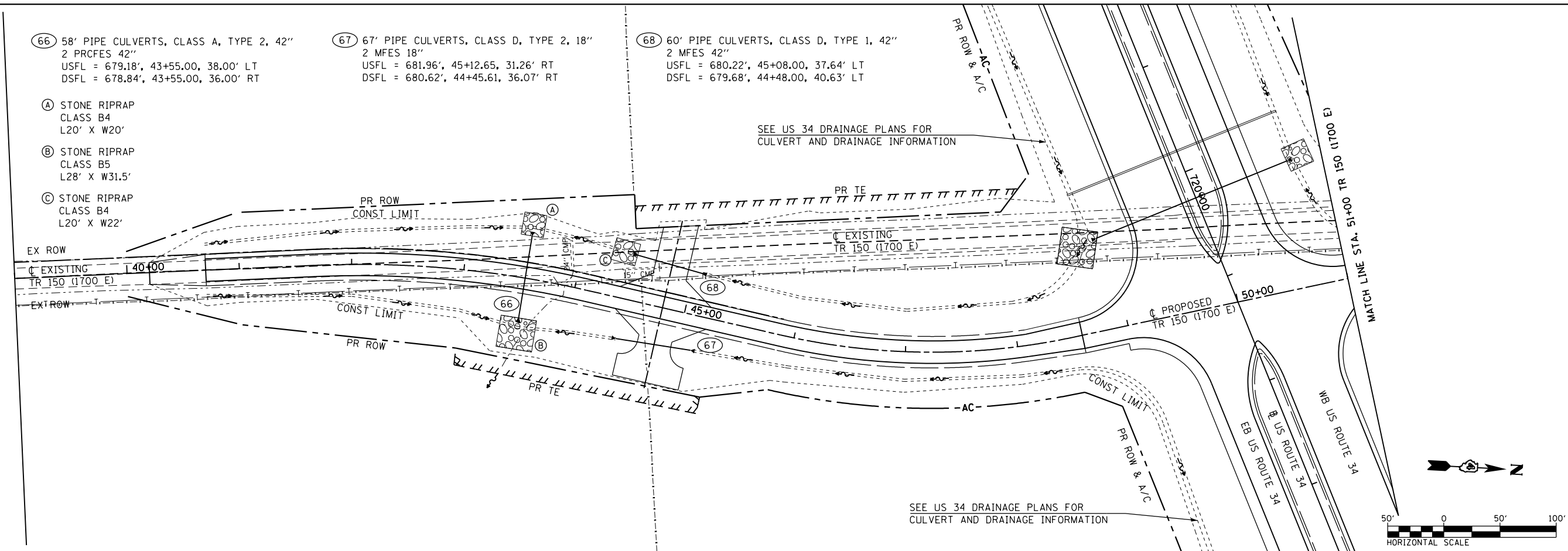

FILE NAME =	USER NAME = zech1	DESIGNED - DBS	REVISED -	STATE OF ILLINOIS DEPARTMENT OF TRANSPORTATION	DRAINAGE PLAN AND PROFILE TR 150 (1700 E)	F.A.P. RT. = 313	SECTION = 7-2 ; 6-1	COUNTY = HENDERSON	TOTAL SHEETS = 976	SHEET NO. = 320	
D468409-SHT-45-DRAIN-TR150-01.dgn	PLOT SCALE = 100.0000' / 1" =	DRAWN - PSBA	REVISED -			SCALE: 1" = 50'	SHEET NO. 45 OF 61 SHEETS	STA. 39+00	TO STA. 51+00	CONTRACT NO. 68409	
	PLOT DATE = 10/16/2012	CHECKED - CSB	REVISED -			ILLINOIS FED. AID PROJECT					
		DATE = 10/2012	REVISED -								