

MATCHLINE STA 60+00

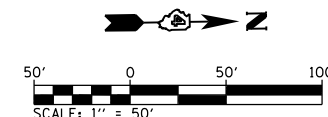
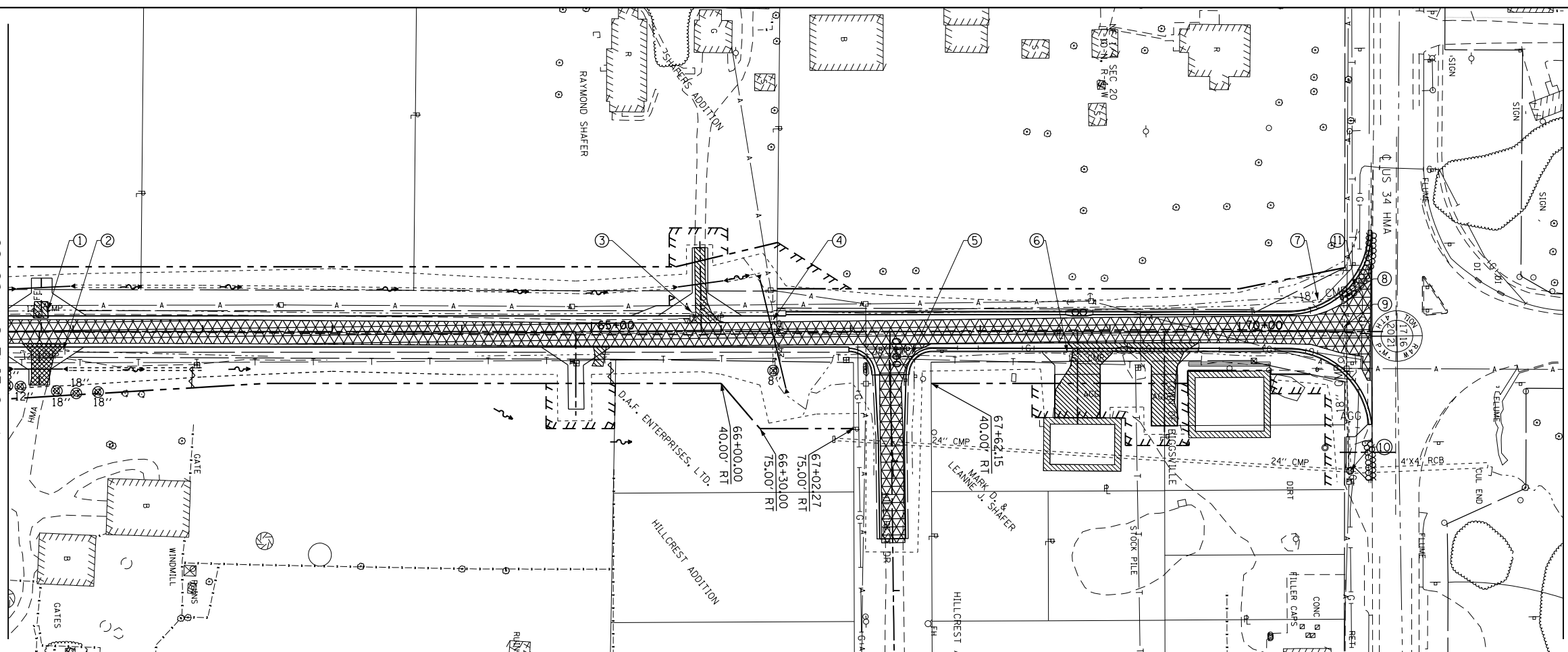

SEE SHEET 1 OF 28
FOR REMOVAL LEGEND

- | | |
|--|--|
| ① PIPE CULVERT REMOVAL
14' - 12" CMP | ⑦ PIPE CULVERT REMOVAL
22' - 18" CMP |
| ② PIPE CULVERT REMOVAL
38' - 12" CMP | ⑧ REMOVAL OF EXISTING STRUCTURE No. 9
SEE SPECIAL PROVISIONS |
| ③ PIPE CULVERT REMOVAL
24' - 15" CMP | ⑨ PIPE CULVERT REMOVAL
133' - 18" RCP |
| ④ PIPE CULVERT REMOVAL
36' - 24" CMP | ⑩ REMOVAL OF EXISTING STRUCTURE No. 10
SEE SPECIAL PROVISIONS |
| ⑤ PIPE CULVERT REMOVAL
40' - 18" CMP | ⑪ 62' - GUTTER REMOVAL |
| ⑥ PIPE CULVERT REMOVAL
104' - 15" CMP | |

FILE NAME =
D468409-SHT-REM-024-TR150.dgn

USER NAME = zach1

DESIGNED - DBS

REVISED -

DRAWN - PSBA

REVISED -

PLOT SCALE = 100.0000' / in.

CHECKED - CSB

REVISED -

PLOT DATE = 10/16/2012

DATE - 10/2012

REVISED -

**STATE OF ILLINOIS
DEPARTMENT OF TRANSPORTATION**

**REMOVAL PLAN
TR 150 (1700 E)**

SCALE: 1" = 50'

SHEET NO. 24 OF 28 SHEETS

STA. 60+00 TO STA. 71+02

F.A.P. RTE. SECTION COUNTY TOTAL SHEETS SHEET NO.

313 7-2; 6-1 HENDERSON 976 130

CONTRACT NO. 68409

ILLINOIS FED. AID PROJECT