

- ① 120' - FENCE REMOVAL
- ② PIPE CULVERT REMOVAL
30' - 18" CMP
- ③ 860' - FENCE REMOVAL
- ④ 2' x 2' BOX CULVERT
HEADWALL REMOVAL

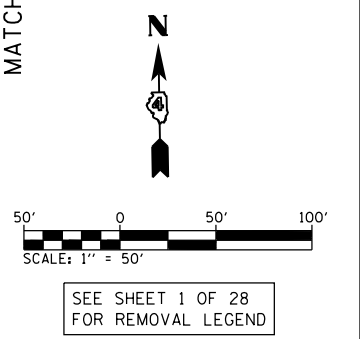
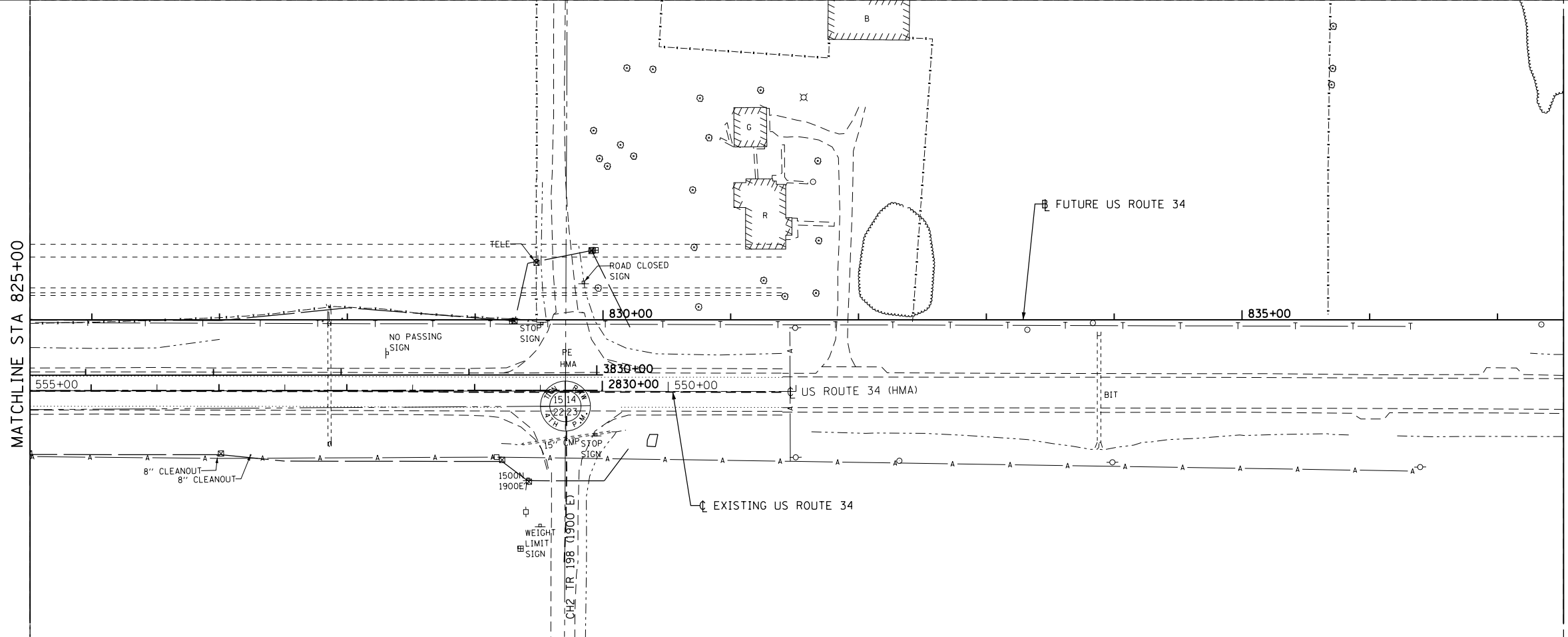
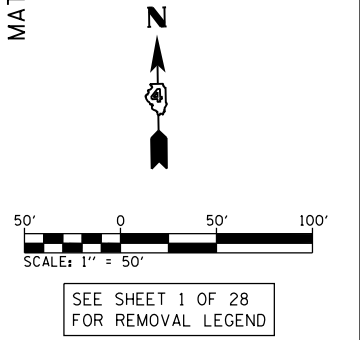

FILE NAME =
D468409-SHT-REM-014-US34.dgn

USER NAME = zachl
PLOT SCALE = 100.0000' / in.
PLOT DATE = 10/16/2012

DESIGNED - DBS
DRAWN - PSBA
CHECKED - CSB
DATE - 10/2012

REVISED -
REVISED -
REVISED -
REVISED -

**STATE OF ILLINOIS
DEPARTMENT OF TRANSPORTATION**

**REMOVAL PLANS
US ROUTE 34**

SCALE: SHEET NO. 14 OF 28 SHEETS STA. 813+00 TO STA. 837+00

F.A.P. RTE.	SECTION	COUNTY	TOTAL SHEETS	SHEET NO.
313	7-2 ; 6-1	HENDERSON	976	120
CONTRACT NO. 68409				
ILLINOIS FED. AID PROJECT				