

MATCHLINE STA 645+00

MATCHLINE STA 657+00

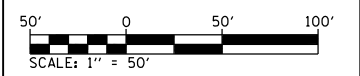

SEE SHEET 1 OF 28 FOR REMOVAL LEGEND

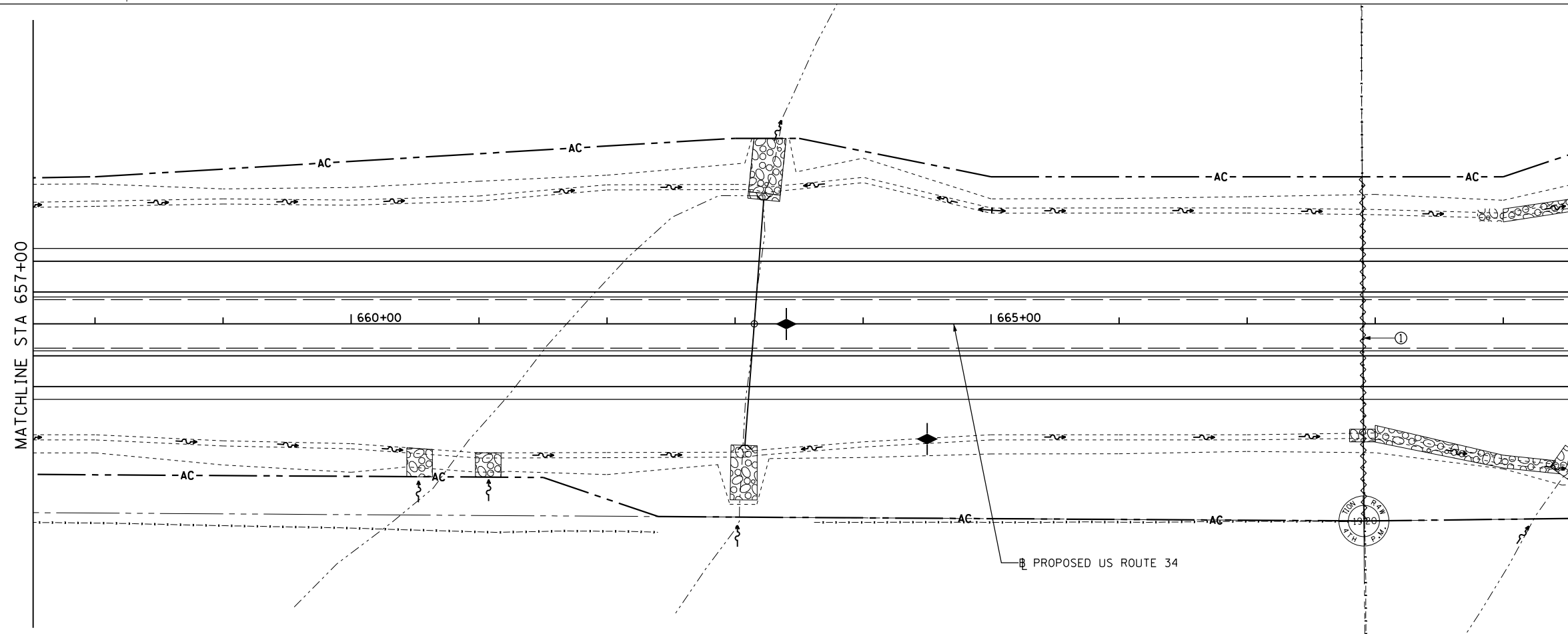

MATCHLINE STA 657+00

MATCHLINE STA 669+00

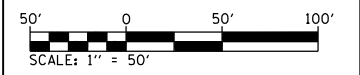

SEE SHEET 1 OF 28 FOR REMOVAL LEGEND

① 270' FENCE REMOVAL

FILE NAME = D468409-SHT-REM-07-US34.dgn	USER NAME = zach1	DESIGNED - DBS	REVISED -
		DRAWN - PSBA	REVISED -
		CHECKED - CSB	REVISED -
		DATE - 10/2012	REVISED -

**STATE OF ILLINOIS
DEPARTMENT OF TRANSPORTATION**

**REMOVAL PLANS
US ROUTE 34**

SCALE: SHEET NO. 7 OF 28 SHEETS STA. 645+00 TO STA. 669+00

F.A.P. RTE. 313	SECTION 7-2 ; 6-1	COUNTY HENDERSON	TOTAL SHEETS 976	SHEET NO. 113
CONTRACT NO. 68409				
ILLINOIS FED. AID PROJECT				