

PLAN	SURVEYED	BY	DATE
	PLOTTED		
	CHECKED		
	FILE NAME		
	NO.		

PROFILE	SURVEYED	BY	DATE
	PLOTTED		
	CHECKED		
	NOTATIONS		
	NO.		

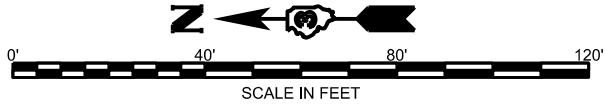

EXIST. CURVE 115-6-2  
 P.I. STA. = 1746+99.97  
 $\Delta = 1^\circ 25' 52''$  (RT)  
 $D = 0^\circ 10' 44''$   
 $R = 32,024.17'$   
 $T = 400.00'$   
 $L = 799.96'$   
 $E = 2.50'$   
 $e =$   
 T.R. =  
 S.E. RUN =  
 P.C. STA. = 1742+99.97  
 P.T. STA. = 1750+99.92

= HMA SURFACE REMOVAL VARIABLE DEPTH

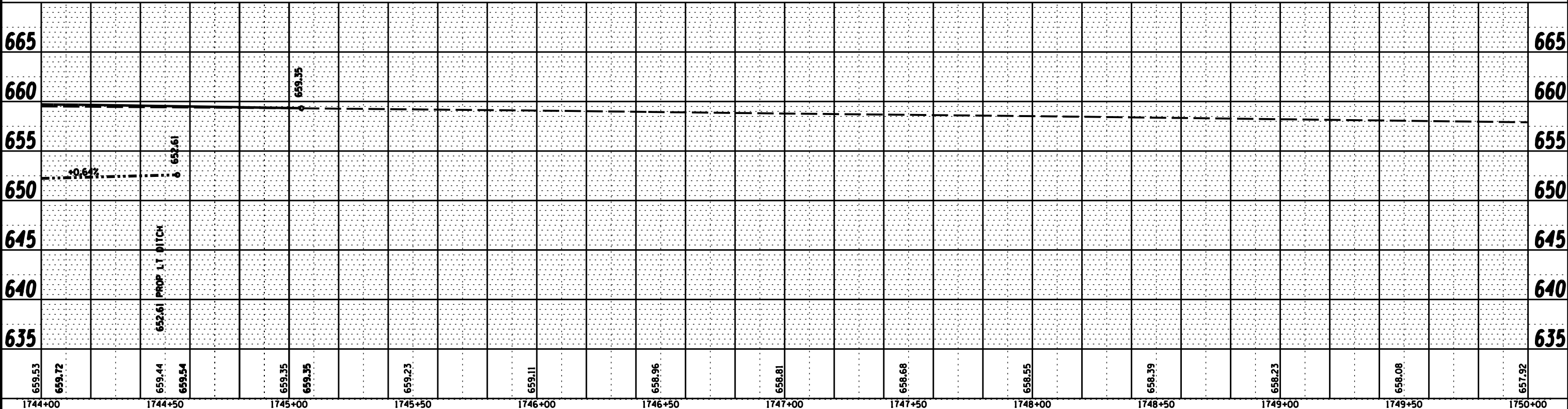
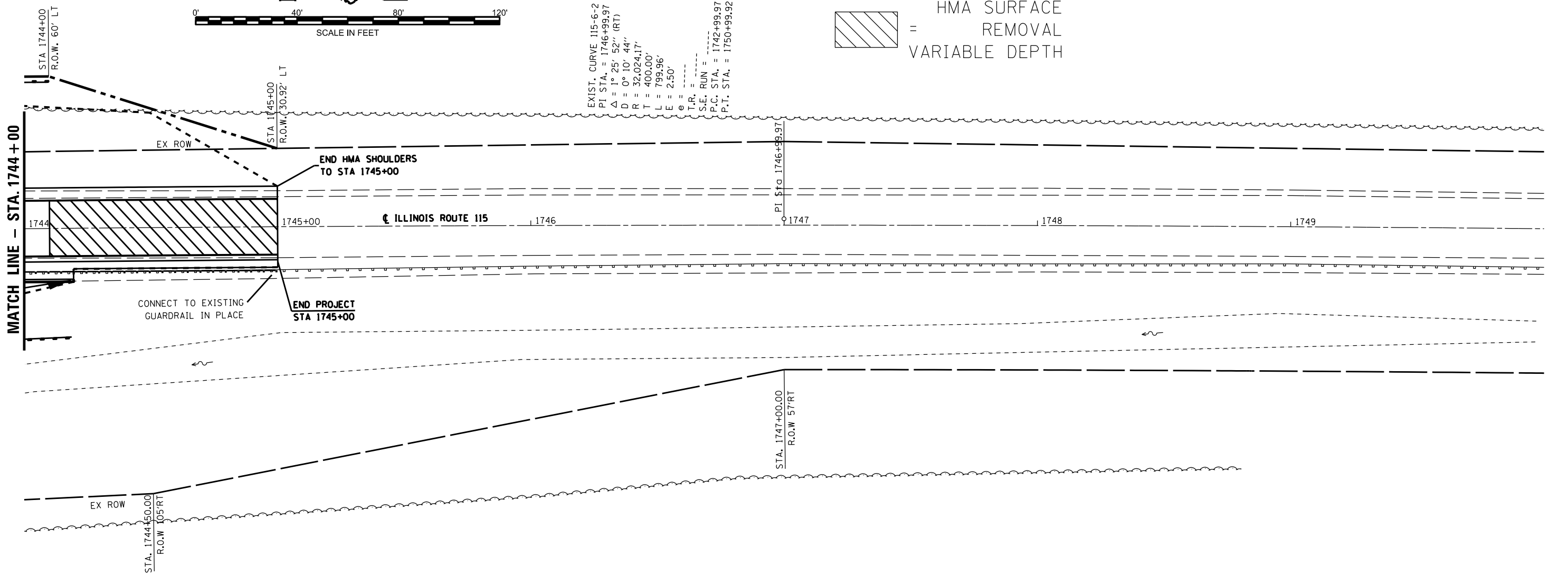

FILE NAME =	USER NAME = *USER*	DESIGNED - JMS 7/07/09	REVISED -	<b>STATE OF ILLINOIS DEPARTMENT OF TRANSPORTATION</b>	<b>IL ROUTE 115 PLAN AND PROFILE SN 027-0072</b>			F.A.P. RTE. 796	SECTION 1061BR-41BR	COUNTY FORD	TOTAL SHEETS 78	SHEET NO. 18			
*FILES*	PLOT SCALE = *SCALE*	CHECKED - ELH 7/07/09	REVISED -					SCALE: AS SHOWN		SHEET NO. 3 OF 3 SHEETS	STA. 1744+00 TO STA. 1750+00	CONTRACT NO. 66980			
SCALE: (HORIZ) 1"=20' (VERT) 1"=5'	PLOT DATE = *DATE*	DATE - 7/07/09	REVISED -					FED. ROAD DIST. NO. ILLINOIS FED. AID PROJECT							