

\* CONFIRM EXISTING ELECTRICAL SERVICE AND TELEPHONE LOCATIONS. ELECTRICAL SERVICE AND TELEPHONE WILL BE INSTALLED PRIOR TO INSTALLING THE TEMPORARY TRAFFIC SIGNALS.

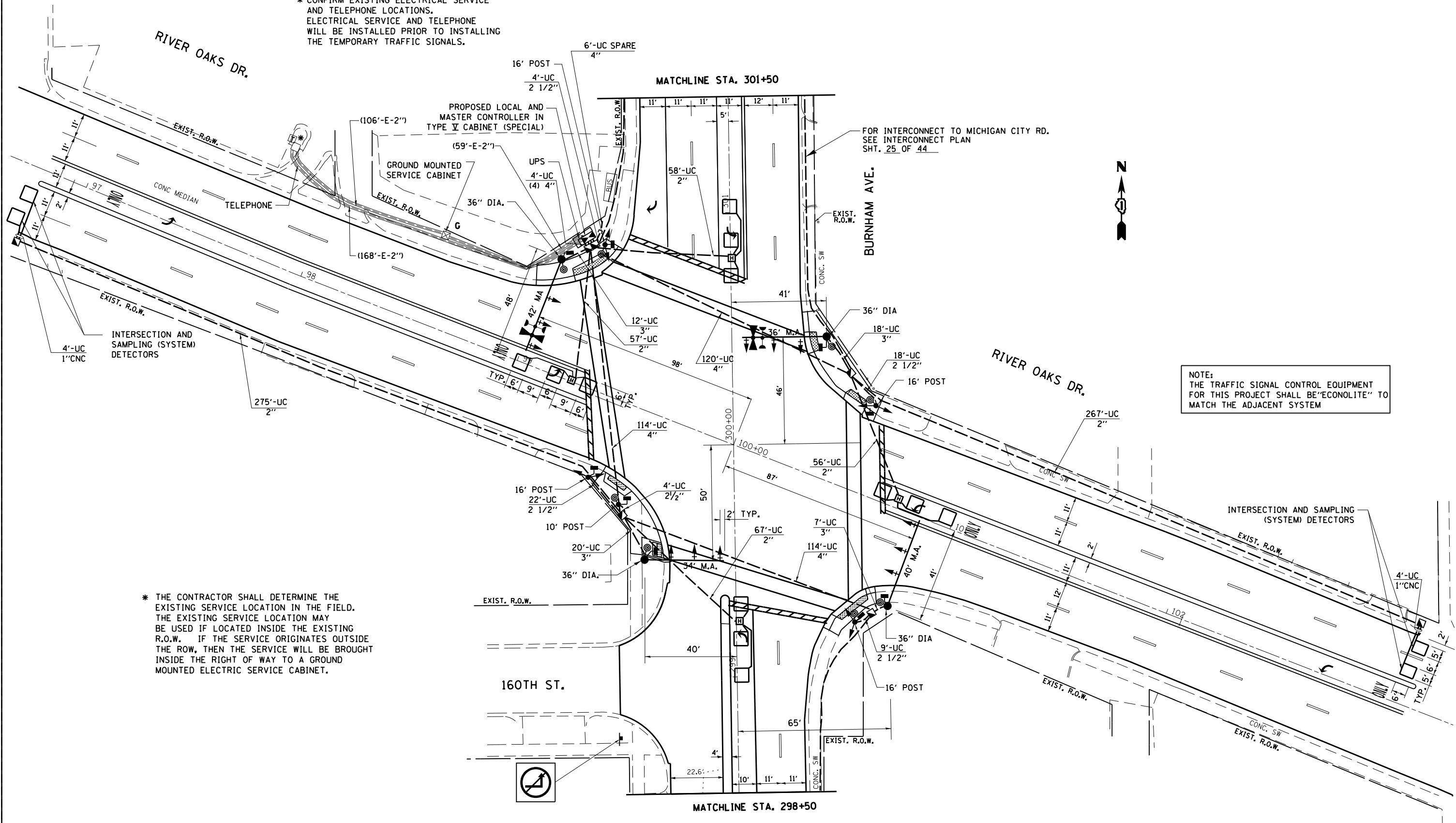

NOTE: THE TRAFFIC SIGNAL CONTROL EQUIPMENT FOR THIS PROJECT SHALL BE "ECONOLITE" TO MATCH THE ADJACENT SYSTEM

\* THE CONTRACTOR SHALL DETERMINE THE EXISTING SERVICE LOCATION IN THE FIELD. THE EXISTING SERVICE LOCATION MAY BE USED IF LOCATED INSIDE THE EXISTING R.O.W. IF THE SERVICE ORIGINATES OUTSIDE THE ROW, THEN THE SERVICE WILL BE BROUGHT INSIDE THE RIGHT OF WAY TO A GROUND MOUNTED ELECTRIC SERVICE CABINET.

FILE NAME =  
 USER NAME = hamdanah  
 DESIGNED - JHE  
 DRAWN - CADD  
 CHECKED - JHE  
 DATE - OCT. 2012

DESIGNED - JHE  
 DRAWN - CADD  
 CHECKED - JHE  
 DATE - OCT. 2012

REVISÉ -  
 REVISÉ -  
 REVISÉ -  
 REVISÉ -

STATE OF ILLINOIS  
 DEPARTMENT OF TRANSPORTATION

BURNHAM AVENUE AT RIVER OAKS DRIVE  
 TRAFFIC SIGNAL INSTALLATION PLAN

SCALE: SHEET OF SHEETS STA. TO STA.

F.A.U. RTE.	SECTION	COUNTY	TOTAL SHEETS	SHEET NO.
2943	3162A-N-1	COOK	42	16
CONTRACT NO. 60T47				
ILLINOIS FED. AID PROJECT				